



Wykeham Road, Hastings TN34 1UA

Offers in excess of £165,000



A bright and spacious one bedroom apartment with PANORAMIC SEA VIEWS situated in an enviable location within immediate reach of Linton Gardens and walking distance from Alexandra Park and Hastings Town centre which enjoys access to the beach and a mainline railway station. Spanning the TOP FLOOR of this period residence the accommodation is WELL PRESENTED THROUGHOUT and arranged as a dual aspect living room which benefits from UNRIVALLED VIEWS across the town with a separate MODERN FITTED KITCHEN. There is a double bedroom and a bathroom where there is a bath with a shower over. Being sold with a SHARE OF FREEHOLD and NO ONWARD CHAIN this fantastic property would make the perfect first time home.

2ND FLOOR
440 sq.ft. (40.9 sq.m.) approx.

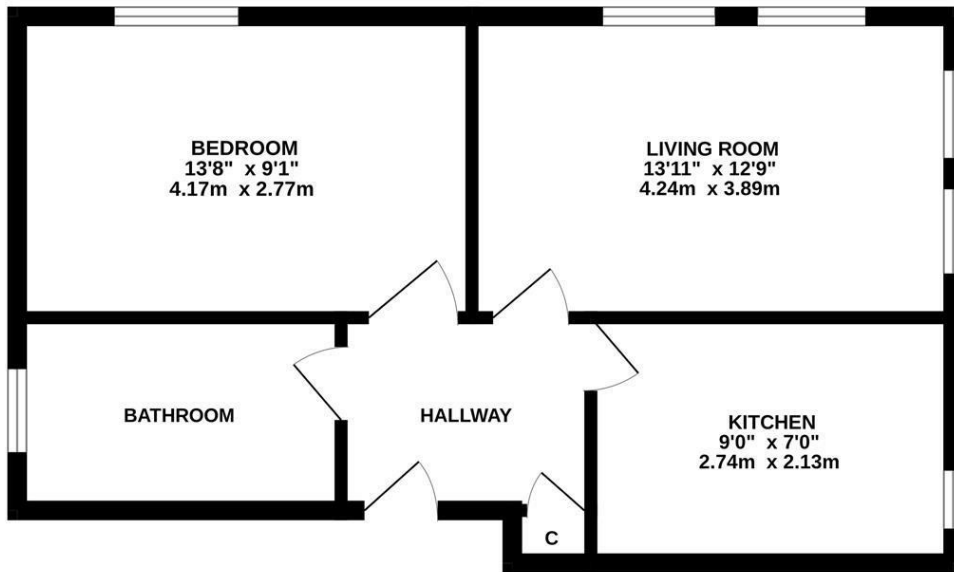

TOTAL FLOOR AREA : 440 sq.ft. (40.9 sq.m.) approx.

Whilst every attempt has been made to ensure the accuracy of the floorplan contained here, measurements of doors, windows, rooms and any other items are approximate and no responsibility is taken for any error, omission or mis-statement. This plan is for illustrative purposes only and should be used as such by any prospective purchaser. The services, systems and appliances shown have not been tested and no guarantee as to their operability or efficiency can be given.

Made with Metropix ©2024

