



Marina, St. Leonards-On-Sea TN38 0BL

Offers in excess of £235,000



A bright and spacious TWO BEDROOM APARTMENT with FAR REACHING SEA VIEWS situated in a prime seafront position. Enjoying an IDYLLIC LOCATION adjacent to the beach it's just a short stroll from the hub of St. Leonards On Sea where there are local independent shops, award winning eateries and galleries along with a mainline railway station with connections to London. Spanning the SECOND FLOOR of this period residence the accommodation here is arranged as a LARGE LIVING ROOM which relishes two SASH WINDOWS framing a stunning southerly aspect with direct sea views and leads through to the FITTED KITCHEN which provides ample storage and worktop space. There are two bedrooms with the principal bedroom positioned at the rear of the property, together with the family bathroom where there is a bath with shower over. There is also a HANDY STORAGE CUPBOARD. Being sold with NO ONWARD CHAIN this fantastic property would make the PERFECT SEASIDE RETREAT and is not one to be missed.

SECOND FLOOR
643 sq.ft. (59.7 sq.m.) approx.

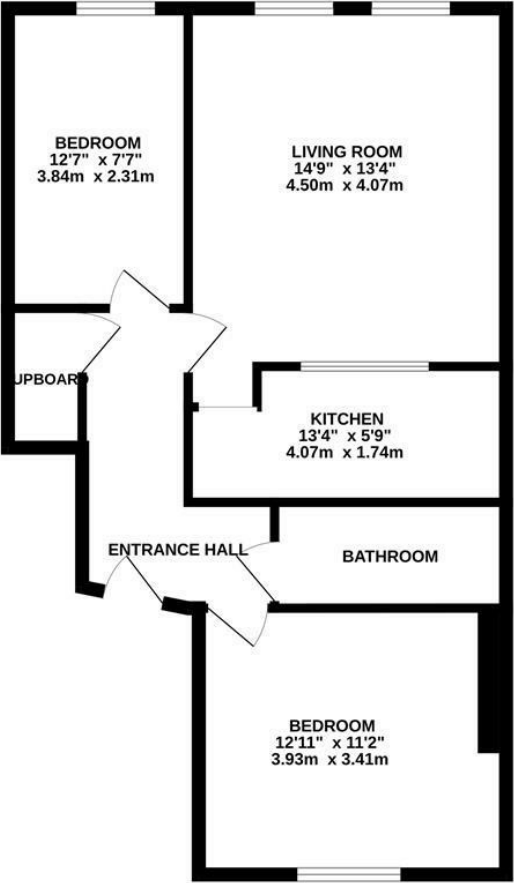

TOTAL FLOOR AREA : 643 sq.ft. (59.7 sq.m.) approx.

Whilst every attempt has been made to ensure the accuracy of the floorplan contained here, measurements of doors, windows, rooms and any other items are approximate and no responsibility is taken for any error, omission or mis-statement. This plan is for illustrative purposes only and should be used as such by any prospective purchaser. The services, systems and appliances shown have not been tested and no guarantee as to their operability or efficiency can be given.

Made with Metropix ©2024

