



## Cornwallis Gardens, Hastings TN34 1LP

Offers in excess of £250,000



A beautiful TWO BEDROOM APARTMENT situated in a CENTRAL POSITION close to Hastings Town centre where there are a range of shopping facilities, a mainline railway station with connections to London and it's within walking distance to the beach. Relishing a WEALTH OF ORIGINAL FEATURES including sash windows and wooden floorboards which flow throughout, the attractive accommodation here is arranged as a BRIGHT AND SPACIOUS LIVING ROOM benefitting from a leafy front aspect with views over Cornwallis Gardens, it features a marble fireplace with a WOOD BURNING STOVE while the BESPOKE KITCHEN is separate and FITTED WITH CONTEMPORARY UNITS which provide ample storage and worktop space. There is also a GENEROUS WALK-IN STORAGE ROOM. There are TWO DOUBLE BEDROOMS with original fireplaces, together with a STYLISH BATHROOM finished with hand-made Moroccan tiles and there is a bath with a shower over. The second bedroom is currently being used as a home office. Being sold with NO ONWARD CHAIN this stunning property would make the PERFECT SEASIDE RETREAT and is not to be missed.

TOP FLOOR  
757 sq.ft. (70.4 sq.m.) approx.

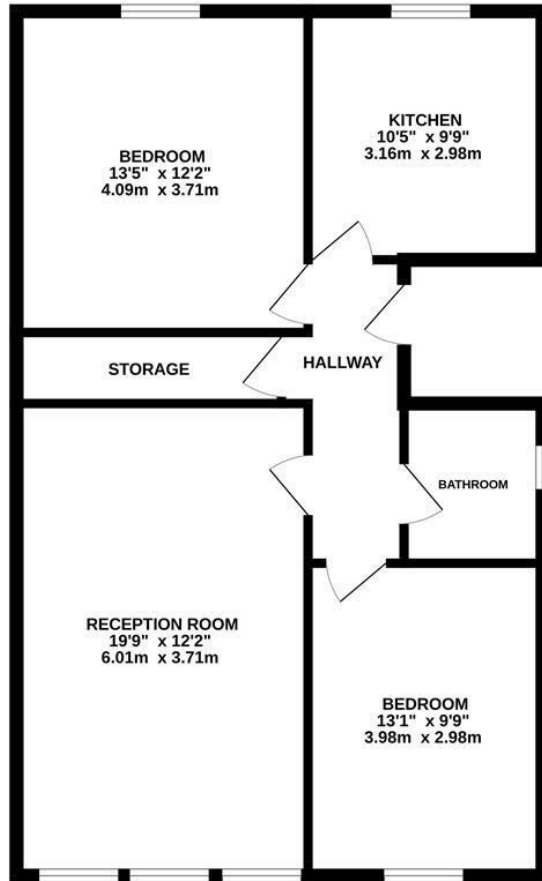

TOTAL FLOOR AREA: 757 sq.ft. (70.4 sq.m.) approx.

Whilst every attempt has been made to ensure the accuracy of the floorplan contained here, measurements of doors, windows, rooms and any other items are approximate and no responsibility is taken for any error, omission or mis-statement. This plan is for illustrative purposes only and should be used as such by any prospective purchaser. The services, systems and appliances shown have not been tested and no guarantee as to their operability or efficiency can be given.  
Made with Metropix ©2024

