



Ridgewood Gardens, Hastings TN34 2LZ

Offers in excess of £850,000



An impressive five bedroom, three reception room DETACHED, EXECUTIVE HOUSE located within a small and exclusive development. It's enviably positioned within immediate reach of St. Helens Woods and within walking distance of popular schools, good transport links and the Conquest Hospital. Having been EXTENDED AND COMPLETELY REMODELLED the accommodation here is presented to an exceptional standard throughout offering a VERSATILE SPACE THAT WOULD BE PERFECT FOR FAMILY LIFE. You enter in to a welcoming entrance hall where there are double doors opening to the STUDY and a downstairs cloakroom, the stunning kitchen and dining space spans the rear of the property with bi-folding doors opening out to the garden, the kitchen is fitted with STYLISH UNITS which house integrated appliances and there is a central island/breakfast bar which creates a sociable space with plenty of room for a full dining table. There is also a SEPARATE UTILITY ROOM, a cosy living room and CONSERVATORY. The second reception area benefits from a triple aspect with bi-folding doors at the rear also opening to the garden, it

GROUND FLOOR
1916 sq.ft. (178.0 sq.m.) approx.

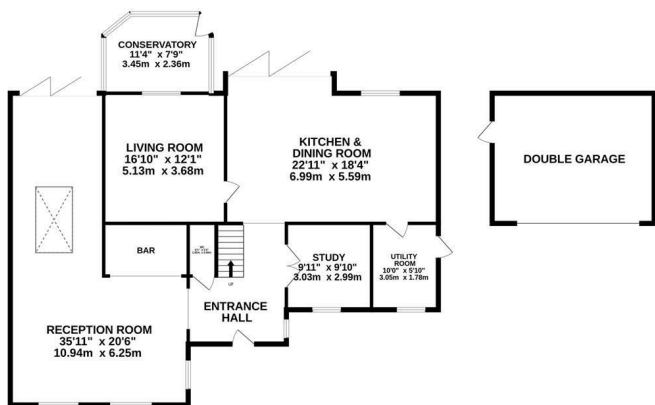

1ST FLOOR
969 sq.ft. (90.0 sq.m.) approx.

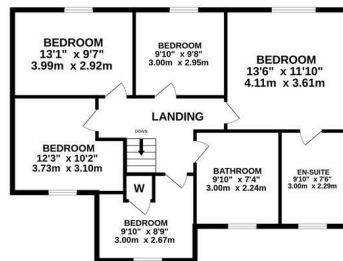

TOTAL FLOOR AREA: 2884 sq.ft. (268.0 sq.m.) approx.

Whilst every attempt has been made to ensure the accuracy of the floorplan contained here, measurements of doors, windows, rooms and any other items are approximate and no responsibility is taken for any error, omission or mis-statement. This plan is for illustrative purposes only and should be used as such by any prospective purchaser. The services, systems and appliances shown have not been tested and no guarantee as to their operability or efficiency can be given.
Made with Metropix ©2024

