



Anglesea Terrace, St. Leonards-On-Sea TN38 0QS

Offers in excess of £270,000



A beautifully presented and bright ONE BEDROOM APARTMENT with attractive leafy views situated on the SECOND FLOOR of this period residence. It's enviably positioned within a CENTRAL ST LEONARDS location adjacent to Gensing Gardens and just a short stroll into the hub of St. Leonards where there is a mainline railway station, local shops and award winning eateries making it perfectly placed for LIFE BY THE SEA. The accommodation here enjoys a WEALTH OF ORIGINAL FEATURES including high ceilings and exposed floorboards and is arranged as a BAY FRONTED LIVING ROOM which measures an impressive 22'0 x 15'1 providing plenty of space for a full dining table, leading through to the MODERN FITTED KITCHEN which offers ample storage space. The GENEROUS DOUBLE BEDROOM is positioned at the rear of the property enjoying a FEATURE FIREPLACE and there is a bathroom where there is a bath with shower over. Being sold with a LONG LEASE AND SHARE OF FREEHOLD this fantastic property would make the PERFECT SEASIDE RETREAT and is not to be missed.

SECOND FLOOR
749 sq.ft. (69.6 sq.m.) approx.

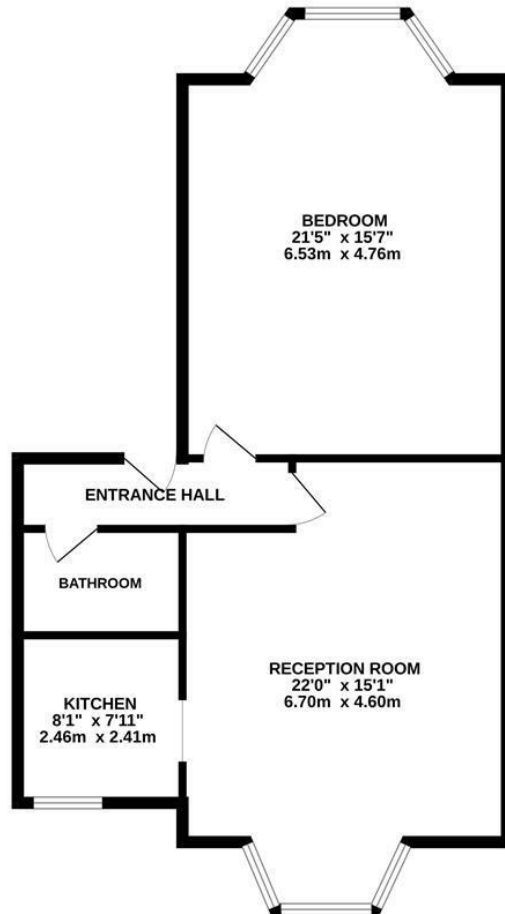

TOTAL FLOOR AREA : 749 sq.ft. (69.6 sq.m.) approx.

Whilst every attempt has been made to ensure the accuracy of the floorplan contained here, measurements of doors, windows, rooms and any other items are approximate and no responsibility is taken for any error, omission or mis-statement. This plan is for illustrative purposes only and should be used as such by any prospective purchaser. The services, systems and appliances shown have not been tested and no guarantee as to their operability or efficiency can be given.
Made with Metropix ©2024

