



Edward Terrace, St. Leonards-On-Sea TN38 9LP

Offers in excess of £230,000



A well presented TWO BEDROOM TERRACE HOUSE located on the Northern outskirts of St. Leonards On Sea within easy reach of local shops, the A21 and the historic Town of Battle. Nestled in a quaint terrace, the accommodation here is arranged as a BRIGHT LIVING ROOM which enjoys a WOOD BURNING STOVE and a front aspect while the FITTED KITCHEN/DINER spans the rear of the property offering ample storage and plenty of room for a dining table. The STYLISH FAMILY BATHROOM can be found on this floor while the TWO DOUBLE BEDROOMS are housed on the first floor both benefitting from BUILT-IN STORAGE SPACE. The rear garden has been designed for low maintenance with a decked area followed by a raised level of artificial lawn which offers the ideal seating space. Set in a CONVENIENT LOCATION, this fantastic property would make the PERFECT FIRST TIME HOME and is not to be missed.

GROUND FLOOR 33.24 sq. m.
(357.83 sq. ft.)

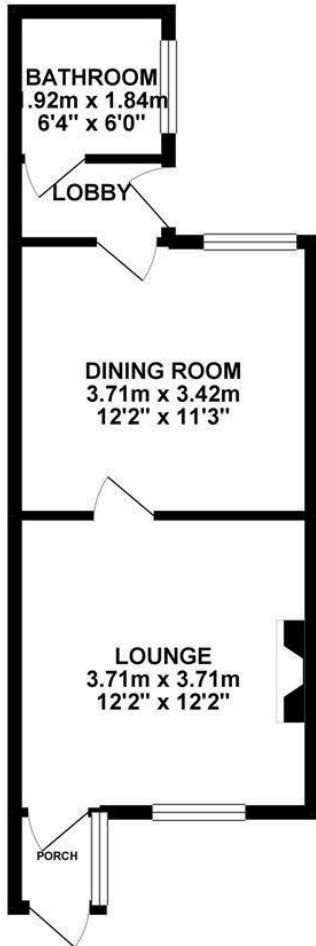

1ST FLOOR 26.45 sq. m.
(284.73 sq. ft.)

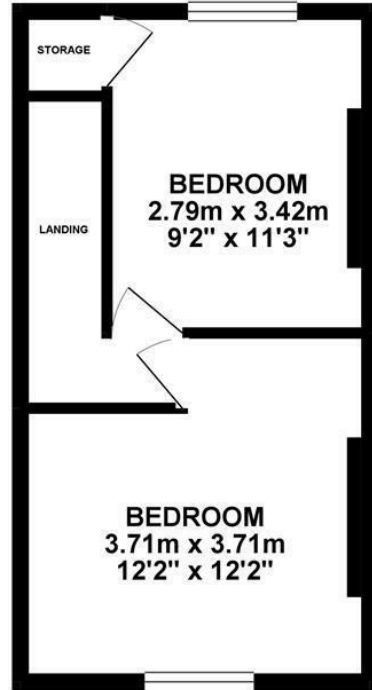

TOTAL FLOOR AREA : 59.70 sq. m. (642.56 sq. ft.) approx.

Whilst every attempt has been made to ensure the accuracy of the floorplan contained here, measurements of doors, windows, rooms and any other items are approximate and no responsibility is taken for any error, omission or mis-statement. This plan is for illustrative purposes only and should be used as such by any prospective purchaser. The services, systems and appliances shown have not been tested and no guarantee as to their operability or efficiency can be given.
Made with Metropix ©2019

