



Charles Road, St. Leonards-On-Sea TN38 0QH

Offers in excess of £285,000



A beautifully presented TWO BEDROOM APARTMENT located in a leafy St. Leonards setting, adjacent to Gensing Gardens. It's just a short stroll from the hub of St. Leonards On Sea where there are a range of local stores, award winning eateries, the beach and a mainline railway station with connections to London. The accommodation here enjoys a BRIGHT OPEN PLAN LIVING SPACE which relishes SEA VIEWS over the gardens and offers plenty of room for a full dining table, creating the perfect social setting. The kitchen is FITTED WITH CONTEMPORARY UNITS housing INTEGRATED APPLIANCES whilst providing ample storage and worktop space. There are two well proportioned bedrooms together with a STYLISH BATHROOM where there is a bath with shower and screen over. The main bedroom also benefits from built-in wardrobes. Set in a central location, this fantastic property would make the PERFECT SEASIDE RETREAT and is not to be missed.

702 sq.ft. (65.3 sq.m.) approx.

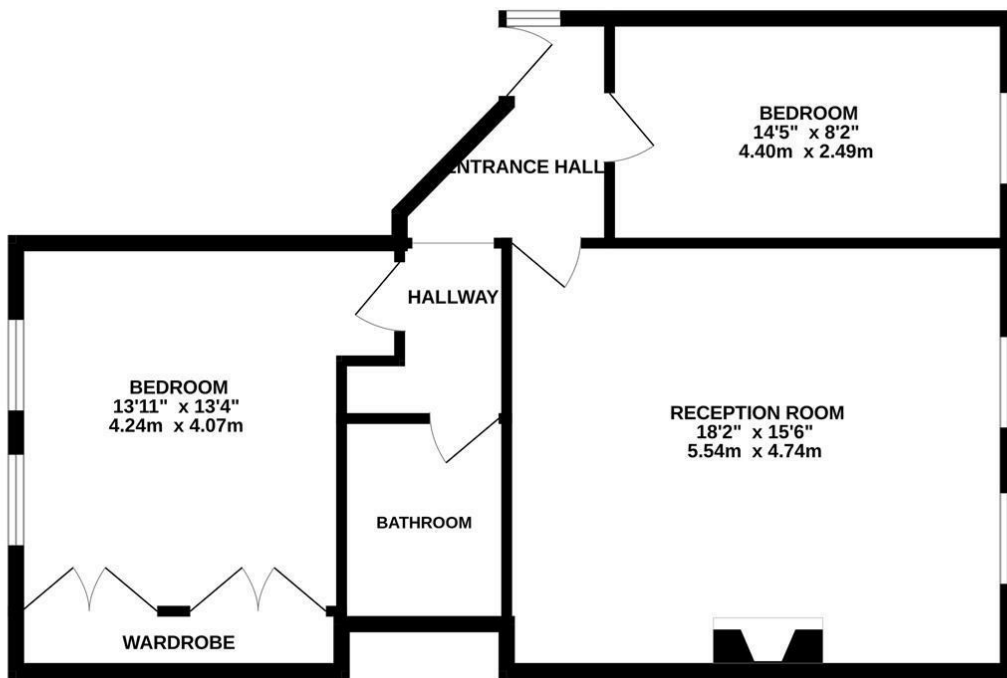

TOTAL FLOOR AREA : 702 sq.ft. (65.3 sq.m.) approx.

Whilst every attempt has been made to ensure the accuracy of the floorplan contained here, measurements of doors, windows, rooms and any other items are approximate and no responsibility is taken for any error, omission or mis-statement. This plan is for illustrative purposes only and should be used as such by any prospective purchaser. The services, systems and appliances shown have not been tested and no guarantee as to their operability or efficiency can be given.

Made with Metropix ©2024

