



St. Helens Park Road, Hastings TN34 2DN

Offers in excess of £180,000



A spacious TWO BEDROOM APARTMENT situated on the top floor of this PURPOSE BUILT BLOCK found in a sought after location just moments from Alexandra Park and Hastings Town centre where there is a mainline railway station and the beach. The accommodation here is arranged as a BRIGHT LIVING ROOM which enjoys a front aspect and offers plenty of space for a full dining table along with a separate FITTED KITCHEN which provides ample storage and worktop space. There are two WELL PROPORTIONED BEDROOMS with the main bedroom benefitting from BUILT-IN WARDROBES, together with a family bathroom where there is a bath and shower over. To the side of the property, there is also an ALLOCATED OFF ROAD PARKING SPACE. Being sold with NO ONWARD CHAIN, this property would make the PERFECT FIRST TIME HOME and is not to be missed.

TOP FLOOR
618 sq.ft. (57.4 sq.m.) approx.

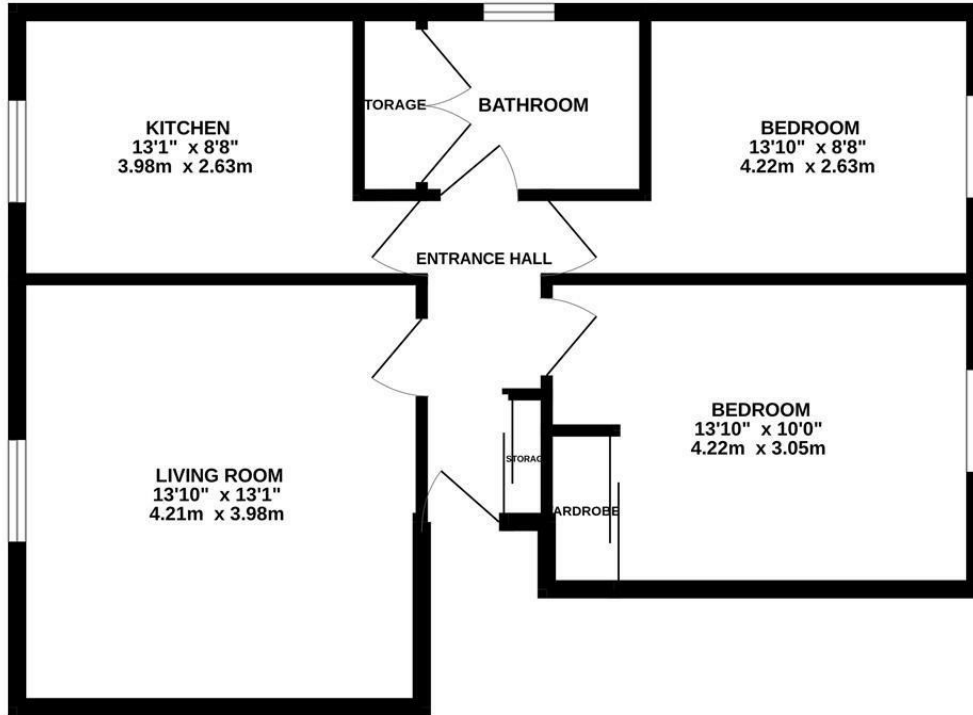

TOTAL FLOOR AREA : 618 sq.ft. (57.4 sq.m.) approx.

Whilst every attempt has been made to ensure the accuracy of the floorplan contained here, measurements of doors, windows, rooms and any other items are approximate and no responsibility is taken for any error, omission or mis-statement. This plan is for illustrative purposes only and should be used as such by any prospective purchaser. The services, systems and appliances shown have not been tested and no guarantee as to their operability or efficiency can be given.

Made with Metropix ©2024

