



Marina, St. Leonards-On-Sea TN38 0BL

Offers in excess of £325,000



Exceptional TWO BEDROOM GARDEN APARTMENT occupying a PRIME POSITION on the marina. It is enviably located adjacent to the seafront and beach with the vibrant hub of St. Leonards only a short stroll away with it's award winning eateries and local shops making this fantastic property perfect for seaside living. Spanning the LOWER GROUND FLOOR of this impressive period residence, the accommodation here showcases a PLETHORA OF ORIGINAL FEATURES including wooden floorboards and SASH WINDOWS. Entering through the GRAND ENTRANCE HALLWAY, there is a BRIGHT LIVING ROOM enjoying a LEAFY OUTLOOK over the courtyard while the EAT-IN KITCHEN spans the rear of the property measuring an impressive 19'4 x 12'3 offering plenty of space for a full dining table. There are TWO DOUBLE BEDROOMS which sit to the front of the property together with a stylish bathroom off of the kitchen. Being sold with NO ONWARD CHAIN, this stunning property would make the PERFECT SEASIDE RETREAT and is not to be missed.

LOWER GROUND FLOOR
1169 sq.ft. (108.6 sq.m.) approx.

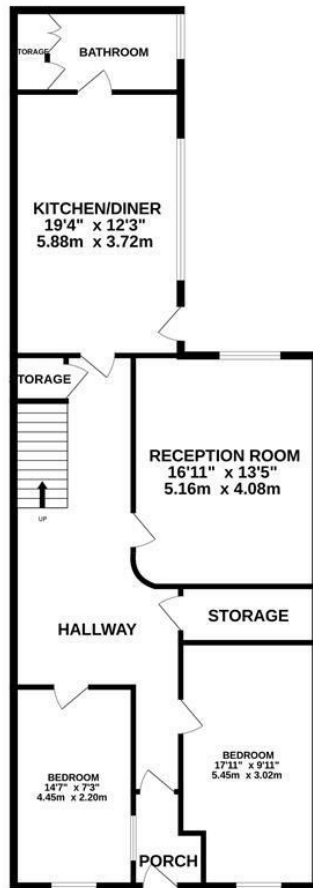

TOTAL FLOOR AREA: 1169 sq.ft. (108.6 sq.m.) approx.

Whilst every attempt has been made to ensure the accuracy of the floorplan contained here, measurements of doors, windows, rooms and any other items are approximate and no responsibility is taken for any error, omission or mis-statement. This plan is for illustrative purposes only and should be used as such by any prospective purchaser. The services, systems and appliances shown have not been tested and no guarantee as to their operability or efficiency can be given.

Made with Metropix ©2024

