



27 Mickley Close

Dilston Grange, Wallsend, NE28 6JJ

** THIS PROPERTY IS NOW "SALE AGREED" AND THERE ARE TO BE NO FURTHER VIEWINGS - WE WOULD LOVE TO HEAR FROM YOU IF YOU HAVE A PROPERTY TO SELL AND WANT ONE OF OUR "GONE" BOARDS TOO! PLEASE GET IN TOUCH **

** TWO BEDROOM FIRST FLOOR APARTMENT ** MODERN OPEN PLAN LIVING AREA **

** MASTER BEDROOM WITH DRESSING ROOM/STUDY ** INTERCOM ENTRY SYSTEM **

ALLOCATED PARKING BAY ** CHAIN FREE ** ENERGY EFFICIENT WITH A B RATING **

COUNCIL TAX BAND A ** 125 YEAR LEASE FROM 2005 **

Offers Over £80,000

27 Mickley Close

Dilston Grange, Wallsend, NE28 6JJ



- Two Bedroom First Floor Apartment
- Bedroom One With Dressing Room / Study
- Council Tax Band A
- Intercom Entry System
- Allocated Parking Bay
- 125 Year Lease From 2005
- Open Plan Living Area
- Chain Free
- Energy Rating B

Communal Entrance

Hallway

Living Room

3.05 x 4.93

Kitchen Area

2.74 x 2.77

Bedroom 1

2.62 x 3.66

Dressing Room

2.24 x 1.52

Bedroom 2

2.62 x 2.31

Bathroom

2.08 x 1.65

External

Lease - Service Charge & Ground Rent

Broadband

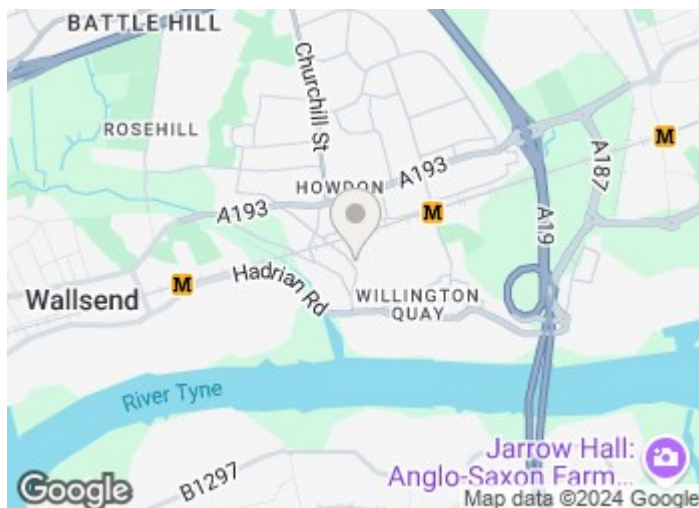

[Directions](#)



Floor Plan

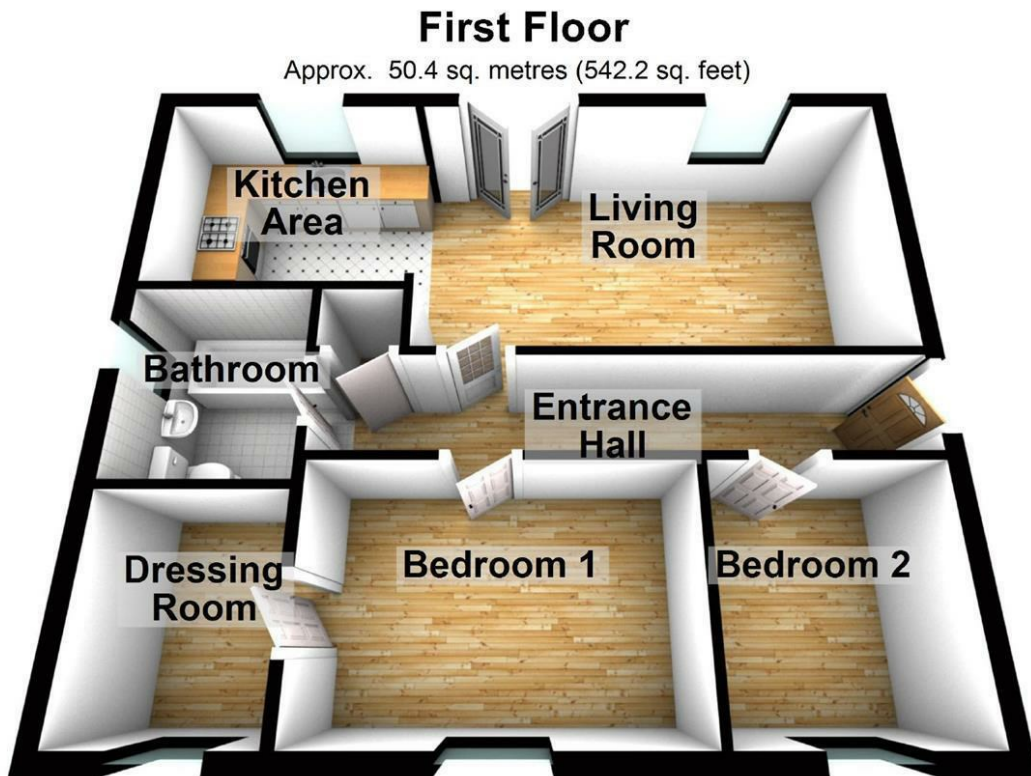

Total area: approx. 50.4 sq. metres (542.2 sq. feet)

These particulars, whilst believed to be accurate are set out as a general outline only for guidance and do not constitute any part of an offer or contract. Intending purchasers should not rely on them as statements of representation of fact, but must satisfy themselves by inspection or otherwise as to their accuracy. No person in this firm's employment has the authority to make or give any representation or warranty in respect of the property.

136 - 138 Station Road, Wallsend, Tyne & Wear, NE28 8QT
Tel: 0191 295 3322 Email: info@next2buy.com <https://www.next2buy.com>

Energy Efficiency Rating		Current	Potential
Very energy efficient - lower running costs			
(92 plus) A			
(81-91) B			
(69-80) C			
(55-68) D			
(39-54) E			
(21-38) F			
(1-20) G			
Not energy efficient - higher running costs			
England & Wales		EU Directive 2002/91/EC	