



94 Savory Road , Howdon, NE28 7EF

** THIS PROPERTY IS NOW "SALE AGREED" AND THERE ARE TO BE NO FURTHER VIEWINGS - WE WOULD LOVE TO HEAR FROM YOU IF YOU HAVE A PROPERTY TO SELL AND WANT ONE OF OUR "GONE" BOARDS TOO! PLEASE GET IN TOUCH **

** THREE BEDROOM SEMI DETACHED HOUSE ** FREEHOLD ** CHAIN FREE ** SPACIOUS LOUNGE **

** REAR GARDEN AND OFF STREET PARKING ** KITCHEN DINER **

** IDEAL FAMILY HOME OR SUPERB FIRST TIME BUY ** EXCELLENT TRANSPORT LINKS **

** CLOSE TO AMENITIES ** COUNCIL TAX BAND A ** EPC RATING C **

Offers Over £135,000

94 Savory Road

, Howdon, NE28 7EF



- *** Chain Free ***
- Freehold
- Three Bedroom Semi Detached House
- Rear Garden
- Ideal First Time Buy Or Family Home
- Off Street Parking
- Excellent Road & Transport Links
- Council Tax Band A
- EPC Rating C

Entrance

Lounge

13'10" x 13'2" (4.23 x 4.02)

Kitchen Diner

16'7" x 8'2" (5.08 x 2.49)

Stairs To First Floor Landing

Bedroom 1

12'6" x 7'11" (3.82 x 2.43)

Bedroom 2

10'5" x 9'8" (3.18 x 2.97)

Bedroom 3

9'5" x 8'5" (2.89 x 2.58)

Bathroom

6'0" x 5'6" (1.83 x 1.68)

Gardens

Broadband

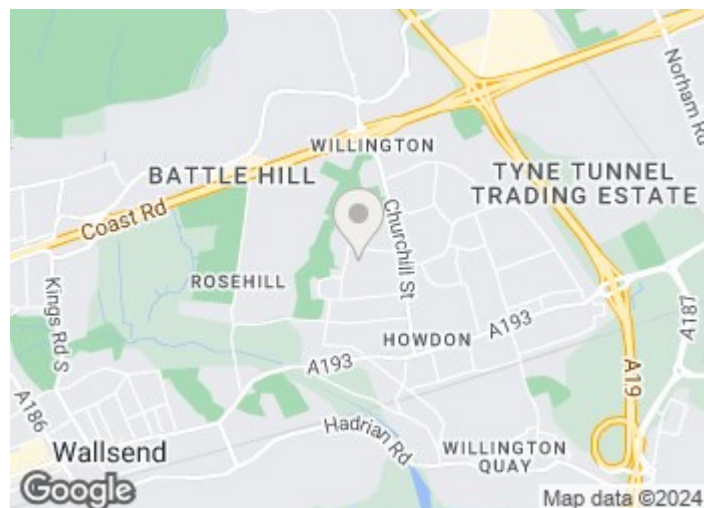

Directions





Floor Plan

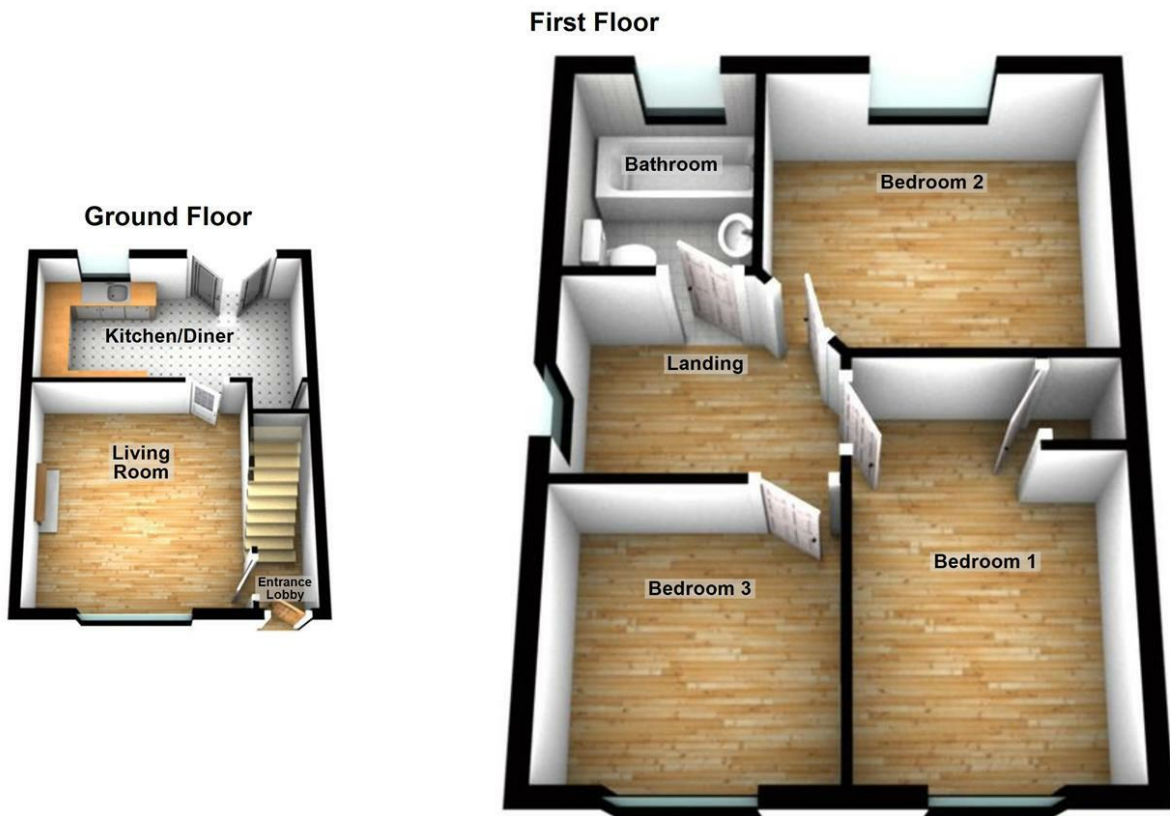

These particulars, whilst believed to be accurate are set out as a general outline only for guidance and do not constitute any part of an offer or contract. Intending purchasers should not rely on them as statements of representation of fact, but must satisfy themselves by inspection or otherwise as to their accuracy. No person in this firm's employment has the authority to make or give any representation or warranty in respect of the property.

136 - 138 Station Road, Wallsend, Tyne & Wear, NE28 8QT
 Tel: 0191 295 3322 Email: info@next2buy.com <https://www.next2buy.com>

| Energy Efficiency Rating | | Current | Potential |
|---|--|-------------------------|-----------|
| Very energy efficient - lower running costs | | | |
| (92 plus) A | | | 84 |
| (81-91) B | | | |
| (69-80) C | | 69 | |
| (55-68) D | | | |
| (39-54) E | | | |
| (21-38) F | | | |
| (1-20) G | | | |
| Not energy efficient - higher running costs | | | |
| England & Wales | | EU Directive 2002/91/EC | |