



81 Haydon Drive Hadrian Village, Wallsend, NE28 0BG

** THIS PROPERTY IS NOW "SALE AGREED" AND THERE ARE TO BE NO FURTHER VIEWINGS - WE WOULD LOVE TO HEAR FROM YOU IF YOU HAVE A PROPERTY TO SELL AND WANT ONE OF OUR "GONE" BOARDS TOO! PLEASE GET IN TOUCH **

** OFFERS IN THE REGION OF £79,950 **

** TWO BEDROOM SECOND FLOOR APARTMENT ** READY TO MOVE INTO ** IDEAL FIRST BUY **

** 125 YEAR LEASE FROM 31ST JANUARY 2011** ALLOCATED PARKING SPACE ** SECURE ENTRY SYSTEM **

** CLOSE TO METRO STATION ** COUNCIL TAX BAND A ** EPC RATING B **

O.I.R.O £79,950

81 Haydon Drive

Hadrian Village, Wallsend, NE28 0BG



- Two Bedroom Modern Apartment
- Beautifully Presented
- Council Tax Band A
- 125 Year Lease From 31st January 2011
- Chain Free
- Energy Rating B
- Allocated Parking
- Metro Nearby
- Secure Entry System

Communal Entrance

Leasehold Information

Hallway

Broadband

Lounge

14'0" x 15'11" max (4.26 x 4.86 max)

Kitchen

6'0" x 12'10" max (1.83 x 3.91 max)

Bedroom 1

11'4" x 10'2" (3.46 x 3.10)

Bedroom 2

12'0" x 6'8" (3.65 x 2.04)

Bathroom

9'0" x 6'3" (2.74 x 1.95)

External

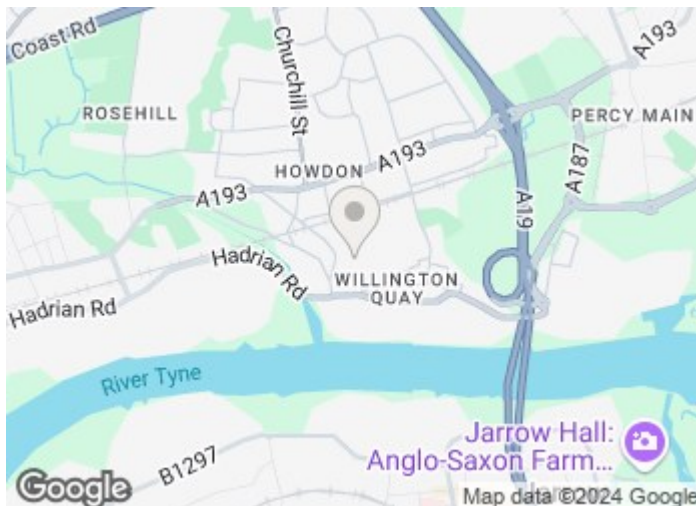

Directions



Floor Plan

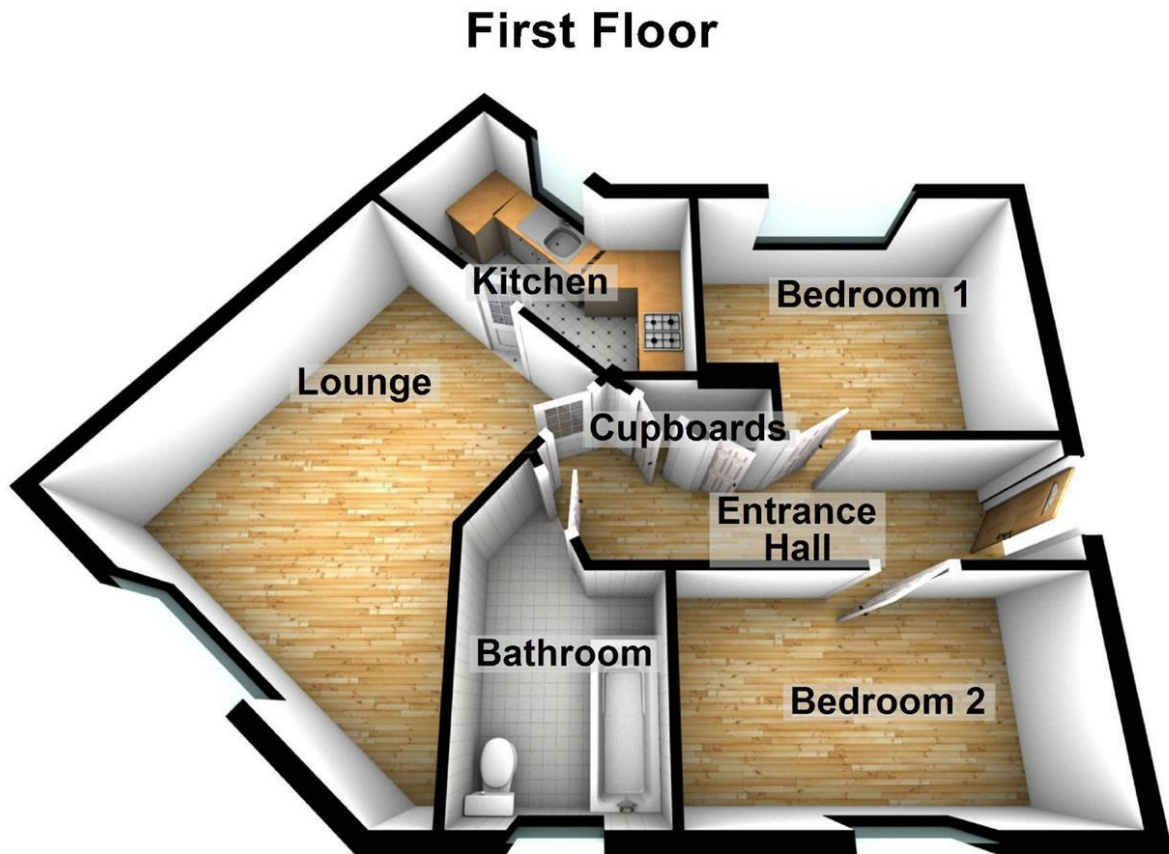

These particulars, whilst believed to be accurate are set out as a general outline only for guidance and do not constitute any part of an offer or contract. Intending purchasers should not rely on them as statements of representation of fact, but must satisfy themselves by inspection or otherwise as to their accuracy. No person in this firm's employment has the authority to make or give any representation or warranty in respect of the property.

136 - 138 Station Road, Wallsend, Tyne & Wear, NE28 8QT
 Tel: 0191 295 3322 Email: info@next2buy.com <https://www.next2buy.com>

Energy Efficiency Rating		Current	Potential
<i>Very energy efficient - lower running costs</i>			
(92 plus) A			
(81-91) B		82	82
(69-80) C			
(55-68) D			
(39-54) E			
(21-38) F			
(1-20) G			
<i>Not energy efficient - higher running costs</i>			
England & Wales		EU Directive 2002/91/EC	