

70 Haydon Drive

Willington Quay, Wallsend, NE28 0BH

THREE BEDROOM DETACHED HOUSE ** EN-SUITE TO MASTER BEDROOM ** OFFICE/PLAYROOM **

CONSERVATORY ** UTILITY ROOM & DOWNSTAIRS WC ** MODERN REFITTED KITCHEN **

RECENTLY REFITTED BATHROOM ** LOUNGE & DINING ROOM ** SOUTH FACING REAR GARDEN ** OFF STREET

PARKING ** FREEHOLD ** COUNCIL TAX BAND C ** ENERGY RATING C **

Asking Price £230,000

70 Haydon Drive

Willington Quay, Wallsend, NE28 0BH



- Three Bedrooms
- Play Room/Office & Conservatory
- Off Street Parking
- En-Suite To Master
- Recently Refitted Bathroom
- Freehold _ Council Tax Band C
- Modern Refitted Kitchen
- South Facing Rear Garden
- Energy Rating C

Entrance Lobby

Lounge

17'7" x 11'7" (5.36 x 3.53)

Play Room / Office

15'1" x 7'3" (4.60 x 2.21)

Dining Room

12'6" x 10'5" (3.81 x 3.18)

Conservatory

6'11" x 11'0" (2.10 x 3.35)

Kitchen

10'8" x 8'11" (3.25 x 2.72)

Utility Room

5'1" x 6'2" (1.55 x 1.88)

WC

5'1" x 3'2" (1.55 x 0.97)

Landing

Bedroom 1

9'4" x 14'2" (2.84 x 4.32)

En-Suite

4'2" x 5'7" (1.27 x 1.70)

Bedroom 2

10'7" x 9'11" (3.23 x 3.02)

Bedroom 3

8'1" x 9'8" (2.46 x 2.95)

Bathroom

6'7" x 5'6" (2.01 x 1.68)

External



Directions







Floor Plan

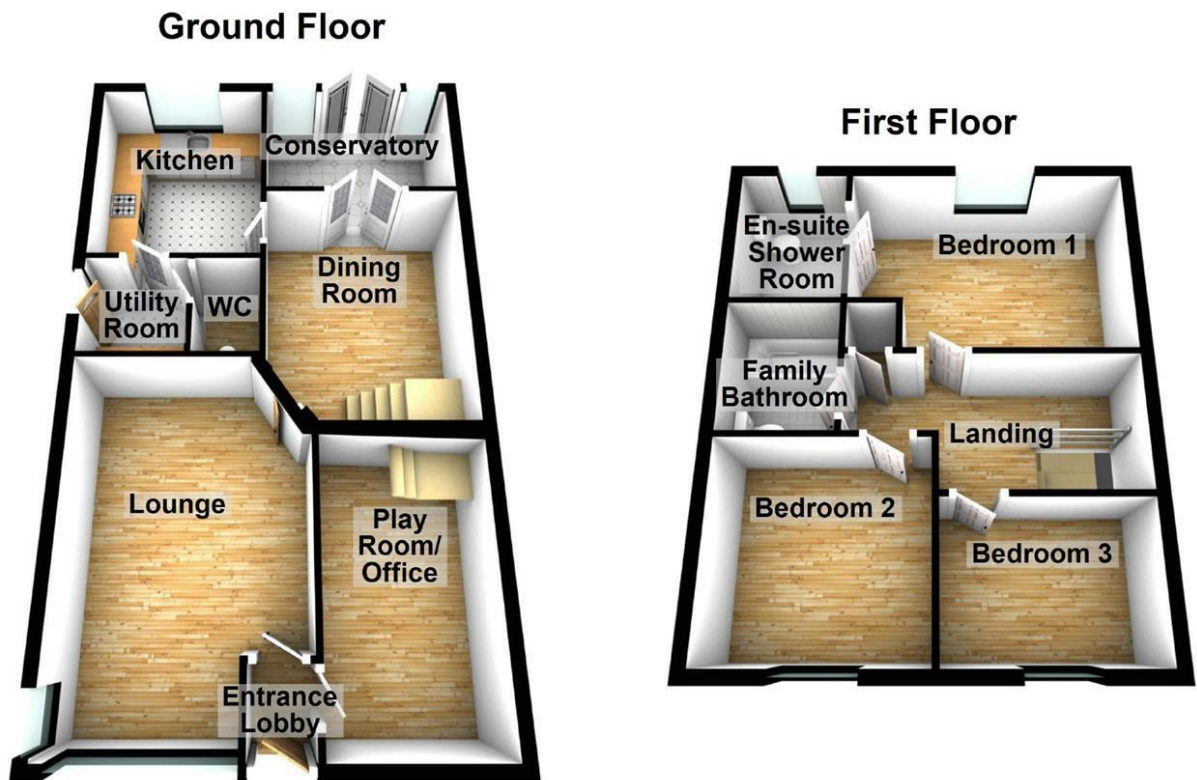

These particulars, whilst believed to be accurate are set out as a general outline only for guidance and do not constitute any part of an offer or contract. Intending purchasers should not rely on them as statements of representation of fact, but must satisfy themselves by inspection or otherwise as to their accuracy. No person in this firm's employment has the authority to make or give any representation or warranty in respect of the property.

136 - 138 Station Road, Wallsend, Tyne & Wear, NE28 8QT
 Tel: 0191 295 3322 Email: info@next2buy.com <https://www.next2buy.com>

Energy Efficiency Rating		Current	Potential
Very energy efficient - lower running costs			
(92 plus) A			87
(81-91) B		76	
(69-80) C			
(55-68) D			
(39-54) E			
(21-38) F			
(1-20) G			
Not energy efficient - higher running costs			
England & Wales		EU Directive 2002/91/EC	