



Waterside

Hythe, Southampton

Asking Price Of - £150,000



- A GREAT INVESTMENT PROPERTY
- GROUND FLOOR FLAT
- ONE DOUBLE BEDROOM
- NEW BATHROOM

EPC Rating

E



Property Description

BEDROOM Spacious double bedroom. Rear aspect double glazing window. Two door access.

KITCHEN Open plan kitchen with ceramic single drainer basin with hot and cold chrome taps. Base level cupboards and drawers. Tiled effect vinyl flooring.

DINING HALL Small dining area just off the kitchen. Open plan to lounge.

LIVING ROOM Cozy living room with rear aspect double glazed windows along rear wall to brighten the whole room.

SHOWER ROOM New three piece white shower suite comprising of a double cubicle walk in shower with glass shower panel and Mira electric shower. WC with push button flush. Pedestal basin with chrome mixer tap. Marble effect tiled surround and timber effect vinyl flooring.



OTHER Communal garden area and stairs leading to path with field views.
Garage and Parking
New carpets fitted in lounge and dining area and new décor throughout.
EPC Rating E

Excellent Investment opportunity
The property currently has a long-term tenant in situ
Who has been there for over 20 years with a current rental income of approx. £750,00 PCM





GROUND FLOOR
415 sq.ft. (38.5 sq.m.) approx.

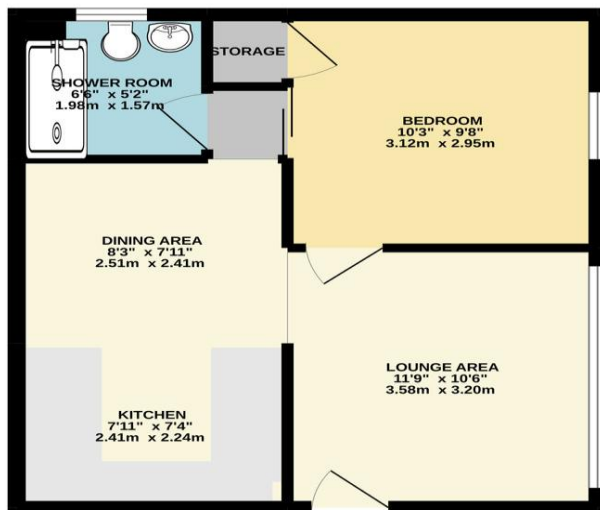

TOTAL FLOOR AREA: 415 sq.ft. (38.5 sq.m.) approx.
Whilst every attempt has been made to ensure the accuracy of the foregoing information, measurements of doors, windows, rooms and any other items are approximate and no responsibility is taken for any error, omission or mis-statement. This plan is for illustrative purposes only and should be used as such by any prospective purchaser. The services, systems and appliances shown have not been tested and no guarantee is given to their operation or efficiency can be given.
Issue with Medipro 12/2022

Hotspur House
Prospect Place
Hythe
Southampton
Hampshire
SO45 3AH

www.hytheadwaterside.com
darren@hytheadwaterside.com
0238 0845 434

Agents Note: Whilst every care has been taken to prepare these sales particulars, they are for guidance purposes only. All measurements are approximate are for general guidance purposes only and whilst every care has been taken to ensure their accuracy, they should not be relied upon and potential buyers are advised to recheck the measurements