



The Old Bank, Sheep Lane, Midhurst, GU29 9NT

A sympathetic conversion full of character with a modern finish, in the centre of Midhurst



- ▶ **High Specification Finish**
- ▶ **Three Bedrooms**
- ▶ **Town Centre Location**
- ▶ **Light and Spacious**
- ▶ **Shaker Style Kitchen with Integrated Appliances**
- ▶ **Two Bathrooms (One Ensuite)**
- ▶ **Shared Courtyard**
- ▶ **Cat 6 Cabling**
- ▶ **Available for Occupation**
- ▶ **Newly Converted Three Bedroom Home**

Introducing a beautifully renovated property that blends the charm of a period home with all the advantages of a new build. Originally part of the historic Lloyds Bank building, this stunning conversion is located in the highly sought-after Old Town area of Midhurst. Lovingly restored by renowned local developer, Future Designer Homes, this house showcases a seamless blend of modern living and traditional character.

Retaining original features such as high ceilings and either restored or handcrafted timber windows, this home has been finished to an impeccable standard. It is ready for immediate occupation, offering all-new systems including central heating, plumbing, and wiring. The brand-new Shaker-style kitchen is equipped with integrated appliances, including an induction hob, oven, fridge/freezer, dishwasher, washer/dryer, and solid oak work surfaces. Additional features include CAT 6 cabling, new flooring throughout, and modern bathroom fittings, all backed by a 10-year Build Zone warranty for peace of mind.

The ground floor boasts a stunning kitchen with wide openings leading to the living room, along with a convenient cloakroom. Upstairs, you'll find three generously sized bedrooms, a luxurious family bathroom, and an en-suite to the main bedroom. Outside, a central courtyard shared by three of the four properties offers a low-maintenance outdoor space to enjoy.

This is a rare opportunity to own a unique and beautifully crafted home in a prime location.



APPROXIMATE GROSS INTERNAL AREA = 1176 SQ FT / 109.3 SQ M

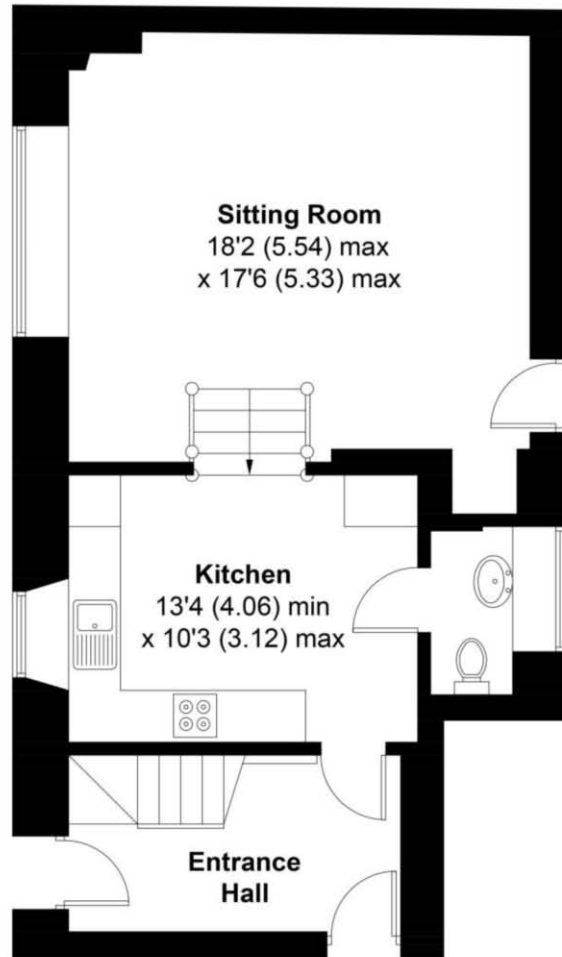

GROUND FLOOR

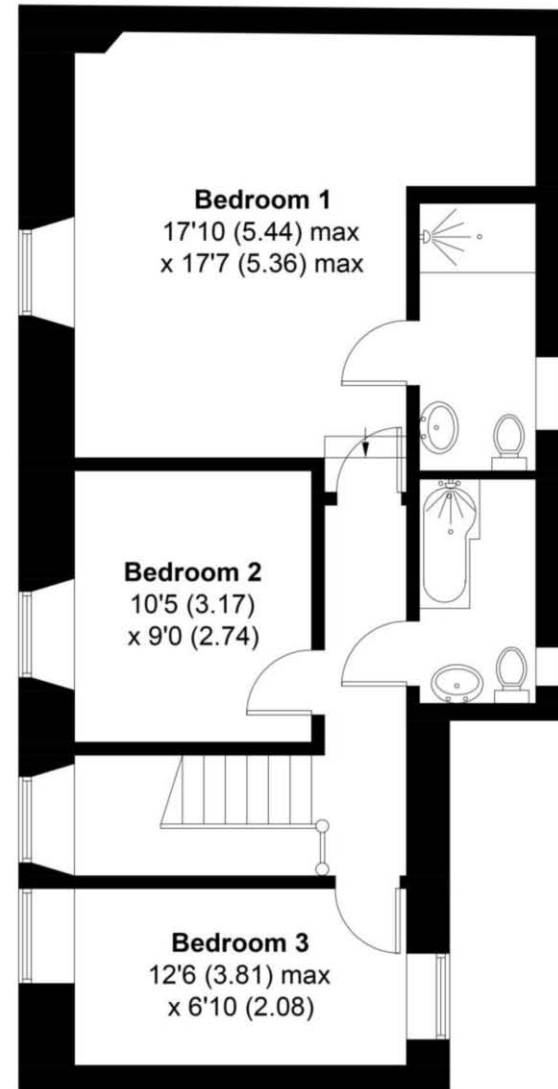

FIRST FLOOR

This plan is for layout guidance only. Not drawn to scale unless stated. Windows and door openings are approximate. Whilst every care is taken in the preparation of this plan, please check all dimensions, shapes and compass bearings before making any decisions reliant upon them. Created by Emzo Marketing (ID1047603)

Produced for Jackson - Stons

Agents Note - Our particulars are for guidance only and are intended to give a fair overall summary of the property. They do not form part of any contract or offer, and should not be relied upon as a statement or representation of fact. Measurements, areas and distances are approximate only. Photographs may include lifestyle shots and pictures of local views. No undertaking is given as to the structural condition of the property, or any necessary consents or the operating ability or efficiency of any service, system or appliance. Please ask if you would like further information, especially before you travel to the property.

Location and Amenities

The thriving town of Midhurst resides on the Surrey and Sussex border. Full of listed buildings, attractive shops and narrow lanes, it's also blessed with charming hotels and restaurants. There are also primary schools, an Academy College, leisure complex, medical centre, a library, Sainsburys and the Cowdray Park golf course. The town has previously been declared as one of the best places to live in the South East by a Sunday Times survey which was based on a number of criteria including lifestyle, crime rate, schooling and house prices.

Discover more extensive havens of choice in nearby Haslemere and Chichester, while neighbouring Petworth has a variety of shops and National Trust parkland. There are plenty of leisure pursuits from walking, cycling and horse riding in the National Park, to shooting and fishing in the historic Cowdray Park. Sailors and theatre-goers will love Chichester and for racing enthusiasts, glorious Goodwood is within a short drive too.

For more information on the town log on to the visitmidhurst.com website.

