



9 Park Crescent, Midhurst, West Sussex, GU29 9ED

A charming three bedroom semi-detached home which has been superbly renovated and extended in the centre of town.



- ▶ Immediate Exchange Of Contracts Available
- ▶ Town Centre Location
- ▶ Large Garden
- ▶ Three Bedrooms / Two Bathrooms
- ▶ Extended & Updated Throughout
- ▶ Sold Via Secure Sale
- ▶ Stunning Kitchen / Dining / Family Room
- ▶ Off-Road Parking
- ▶ No Onward Chain
- ▶ Bright and Airy Accommodation

Being sold via Secure Sale online bidding. Terms & Conditions apply. Starting Bids from £480,000. Introducing a meticulously renovated three-bedroom semi-detached haven, ideally situated just moments away from the vibrant pulse of town life yet offering serene seclusion. This charming residence boasts a seamless blend of traditional elegance and contemporary flair, promising a lifestyle of comfort and convenience.

Upon stepping through the threshold, you're greeted by the timeless allure of exposed floorboards and a captivating fireplace in the inviting sitting room, setting the tone for warmth and character. Beyond lies the heart of the home, a marvelously modernised kitchen/dining room adorned with sleek finishes and flooded with natural light. The kitchen, a culinary enthusiast's dream, showcases a central island brimming with storage options and features an 'Eco-Aga'. A rear extension orangery, adorned with bi-fold doors, beckons you to embrace alfresco living, seamlessly merging indoor and outdoor spaces. The ground floor further boasts a convenient boot room and a thoughtfully appointed shower room, ensuring practicality meets luxury at every turn. Ascend the staircase to discover a tranquil retreat comprising three generously proportioned bedrooms, comprising two ample doubles and a cosy single. A family bathroom, boasting a sumptuous bath and overhead shower, provides the perfect sanctuary for relaxation. Outside, a meticulously landscaped garden awaits with power points and lighting connected to the mains, enveloped by mature flower beds and offering a paved terrace ideal for hosting or unwinding.



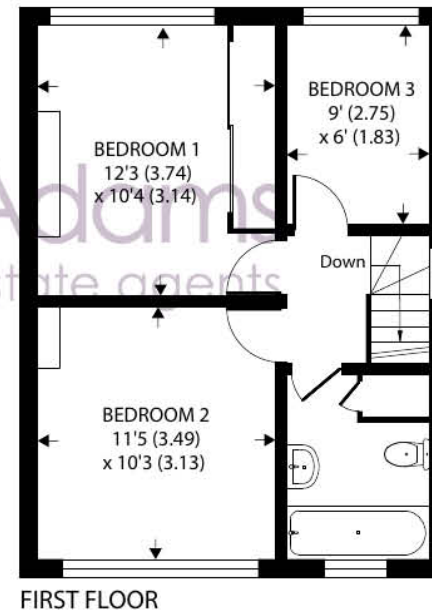
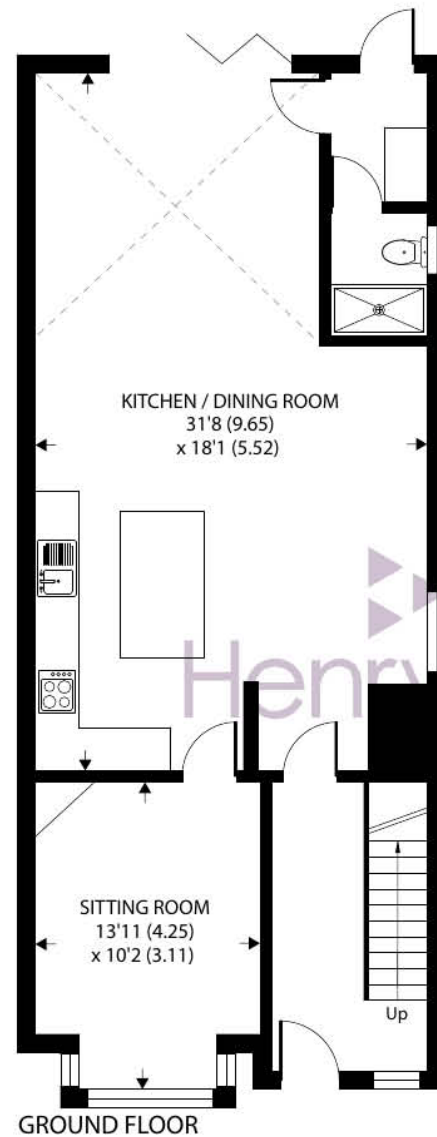

Park Crescent, Midhurst, GU29

Approximate Area = 1232 sq ft / 114.4 sq m

For identification only - Not to scale

Agents Note - Our particulars are for guidance only and are intended to give a fair overall summary of the property. They do not form part of any contract or offer, and should not be relied upon as a statement or representation of fact. Measurements, areas and distances are approximate only. Photographs may include lifestyle shots and pictures of local views. No undertaking is given as to the structural condition of the property, or any necessary consents or the operating ability or efficiency of any service, system or appliance. Please ask if you would like further information, especially before you travel to the property.

Location and Amenities

The thriving town of Midhurst resides on the Surrey and Sussex border. Full of listed buildings, attractive shops and narrow lanes, it's also blessed with charming hotels and restaurants. There are also primary schools, an Academy College, leisure complex, medical centre, a library, Sainsburys and the Cowdray Park golf course. The town has previously been declared as one of the best places to live in the South East by a Sunday Times survey which was based on a number of criteria including lifestyle, crime rate, schooling and house prices.

Discover more extensive havens of choice in nearby Haslemere and Chichester, while neighbouring Petworth has a variety of shops and National Trust parkland. There are plenty of leisure pursuits from walking, cycling and horse riding in the National Park, to shooting and fishing in the historic Cowdray Park. Sailors and theatre-goers will love Chichester and for racing enthusiasts, glorious Goodwood is within a short drive too.

For more information on the town log on to the visitmidhurst.com website.

