



ARGYLE STREET

Gorse Hill, Swindon, Wilts SN2 8BD

PRIMARY
HOMES & LETTINGS

Argyle Street, Gorse Hill, Swindon SN2 8BD

- AVAILABLE NOW
- First Floor Apartment
- Two Bedrooms
- Allocated Parking For Two Vehicles
- NEWLY DECORATED & NEW CARPETS
- Gas Central Heating
- White Goods Included
- Open Plan Lounge/Diner/Kitchen
- Bathroom
- Unfurnished

£900 PCM



***** AVAILABLE NOW ***** We are delighted to offer this **NEWLY DECORATED** two bedroom first floor flat located in Gorse Hill within walking distance to all local amenities, town centre and railway station. The accommodation comprises of open plan lounge/diner/kitchen, two bedrooms and bathroom. Property also benefits from gas central heating and two allocated parking spaces. Viewing is highly recommended.

Tenant Information

Length of Tenancy: Long term let with initial tenancy agreement of 6 months

Council: Swindon Borough Council

Tax Band: A

Viewings

Strictly via our Swindon office telephone (01793) 641641.

Sizes

Please note, all measurements of room sizes given are not guaranteed and figures are for guidance only.



FIRST FLOOR
456 sq.ft. (42.4 sq.m.) approx.

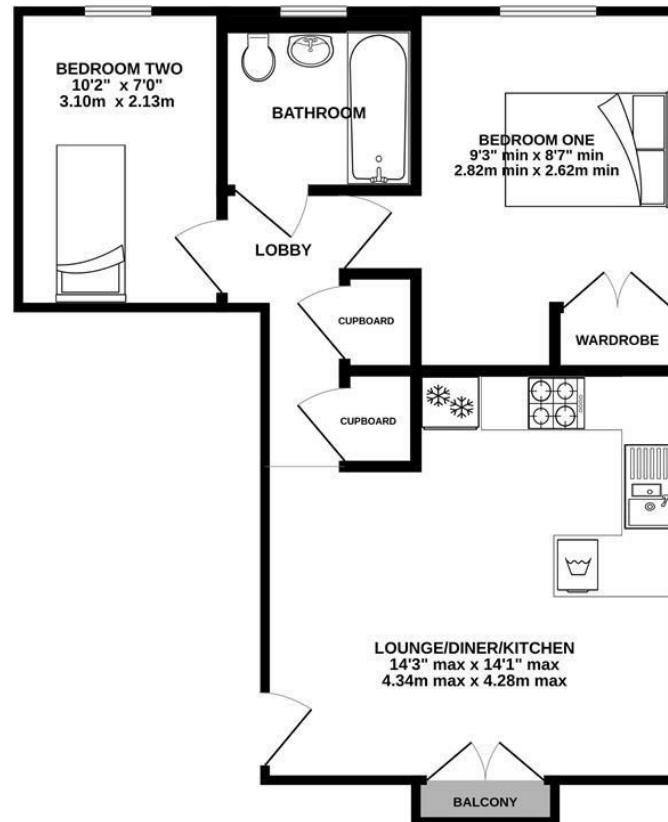

TOTAL FLOOR AREA : 456 sq.ft. (42.4 sq.m.) approx.

Whilst every attempt has been made to ensure the accuracy of the floorplan contained here, measurements of doors, windows, rooms and any other items are approximate and no responsibility is taken for any error, omission or mis-statement. This plan is for illustrative purposes only and should be used as such by any prospective purchaser. The services, systems and appliances shown have not been tested and no guarantee as to their operability or efficiency can be given.
Made with Metropix ©2025

01793 641641

101 Commercial Road, Swindon, SN1 5PL

info@primaryhomesandlettings.co.uk

PRIMARY
HOMES & LETTINGS