



GEORGE STREET

Rodbourn, Swindon, Wiltshire SN1 5HE

PRIMARY
HOMES & LETTINGS

George Street, Rodbourne, Swindon SN1 5HE

- AVAILABLE FROM 01.09.25
- Mid Terrace House
- Two DOUBLE Bedrooms
- Well Presented
- Gas Central Heating
- Modern Kitchen
- Low Maintenance Rear Garden
- Lean To/Utility Room
- No Pets
- Good Location

£1,100 PCM



We are pleased to offer this well presented two DOUBLE bedroom mid terrace house being offered unfurnished. The accommodation comprises of entrance porch, living room, dining area, kitchen, bathroom, lean to/utility and two bedrooms. Property also benefits from an enclosed rear garden and gas central heating. Located in the popular area of Rodbourne within walking distance to The Designer Outlet Village, town centre and railway station. An early viewing is highly recommended.

Tenant Information

Length of Tenancy: Long term let with initial tenancy agreement of 6 months

Council: Swindon Borough Council

Tax Band: B

Viewings

Strictly via our Swindon office telephone (01793) 641641.

Sizes

Please note, all measurements of room sizes given are not guaranteed and figures are for guidance only.

Photographs

Please note that photos were taken prior to the current tenants moving into the property.



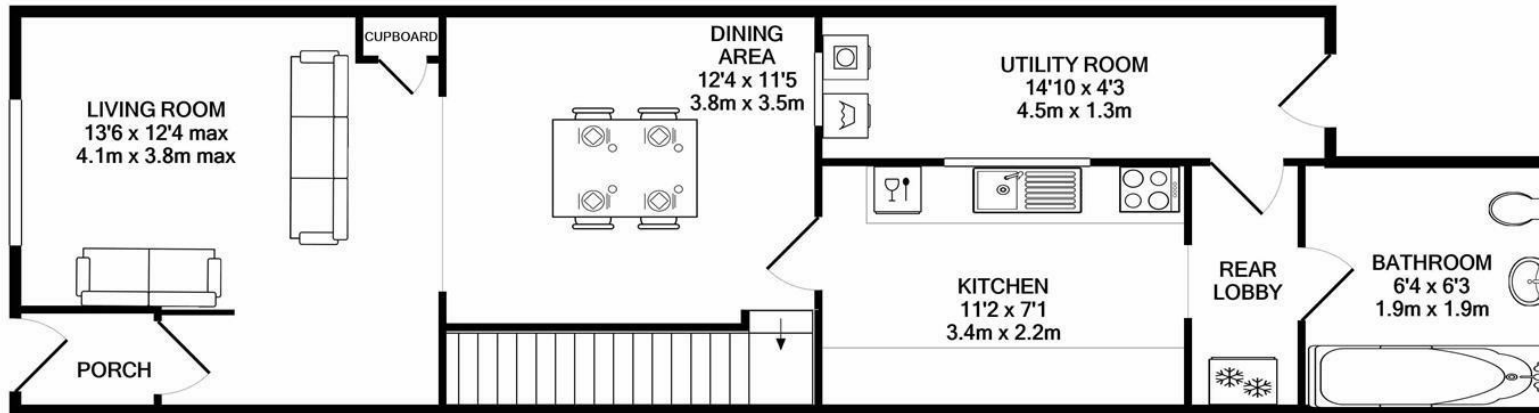

GROUND FLOOR

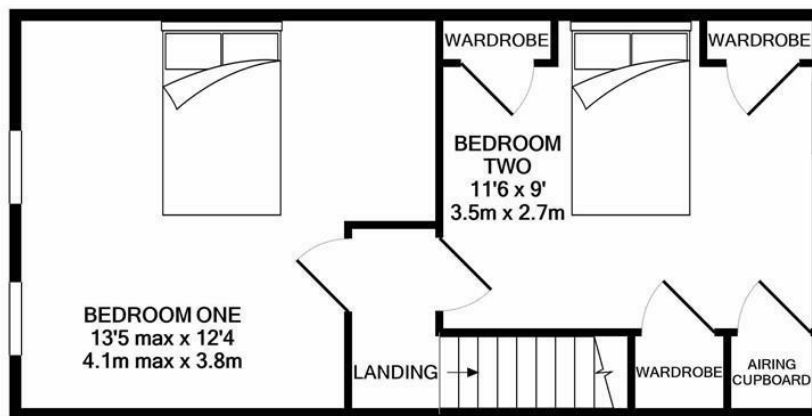

1ST FLOOR

FOR ILLUSTRATION ONLY

Whilst every attempt has been made to ensure the accuracy of the floor plan contained here, measurements of doors, windows, rooms and any other items are approximate and no responsibility is taken for any error, omission, or mis-statement. This plan is for illustrative purposes only and should be used as such by any prospective purchaser. The services, systems and appliances shown have not been tested and no guarantee as to their operability or efficiency can be given.
Made with Metropix ©2021

01793 641641

10 Commercial Road, Swindon, SN1 5PL

info@primaryhomesandlettings.co.uk

