



112 Queen Elizabeth Drive, Taw Hill, Swindon, SN25 1XA

- AVAILABLE FROM 09.08.24
- Three Storey Town House
- Three Bedrooms
- Master Bedroom With En-Suite & Dressing Area
- Lounge/Diner & Kitchen
- Family Bathroom & Cloakroom
- Garage & Off Road Parking
- Low Maintenance Rear Garden
- NO PETS
- Excellent Location

£1,350 PCM



We are pleased to offer this spacious, three bedroom, three storey town house located in the popular area of Taw Hill, North Swindon. Within walking distance to all local amenities, schools and easy access to the Orbital shopping centre and A419. The ground floor briefly comprises of entrance hallway, cloakroom, kitchen and lounge/diner. To the first floor are bedrooms two and three and family bathroom. The master bedroom with dressing room and en-suite are located on the second floor. Property also benefits from uPVC double glazing, gas central heating, enclosed rear garden, garage and off road parking. Viewing is highly recommended.

EPC Rating

C

Tenant Information

Length of Tenancy: Long term let with initial tenancy agreement of 6 months

Council: Swindon Borough Council

Tax Band: D

Photographs

Please note that photos were taken prior to the current tenants moving into the property.

Viewings

Strictly via our Swindon office telephone (01793) 641641.



PRIMARY HOMES & LETTINGS

Tel: 01793 641 641

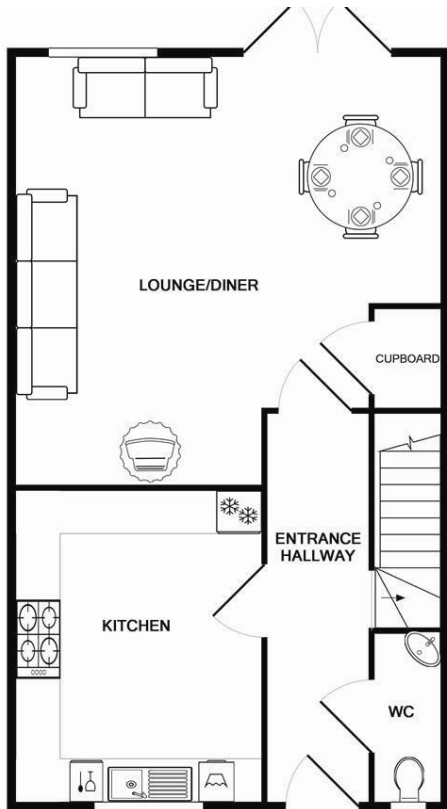

GROUND FLOOR

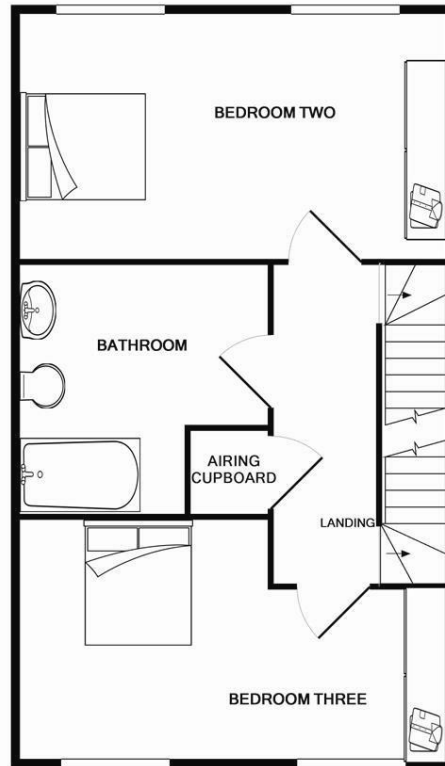

1ST FLOOR

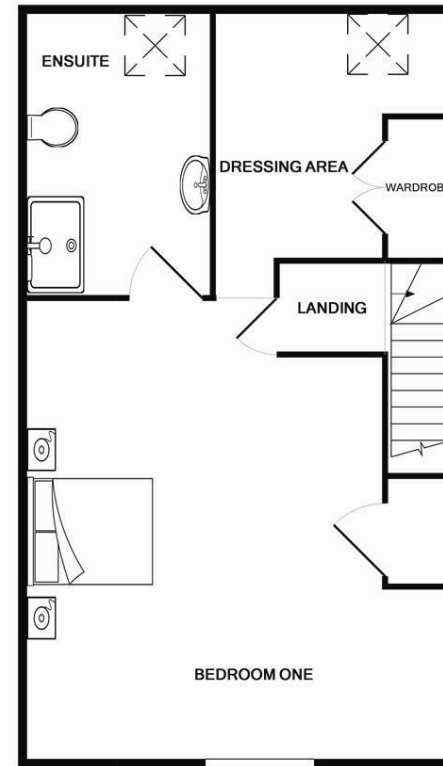

2ND FLOOR

FOR ILLUSTRATION ONLY

Whilst every attempt has been made to ensure the accuracy of the floor plan contained here, measurements of doors, windows, rooms and any other items are approximate and no responsibility is taken for any error, omission, or mis-statement. This plan is for illustrative purposes only and should be used as such by any prospective purchaser. The services, systems and appliances shown have not been tested and no guarantee as to their operability or efficiency can be given.

Made with Metropix ©2015

101 Commercial Road, Swindon, SN1 5PL
 Tel: 01793 641641 Fax: 01793 618127
 Email: info@primaryhomesandlettings.co.uk
www.primaryhomesandlettings.co.uk