



Mount Pleasant
Cockfosters, Barnet, EN4 9HQ
Guide Price £875,000



Mount Pleasant

Cockfosters, Barnet, EN4 9HQ

SEMI-DETACHED FAMILY HOME offering SCOPE FOR IMPROVEMENT (stpp). Situated in this extremely DESIRABLE RESIDENTIAL LOCATION within short walking distance to COCKFOSTERS UNDERGROUND (Piccadilly Line) and close proximity to multiple cafes, restaurants and boutiques on the bustling High Street.

The 1950's FOUR BEDROOM residence is IDEAL FOR FAMILY LIVING and the current owners have developed the property well to create considerable versatile accommodation. The EXTENSIVE GROUND FLOOR SPACE includes entrance hall, large reception with bay window through to dining area and connecting living/study area, kitchen/ breakfast room. A generous ground floor bedroom, GUEST CLOAKROOM and study space opens onto landscaped 75ft rear garden and patio terrace. Bright and spacious, with skylights and natural light flowing throughout. The first floor offers a further three bedrooms and a CONTEMPORARY FAMILY BATHROOM.

The property benefits further from a block-paved front DRIVEWAY, providing OFF STREET PARKING for two cars, front garden, garden shed and utility area. With JCoSS Secondary school and Trent Church of England Primary school being 10 mins walk to facilitate catchment criteria.

EPC : D

BARNET COUNCIL TAX BAND : F

TENURE : Freehold





GROUND FLOOR

Entrance Hallway

Reception Room

13'11 x 12'11 (4.24m x 3.94m)

Dining Room

11'0 x 9'10 (3.35m x 3.00m)

Living Area

9'9 x 9'1 (2.97m x 2.77m)

Kitchen/Breakfast Room

11'0 x 9'2 (3.35m x 2.79m)

Utility Area

9'2 x 8'6 (2.79m x 2.59m)

Guest Cloakroom

Bedroom Four

16'8 x 7'7 (5.08m x 2.31m)

FIRST FLOOR

Landing

Bedroom One

14'4 x 10'11 (4.37m x 3.33m)

Bedroom Two

10'6 x 10'1 (3.20m x 3.07m)

Bedroom Three

8'1 x 8'1 (2.46m x 2.46m)

Family Bathroom

8'4 x 7'1 (2.54m x 2.16m)



Floor Plan

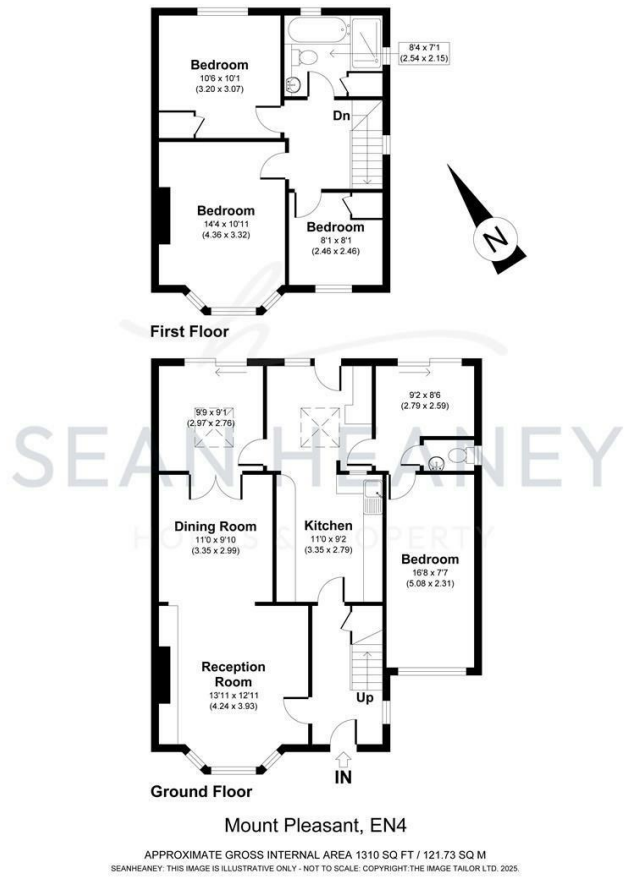

Viewing

Please contact our Barnet Office on 020 8441 7173 if you wish to arrange a viewing appointment for this property or require further information.

1. Please note that we have not tested any apparatus, equipment, fixtures, fittings or services, and so cannot verify they are in working order, or fit for their purpose. A buyer is advised to obtain verification from their Solicitor or Surveyor.
2. References to the tenure of a property are based on information supplied by the seller. The agent has not had sight of the title documents. A buyer is advised to obtain verification from their Solicitor.
3. Room measurements have been made using a Laser Meter. Complete accuracy cannot be guaranteed and therefore the room sizes given should be regarded as being approximate.
4. Photographs are for illustration only and may depict items which are not for sale or included in the sale of the property.
5. Floor plans remain copyright of Sean Heaney Estate Agents and are not to be copied in part or full without written consent, are provided for illustrative purposes only and are not to scale.

Area Map

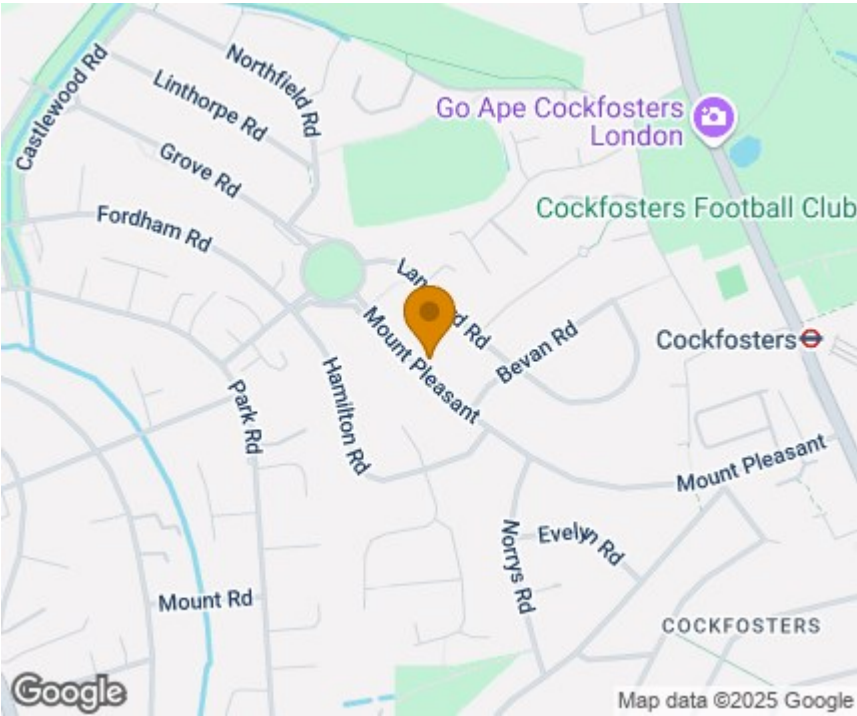

Energy Efficiency Graph

