

Clifton Court
Hemel Hempstead HP3 9XY
£1,225 PCM

- Communal Sky dish
- Underfloor Heating
- Allocated Parking Space
- Passenger Lift
- Fully Furnished
- One bedroom
- Close to Station & Town Centre
- Available from 01/07/25
- EPC - B
- Council tax - B



67 Marlowes
Hemel Hempstead
Hertfordshire
HP1 1LE

01442 233533

homes@squireestates.co.uk

squireestates.co.uk

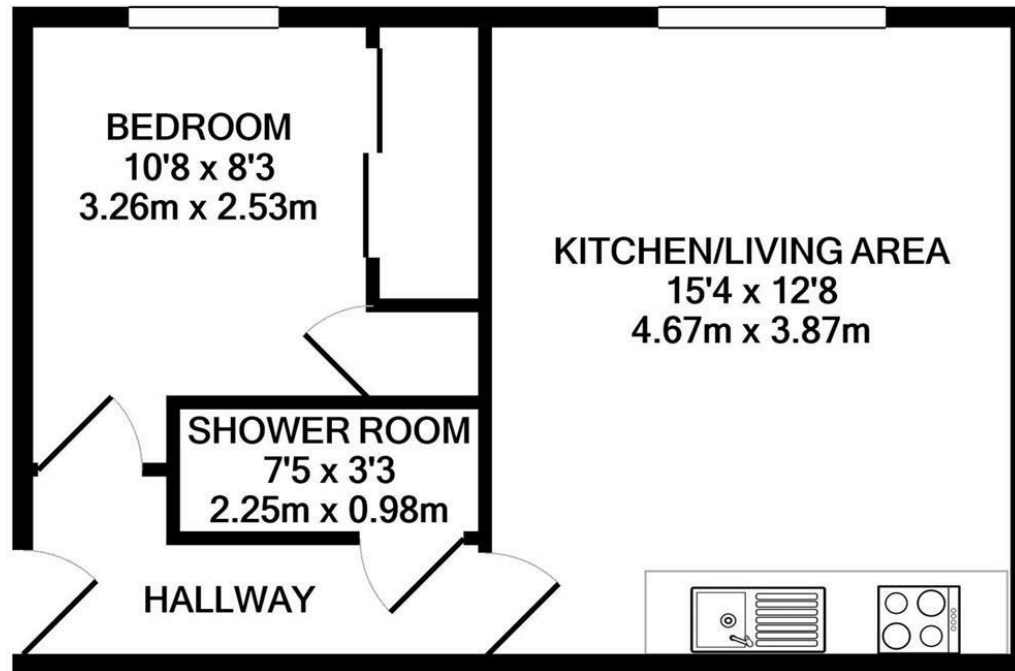

TOTAL APPROX. FLOOR AREA 355 SQ.FT. (33.0 SQ.M.)

Whilst every attempt has been made to ensure the accuracy of the floor plan contained here, measurements of doors, windows, rooms and any other items are approximate and no responsibility is taken for any error, omission, or mis-statement. This plan is for illustrative purposes only and should be used as such by any prospective purchaser. The services, systems and appliances shown have not been tested and no guarantee as to their operability or efficiency can be given

Made with Metropix ©2020