

HUNTERS[®]

HERE TO GET *you* THERE



The Fairway

Gravesend, DA11 7LN

£1,750 Per Month

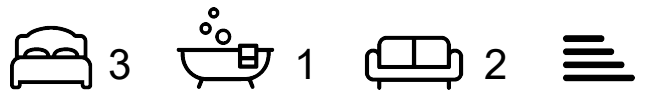

A well presented and spacious three bedroom bay fronted end of terrace house situated in a sought after location, comprising of two separate reception rooms with a door from the dining room opening onto the rear garden. Fitted kitchen with built in oven and hob, door leading to a lean to providing plumbing for a washing machine and a first floor family bathroom with separate W.C. Enclosed rear garden leading to a garage to the rear with side door access. Situated within close proximity to Gravesend town centre and railway station, within easy reach of motorway connections. AVAILABLE NOW



Area Map



Floor Plans

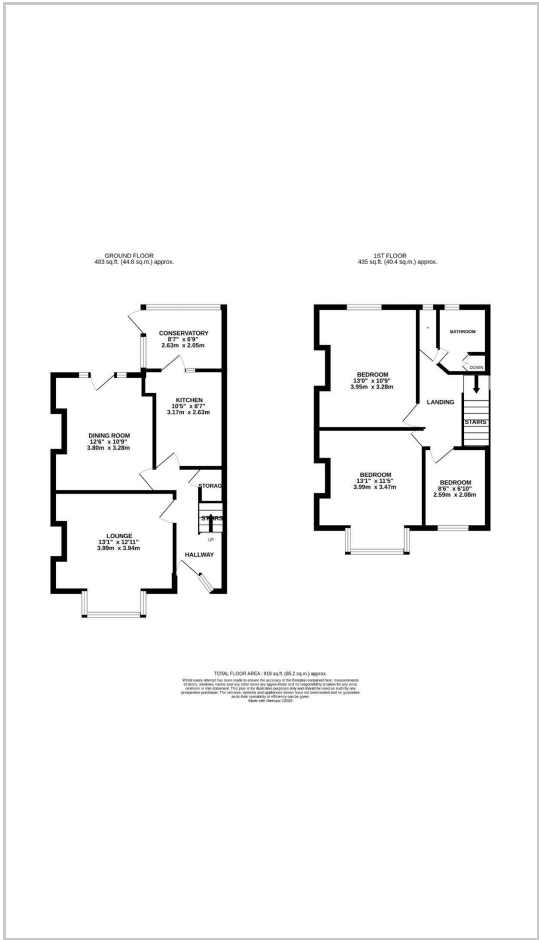

Energy Efficiency Graph



These particulars are intended to give a fair and reliable description of the property but no responsibility for any inaccuracy or error can be accepted and do not constitute an offer or contract. We have not tested any services or appliances (including central heating if fitted) referred to in these particulars and the purchasers are advised to satisfy themselves as to the working order and condition. If a property is unoccupied at any time there may be reconnection charges for any switched off/disconnected or drained services or appliances - All measurements are approximate.

THINKING OF SELLING? If you are thinking of selling your home or just curious to discover the value of your property, Hunters would be pleased to provide free, no obligation sales and marketing advice. Even if your home is outside the area covered by our local offices we can arrange a Market Appraisal through our national network of Hunters estate agents.