

HUNTERS®

HERE TO GET *you* THERE

40 Maritime Gate, Gravesend, DA11 9EB

Asking Price £300,000

Property Images



HUNTERS®

HERE TO GET *you* THERE

GROUND FLOOR
317 sq.ft. (29.4 sq.m.) approx.

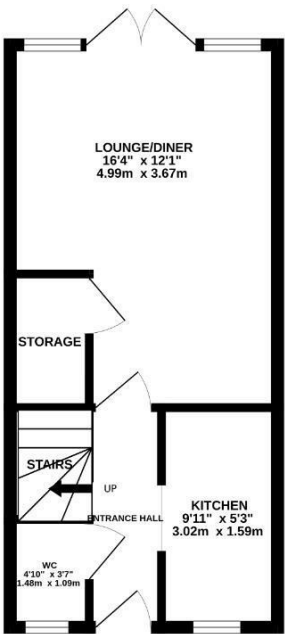

1ST FLOOR
317 sq.ft. (29.4 sq.m.) approx.

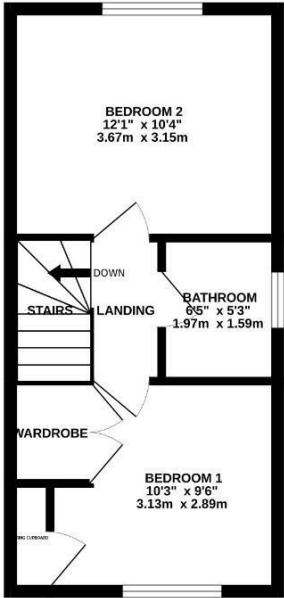

MARITIME GATE, GRAVESEND, DA11

TOTAL FLOOR AREA: 633 sq.ft. (58.8 sq.m.) approx.

While every attempt has been made to ensure the accuracy of the floorplan contained here, measurements of doors, windows, rooms and any other items are approximate and no responsibility is taken for any error, omission or mis-statement. This plan is for illustrative purposes only and should be used as such by any prospective purchaser. The services, systems and appliances shown have not been tested and no guarantee as to their possibility of efficiency can be given.

Made with Metropix 1/2025

EPC

Energy Efficiency Rating		
	Current	Potential
Very energy efficient - lower running costs		
(92 plus) A		89
(81-91) B		
(69-80) C	73	
(55-68) D		
(39-54) E		
(21-38) F		
(1-20) G		
Not energy efficient - higher running costs		
England & Wales		EU Directive 2002/91/EC

Map

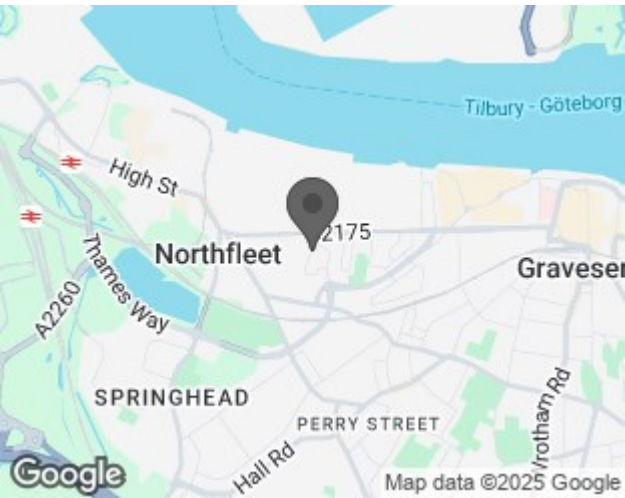

Details

Type: House Beds: 2 Bathrooms: 1 Receptions: 1 Tenure: Freehold

Hunters Gravesend are now marketing this two bedroom, semi-detached property on the popular Maritime Gate, Northfleet.

This home consists of entrance hall, kitchen, lounge, downstairs WC, two double bedrooms and family bathroom and comes with the added bonus of No Forward Chain.

There is a garden to the rear with side access as well as door access to the garage which can be used for either a car or storage.

Parking is available as there is as driveway for the property for two cars.

Please call now to arrange your viewing.

Features

• SEMI-DETACHED • TWO BEDROOMS • NO FORWARD CHAIN • DRIVEWAY • GARAGE • MODERNISATION REQUIRED • EPC RATING- C