

HUNTERS[®]

HERE TO GET *you* THERE

Apartment 1, Monmouth Court Romulus Road, Gravesend, DA12 2SG
Offers In The Region Of £170,000

Property Images



HUNTERS®

HERE TO GET *you* THERE

GROUND FLOOR
441 sq.ft. (41.0 sq.m.) approx.

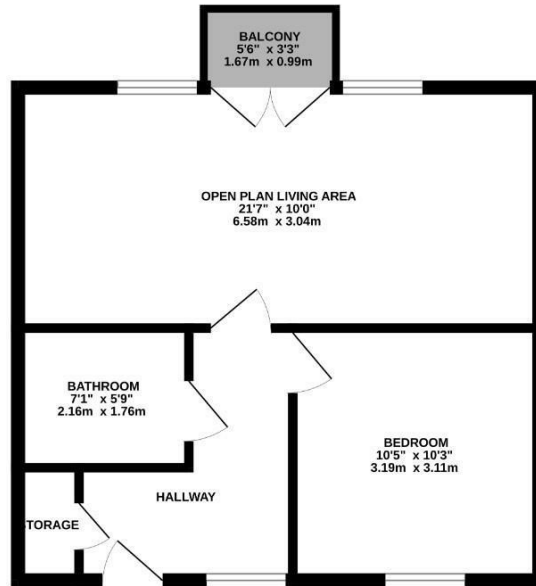

1 MONMOUTH COURT

TOTAL FLOOR AREA: 441 sq.ft. (41.0 sq.m.) approx.
While every attempt has been made to ensure the accuracy of the description contained herein, measurements of spaces, windows, rooms and any other items are approximate and no responsibility is taken for any error, omission or misstatement. This plan is for illustrative purposes only and should be used as such by any prospective purchaser. The services, systems and appliances shown have not been tested and no guarantee is given as to their operability or efficiency over the given.
Made with Metrage 02/2024

EPC

Energy Efficiency Rating		Current	Potential
<i>Very energy efficient - lower running costs</i>			
(92 plus) A			
(81-91) B		78	79
(69-80) C			
(55-68) D			
(39-54) E			
(21-38) F			
(1-20) G			
<i>Not energy efficient - higher running costs</i>			
England & Wales	EU Directive 2002/91/EC		

Map



Details

Type: Flat - Purpose Built Beds: 1 Bathrooms: 1 Receptions: 1 Tenure: Leasehold

Summary

We are pleased to offer for sale with NO FORWARD CHAIN this one bedroom TOP FLOOR flat situated on Romulus Road. It is conveniently located within walking distance to Gravesend Town Centre where you'll find shops and amenities as well as Gravesend Mainline Railway Station offering services into London.

Benefits include a spacious entrance hall, good size open plan living/kitchen area, bedroom, bathroom, storage cupboard, balcony and has the added bonus of one allocated parking space.

This would make an ideal first time purchase or investment opportunity for any prospective buyer, so call now to arrange an immediate viewing!

Features

- OPEN PLAN LIVING AREA • ONE BEDROOM • BATHROOM • ONE ALLOCATED PARKING SPACE • BALCONY • CLOSE TO TOWN CENTRE • CHAIN FREE • IDEAL FIRST TIME PURCHASE • TOP FLOOR • EPC RATING C