

HUNTERS®

HERE TO GET *you* THERE

10 Lydia Cottages, Wrotham Road, Gravesend, Kent, DA11 0QE

Offers Over £260,000

Property Images



HUNTERS®

HERE TO GET *you* THERE

GROUND FLOOR
354 sq.ft. (32.9 sq.m.) approx.

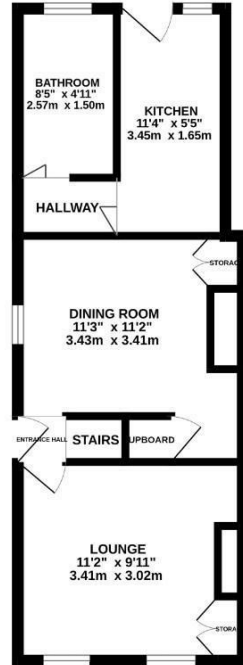

1ST FLOOR
237 sq.ft. (22.0 sq.m.) approx.

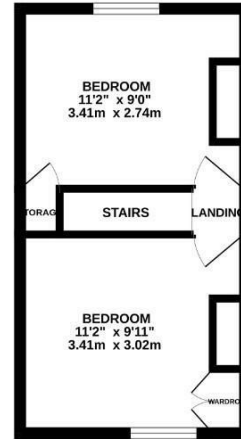

TOTAL FLOOR AREA: 591 sq.ft. (54.9 sq.m.) approx.

Whilst every attempt has been made to ensure the accuracy of the floorplan contained here, measurements of doors, windows, rooms and any other items are approximate and no responsibility is taken for any error, omission or mis-statement. This plan is for illustrative purposes only and should be used as such by any prospective purchaser. The services, systems and appliances shown have not been tested and no guarantee as to their operability or efficiency can be given.
Made with floorplan 03/24

EPC

Energy Efficiency Rating		Current	Potential
<i>Very energy efficient - lower running costs</i>			
(92 plus) A			
(81-91) B			
(69-80) C			
(55-68) D			
(39-54) E			
(21-38) F			
(1-20) G			
<i>Not energy efficient - higher running costs</i>			
England & Wales	EU Directive 2002/91/EC		

Map

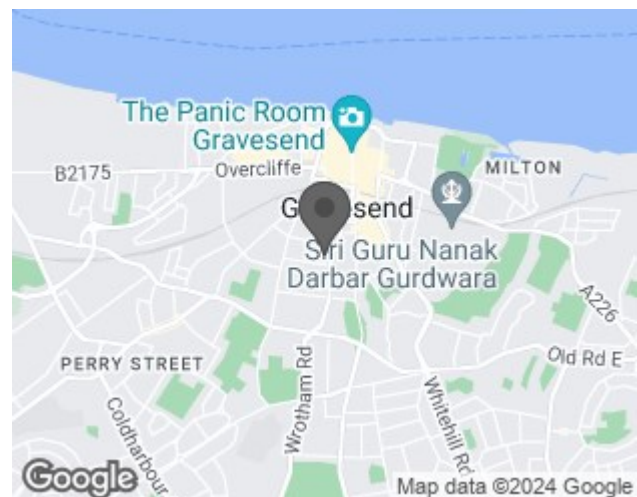

Details

Type: House - Terraced Beds: 2 Bathrooms: 1 Receptions: 2 Tenure: Freehold

Summary

Attention First-time buyers and investors!

Hunters Gravesend are now marketing a two bedroom, end of terrace home in a private courtyard location close to Gravesend town centre.

Property comprises of lounge, dining room, kitchen and downstairs bathroom, with two double bedrooms on the first floor.

There is a small garden to the rear which can be accessed via side gate, as well as from the kitchen.

This property is a great opportunity for investment or as a first time purchase and comes with the bonus of No Forward Chain so call now to avoid missing out!

Features

- TWO BEDROOMS • NO FORWARD CHAIN • LOUNGE • DINING ROOM • DOWNSTAIRS BATHROOM • CLOSE TO TOWN CENTRE • GATED ENTRANCE • EPC RATING TO FOLLOW