



FOR SALE

Chaffinch Close, Chatham, ME5
£165,000

Entry
3'1" x 5'2"
0.95 x 1.58 m



Living Room
8'11" x 13'6"
2.72 x 4.12 m

Kitchen
7'10" x 5'11"
2.39 x 1.82 m

Floor 0

Approximate total area⁽¹⁾

437.16 ft²

40.61 m²

Reduced headroom

20.03 ft²

1.86 m²

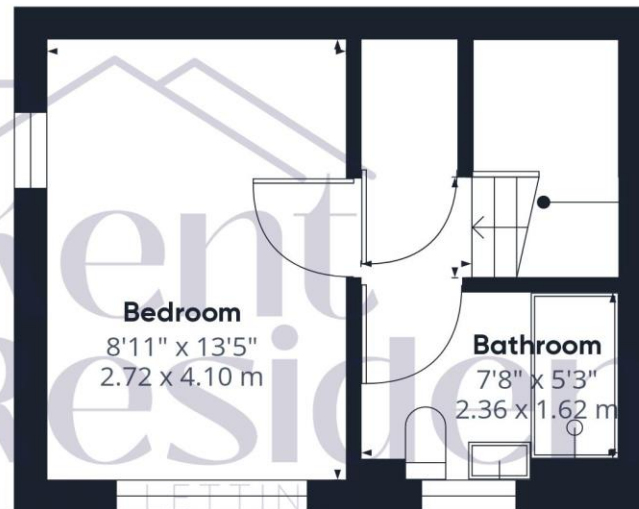

Bedroom
8'11" x 13'5"
2.72 x 4.10 m

Bathroom
7'8" x 5'3"
2.36 x 1.62 m

Landing
3'3" x 3'1"
1.01 x 0.95 m

Floor 1

(1) Excluding balconies and terraces

⊞ Reduced headroom
(below 1.5m/4.92ft)

While every attempt has been made to ensure accuracy, all measurements are approximate, not to scale. This floor plan is for illustrative purposes only.

GIRAFFE360

Property Description	Key Features	Room Dimensions
<p>A fantastic investment property being sold with tenants in situ providing a yield of 6%. 1 Bedroom house with garden located in the popular residential area of Princes Park, Chatham.</p> <p>This one bedroom home consists of a small entrance hallway perfect for hanging coats and storing shoes. Leading into the Lounge, there are sliding double doors to the enclosed patio garden. There is a kitchen complete with electric oven and hob. Up the spiral stairs leads to the shower room and double bedroom with storage cupboard. There is also an allocated parking space.</p> <p>Conveniently located in the Princes Park area of Chatham being a short distance from a choice of local amenities. Chatham town centre has a variety of shops, pubs and restaurants including the Pentagon Shopping Centre. Close by is the Dockside Retail outlet located within the Historical Chatham Dockyard. A wide variety of shops complimented with restaurants, bars, gym and a multiplex cinema. Local train services in Chatham are operated by Southeastern rail. Services operate to London Victoria in 49 minutes and London St Pancras in 40 Minutes.</p> <p>Freehold EPC – C Council Tax Band - B</p>	<ul style="list-style-type: none"> ● SOLD WITH TENANT IN SITU ● 6% RENTAL YIELD ● FREEHOLD ● 1 BEDROOM HOUSE ● ENCLOSED PATIO GARDEN ● ALLOCATED PARKING SPACE ● EPC RATING - C 	<p>As per floorplan</p>

