

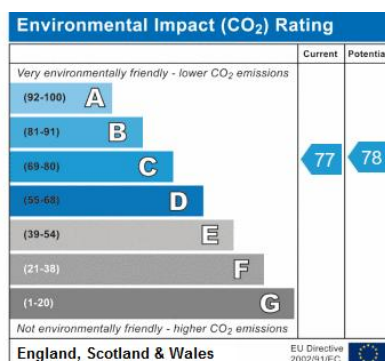

Baillie Street, Fulwood, Preston, PR2 9LT

Price: £125,000

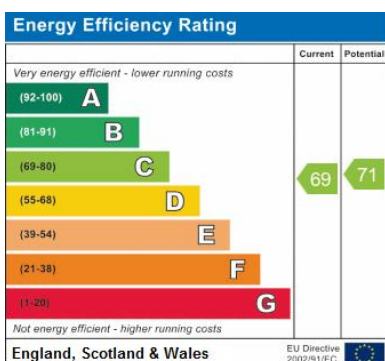

- Sought After Position of Fulwood
- Modern Development
- Spacious Apartment
- NO CHAIN
- Allocated Parking
- Convenient for Motorway & Royal Preston
- Ideal First Time Buy
- Double Glazing

Baillie Street, Fulwood, Preston

Situated in a sought after modern development of Fulwood, convenient for ROYAL PRESTON HOSPITAL & MOTORWAY LINKS is this executive two bedroom apartment offering NO CHAIN. Briefly comprises; communal hallway, hallway, two double bedrooms, bathroom, lounge & kitchen. Early viewing is highly recommended.

COMMUNAL HALLWAY

HALLWAY

Large storage cupboard. Alarm panel & intercom. Central heating radiator. Double glazed window.

BEDROOM ONE

16' 0" x 8' 7" (4.90m x 2.64m)

Central heating radiator. Two double glazed windows.

BEDROOM TWO

13' 5" x 8' 8" (4.10m x 2.65m)

Central heating radiator. Double glazed window.

BATHROOM

Panelled bath. Shower cubicle. Half tiled walls. Low flush W.C. Pedestal wash hand basin. Shaving point. Central heating radiator.

LOUNGE

16' 6" x 12' 5" (5.05m x 3.80m)

Two central heating radiators. Two double glazed windows.

KITCHEN

8' 9" x 6' 8" (2.69m x 2.04m)

Fitted wall and base units. Stainless steel sink unit with mixer tap and drainer. Cupboard housing boiler. Electric oven. Four ring gas hob with extractor overhead. Tiled splash backs. Central heating radiator. Double glazed window.

COMMUNAL GARDENS & PARKING

TENURE

The property is **Leasehold**

COUNCIL TAX

Band "B"

The average council tax charges for April 2010 - March 2013 are listed below, based on a household of two adults. The tax bands are based on the value of your property in 1991.

Valuation Band	Council Tax 2017/18	Council Tax 2018/19	Council Tax 2019/20
A	£1104.47	£1170.70	£1218.16
B	£1288.54	£1365.82	£1421.19
C	£1472.62	£1560.93	£1624.21
D	£1656.70	£1756.05	£1827.24
E	£2024.86	£2146.28	£2233.29
F	£2393.01	£2536.52	£2639.35
G	£2761.17	£2926.75	£3045.40
H	£3313.40	£3512.10	£3654.48



Baillie Street, Fulwood, Preston

Ground Floor

Approx. 66.8 sq. metres (719.0 sq. feet)

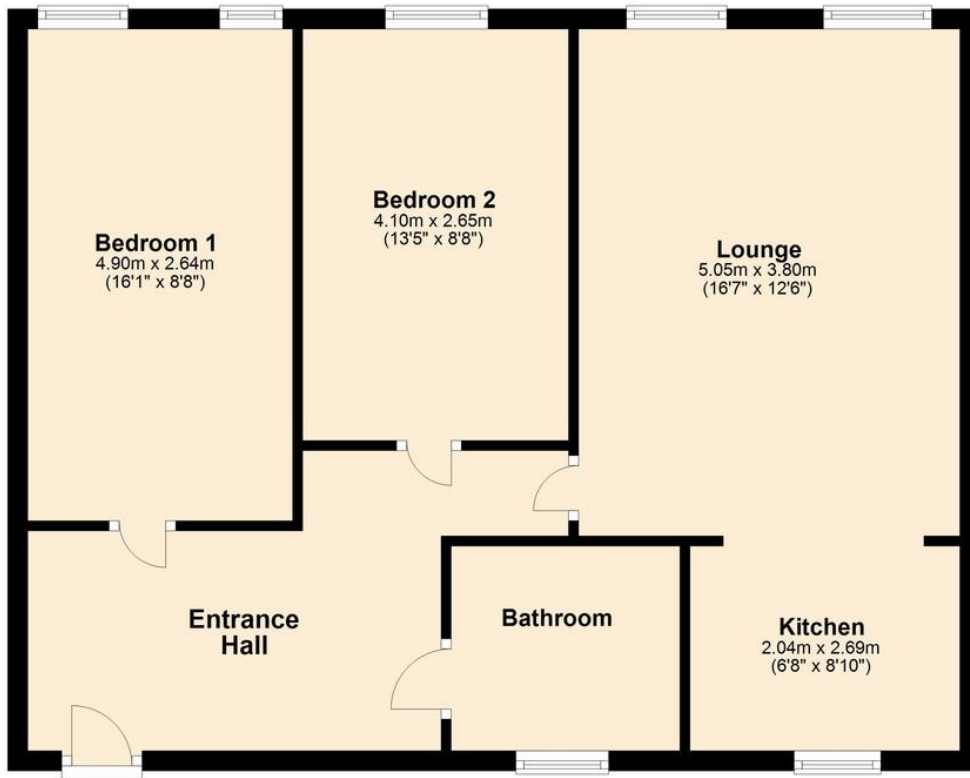

Total area: approx. 66.8 sq. metres (719.0 sq. feet)

16 Baillie Street, Fulwood