



**De Lacy Street, Ashton-on-ribble, Preston, PR2 2AP**

**Starting Bid £85,000**

- For Sale by Online Auction
- Spacious Living Accommodation
- Two Reception Rooms
- Rear Patio Garden with Outhouse
- Convenient Location
- Large Bathroom
- Located Close to Local Amenities
- No Chain!

**To view all of our properties visit [www.tigerestates.co.uk](http://www.tigerestates.co.uk)**

# De Lacy Street, Ashton-on-ribble, Preston

For Sale by Online Auction with a Starting Bid of £85,000. Terms & Conditions Apply. See WebbMove for all of the Auction Details.

This family sized three-bedroom mid terraced house comprises entrance hallway, two reception rooms, fitted kitchen, rear flagged patio garden with outhouse, three bedrooms and a family bathroom. The home has double glazing, requires some modernization and has been priced accordingly. No Chain!

## ENTRANCE VESTIBULE

## ENTRANCE HALL

## LOUNGE

Double glazed window. Gas fire. Folding doors to dining room.

## DINING ROOM

Gas fire. Double glazed window. Built in under stairs storage cupboard.

## KITCHEN

Fitted wall and base units. Plumbed for washing machine. Stainless steel sink unit and mixer tap. Part tiled.

## STAIRS AND LANDING

## BEDROOM

Double glazed window.

## BEDROOM

Double glazed window.

## BEDROOM

Double glazed window.

## BATHROOM

Bath. WC. Pedestal hand basin. Part tiled. Double glazed window.

## GARDENS

Flagged to rear with an outhouse utility room with power and lighting.

## TENURE

The property is **Freehold**

## COUNCIL TAX

Band "A"



# De Lacy Street, Ashton-on-ribble, Preston

## PLEASE NOTE

These particulars are believed to be correct but in no way is their accuracy guaranteed and they do not form part of any contract and neither do Tiger Sales & Lettings or the vendors accept any responsibility in respect of these particulars and any prospective purchaser must satisfy themselves by inspection or otherwise as to their accuracy. All measurements are approximate and for illustrative purposes only. Floor Plans are included as a service to our customers and is intended as a GUIDE TO LAYOUT ONLY. Digital images are reproduced for general information only and must not be inferred that any item shown is included for sale with the property. We have been unable to confirm if services / items in the property are in full working order. The property is offered for sale on this basis. Prospective purchasers are advised to seek expert advice where appropriate. We are only verbally informed by the vendor of the stated tenure details, therefore we advise any prospective purchaser to confirm the tenure details with their solicitor / legal representative.

29/07/2024

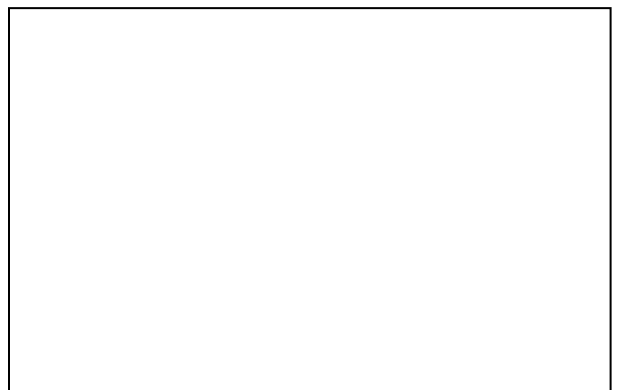

# De Lacy Street, Ashton-on-ribble, Preston

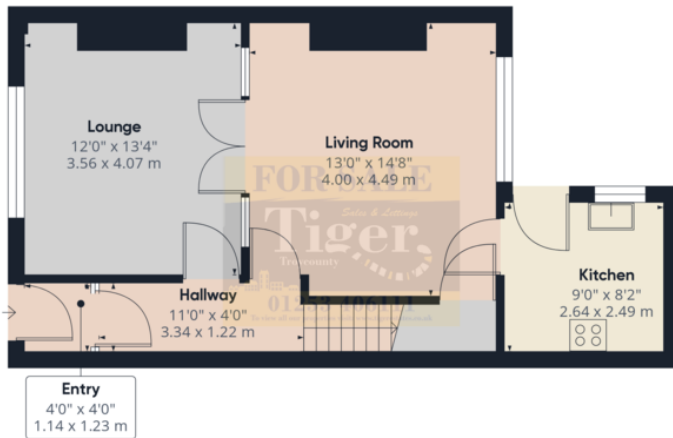

Ground Floor

Approximate total area<sup>(1)</sup>  
969.94 ft<sup>2</sup>  
90.11 m<sup>2</sup>



Floor 1

(1) Excluding balconies and terraces

While every attempt has been made to ensure accuracy, all measurements are approximate, not to scale. This floor plan is for illustrative purposes only.

GIRAFFE 360