



Lonsdale Road, Blackpool, FY1 6EE

Starting Bid £35,000

Energy Efficiency Rating		
	Current	Potential
<i>Very energy efficient - lower running costs</i>		
(92+) A		
(81-91) B		
(69-80) C		
(55-68) D		68
(39-54) E		
(21-38) F	29	
(1-20) G		
<i>Not energy efficient - higher running costs</i>		
England & Wales	EU Directive 2002/91/EC	

- For Sale by Online Auction
- Two Bedroom Residential Ground Floor Flat
- Close To Blackpool Town Centre
- Garage To the Rear
- Could Be an Ideal Buy to Let
- 360 Virtual Tour Available
-
-

Lonsdale Road, Blackpool

For Sale by Online Auction with a Starting Bid of £40,000. T&Cs Apply. See WebbMove for all the auction details. Tiger Estates Introduce This Two Bedroom Residential Ground Floor Flat with Garage to The Rear. Could Be an Ideal Buy to Let Investment Due to It's Ideal Location Close to The Popular Blackpool Promenade. For Your Viewing Or For More Information Call Tiger Estates Today Or Visit Our 360 Virtual Tour For A Closer Look.

BEDROOM

16' 6" x 12' 5" (5.03m x 3.78m)

SHOWER ROOM

5' 4" x 4' 11" (1.63m x 1.5m)

BEDROOM

12' 2" x 10' 9" (3.71m x 3.28m)

KITCHEN

16' 8" x 5' 9" (5.08m x 1.75m)

LIVING ROOM

11' 3" x 9' 4" (3.43m x 2.84m)

BATHROOM

6' x 6' 11" (1.83m x 2.11m)

TENURE

The property is **Leasehold**

COUNCIL TAX

Band "A"

The average council tax charges for April 2010 - March 2013 are listed below, based on a household of two adults. The tax bands are based on the value of your property in 1991.

Valuation Band	Council Tax 2017/18	Council Tax 2018/19	Council Tax 2019/20
A	£1104.47	£1170.70	£1218.16
B	£1288.54	£1365.82	£1421.19
C	£1472.62	£1560.93	£1624.21
D	£1656.70	£1756.05	£1827.24
E	£2024.86	£2146.28	£2233.29
F	£2393.01	£2536.52	£2639.35
G	£2761.17	£2926.75	£3045.40
H	£3313.40	£3512.10	£3654.48

These particulars are believed to be correct but in no way is their accuracy guaranteed and they do not form part of any contract and neither do Tiger Sales & Lettings or the vendors accept any responsibility in respect of these particulars and any prospective purchaser must satisfy themselves by inspection or otherwise as to their accuracy. All measurements are approximate and for illustrative purposes only. Floor Plans are included as a service to our customers and is intended as a GUIDE TO LAYOUT ONLY. Digital images are reproduced for general information only and must not be inferred that any item shown is included for sale with the property. We have been unable to confirm if services / items in the property are in full working order. The property is offered for sale on this basis. Prospective purchasers are advised to seek expert advice where appropriate. We are only verbally informed by the vendor of the stated tenure details, therefore we advise any prospective purchaser to confirm the tenure details with their solicitor / legal representative.



Lonsdale Road, Blackpool



Lonsdale Road, Blackpool

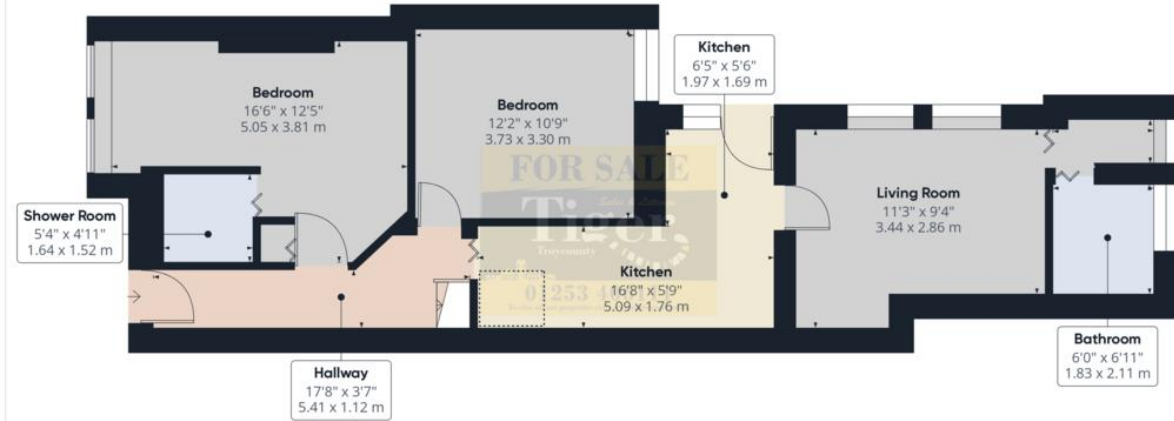

Approximate total area⁽¹⁾

750.58 ft²
69.73 m²

Reduced headroom

10.57 ft²
0.98 m²

(1) Excluding balconies and terraces

Reduced headroom
(below 1.5m/4.92ft)

While every attempt has been made to ensure accuracy, all measurements are approximate, not to scale. This floor plan is for illustrative purposes only.

GIRAFFE 360