



## Tryon Court, Halstead, Essex, CO9 1BX

Rent - £1,250 PCM      Deposit - £1,442

SCOTT MADDISON bring to the rental market this three bedroom mid-terraced family home, situated in a walk-way location. The home is let unfurnished and is available early August 2024. The property features an open plan kitchen / breakfast room, cloakroom, first floor bathroom, enclosed garden and single garage. Viewing is recommended.

- MID-TERRACED FAMILY HOME
- THREE BEDROOMS
- SITTING ROOM WITH FIREPLACE
- FAMILY BATHROOM
- ENCLOSED REAR GARDEN AND SINGLE GARAGE
- LET UNFURNISHED
- GAS HEATING & ENERGY RATING - D.
- APPROXIMATE SIZE - 925 SQ. FT.
- ONE PET CONSIDERED / COUNCIL TAX BAND C
- AVAILABLE EARLY AUGUST 2024



Council Tax Band: C - EPC Rating: D 62

GROUND FLOOR  
40.0 sq.m. (430 sq.ft.) approx.

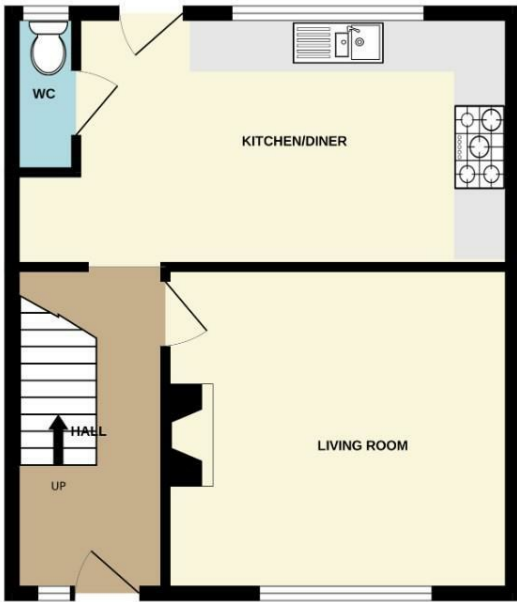

1ST FLOOR  
40.4 sq.m. (435 sq.ft.) approx.

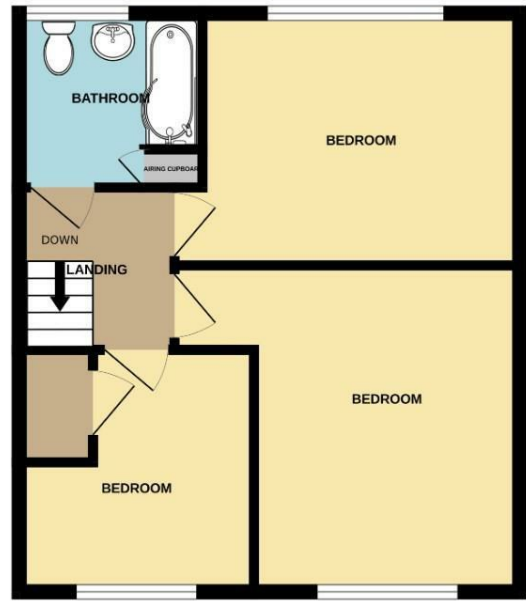

TOTAL FLOOR AREA: 80.4 sq.m. (865 sq.ft.) approx.

Whilst every attempt has been made to ensure the accuracy of the floorplan contained here, measurements of doors, windows, rooms and any other items are approximate and no responsibility is taken for any error, omission or mis-statement. This plan is for illustrative purposes only and should be used as such by any prospective purchaser. The services, systems and appliances shown have not been tested and no guarantee as to their operability or efficiency can be given.  
Made with MetroPix ©2024

