

## £440,000

JUBILEE AVENUE, PORTCHESTER BORDERS, PO6 4QN



- Four Bedrooms (Fitted Wardrobes)
- En-Suite To The Main Bedroom
- Entrance Hallway
- Downstairs Cloakroom
- 21' Dual Aspect Fitted Kitchen/Diner
- 21' Dual Aspect Lounge
- Modern Family Bathroom
- Gas Central Heating
- UPVC Double Glazed Windows
- Off Street Parking
- Garage/Workshop
- Enclosed South Facing Garden

### Portchester Office

92 West Street Portchester Hampshire PO16 9UQ

Tel: 02392 327 070 | E: [portchester@fenwicks-estates.co.uk](mailto:portchester@fenwicks-estates.co.uk)

[www.fenwicks-estates.co.uk](http://www.fenwicks-estates.co.uk)

Property Reference: P2680

Council Tax Band: D

Score	Energy rating	Current	Potential
92+	A		
81-91	B		89 B
69-80	C	80 C	
55-68	D		
39-54	E		
21-38	F		
1-20	G		

Floor Plans (For illustrative purposes and not drawn exactly to scale)



Ground Floor

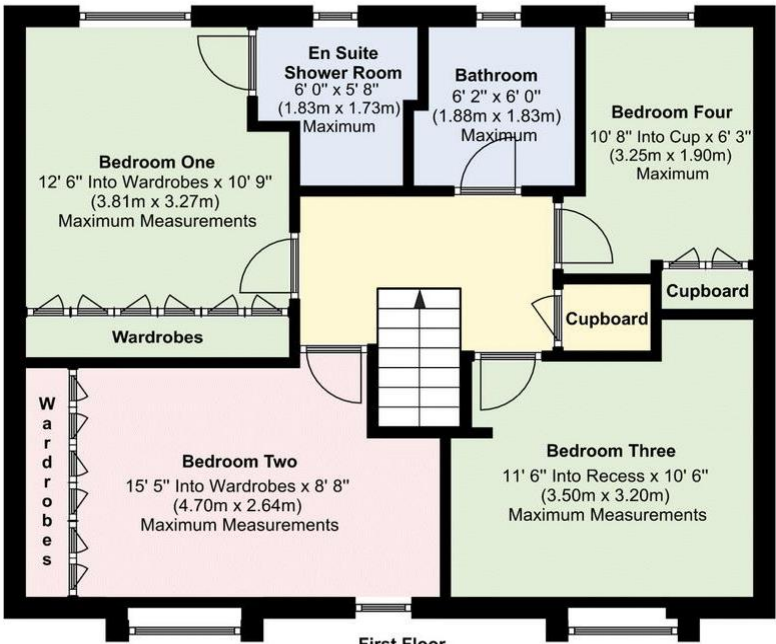

First Floor

## The Accommodation Comprises:-

Part double glazed composite front door into:

### Entrance Hall:-

Stairs to first floor with pull out storage cupboards below, radiator with decorative cover, wood effect laminate flooring, built-in storage cupboard housing meters, smoke detector and flat ceiling. Door to:

### Downstairs Cloakroom:-

4' 11" x 3' 2" (1.50m x 0.96m)

White suite comprising: close coupled WC, pedestal wash hand basin with mixer tap, part tiled walls with fitted mirror, flat and sloping ceiling with spotlighting inset, chrome heated towel rail and continuation of wood effect laminate flooring.

### Lounge:-

21' 6" x 10' 3" (6.55m x 3.12m)

Dual aspect room with UPVC double glazed window to front elevation, radiator with decorative cover, continuation of wood effect laminate flooring, TV aerial point, flat ceiling and UPVC double glazed double opening doors overlooking and accessing the rear garden.



### Kitchen/Diner:-

21' 6" x 16' 5" (6.55m x 5.00m) Maximum Measurements

Dual aspect room with UPVC double glazed window to front and rear elevations, fitted modern range of matching base, eye level and larder style soft close units, wooden worktops, Butler sink with mixer tap, part tiled walls, space for range style cooker with extractor above, integrated dishwasher, recess for American style fridge/freezer, space for table and chairs, radiator, utility area with space and plumbing for washing machine, space for tumble dryer, internal door to hallway, wood effect laminate flooring, flat ceiling and part double glazed composite door leading to rear garden.



## Portchester Office

92 West Street Portchester Hampshire PO16 9UQ

Tel: 02392 327 070 | E: portchester@fenwicks-estates.co.uk

www.fenwicks-estates.co.uk



## First Floor Landing:-

Built-in airing cupboard, smoke detector, access to loft via fitted ladder and flat ceiling. Doors to:

## Bedroom One:-

12' 6" Into Wardrobes x 10' 9" (3.81m x 3.27m) Maximum Measurements

UPVC double glazed window to rear elevation overlooking the garden, radiator, built-in wardrobes, wood effect laminate flooring and flat ceiling. Door to:



## En Suite Shower Room:-

6' 0" x 5' 8" (1.83m x 1.73m) Maximum Measurements

Opaque UPVC double glazed window to rear elevation, white suite comprising: double width shower cubicle, close couple WC, pedestal wash hand basin with mixer tap, part tiled walls, fitted mirror fronted cabinet, radiator, tiled flooring, extractor and flat ceiling with spotlighting inset.

## Portchester Office

92 West Street Portchester Hampshire PO16 9UQ

Tel: 02392 327 070 | E: portchester@fenwicks-estates.co.uk

www.fenwicks-estates.co.uk



## Bedroom Two:-

15' 5" Into Wardrobes x 8' 8" (4.70m x 2.64m) Maximum Measurements

UPVC double glazed bow window to front elevation, radiator, built-in wardrobes and flat ceiling.



## Bedroom Three:-

11' 6" Into Recess x 10' 6" (3.50m x 3.20m) Maximum Measurements

UPVC double glazed bow window to front elevation, radiator, wood effect laminate flooring and flat ceiling with spotlighting inset.



## Bedroom Four:-

10' 8" Into Cupboard x 6' 3" (3.25m x 1.90m) Maximum Measurements

UPVC double glazed window to rear elevation overlooking the garden, radiator, built-in wardrobes and flat ceiling.



## Bathroom:-

6' 2" x 6' 0" (1.88m x 1.83m) Maximum Measurements

Opaque UPVC double glazed window to rear elevation, white suite comprising: panelled bath with mixer tap and handheld shower attachment, shower screen, close couple WC, pedestal wash hand basin with mixer tap, part tiled walls with fitted mirror, chrome heated towel rail, tiled flooring, extractor and flat ceiling with spotlighting inset.

## Portchester Office

92 West Street Portchester Hampshire PO16 9UQ

Tel: 02392 327 070 | E: portchester@fenwicks-estates.co.uk

www.fenwicks-estates.co.uk



## Outside:-

Front garden laid mainly to lawn with mature shrubs and hedging, parking available and garage in block. Wooden gate gives side pedestrian access to:



## Rear Garden:-

South facing, enclosed, raised decking for entertaining purposes, water tap, outside light and stairs lead to lower section laid mainly to lawn.



## Agents Note:-

There is an annual maintenance charge which is currently £242.17 per annum but this can vary.

## Portchester Office

92 West Street Portchester Hampshire PO16 9UQ

Tel: 02392 327 070 | E: [portchester@fenwicks-estates.co.uk](mailto:portchester@fenwicks-estates.co.uk)

[www.fenwicks-estates.co.uk](http://www.fenwicks-estates.co.uk)

Disclaimer: These particulars are set out as a general outline in accordance with the Consumer Protection from Unfair Trading Regulations 2008 (CPR's) and Business Protection from Misleading Marketing Regulations 2008 (BPR's) only for the guidance of intending purchasers or lessees, and do not constitute any part of an offer or contract. Details are given without any responsibility, and any intending purchasers, lessees or third parties should not rely on them as statements or representations of fact, but must satisfy themselves by inspection or otherwise as to the correctness of each of them.

We have not carried out a structural survey and the services, appliances and specific fittings have not been tested. All photographs, measurements, floor plans and distances referred to are given as a guide only and should not be relied upon for the purchase of carpets or any other fixtures or fittings. Gardens, roof terraces, balconies and communal gardens as well as tenure and lease details cannot have their accuracy guaranteed for intending purchasers. Lease details, service ground rent (where applicable) are given as a guide only and should be checked and confirmed by your solicitor prior to exchange of contracts.

No person in the employment of Fenwicks Estates Ltd has any authority to make any representation or warranty whatever in relation to this property. Purchase prices, rents or other prices quoted are correct at the date of publication and, unless otherwise stated, exclusive of VAT.

Data Protection: We retain the copyright in all advertising material used to market this Property.

Money Laundering Regulations 2017: Intending purchasers will be required to produce identification documentation once an offer is accepted

Your home is at risk if you do not keep up repayments on mortgage or other secured loans.

## Portchester Office

92 West Street Portchester Hampshire PO16 9UQ

Tel: 02392 327 070 | E: [portchester@fenwicks-estates.co.uk](mailto:portchester@fenwicks-estates.co.uk)

[www.fenwicks-estates.co.uk](http://www.fenwicks-estates.co.uk)

