

£315,000

PORTOBELLO GROVE, PORTCHESTER, PO16 8HU



- Two Bedrooms
- Entrance Hallway
- Lounge
- Fitted Kitchen with Harbour Views
- Conservatory
- Shower Room
- Gas Central Heating
- Double Glazed Windows
- Off Street Parking
- Garage/Workshop
- Enclosed West Facing Rear Garden
- No Onward Chain

Portchester Office

92 West Street Portchester Hampshire PO16 9UQ

Tel: 02392 327 070 | E: portchester@fenwicks-estates.co.uk

www.fenwicks-estates.co.uk

Property Reference: P2694

Council Tax Band: C

Score	Energy rating	Current	Potential
92+	A		
81-91	B		83 B
69-80	C		
55-68	D	67 D	
39-54	E		
21-38	F		
1-20	G		

Floor Plans (For illustrative purposes and not drawn exactly to scale)

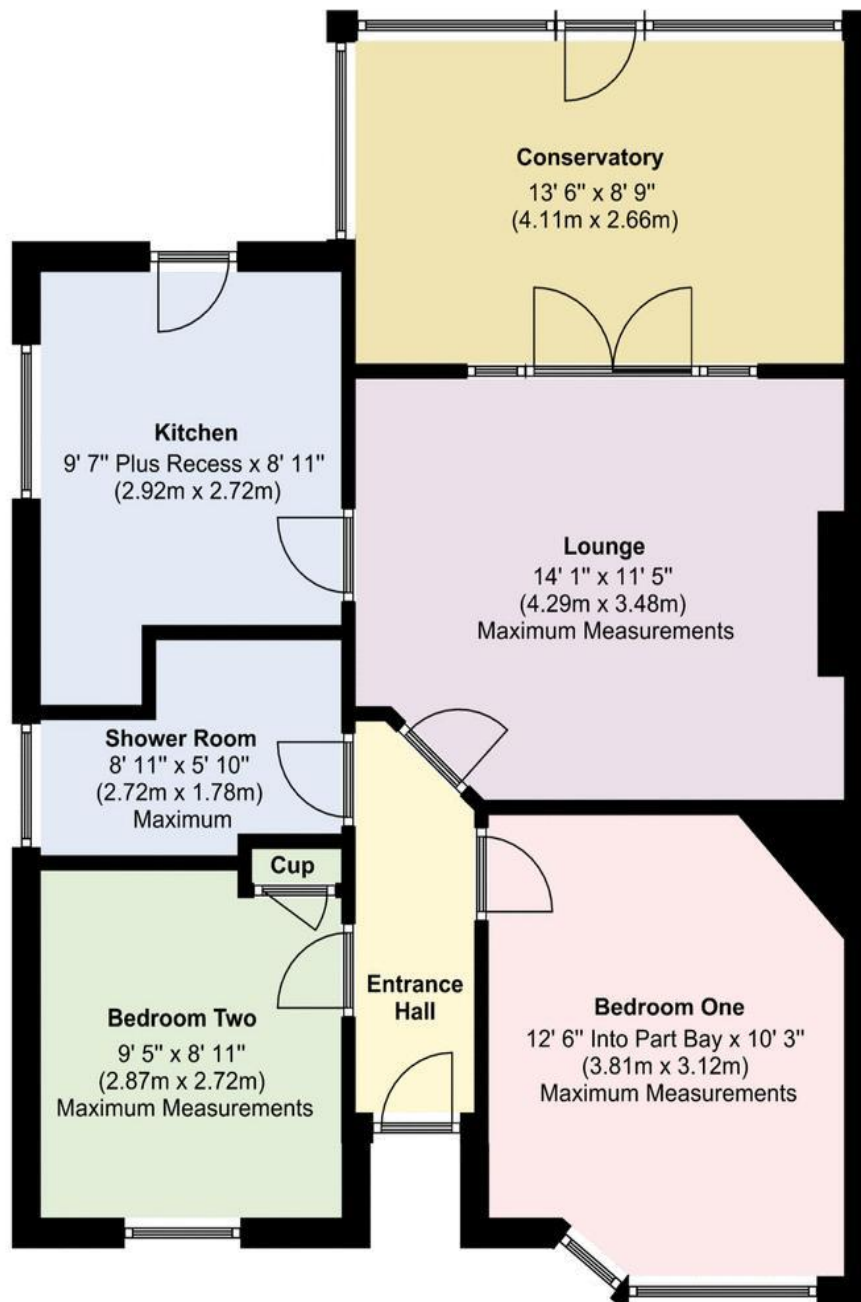

Portchester Office

92 West Street Portchester Hampshire PO16 9UQ

Tel: 02392 327 070 | E: portchester@fenwicks-estates.co.uk

www.fenwicks-estates.co.uk



The Accommodation Comprises:-

Covered entrance with UPVC part double glazed front door into:

Entrance Hall:-

Radiator and coving to textured ceiling with access to the loft via fitted ladder. Doors to:

Lounge:-

14' 1" x 11' 5" (4.29m x 3.48m) Maximum Measurements

Feature fireplace, radiator, TV aerial point, coving to textured ceiling with central ceiling rose and lead light double doors with matching side panels leading to conservatory. Further door to:



Kitchen:-

9' 7" Plus Recess x 8' 11" (2.92m x 2.72m)

UPVC double glazed window to side elevation with views towards Portsmouth Harbour, fitted range of matching base, eye level and glass display storage units, roll top worksurfaces, two and a half bowl sink unit with mixer tap, part tiled walls, built-in oven and hob with concealed extractor over, recess for fridge/freezer, space and plumbing for washing machine, wall mounted gas central heating boiler, radiator, coving to textured ceiling and UPVC part double glazed door to rear garden.



Conservatory:-

13' 6" x 8' 9" (4.11m x 2.66m)

UPVC double glazed windows and doors overlooking and accessing the rear garden, space for table and chairs and power connected.

Portchester Office

92 West Street Portchester Hampshire PO16 9UQ

Tel: 02392 327 070 | E: portchester@fenwicks-estates.co.uk

www.fenwicks-estates.co.uk





Bedroom One:-
12' 6" Into Part Bay x 10' 3" (3.81m x 3.12m) Maximum Measurements

UPVC double glazed part bay window to front elevation, radiator, fitted bedroom furniture (to remain) and coving to textured ceiling with spotlighting inset.



Bedroom Two:-
9' 5" x 8' 11" (2.87m x 2.72m) Maximum Measurements

UPVC double glazed window to front elevation, radiator, built-in storage cupboard and coving to textured ceiling.



Shower Room:-
8' 11" x 5' 10" (2.72m x 1.78m) Maximum Measurements

Opaque UPVC double glazed window to side elevation, white suite comprising: shower cubicle with rainwater shower and handheld shower attachment, wash hand basin inset vanity unit with mixer tap, close coupled WC, waterproof shower wall and part tiled walls, chrome heated towel rail, extractor and flat ceiling with spotlighting inset.



Outside:-

Paved low maintenance front garden with shrubs, flowers and plants inset. Double opening wrought iron gates allowing off street parking and leading to:

Portchester Office

92 West Street Portchester Hampshire PO16 9UQ

Tel: 02392 327 070 | E: portchester@fenwicks-estates.co.uk

www.fenwicks-estates.co.uk



Garage/Workshop:-

Up and over door, power connected and rear courtesy door.

Rear Garden-

West facing, enclosed, patio area for entertaining purposes, water tap, lawn area with established shrubs, flowers and plants to borders, wooden shed (to remain) and built-in brick storage.



Portchester Office

92 West Street Portchester Hampshire PO16 9UQ

Tel: 02392 327 070 | E: portchester@fenwicks-estates.co.uk

www.fenwicks-estates.co.uk

Disclaimer: These particulars are set out as a general outline in accordance with the Consumer Protection from Unfair Trading Regulations 2008 (CPR's) and Business Protection from Misleading Marketing Regulations 2008 (BPR's) only for the guidance of intending purchasers or lessees, and do not constitute any part of an offer or contract. Details are given without any responsibility, and any intending purchasers, lessees or third parties should not rely on them as statements or representations of fact, but must satisfy themselves by inspection or otherwise as to the correctness of each of them.

We have not carried out a structural survey and the services, appliances and specific fittings have not been tested. All photographs, measurements, floor plans and distances referred to are given as a guide only and should not be relied upon for the purchase of carpets or any other fixtures or fittings. Gardens, roof terraces, balconies and communal gardens as well as tenure and lease details cannot have their accuracy guaranteed for intending purchasers. Lease details, service ground rent (where applicable) are given as a guide only and should be checked and confirmed by your solicitor prior to exchange of contracts.

No person in the employment of Fenwicks Estates Ltd has any authority to make any representation or warranty whatever in relation to this property. Purchase prices, rents or other prices quoted are correct at the date of publication and, unless otherwise stated, exclusive of VAT.

Data Protection: We retain the copyright in all advertising material used to market this Property.

Money Laundering Regulations 2017: Intending purchasers will be required to produce identification documentation once an offer is accepted

Your home is at risk if you do not keep up repayments on mortgage or other secured loans.

Portchester Office

92 West Street Portchester Hampshire PO16 9UQ

Tel: 02392 327 070 | E: portchester@fenwicks-estates.co.uk

www.fenwicks-estates.co.uk

