



New Court, Addlestone, KT15 2EE





Set within a small, well-maintained development on the outskirts of Addlestone town centre, this bright and airy first-floor apartment offers well presented accommodation throughout.

The property features a generous double bedroom, a light-filled reception room with built-in storage, a well-appointed kitchen with a range of eye-level and base units, and a modern three-piece bathroom.

Additional benefits include permit parking, access to attractive communal gardens, dedicated bike storage, and a long lease—making this an ideal purchase for first-time buyers, downsizers, or investors.

Leasehold - Share of Freehold



Approximate Area = 472 sq ft / 43.84 sq m

For identification only - Not to scale

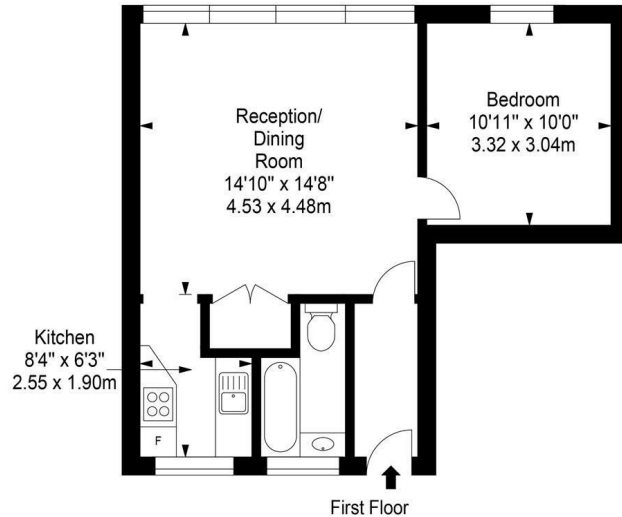

Every attempt is made to assure accuracy, however  
measurements are approximate and for illustrative purposes only. Not to scale.



EPC Rating: 76 C







Grants Homes 155 Station Road, Addlestone, Surrey, KT15 2AT  
T: 01932 858885 E: [addlestone@grantshomes.co.uk](mailto:addlestone@grantshomes.co.uk)

