



Pyle Close, Addlestone, KT15 2FF

**g**  
**GRANTS**  
**HOMES**





Built in 2012 by the renowned Bellway Homes, this superb three-bedroom end-terrace property offers modern living in a quiet, no-through road just a short walk from Addlestone town centre and the train station.

The ground floor features a contemporary, fully fitted kitchen equipped with integrated appliance, The spacious reception room at the rear of the property is flooded with natural light thanks to large patio doors that open onto the southwest-facing garden — perfect for enjoying sunny afternoons. A downstairs cloakroom completes the ground floor.

On the first floor, you'll find a generously sized single bedroom, a fully tiled family bathroom, and a well-proportioned double bedroom with a private balcony overlooking the garden.

The top floor is dedicated to a stunning dual-aspect main bedroom, complete with fitted wardrobes and a stylish en-suite shower room.

Additional benefits include allocated parking and a peaceful residential setting, making this an ideal home for professionals, small families, or downsizers seeking comfort, convenience, and style.

Freehold





EPC: C78





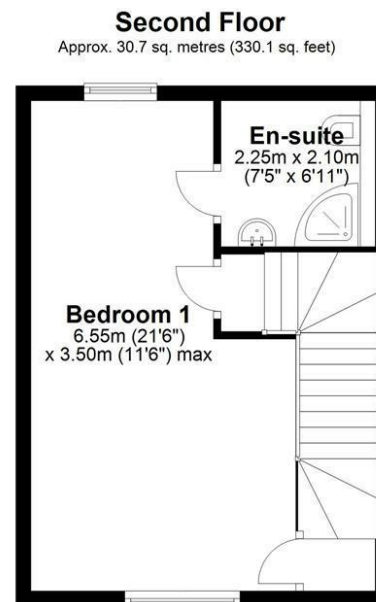
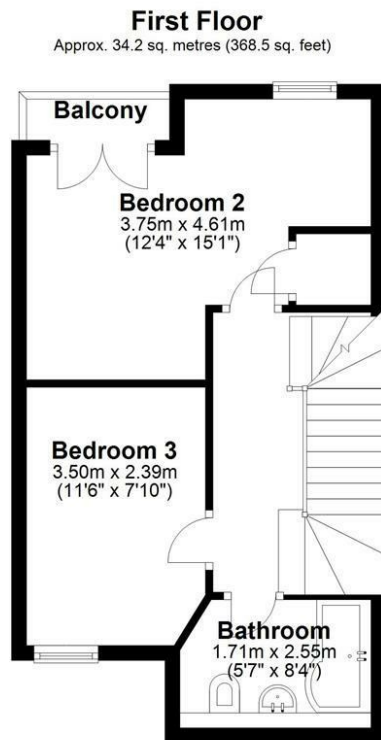
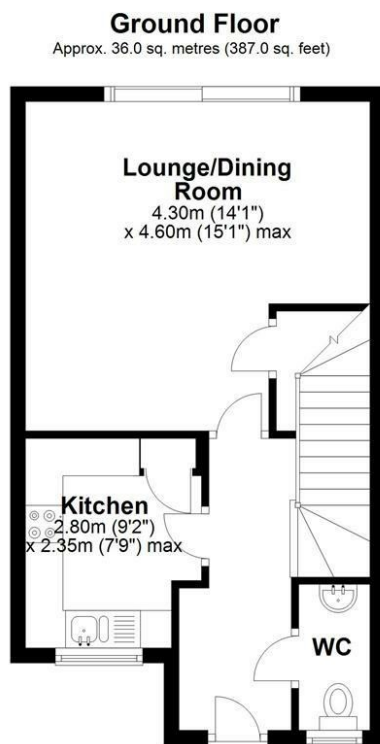

Total area: approx. 100.9 sq. metres (1085.6 sq. feet)

Floor Plan measurements are approximate and are for illustrative purposes only.  
Plan produced using PlanUp.

