



St Georges Court, St. Georges Road, Addlestone, KT15 2AY





Located just a short stroll from the town centre, this charming ground floor one-bedroom apartment is situated within a well-maintained retirement development for over 55's women & over 60's men, offering comfort, convenience, and a strong sense of community.

Well presented throughout, the property boasts a generously sized double bedroom, contemporary shower room featuring a spacious walk-in shower, kitchen with ample worktop space and storage, a bright and airy living room with French doors opening onto a private patio area, offering direct access to the beautifully maintained communal gardens. Residents of the development benefit from a range of excellent facilities, including a welcoming owners' lounge – ideal for socialising, Residents' and visitor parking, an on-site house manager available Monday to Friday, 24-hour Careline support system in both individual apartments and communal areas for added peace of mind. Further benefits include UPVC windows throughout the property and our clients are committed to providing a new 99 year lease upon completion.

Leasehold



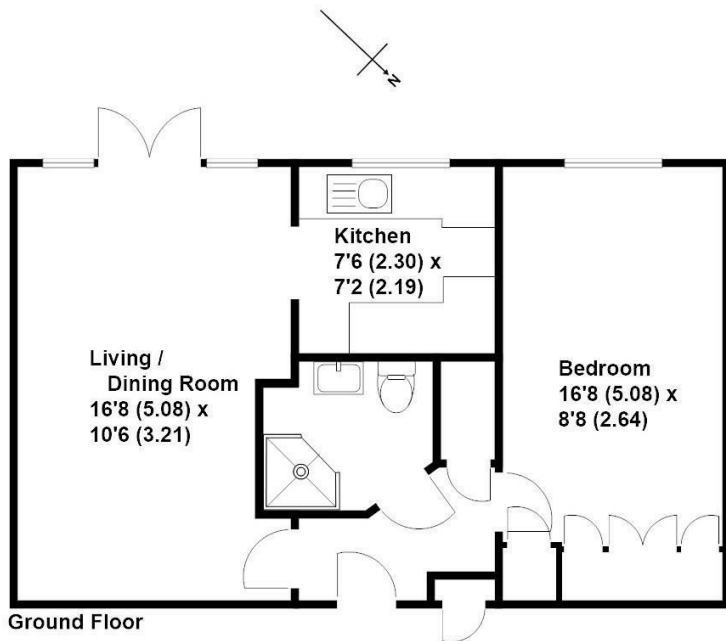

Approximate Gross Internal Floor Area - 450 sq/ft - 41.8 sq/mtr

Grants Independent has prepared these sales particulars for general guidance purposes only. They do not form or constitute any part of an offer or contract. The services, systems and appliances listed in these details have not been tested by us, and no guarantee is given to their operational ability or efficiency. Lease details, service charges and ground rent are given as a guide and should be checked by your solicitor prior to exchange of contracts. These plans are not drawn to scale and are for representational purposes only. Created by www.visionwithin.co.uk



EPC Rating: 77 C





Grants Homes 155 Station Road, Addlestone, Surrey, KT15 2AT
T: 01932 858885 E: addlestone@grantshomes.co.uk