



Ecton Road, Addlestone, KT15 1UE

g
GRANTS
HOMES



This charming Victorian home, offering two double bedrooms and two reception rooms, is presented in immaculate condition. Ideally located just a short stroll from the town centre and railway station, the property boasts a front-facing living room with a characterful fireplace, and a dining room, also featuring a striking fireplace, which opens into a bright and airy kitchen. The kitchen offers delightful views and direct access to the generous rear garden.

The garden is well-proportioned, featuring both patio and lawn areas, and includes a fully-equipped summer house with power and lighting—perfect for a variety of uses.

On the first floor, you'll find the spacious principle bedroom with built-in wardrobes and an elegant feature fireplace, a second well-sized double bedroom, and a beautifully appointed bathroom complete with a classic clawfoot bath and a separate shower.

This home is a wonderful example of Victorian architecture, full of charm and character. There is also potential for further expansion, subject to the usual planning consents.

Freehold





EPC: D58



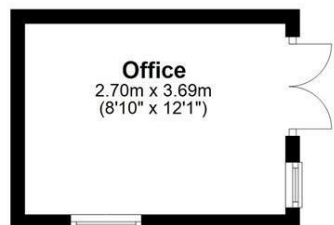

Ground Floor
Approx. 44.7 sq. metres (481.0 sq. feet)

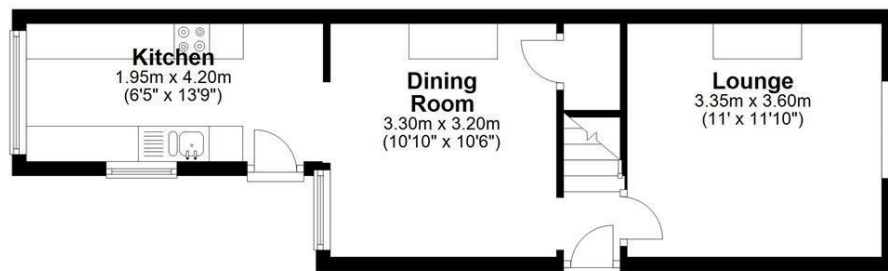

First Floor
Approx. 33.4 sq. metres (359.2 sq. feet)

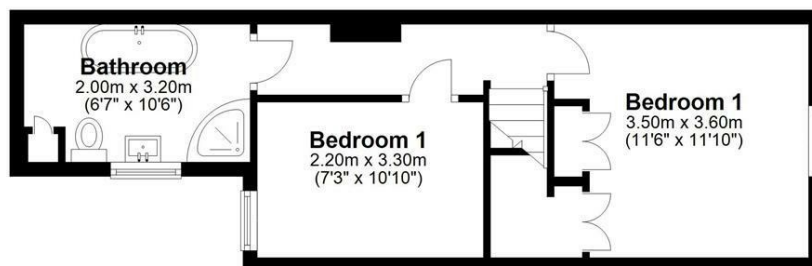

Total area: approx. 78.1 sq. metres (840.2 sq. feet)

Floor Plan measurements are approximate and are for illustrative purposes only.
Plan produced using PlanUp.

