



Burn Close, Addlestone, KT15 2PJ





Beautifully Presented Two Bedroom Ground Floor Apartment located close to the Train Station and Town Centre. Situated in the heart of Addlestone this wonderful property had a substantial refurbishment 2 years ago turning it into a very stylish home, with a principle double bedroom, a good size single bedroom, contemporary bathroom with shower over the bath and a stunning fully fitted kitchen which is open plan to the living area which has French doors out to a small patio area. Further benefits to the property include a long lease, resident only parking and secure door entry system. Offered to the market with No Onward Chain.

Leasehold - Share of Freehold



GROUND FLOOR
51.0 sq.m. (549 sq.ft.) approx.

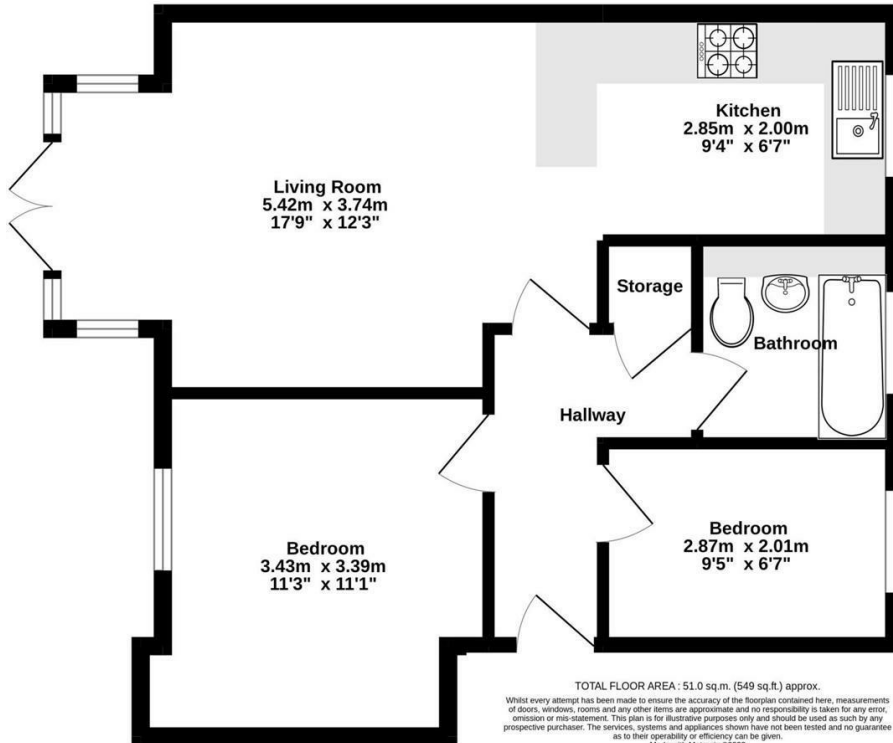

TOTAL FLOOR AREA : 51.0 sq.m. (549 sq.ft.) approx.
Whilst every attempt has been made to ensure the accuracy of the floorplan contained here, measurements of doors, windows, rooms and any other items are approximate and no responsibility is taken for any error, omission or mis-statement. This plan is for illustrative purposes only and should be used as such by any prospective purchaser. The services, systems and appliances shown have not been tested and no guarantee as to their operability or efficiency can be given.
Made with Metropix ©2022



EPC Rating: 79 C





Grants Homes 155 Station Road, Addlestone, Surrey, KT15 2AT
T: 01932 858885 E: addlestone@grantshomes.co.uk