



Everything you need to know about:

Market Place,
Garstang, Preston,
PR3 1ZA



Introduction



The Property



Local Authority



Transport Links

Education



Health



Local Policing





An invaluable insight into your new home

This i-PACK brochure offers an informed overview of **Market Place** as a potential new home, along with essential material about its surrounding area and its local community. It provides a valuable insight for any prospective owner or tenant.

We wanted to provide you with information that you can absorb quickly, so we have presented it as visually as possible, making use of maps, icons, tables, graphs and charts. Overall, the brochure contains information about:

- **The Property** - including property details, floor plans, room details, photographs and Energy Performance Certificate.
- **Transport** - including locations of bus and coach stops, railway stations and ferry ports.
- **Health** - including locations, contact details and organisational information on the nearest GPs, pharmacies, hospitals and dentists.
- **Local Policing** - including locations, contact details and information about local community policing and the nearest police station, as well as police officers assigned to the area.
- **Education** - including locations of infant, primary and secondary schools and Key Performance Indicators (KPIs) for each key stage.



Farrell Heyworth 7 The High Street, Garstang, PR3 1FA **01995 600666**



MARKET PLACE, PRESTON £259,950



x2
Bedrooms



x1
Living Rooms



x1
Bathrooms

Where you are

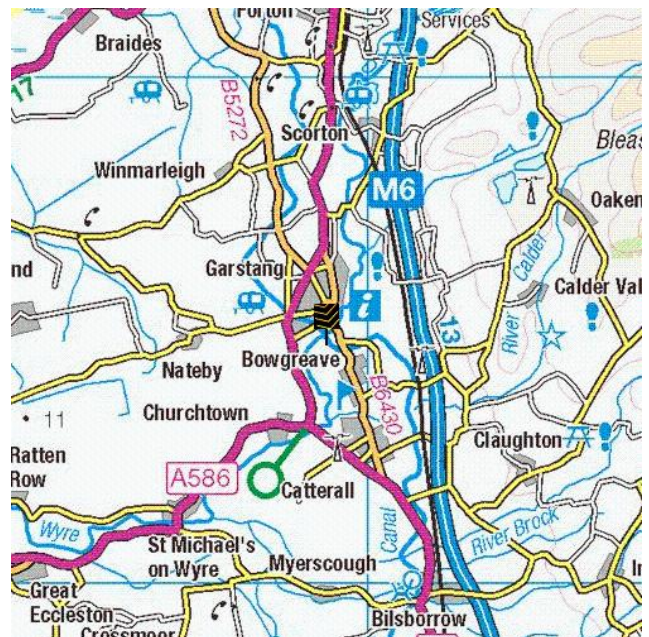





Lounge Area image 3



Breakfast Kitchen Ar



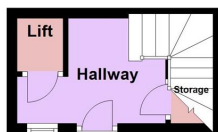

Ground Floor

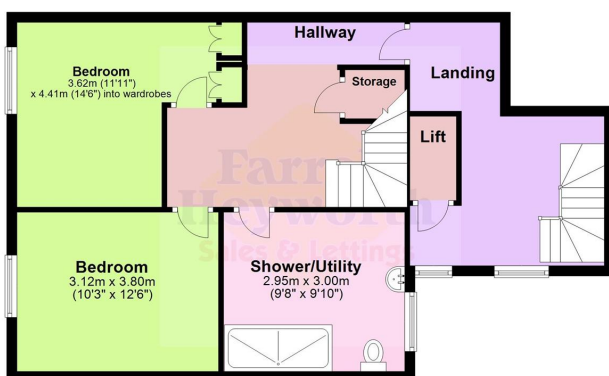

First Floor

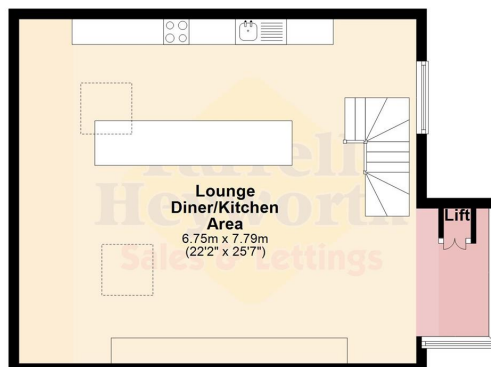

Second Floor





Everything you want
to know about
local authorities





Get to know your local authorities

Local government directly affects quality of life, particularly when it comes to council tax, planning, waste disposal and the impact of local policies. You may want to investigate how this is likely to affect you if you decide to move. There are nearly 400 local authorities in England, with five different types of local government structure. These can be broadly divided into **single-tier** and **two-tier authorities**. Single-tier authorities are **Metropolitan Authorities, London Boroughs** and **Unitary or Shire Authorities**. Two-tier authorities have both a **County Council**, and a **District Council or City Council**. There are also around 10,000 parish and town councils, effectively creating an additional tier in some areas - mostly, but not exclusively, in rural areas. The National Association of Local Councils (NALC) represents and works on behalf of these community councils and is a useful contact point.

The local authority locations and contact details for **Market Place** are:

Shire / County / District	Website	Address	Contact details
---------------------------	---------	---------	-----------------

Disclaimer: The information displayed above has been obtained using the property's postcode in proximity to its local authority. It is recommended that this information is independently verified.



Everything you want
to know about
transport links







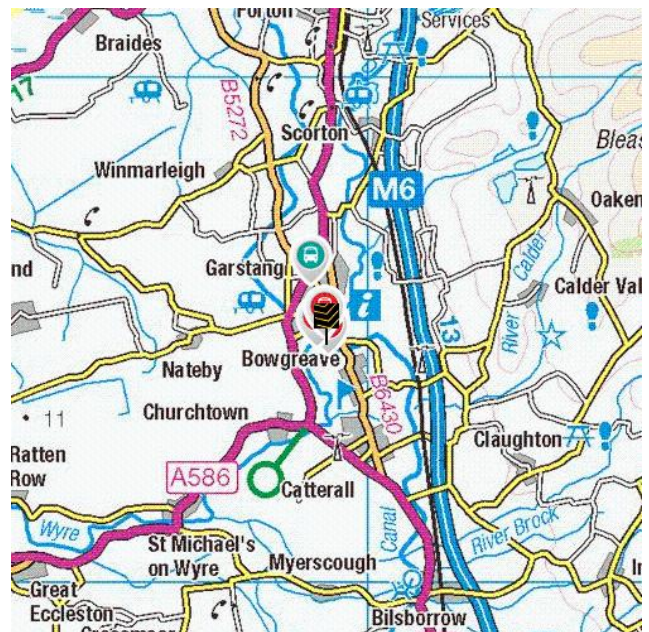
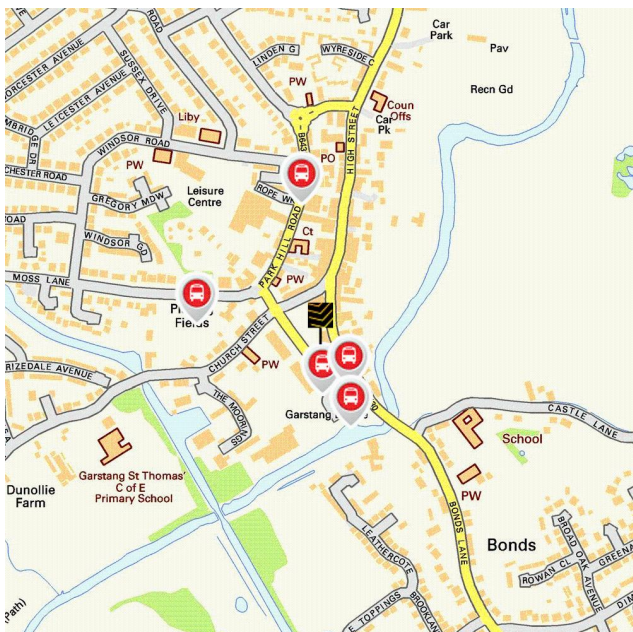

Become familiar with public transport links

Being able to choose to travel by public transport is important for many reasons. It helps to reduce congestion, provides access to work and education, and facilitates use of health and leisure facilities. If you or your family members travel abroad, access to the nearest ferry terminals is also likely to be a significant factor in choosing a new property. Using the maps below, you can pinpoint the precise locations of transport links for **Market Place**. Tables for each type of transport indicate the property's distance from the nearest bus stops, railway stations, coach stops and ferry terminals (providing that these facilities are within the scale proximity of the maps.)

Transport Links



	Airports	Approx Distance
	Blackpool International Airport	13.74 miles
	Liverpool John Lennon Airport	38.94 miles
	Manchester Airport	42.48 miles
	Leeds Bradford International Airport	45.41 miles
	Ferry ports	Approx Distance
	Knott End-On-Sea Ferry Landing	9.26 miles
	Fleetwood for Knott End Ferry Landing	9.6 miles
	Heysham Ferry Terminal	10.82 miles
	Piel Island Ferry Landing	19.76 miles
	Roa Island Ferry Landing	20.18 miles
	Train Stations	Approx Distance
	Salwick Rail Station	8.33 miles
	Kirkham & Wesham Rail Station	8.94 miles
	Poulton-le-Fylde Rail Station	9.48 miles
	Preston Rail Station	10.22 miles
	Lancaster Rail Station	10.38 miles

Disclaimer: The information represented in this section has been sourced from the Department of Transport's Open Data and is based on the property's postcode. It is recommended that this information is independently verified.



Farrell Heyworth 7 The High Street, Garstang, PR3 1FA 01995 600666

	Bus Stops	Approx Distance
	Park Hill Road	0.04 miles
	Bridge Street	0.05 miles
	Safeways	0.08 miles
	Moss Lane	0.12 miles
	Park Hill Road	0.14 miles
	Coach Stops	Approx Distance
	Garstang (Lancs): Crofters Hotel Coach Stop	0.78 miles
	Galgate: Crossroads Coach Stop	6.42 miles
	Lancaster: University Underpass Coach Stop	7.65 miles
	Fulwood (Preston) Coach Stop	8.77 miles
	Preston Bus Station	10.08 miles

Disclaimer: The information represented in this section has been sourced from the Department of Transport's Open Data and is based on the property's postcode. It is recommended that this information is independently verified.



Farrell Heyworth 7 The High Street, Garstang, PR3 1FA 01995 600666



Everything you want
to know about
local schools





How are local schools performing?

If schools are important to you, then this section sets out the published Key Performance Indicators for schools near to your prospective new home. Key Performance Indicators look primarily at how well pupils perform in their tests and examinations, as well as some other measures like attendance.

If you want to know more about a particular school or college, you can also visit the Ofsted website <http://www.ofsted.gov.uk/inspection-reports/find-inspection-report>

Local Schools

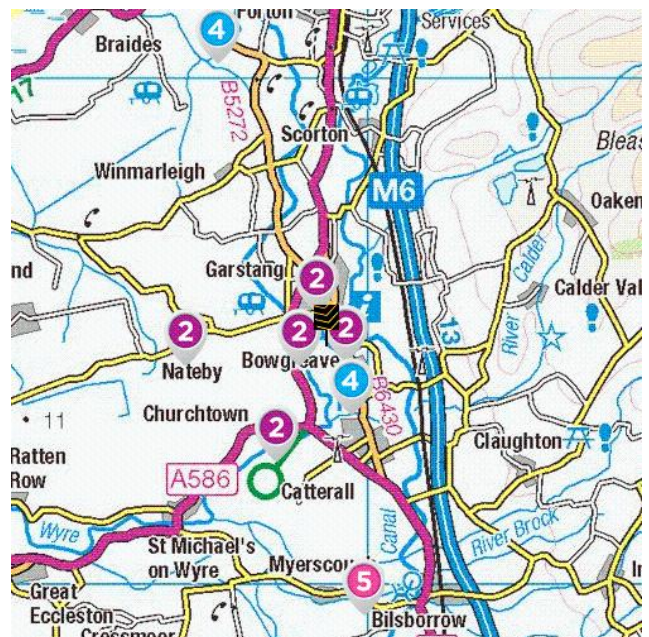
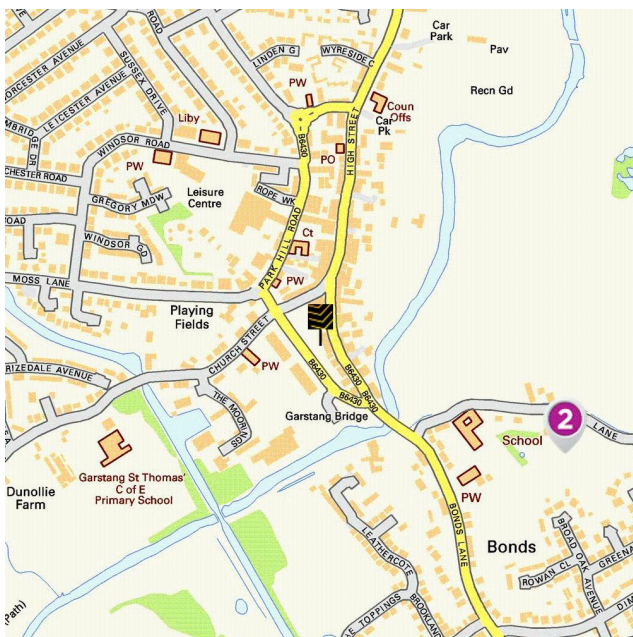

The next page shows tables and charts divided into Key Stages and a list of respective schools local to **Market Place**. There are four main age-related Key Stages defined as:



Special schools are marked with this icon

Key Stage	Definition
Key Stage 1	Fits broadly with the first stage of education, i.e. ages 5-7.
Key Stage 2	Fits the later stage of primary education, often known as junior schools, i.e. ages 8-11. This takes pupils up to the standardised break at age 11 after which pupils generally change schools and transfer to secondary education.
Key Stage 3	Secondary education split between key stages 3 and 4, with key stage 3 covering ages 11-13.
Key Stage 4	Key Stage 4 (ages 14-16) covers the two year period of study for GCSE level examinations.
Key Stage 5	Beyond key stage 4 is 16+ or Sixth Form provision, sometimes unofficially referred to as Key Stage 5.



Farrell Heyworth 7 The High Street, Garstang, PR3 1FA 01995 600666

	Key Stage 2 - Information	Approx Distance
	<p>Name: St Mary and Michael Catholic Primary School Address: Castle Lane, Preston, PR3 1RB Contact Number: 01995603023 Age Range: 4-11 yrs Local Education Authority: Lancashire Religious Character: Roman Catholic</p>	0.26 miles
	<p>Name: Garstang St Thomas' Church of England Primary School Address: Kepple Lane, Preston, PR3 1PB Contact Number: 01995603454 Age Range: 4-11 yrs Local Education Authority: Lancashire Religious Character: Church of England</p>	0.37 miles
	<p>Name: Garstang Community Primary School Address: Oak Road, Preston, PR3 1HT Contact Number: 01995603622 Age Range: 5-11 yrs Local Education Authority: Lancashire Religious Character: Does not apply</p>	0.52 miles
	<p>Name: Kirkland and Catterall St Helen's Church of England Voluntary Aided Primary School Address: The Green, Preston, PR3 0HS Contact Number: 01995603050 Age Range: 4-11 yrs Local Education Authority: Lancashire Religious Character: Church of England</p>	1.45 miles
	<p>Name: Nateby Primary School Address: Longmoor Lane, Preston, PR3 0JH Contact Number: 01995602945 Age Range: 5-11 yrs Local Education Authority: Lancashire Religious Character: Does not apply</p>	1.74 miles

Disclaimer: The information represented in this section has been sourced from the Department of Education's 2019 results data s and is based on the property's postcode.



Reading, Writing and Maths

	Name	Expected	Higher
	St Mary and Michael Catholic Primary School	59.0 %	0.0 %
	Garstang St Thomas' Church of England Primary School	78.0 %	13.0 %
	Garstang Community Primary School	65.0 %	13.0 %
	Kirkland and Catterall St Helen's Church of England Voluntary Aided Primary School	82.0 %	12.0 %
	Nateby Primary School	67.0 %	25.0 %
	Lancashire	64.0 %	10.0 %
	National	65.0 %	11.0 %

Primary Progress Measures

As well as actual pupil performance in tests and exams an important Key Performance Indicator is that of progress measures that compare the actual achievements of other pupils nationally with similar prior attainment. Any increase in attainment achieved by each pupil will be reflected in the schools progress scores. They are fairer to schools in challenging circumstances, as they recognise a school that is doing a good job with an intake with poor prior attainment

Progress Measures for 2019

	Name	Math	Reading	Writing
	St Mary and Michael Catholic Primary School	0.5 %	2.5 %	-4.7 %
	Garstang St Thomas' Church of England Primary School	1.0 %	3.5 %	1.6 %
	Garstang Community Primary School	0.8 %	1.4 %	1.7 %
	Kirkland and Catterall St Helen's Church of England Voluntary Aided Primary School	1.6 %	-2.5 %	-1.4 %
	Nateby Primary School	0.4 %	0.0 %	-0.3 %

Disclaimer: The information represented in this section has been sourced from the Department of Education's 2019 results data set and is based on the property's postcode.



Farrell Heyworth 7 The High Street, Garstang, PR3 1FA 01995 600666

	Key Stage 4 - Information	Approx Distance
	<p>Name: Garstang Community Academy Address: Bowgreave, Preston, PR3 1YE Contact Number: 01995603226 Age Range: 11-16 yrs Local Education Authority: Lancashire Religious Character: Does not apply</p>	0.81 miles
	<p> Name: Crookhey Hall School Address: Crookhey Hall, Lancaster, LA2 0HA Contact Number: 01524792618 Age Range: 10-17 yrs Local Education Authority: Lancashire Religious Character: None</p>	3.8 miles
	<p>Name: Broughton High School Address: Woodplumpton Lane, Preston, PR3 5JJ Contact Number: 01772863849 Age Range: 11-16 yrs Local Education Authority: Lancashire Religious Character: Does not apply</p>	6.57 miles
	<p>Name: Saint Aidan's Church of England High School Address: Cartgate, Poulton-le-Fylde, FY6 0NP Contact Number: 01253810504 Age Range: 11-16 yrs Local Education Authority: Lancashire Religious Character: Church of England</p>	7.67 miles
	<p>Name: Fulwood Academy Address: Black Bull Lane, Preston, PR2 9YR Contact Number: 01772719060 Age Range: 11-16 yrs Local Education Authority: Lancashire Religious Character: Does not apply</p>	8.08 miles

Disclaimer: The information represented in this section has been sourced from the Department of Education's 2019 results data s and is based on the property's postcode.



Percentage of pupils achieving 5+ A*-C/9-4 or equivalents including 9-4 in both English and mathematics GCSEs

	Name	2019	2018	2017	2016
4	Garstang Community Academy	71.0 %	78.0 %	71.0 %	72.0 %
	Crookhey Hall School	0.0 %	0.0 %	0.0 %	0.0 %
	Broughton High School	88.0 %	87.0 %	82.0 %	83.0 %
	Saint Aidan's Church of England High School	74.0 %	74.0 %	75.0 %	57.0 %
	Fulwood Academy	45.0 %	50.0 %	44.0 %	32.0 %
	Lancashire	66.0 %	66.1 %	61.7 %	58.5 %
	National	60.0 %	59.4 %	56.6 %	53.5 %

Disclaimer: The information represented in this section has been sourced from the Department of Education's 2017 results data set and is based on the property's postcode.

Average number of GCSE entries per pupil

	Name	Number
4	Garstang Community Academy	6.8
	Crookhey Hall School	2.1
	Broughton High School	7.8
	Saint Aidan's Church of England High School	8.4
	Fulwood Academy	6.6
	Lancashire	7.5
	National	7.1

Disclaimer: The information represented in this section has been sourced from the Department of Education's 2019 results data set and is based on the property's postcode.



	Key Stage 5 - Information	Approx Distance
	<p>Name: Myerscough College Address: St Michael's Road, Preston, PR3 0RY Contact Number: 01995642222 Age Range: 16+ yrs Local Education Authority: Lancashire Religious Character: Does not apply Admission Policy: Not applicable</p>	3.24 miles
	<p>Name: Fulwood Academy Address: Black Bull Lane, Preston, PR2 9YR Contact Number: 01772719060 Age Range: 11-16 yrs Local Education Authority: Lancashire Religious Character: Does not apply</p>	8.08 miles
	<p>Name: Preston College Address: Fulwood Campus, Preston, PR2 8UR Contact Number: 01772225000 Age Range: 16+ yrs Local Education Authority: Lancashire Religious Character: Does not apply Admission Policy: Not applicable</p>	8.54 miles
	<p>Name: Ashton Community Science College Address: Aldwych Drive, Preston, PR2 1SL Contact Number: 01772513002 Age Range: 11-16 yrs Local Education Authority: Lancashire Religious Character: Does not apply Admission Policy: Comprehensive</p>	9.03 miles
	<p>Name: Carr Hill High School Address: Royal Avenue, Preston, PR4 2ST Contact Number: 01772682008 Age Range: 11-16 yrs Local Education Authority: Lancashire Religious Character: Does not apply Admission Policy: Comprehensive</p>	9.11 miles

Disclaimer: The information represented in this section has been sourced from the Department of Education's 2019 results data s and is based on the property's postcode.



Percentage of A level students achieving at least three levels at grades AAB or better, at least two of which are in facilitating subjects

	Name	%
5	Myerscough College	N/A
	Fulwood Academy	N/A
	Preston College	0.0 %
	Ashton Community Science College	N/A
	Carr Hill High School	N/A
	Lancashire	15.1 %
	National	16.5 %

Disclaimer: The information represented in this section has been sourced from the Department of Education's 2019 results data set and is based on the property's postcode.

As well as actual pupil performance in tests and exams, an important Key Performance Indicator is that of Value Added. When pupils start a school, they all have varying levels of ability and social advantage. A school's Value Added score measures how much progress they have made from the beginning to the end of their compulsory secondary education (i.e. between the end of Key Stage 2 and the end of Key Stage 4). It is a quick measurement of the effect of a school on its pupils.

	Name	Value Added
5	Myerscough College	N/A
	Fulwood Academy	N/A
	Preston College	-0.5
	Ashton Community Science College	N/A
	Carr Hill High School	N/A







Everything you want
to know about
local health services





How local are the health services?

We all want good access to local health facilities, wherever we live. To see how well **Market Place** is served, we have set out below the exact locations of hospitals, Accident & Emergency centres, GPs, pharmacies, dentists, out-of-hours medical care and walk-in clinics. Where it's available, you will find more detailed information, including the names of practitioners and their contact details.

	Hospitals	Approx Distance
	Royal Preston Hospital, Sharoe Green Lane North, Preston, Lancashire, PR2 9HT	7.96 miles
	Royal Lancaster Infirmary, Ashton Road, Lancaster, Lancashire, LA1 4RP	9.95 miles
	Blackpool Victoria Hospital, Whinney Heys Road, Blackpool, Lancashire, FY3 8NR	11.25 miles
	Royal Blackburn Hospital, Haslingden Road, Blackburn, Lancashire, BB2 3HH	16.85 miles
	Chorley And South Ribble Hospital, Chorley and South Ribble Hospital, Chorley, Lancashire, PR7 1PP	17.08 miles
	A&E	Approx Distance
	Royal Preston Hospital, Sharoe Green Lane North, Preston, Lancashire, PR2 9HT	7.96 miles
	Royal Lancaster Infirmary, Ashton Road, Lancaster, Lancashire, LA1 4RP	9.95 miles
	Blackpool Victoria Hospital, Whinney Heys Road, Blackpool, Lancashire, FY3 8NR	11.25 miles
	Royal Blackburn Hospital, Haslingden Road, Blackburn, Lancashire, BB2 3HH	16.85 miles
	Chorley And South Ribble Hospital, Chorley and South Ribble Hospital, Chorley, Lancashire, PR7 1PP	17.08 miles

	Walk-in Clinics	Approx Distance
	Same Day Health Centre – Fleetwood, Same Day Health Centre, Fleetwood, Lancashire, FY7 6HP	9.7 miles
	Blackpool Victoria Hospital, Whinney Heys Road, Blackpool, Lancashire, FY3 8NR	11.25 miles
	Blackpool Nhs Walk-in Centre, Whitegate Health Centre, Blackpool, Lancashire, FY3 9ES	12.16 miles
	Same Day Health Centre – Morecambe, Same Day Health Centre, Morecambe, Lancashire, LA4 5LY	12.45 miles
	Dr T L Phillips At Barbara Castle Health Centre, Level Two, Lancashire, BB2 1AX	15.62 miles
	GPs	Approx Distance
	WINDSOR SURGERY, WINDSOR SURGERY, LANCASHIRE, PR3 1PB	0.37 miles
	LANDSCAPE, LANDSCAPE SURGERY, LANCASHIRE, PR3 1PB	0.37 miles
	GREAT ECCLESTON HLTH CTR, GREAT ECCLESTON HLTH CTR, PRESTON, LANCASHIRE, PR3 0ZA	4.88 miles
	BEECH DRIVE SURGERY, THE SURGERY, PRESTON, PR2 3NB	7.54 miles
	DR D C PATEL & PARTNERS, BROADWAY SURGERY, LANCASHIRE, PR2 9TH	7.86 miles
	Dental Surgeons	Approx Distance
	Community Dental Services, Ashton Road, LANCASTER, Lancashire, LA1 4RR	9.81 miles
	Mayo Dental Clinic, Dallas Road, LANCASTER, Lancashire, LA1 1TW	10.2 miles
	Brock Street Dental Practice, 8 Brock Street, LANCASTER, Lancashire, LA1 1UU	10.25 miles
	Central Dental Practice, Telephone House, LANCASTER, Lancashire, LA1 1AB	10.32 miles
	Marketgate Dental Practice, Marketgate Shopping Centre, LANCASTER, Lancashire, LA1 1JF	10.33 miles

Disclaimer: The information represented in this section has been sourced from Experian and is based on the property's postcode.



Farrell Heyworth 7 The High Street, Garstang, PR3 1FA 01995 600666



Everything you want
to know about
local policing





Understanding who polices your neighbourhood

When you move to a new area, you want to know the arrangements for local community policing. See below for essential information about police services near to **Market Place**. We have included location and contact details for the police station and wherever possible, details of police officers assigned to the area.

Your policing neighbourhood

The name of your policing neighbourhood is **Garstang and Calder Vale** and it has a population of **7000**.

Your Local Policing Team			
Name	Rank	Tel No.	E-mail
Dave Kerfoot	Constable		
Matthew Butcher	Constable		

Disclaimer: The information represented in this section has been sourced from data.police.uk.

Disclaimer: The information represented in this section has been sourced from data.police.uk.



