



Everything you need to know about:

**Sharoe Green Lane,  
Fulwood, Preston,  
PR2 9HB**



**Introduction**



**The Property**



**Local Authority**



**Transport Links**

**Education**



**Health**



**Local Policing**





### An invaluable insight into your new home

This i-PACK brochure offers an informed overview of **Sharoe Green Lane** as a potential new home, along with essential material about its surrounding area and its local community. It provides a valuable insight for any prospective owner or tenant.

We wanted to provide you with information that you can absorb quickly, so we have presented it as visually as possible, making use of maps, icons, tables, graphs and charts. Overall, the brochure contains information about:

- **The Property** - including property details, floor plans, room details, photographs and Energy Performance Certificate.
- **Transport** - including locations of bus and coach stops, railway stations and ferry ports.
- **Health** - including locations, contact details and organisational information on the nearest GPs, pharmacies, hospitals and dentists.
- **Local Policing** - including locations, contact details and information about local community policing and the nearest police station, as well as police officers assigned to the area.
- **Education** - including locations of infant, primary and secondary schools and Key Performance Indicators (KPIs) for each key stage.



**Farrell Heyworth** 309 Garstang Road , Preston, PR2 9XJ **01772 787666**



SHAROE GREEN LANE, PRESTON £350,000



x4  
Bedrooms



x2  
Living Rooms



x1  
Bathrooms

Where you are

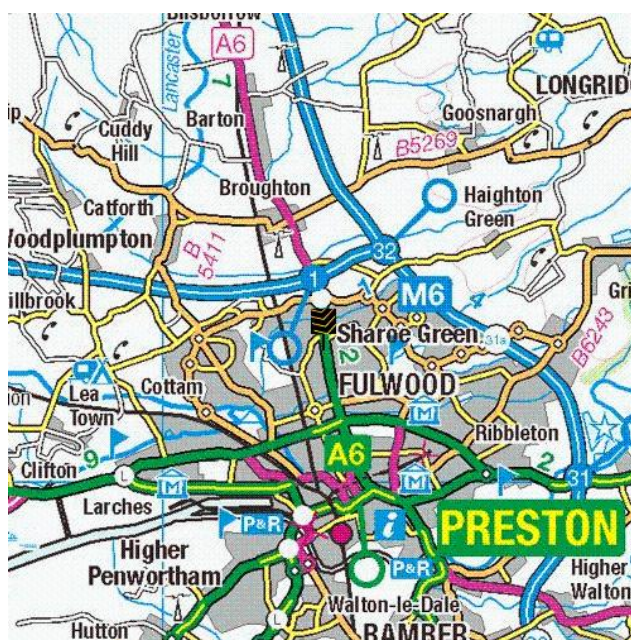
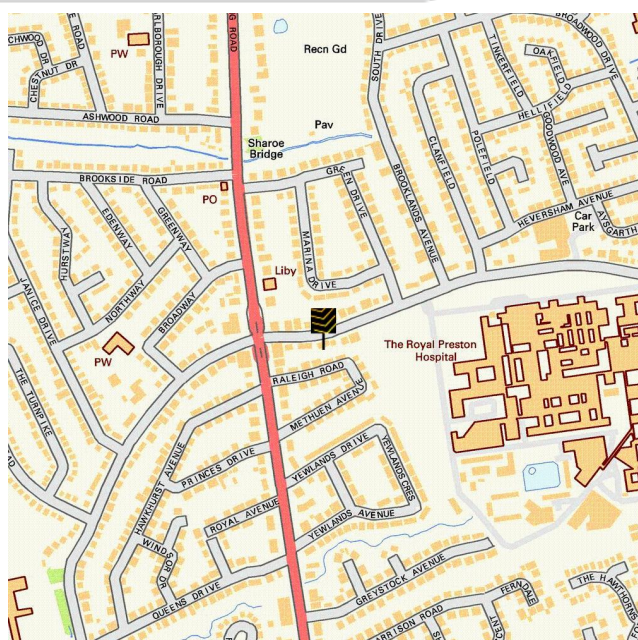



Rear Garden image 3



Lounge image 2





Lounge



Dining Room



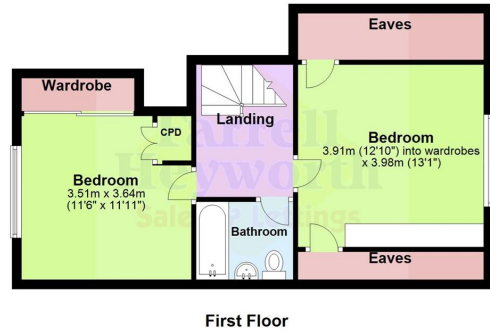
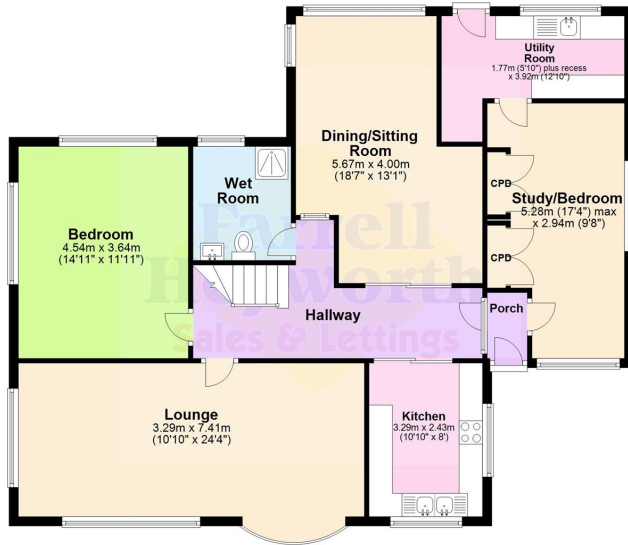



Everything you want  
to know about  
local authorities







**Get to know your local authorities**

Local government directly affects quality of life, particularly when it comes to council tax, planning, waste disposal and the impact of local policies. You may want to investigate how this is likely to affect you if you decide to move. There are nearly 400 local authorities in England, with five different types of local government structure. These can be broadly divided into **single-tier** and **two-tier authorities**. Single-tier authorities are **Metropolitan Authorities, London Boroughs** and **Unitary or Shire Authorities**. Two-tier authorities have both a **County Council**, and a **District Council or City Council**. There are also around 10,000 parish and town councils, effectively creating an additional tier in some areas - mostly, but not exclusively, in rural areas. The National Association of Local Councils (NALC) represents and works on behalf of these community councils and is a useful contact point.

The local authority locations and contact details for **Sharoe Green Lane** are:

Shire / County / District	Website	Address	Contact details
---------------------------	---------	---------	-----------------

**Disclaimer:** The information displayed above has been obtained using the property's postcode in proximity to its local authority. It is recommended that this information is independently verified.



Everything you want  
to know about  
transport links







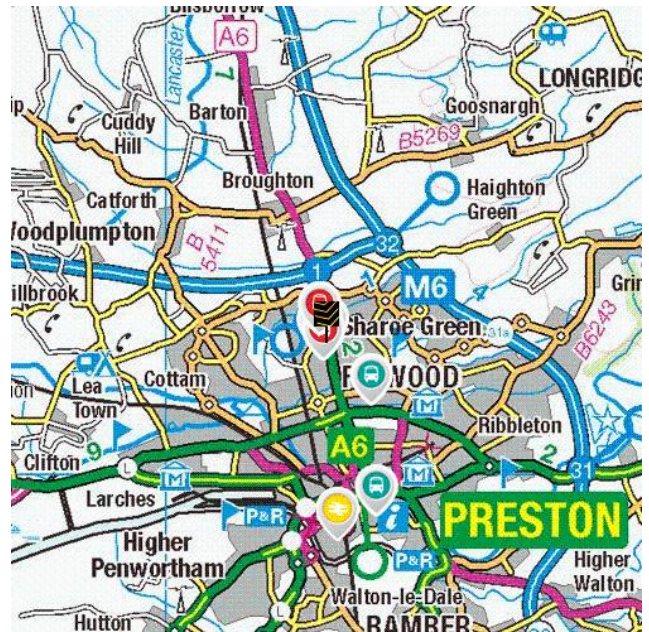
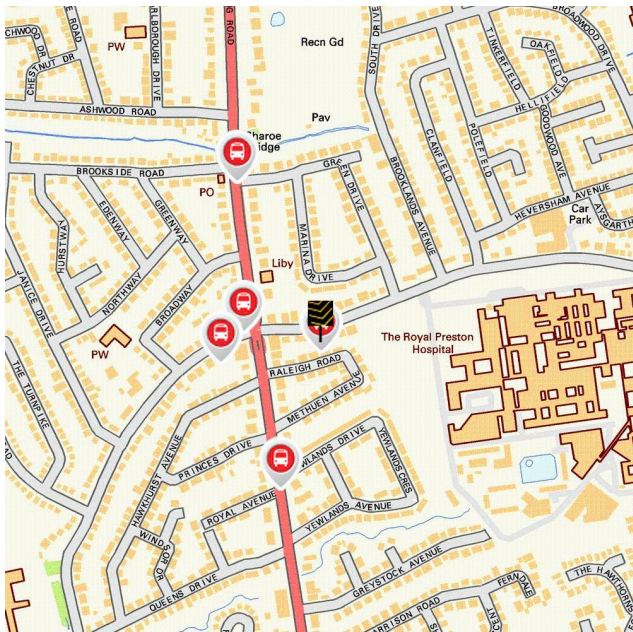

### Become familiar with public transport links

Being able to choose to travel by public transport is important for many reasons. It helps to reduce congestion, provides access to work and education, and facilitates use of health and leisure facilities. If you or your family members travel abroad, access to the nearest ferry terminals is also likely to be a significant factor in choosing a new property. Using the maps below, you can pinpoint the precise locations of transport links for **Sharoe Green Lane**. Tables for each type of transport indicate the property's distance from the nearest bus stops, railway stations, coach stops and ferry terminals (providing that these facilities are within the scale proximity of the maps.)

## Transport Links



	Airports	Approx Distance
	Blackpool International Airport	13.49 miles
	Liverpool John Lennon Airport	31.86 miles
	Manchester Airport	34.73 miles
	Leeds Bradford International Airport	43.19 miles
	Ferry ports	Approx Distance
	Knott End-On-Sea Ferry Landing	14.99 miles
	Fleetwood for Knott End Ferry Landing	15.23 miles
	Heysham Ferry Terminal	18.62 miles
	Piel Island Ferry Landing	26.57 miles
	Liverpool Belfast Ferry Terminal Bootle	26.86 miles
	Train Stations	Approx Distance
	Preston Rail Station	2.38 miles
	Salwick Rail Station	4.34 miles
	Lostock Hall Rail Station	4.73 miles
	Bamber Bridge Rail Station	4.91 miles
	Leyland Rail Station	6.46 miles

**Disclaimer:** The information represented in this section has been sourced from the Department of Transport's Open Data and is based on the property's postcode. It is recommended that this information is independently verified.



**Farrell Heyworth** 309 Garstang Road , Preston, PR2 9XJ 01772 787666

	Bus Stops	Approx Distance
	Blackbull Lane	0.01 miles
	Black Bull Garstang Rd	0.08 miles
	Black Bull	0.1 miles
	Yewlands Drive	0.15 miles
	Brookside Road	0.18 miles
	Coach Stops	Approx Distance
	Fulwood (Preston) Coach Stop	0.91 miles
	Preston Bus Station	2.17 miles
	Freckleton Coach Stop	6.85 miles
	Warton (Lancs): Pickwick Coach Stop	7.93 miles
	Garstang (Lancs): Crofters Hotel Coach Stop	8.69 miles

**Disclaimer:** The information represented in this section has been sourced from the Department of Transport's Open Data and is based on the property's postcode. It is recommended that this information is independently verified.



**Farrell Heyworth** 309 Garstang Road , Preston, PR2 9XJ **01772 787666**



Everything you want  
to know about  
local schools





### How are local schools performing?

If schools are important to you, then this section sets out the published Key Performance Indicators for schools near to your prospective new home. Key Performance Indicators look primarily at how well pupils perform in their tests and examinations, as well as some other measures like attendance.

If you want to know more about a particular school or college, you can also visit the Ofsted website <http://www.ofsted.gov.uk/inspection-reports/find-inspection-report>

### Local Schools

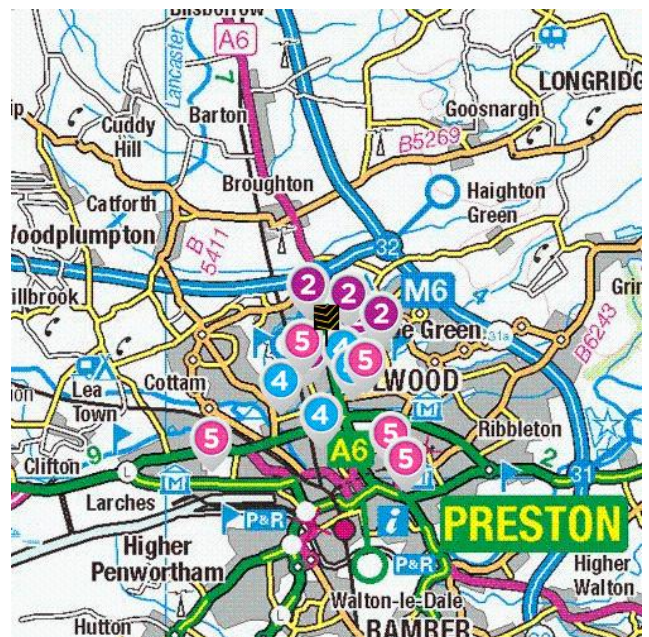
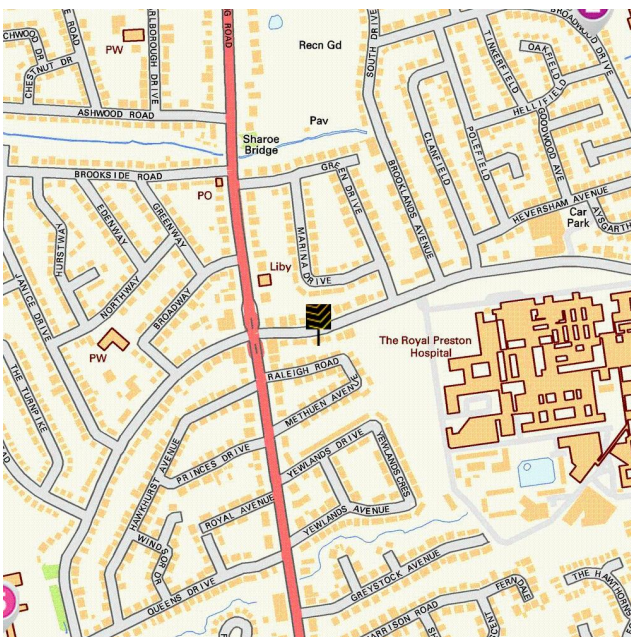

The next page shows tables and charts divided into Key Stages and a list of respective schools local to **Sharoe Green Lane**. There are four main age-related Key Stages defined as:



Special schools are marked with this icon

Key Stage	Definition
Key Stage 1	Fits broadly with the first stage of education, i.e. ages 5-7.
Key Stage 2	Fits the later stage of primary education, often known as junior schools, i.e. ages 8-11. This takes pupils up to the standardised break at age 11 after which pupils generally change schools and transfer to secondary education.
Key Stage 3	Secondary education split between key stages 3 and 4, with key stage 3 covering ages 11-13.
Key Stage 4	Key Stage 4 (ages 14-16) covers the two year period of study for GCSE level examinations.
Key Stage 5	Beyond key stage 4 is 16+ or Sixth Form provision, sometimes unofficially referred to as Key Stage 5.



**Farrell Heyworth** 309 Garstang Road , Preston, PR2 9XJ **01772 787666**



	Key Stage 2 - Information	Approx Distance
	<p><b>Name:</b> St Clare's Catholic Primary School, Preston  <b>Address:</b> Sharoe Green Lane North, Preston, PR2 9HH  <b>Contact Number:</b> 01772787037  <b>Age Range:</b> 4-11 yrs  <b>Local Education Authority:</b> Lancashire  <b>Religious Character:</b> Roman Catholic</p>	0.39 miles
	<p><b>Name:</b> Fulwood, St Peter's Church of England Primary School and Nursery  <b>Address:</b> Meadowfield, Preston, PR2 9RE  <b>Contact Number:</b> 01772864550  <b>Age Range:</b> 3-11 yrs  <b>Local Education Authority:</b> Lancashire  <b>Religious Character:</b> Church of England</p>	0.41 miles
	<p><b>Name:</b> Queen's Drive Primary School  <b>Address:</b> Black Bull Lane, Preston, PR2 3LA  <b>Contact Number:</b> 01772718344  <b>Age Range:</b> 4-11 yrs  <b>Local Education Authority:</b> Lancashire  <b>Religious Character:</b> Does not apply</p>	0.46 miles
	<p><b>Name:</b> Our Lady and St Edward's Catholic Primary School, Preston  <b>Address:</b> Lightfoot Lane, Preston, PR2 3LP  <b>Contact Number:</b> 01772862305  <b>Age Range:</b> 5-11 yrs  <b>Local Education Authority:</b> Lancashire  <b>Religious Character:</b> Roman Catholic</p>	0.48 miles
	<p><b>Name:</b> Sherwood Primary School  <b>Address:</b> Sherwood Way, Preston, PR2 9GA  <b>Contact Number:</b> 01772719093  <b>Age Range:</b> 4-11 yrs  <b>Local Education Authority:</b> Lancashire  <b>Religious Character:</b> Does not apply</p>	0.68 miles

**Disclaimer:** The information represented in this section has been sourced from the Department of Education's 2019 results data s and is based on the property's postcode.



## Reading, Writing and Maths

	Name	Expected	Higher
2	St Clare's Catholic Primary School, Preston	81.0 %	33.0 %
	Fulwood, St Peter's Church of England Primary School and Nursery	97.0 %	32.0 %
	Queen's Drive Primary School	86.0 %	16.0 %
	Our Lady and St Edward's Catholic Primary School, Preston	84.0 %	19.0 %
	Sherwood Primary School	85.0 %	20.0 %
	<b>Lancashire</b>	64.0 %	10.0 %
<b>National</b>	65.0 %	11.0 %	

## Primary Progress Measures

As well as actual pupil performance in tests and exams an important Key Performance Indicator is that of progress measures that compare the actual achievements of other pupils nationally with similar prior attainment. Any increase in attainment achieved by each pupil will be reflected in the schools progress scores. They are fairer to schools in challenging circumstances, as they recognise a school that is doing a good job with an intake with poor prior attainment



## Progress Measures for 2019

	Name	Math	Reading	Writing
2	St Clare's Catholic Primary School, Preston	3.7 %	1.7 %	1.3 %
	Fulwood, St Peter's Church of England Primary School and Nursery	3.4 %	1.6 %	1.5 %
	Queen's Drive Primary School	1.3 %	1.9 %	2.0 %
	Our Lady and St Edward's Catholic Primary School, Preston	0.2 %	1.7 %	-0.2 %
	Sherwood Primary School	1.9 %	2.0 %	1.7 %

**Disclaimer:** The information represented in this section has been sourced from the Department of Education's 2019 results data set and is based on the property's postcode.



Farrell Heyworth 309 Garstang Road , Preston, PR2 9XJ 01772 787666

	Key Stage 4 - Information	Approx Distance
	<p><b>Name:</b> Corpus Christi Catholic High School  <b>Address:</b> St Vincent's Road, Preston, PR2 8QY  <b>Contact Number:</b> 01772716912  <b>Age Range:</b> 11-16 yrs  <b>Local Education Authority:</b> Lancashire  <b>Religious Character:</b> Roman Catholic</p>	0.41 miles
	<p><b>Name:</b> Fulwood Academy  <b>Address:</b> Black Bull Lane, Preston, PR2 9YR  <b>Contact Number:</b> 01772719060  <b>Age Range:</b> 11-16 yrs  <b>Local Education Authority:</b> Lancashire  <b>Religious Character:</b> Does not apply</p>	0.42 miles
	<p><b>Name:</b> Archbishop Temple School, A Church of England Specialist College  <b>Address:</b> St Vincent's Road, Preston, PR2 8RA  <b>Contact Number:</b> 01772717782  <b>Age Range:</b> 11-16 yrs  <b>Local Education Authority:</b> Lancashire  <b>Religious Character:</b> Church of England</p>	0.67 miles
	<p><b>Name:</b> Our Lady's Catholic High School  <b>Address:</b> St Anthony's Drive, Preston, PR2 3SQ  <b>Contact Number:</b> 01772326900  <b>Age Range:</b> 11-16 yrs  <b>Local Education Authority:</b> Lancashire  <b>Religious Character:</b> Roman Catholic</p>	0.94 miles
	<p>  <b>Name:</b> Moorbrook School  <b>Address:</b> Ainslie Road, Preston, PR2 3DB  <b>Contact Number:</b> 01772774752  <b>Age Range:</b> 11-16 yrs  <b>Local Education Authority:</b> Lancashire  <b>Religious Character:</b> Does not apply</p>	1.17 miles

**Disclaimer:** The information represented in this section has been sourced from the Department of Education's 2019 results data s and is based on the property's postcode.



### Percentage of pupils achieving 5+ A\*-C/9-4 or equivalents including 9-4 in both English and mathematics GCSEs

	Name	2019	2018	2017	2016
4	Corpus Christi Catholic High School	46.0 %	50.0 %	45.0 %	32.0 %
	Fulwood Academy	45.0 %	50.0 %	44.0 %	32.0 %
	Archbishop Temple School, A Church of England Specialist College	83.0 %	87.0 %	91.0 %	80.0 %
	Our Lady's Catholic High School	83.0 %	80.0 %	72.0 %	73.0 %
	Moorbrook School	0.0 %	0.0 %	N/A	0.0 %
	<b>Lancashire</b>	<b>66.0 %</b>	<b>66.1 %</b>	<b>61.7 %</b>	<b>58.5 %</b>
	<b>National</b>	<b>60.0 %</b>	<b>59.4 %</b>	<b>56.6 %</b>	<b>53.5 %</b>

**Disclaimer:** The information represented in this section has been sourced from the Department of Education's 2017 results data set and is based on the property's postcode.

### Average number of GCSE entries per pupil

	Name	Number
4	Corpus Christi Catholic High School	7.2
	Fulwood Academy	6.6
	Archbishop Temple School, A Church of England Specialist College	8.7
	Our Lady's Catholic High School	8.5
	Moorbrook School	1.0
	<b>Lancashire</b>	<b>7.5</b>
	<b>National</b>	<b>7.1</b>

**Disclaimer:** The information represented in this section has been sourced from the Department of Education's 2019 results data set and is based on the property's postcode.



**Farrell Heyworth** 309 Garstang Road , Preston, PR2 9XJ **01772 787666**

	Key Stage 5 - Information	Approx Distance
	<b>Name:</b> Fulwood Academy <b>Address:</b> Black Bull Lane, Preston, PR2 9YR <b>Contact Number:</b> 01772719060 <b>Age Range:</b> 11-16 yrs <b>Local Education Authority:</b> Lancashire <b>Religious Character:</b> Does not apply	0.42 miles
	<b>Name:</b> Preston College <b>Address:</b> Fulwood Campus, Preston, PR2 8UR <b>Contact Number:</b> 01772225000 <b>Age Range:</b> 16+ yrs <b>Local Education Authority:</b> Lancashire <b>Religious Character:</b> Does not apply <b>Admission Policy:</b> Not applicable	0.69 miles
	<b>Name:</b> Moor Park High School and Sixth Form <b>Address:</b> Moor Park Avenue, Preston, PR1 6DT <b>Contact Number:</b> 01772795428 <b>Age Range:</b> 11-18 yrs <b>Local Education Authority:</b> Lancashire <b>Religious Character:</b> None	1.6 miles
	<b>Name:</b> Preston Muslim Girls High School <b>Address:</b> Quwwatul Education Centre, Preston, PR1 6QQ <b>Contact Number:</b> 01772651906 <b>Age Range:</b> 11-19 yrs <b>Local Education Authority:</b> Lancashire <b>Religious Character:</b> Muslim	1.96 miles
	<b>Name:</b> Ashton Community Science College <b>Address:</b> Aldwych Drive, Preston, PR2 1SL <b>Contact Number:</b> 01772513002 <b>Age Range:</b> 11-16 yrs <b>Local Education Authority:</b> Lancashire <b>Religious Character:</b> Does not apply <b>Admission Policy:</b> Comprehensive	2.05 miles

**Disclaimer:** The information represented in this section has been sourced from the Department of Education's 2019 results data s and is based on the property's postcode.



**Percentage of A level students achieving at least three levels at grades AAB or better, at least two of which are in facilitating subjects**

	Name	%
5	Fulwood Academy	N/A
	Preston College	0.0 %
	Moor Park High School and Sixth Form	0.0 %
	Preston Muslim Girls High School	N/A
	Ashton Community Science College	N/A
	<b>Lancashire</b>	<b>15.1 %</b>
	<b>National</b>	<b>16.5 %</b>

**Disclaimer:** The information represented in this section has been sourced from the Department of Education's 2019 results data set and is based on the property's postcode.

As well as actual pupil performance in tests and exams, an important Key Performance Indicator is that of Value Added. When pupils start a school, they all have varying levels of ability and social advantage. A school's Value Added score measures how much progress they have made from the beginning to the end of their compulsory secondary education (i.e. between the end of Key Stage 2 and the end of Key Stage 4). It is a quick measurement of the effect of a school on its pupils.

	Name	Value Added
5	Fulwood Academy	N/A
	Preston College	-0.5
	Moor Park High School and Sixth Form	0.1
	Preston Muslim Girls High School	N/A
	Ashton Community Science College	N/A



**Farrell Heyworth** 309 Garstang Road , Preston, PR2 9XJ **01772 787666**



Everything you want  
to know about  
local health services





**How local are the health services?**

We all want good access to local health facilities, wherever we live. To see how well **Sharoe Green Lane** is served, we have set out below the exact locations of hospitals, Accident & Emergency centres, GPs, pharmacies, dentists, out-of-hours medical care and walk-in clinics. Where it's available, you will find more detailed information, including the names of practitioners and their contact details.

	Hospitals	Approx Distance
	Royal Preston Hospital, Sharoe Green Lane North, Preston, Lancashire, PR2 9HT	0.18 miles
	Chorley And South Ribble Hospital, Chorley and South Ribble Hospital, Chorley, Lancashire, PR7 1PP	9.17 miles
	Royal Blackburn Hospital, Haslingden Road, Blackburn, Lancashire, BB2 3HH	10.69 miles
	Blackpool Victoria Hospital, Whinney Heys Road, Blackpool, Lancashire, FY3 8NR	12.58 miles
	Accrington Victoria Hospital, BB5 6AS	14.24 miles
	A&E	Approx Distance
	Royal Preston Hospital, Sharoe Green Lane North, Preston, Lancashire, PR2 9HT	0.18 miles
	Chorley And South Ribble Hospital, Chorley and South Ribble Hospital, Chorley, Lancashire, PR7 1PP	9.17 miles
	Royal Blackburn Hospital, Haslingden Road, Blackburn, Lancashire, BB2 3HH	10.69 miles
	Blackpool Victoria Hospital, Whinney Heys Road, Blackpool, Lancashire, FY3 8NR	12.58 miles
	Southport And Formby District General Hospital, Southport, Merseyside, PR8 6PN	15.39 miles



	Walk-in Clinics	Approx Distance
	Dr T L Phillips At Barbara Castle Health Centre, Level Two, Lancashire, BB2 1AX	9.61 miles
	Royal Blackburn Hospital, Haslingden Road, Blackburn, Lancashire, BB2 3HH	10.69 miles
	Darwen Health Care, Darwen Health Centre, Lancashire, BB3 1PY	11.83 miles
	Blackpool Victoria Hospital, Whinney Heys Road, Blackpool, Lancashire, FY3 8NR	12.58 miles
	Blackpool Nhs Walk-in Centre, Whitegate Health Centre, Blackpool, Lancashire, FY3 9ES	13.24 miles
	GPs	Approx Distance
	DR D C PATEL & PARTNERS, BROADWAY SURGERY, LANCASHIRE, PR2 9TH	0.13 miles
	BEECH DRIVE SURGERY, THE SURGERY, PRESTON, PR2 3NB	0.37 miles
	LYTHAM ROAD SURGERY, LYTHAM ROAD SURGERY, PR2 8JB	0.92 miles
	THE HEALTHCARE CENTRE, THE HEALTHCARE CENTRE, LANCASHIRE, PR1 5AF	1.41 miles
	MEDICOM LTD, THE HEALTHCARE CENTRE, LANCASHIRE, PR1 5AF	1.41 miles
	Dental Surgeons	Approx Distance
	Community Dental Services, Ashton Road, LANCASTER, Lancashire, LA1 4RR	17.61 miles
	Mayo Dental Clinic, Dallas Road, LANCASTER, Lancashire, LA1 1TW	18.01 miles
	Brock Street Dental Practice, 8 Brock Street, LANCASTER, Lancashire, LA1 1UU	18.04 miles
	Marketgate Dental Practice, Marketgate Shopping Centre, LANCASTER, Lancashire, LA1 1JF	18.12 miles
	3a Dental Care, 3 Great John Street, LANCASTER, Lancashire, LA1 1NQ	18.13 miles

**Disclaimer:** The information represented in this section has been sourced from Experian and is based on the property's postcode.



**Farrell Heyworth** 309 Garstang Road , Preston, PR2 9XJ **01772 787666**



Everything you want  
to know about  
local policing





### Understanding who polices your neighbourhood

When you move to a new area, you want to know the arrangements for local community policing. See below for essential information about police services near to **Sharoe Green Lane**. We have included location and contact details for the police station and wherever possible, details of police officers assigned to the area.

#### Your policing neighbourhood

The name of your policing neighbourhood is **Sharoe Green** and it has a population of **6279**.

Your Local Policing Team			
Name	Rank	Tel No.	E-mail
Kris Dell	Constable		
Gemma McDonough	PCSO		

**Disclaimer:** The information represented in this section has been sourced from data.police.uk.

#### Locations of Interest

Preston Police Station  
 station  
 Lancaster Road North Preston

Preston Police Station is open 08:00 to 20:00 Monday to Friday, 09:00 to 18:00 Saturday and Sunday

**Disclaimer:** The information represented in this section has been sourced from data.police.uk.



**Farrell Heyworth 309 Garstang Road , Preston, PR2 9XJ 01772 787666**

