



Everything you need to know about:

Merton Avenue,
Fulwood, Preston,
PR2 8HX



Introduction



The Property



Local Authority



Transport Links

Education



Health



Local Policing





An invaluable insight into your new home

This i-PACK brochure offers an informed overview of **Merton Avenue** as a potential new home, along with essential material about its surrounding area and its local community. It provides a valuable insight for any prospective owner or tenant.

We wanted to provide you with information that you can absorb quickly, so we have presented it as visually as possible, making use of maps, icons, tables, graphs and charts. Overall, the brochure contains information about:

- **The Property** - including property details, floor plans, room details, photographs and Energy Performance Certificate.
- **Transport** - including locations of bus and coach stops, railway stations and ferry ports.
- **Health** - including locations, contact details and organisational information on the nearest GPs, pharmacies, hospitals and dentists.
- **Local Policing** - including locations, contact details and information about local community policing and the nearest police station, as well as police officers assigned to the area.
- **Education** - including locations of infant, primary and secondary schools and Key Performance Indicators (KPIs) for each key stage.



Farrell Heyworth 309 Garstang Road , Preston, PR2 9XJ **01772 787666**



MERTON AVENUE, PRESTON £374,950



x3
Bedrooms



x2
Living Rooms



x1
Bathrooms

Where you are

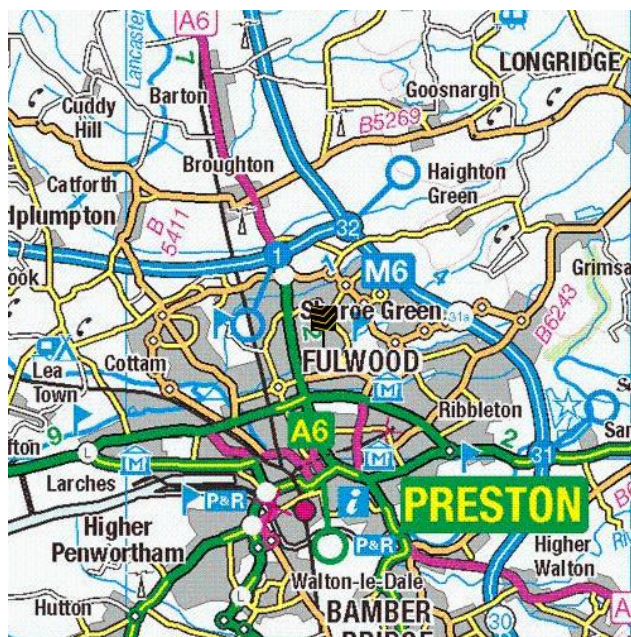
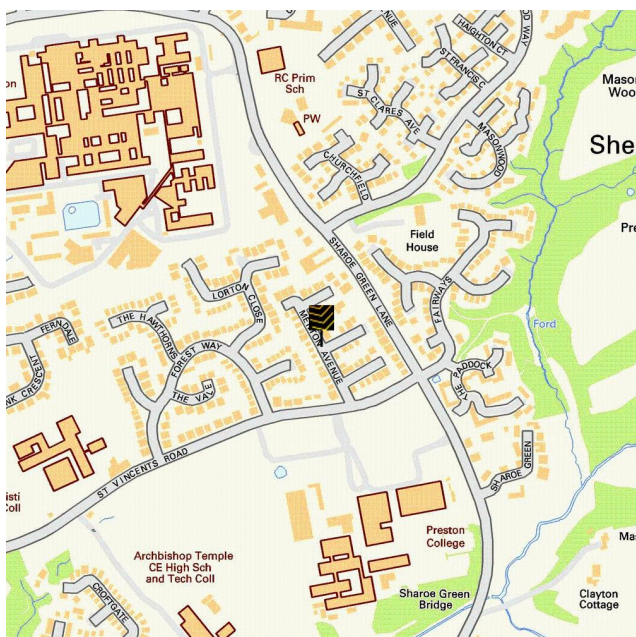



Rear Garden image 3



Lounge





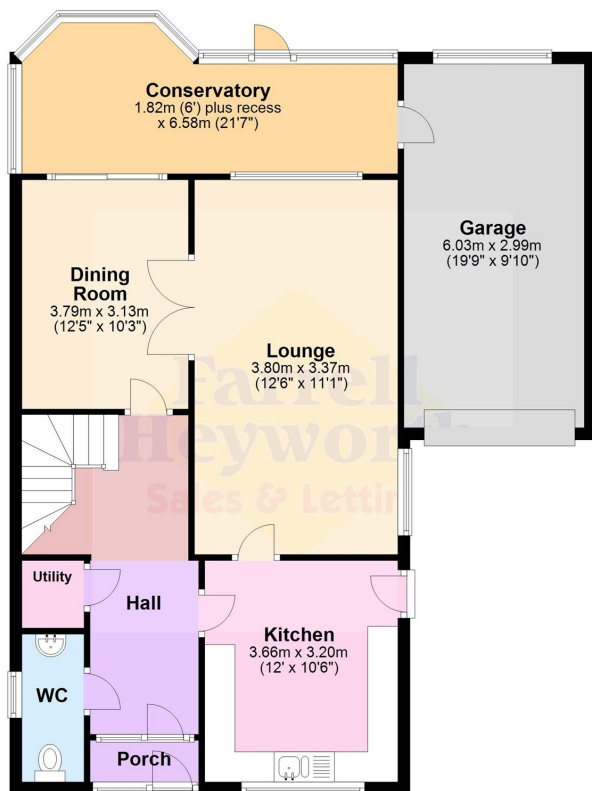

Ground Floor

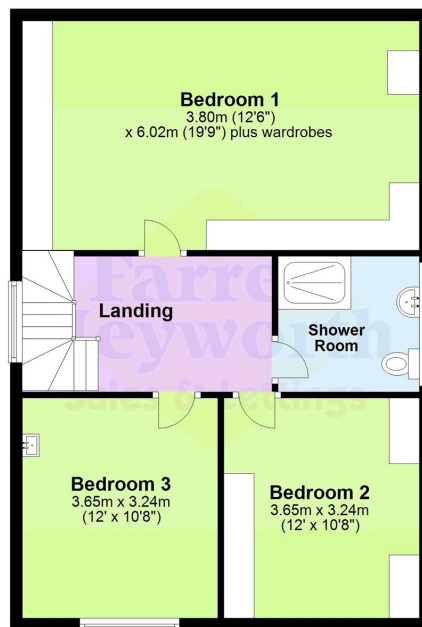

First Floor





Everything you want
to know about
local authorities





Get to know your local authorities

Local government directly affects quality of life, particularly when it comes to council tax, planning, waste disposal and the impact of local policies. You may want to investigate how this is likely to affect you if you decide to move. There are nearly 400 local authorities in England, with five different types of local government structure. These can be broadly divided into **single-tier** and **two-tier authorities**. Single-tier authorities are **Metropolitan Authorities, London Boroughs** and **Unitary or Shire Authorities**. Two-tier authorities have both a **County Council**, and a **District Council or City Council**. There are also around 10,000 parish and town councils, effectively creating an additional tier in some areas - mostly, but not exclusively, in rural areas. The National Association of Local Councils (NALC) represents and works on behalf of these community councils and is a useful contact point.

The local authority locations and contact details for **Merton Avenue** are:

Shire / County / District	Website	Address	Contact details
---------------------------	---------	---------	-----------------

Disclaimer: The information displayed above has been obtained using the property's postcode in proximity to its local authority. It is recommended that this information is independently verified.



Everything you want
to know about
transport links







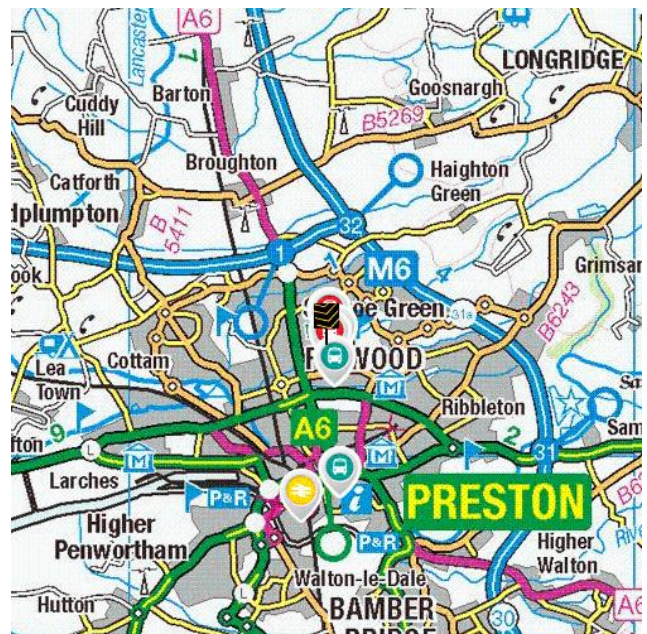
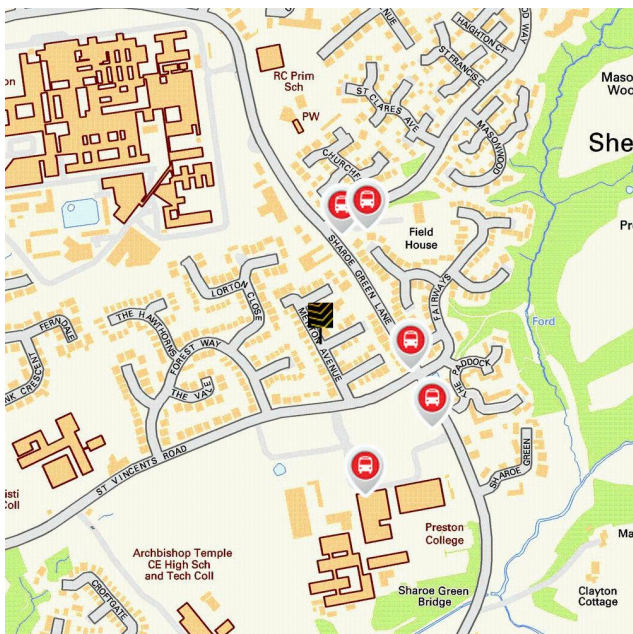

Become familiar with public transport links

Being able to choose to travel by public transport is important for many reasons. It helps to reduce congestion, provides access to work and education, and facilitates use of health and leisure facilities. If you or your family members travel abroad, access to the nearest ferry terminals is also likely to be a significant factor in choosing a new property. Using the maps below, you can pinpoint the precise locations of transport links for **Merton Avenue**. Tables for each type of transport indicate the property's distance from the nearest bus stops, railway stations, coach stops and ferry terminals (providing that these facilities are within the scale proximity of the maps.)

Transport Links



	Airports	Approx Distance
	Blackpool International Airport	13.92 miles
	Liverpool John Lennon Airport	31.7 miles
	Manchester Airport	34.28 miles
	Leeds Bradford International Airport	42.78 miles
	Ferry ports	Approx Distance
	Knott End-On-Sea Ferry Landing	15.49 miles
	Fleetwood for Knott End Ferry Landing	15.74 miles
	Heysham Ferry Terminal	19.05 miles
	Liverpool Belfast Ferry Terminal Bootle	26.85 miles
	Piel Island Ferry Landing	27.07 miles
	Train Stations	Approx Distance
	Preston Rail Station	2.14 miles
	Lostock Hall Rail Station	4.41 miles
	Bamber Bridge Rail Station	4.5 miles
	Salwick Rail Station	4.76 miles
	Leyland Rail Station	6.15 miles

Disclaimer: The information represented in this section has been sourced from the Department of Transport's Open Data and is based on the property's postcode. It is recommended that this information is independently verified.



Farrell Heyworth 309 Garstang Road , Preston, PR2 9XJ **01772 787666**

	Bus Stops	Approx Distance
	St Vincents Road	0.09 miles
	Churchfields	0.11 miles
	Churchfield	0.13 miles
	Preston College	0.13 miles
	Preston College Grounds	0.15 miles
	Coach Stops	Approx Distance
	Fulwood (Preston) Coach Stop	0.48 miles
	Preston Bus Station	1.84 miles
	Freckleton Coach Stop	7.19 miles
	Warton (Lancs): Pickwick Coach Stop	8.27 miles
	Garstang (Lancs): Crofters Hotel Coach Stop	9.07 miles

Disclaimer: The information represented in this section has been sourced from the Department of Transport's Open Data and is based on the property's postcode. It is recommended that this information is independently verified.



Farrell Heyworth 309 Garstang Road , Preston, PR2 9XJ **01772 787666**



Everything you want
to know about
local schools





How are local schools performing?

If schools are important to you, then this section sets out the published Key Performance Indicators for schools near to your prospective new home. Key Performance Indicators look primarily at how well pupils perform in their tests and examinations, as well as some other measures like attendance.

If you want to know more about a particular school or college, you can also visit the Ofsted website <http://www.ofsted.gov.uk/inspection-reports/find-inspection-report>

Local Schools

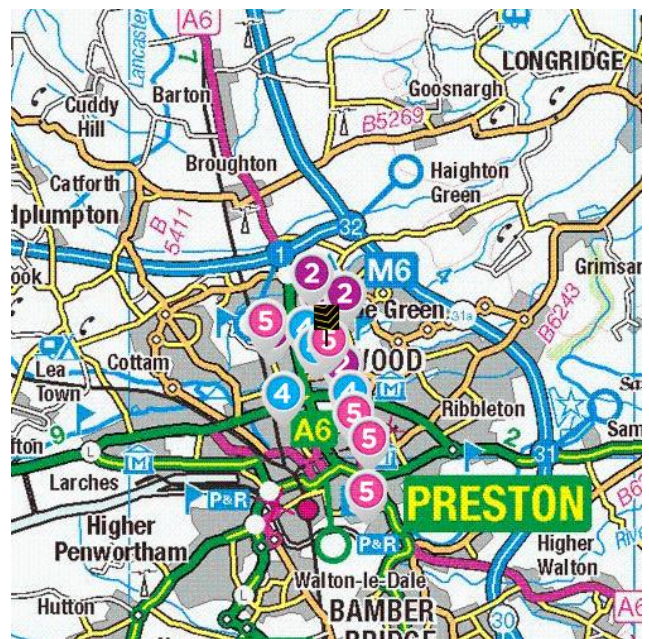
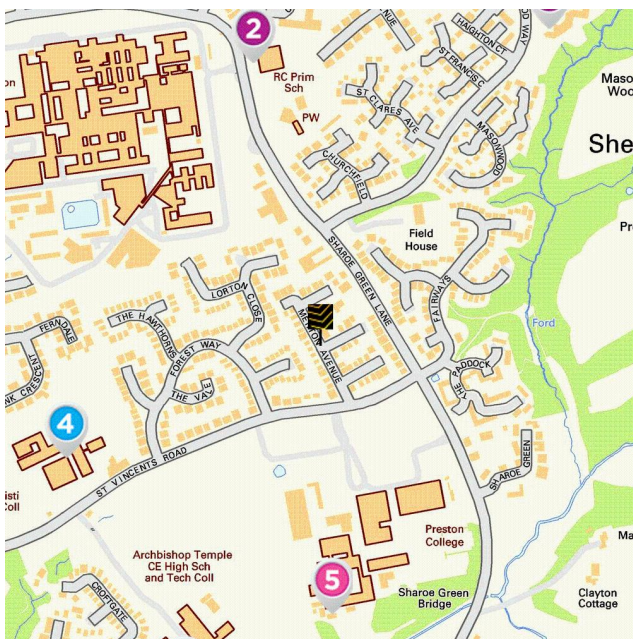

The next page shows tables and charts divided into Key Stages and a list of respective schools local to **Merton Avenue**. There are four main age-related Key Stages defined as:



Special schools are marked with this icon

Key Stage	Definition
Key Stage 1	Fits broadly with the first stage of education, i.e. ages 5-7.
Key Stage 2	Fits the later stage of primary education, often known as junior schools, i.e. ages 8-11. This takes pupils up to the standardised break at age 11 after which pupils generally change schools and transfer to secondary education.
Key Stage 3	Secondary education split between key stages 3 and 4, with key stage 3 covering ages 11-13.
Key Stage 4	Key Stage 4 (ages 14-16) covers the two year period of study for GCSE level examinations.
Key Stage 5	Beyond key stage 4 is 16+ or Sixth Form provision, sometimes unofficially referred to as Key Stage 5.



Farrell Heyworth 309 Garstang Road , Preston, PR2 9XJ **01772 787666**

	Key Stage 2 - Information	Approx Distance
	<p>Name: St Clare's Catholic Primary School, Preston Address: Sharoe Green Lane North, Preston, PR2 9HH Contact Number: 01772787037 Age Range: 4-11 yrs Local Education Authority: Lancashire Religious Character: Roman Catholic</p>	0.29 miles
	<p>Name: Sherwood Primary School Address: Sherwood Way, Preston, PR2 9GA Contact Number: 01772719093 Age Range: 4-11 yrs Local Education Authority: Lancashire Religious Character: Does not apply</p>	0.39 miles
	<p>Name: Kennington Primary School Address: Kennington Road, Preston, PR2 8ER Contact Number: 01772774044 Age Range: 4-11 yrs Local Education Authority: Lancashire Religious Character: Does not apply</p>	0.59 miles
	<p>Name: Fulwood, St Peter's Church of England Primary School and Nursery Address: Meadowfield, Preston, PR2 9RE Contact Number: 01772864550 Age Range: 3-11 yrs Local Education Authority: Lancashire Religious Character: Church of England</p>	0.59 miles
	<p>Name: Queen's Drive Primary School Address: Black Bull Lane, Preston, PR2 3LA Contact Number: 01772718344 Age Range: 4-11 yrs Local Education Authority: Lancashire Religious Character: Does not apply</p>	0.7 miles

Disclaimer: The information represented in this section has been sourced from the Department of Education's 2019 results data s and is based on the property's postcode.



Reading, Writing and Maths

	Name	Expected	Higher
2	St Clare's Catholic Primary School, Preston	81.0 %	33.0 %
	Sherwood Primary School	85.0 %	20.0 %
	Kennington Primary School	71.0 %	15.0 %
	Fulwood, St Peter's Church of England Primary School and Nursery	97.0 %	32.0 %
	Queen's Drive Primary School	86.0 %	16.0 %
	Lancashire	64.0 %	10.0 %
	National	65.0 %	11.0 %

Primary Progress Measures

As well as actual pupil performance in tests and exams an important Key Performance Indicator is that of progress measures that compare the actual achievements of other pupils nationally with similar prior attainment. Any increase in attainment achieved by each pupil will be reflected in the schools progress scores. They are fairer to schools in challenging circumstances, as they recognise a school that is doing a good job with an intake with poor prior attainment



Progress Measures for 2019

	Name	Math	Reading	Writing
2	St Clare's Catholic Primary School, Preston	3.7 %	1.7 %	1.3 %
	Sherwood Primary School	1.9 %	2.0 %	1.7 %
	Kennington Primary School	1.5 %	2.5 %	2.2 %
	Fulwood, St Peter's Church of England Primary School and Nursery	3.4 %	1.6 %	1.5 %
	Queen's Drive Primary School	1.3 %	1.9 %	2.0 %

Disclaimer: The information represented in this section has been sourced from the Department of Education's 2019 results data set and is based on the property's postcode.



Farrell Heyworth 309 Garstang Road , Preston, PR2 9XJ 01772 787666

	Key Stage 4 - Information	Approx Distance
	<p>Name: Corpus Christi Catholic High School Address: St Vincent's Road, Preston, PR2 8QY Contact Number: 01772716912 Age Range: 11-16 yrs Local Education Authority: Lancashire Religious Character: Roman Catholic</p>	0.27 miles
	<p>Name: Archbishop Temple School, A Church of England Specialist College Address: St Vincent's Road, Preston, PR2 8RA Contact Number: 01772717782 Age Range: 11-16 yrs Local Education Authority: Lancashire Religious Character: Church of England</p>	0.36 miles
	<p>Name: Fulwood Academy Address: Black Bull Lane, Preston, PR2 9YR Contact Number: 01772719060 Age Range: 11-16 yrs Local Education Authority: Lancashire Religious Character: Does not apply</p>	0.77 miles
	<p>Name: Sir Tom Finney Community High School  Address: Moor Park, Preston, PR1 6AA Contact Number: 01772795749 Age Range: 11-19 yrs Local Education Authority: Lancashire Religious Character: Does not apply</p>	0.94 miles
	<p>Name: Moorbrook School  Address: Ainslie Road, Preston, PR2 3DB Contact Number: 01772774752 Age Range: 11-16 yrs Local Education Authority: Lancashire Religious Character: Does not apply</p>	1.06 miles

Disclaimer: The information represented in this section has been sourced from the Department of Education's 2019 results data and is based on the property's postcode.



Percentage of pupils achieving 5+ A*-C/9-4 or equivalents including 9-4 in both English and mathematics GCSEs

	Name	2019	2018	2017	2016
4	Corpus Christi Catholic High School	46.0 %	50.0 %	45.0 %	32.0 %
	Archbishop Temple School, A Church of England Specialist College	83.0 %	87.0 %	91.0 %	80.0 %
	Fulwood Academy	45.0 %	50.0 %	44.0 %	32.0 %
	Sir Tom Finney Community High School	N/A	N/A	0.0 %	0.0 %
	Moorbrook School	0.0 %	0.0 %	N/A	0.0 %
	Lancashire	66.0 %	66.1 %	61.7 %	58.5 %
	National	60.0 %	59.4 %	56.6 %	53.5 %

Disclaimer: The information represented in this section has been sourced from the Department of Education's 2017 results data set and is based on the property's postcode.

Average number of GCSE entries per pupil

	Name	Number
4	Corpus Christi Catholic High School	7.2
	Archbishop Temple School, A Church of England Specialist College	8.7
	Fulwood Academy	6.6
	Sir Tom Finney Community High School	N/A
	Moorbrook School	1.0
	Lancashire	7.5
	National	7.1

Disclaimer: The information represented in this section has been sourced from the Department of Education's 2019 results data set and is based on the property's postcode.



	Key Stage 5 - Information	Approx Distance
	<p>Name: Preston College Address: Fulwood Campus, Preston, PR2 8UR Contact Number: 01772225000 Age Range: 16+ yrs Local Education Authority: Lancashire Religious Character: Does not apply Admission Policy: Not applicable</p>	0.26 miles
	<p>Name: Fulwood Academy Address: Black Bull Lane, Preston, PR2 9YR Contact Number: 01772719060 Age Range: 11-16 yrs Local Education Authority: Lancashire Religious Character: Does not apply</p>	0.77 miles
	<p>Name: Moor Park High School and Sixth Form Address: Moor Park Avenue, Preston, PR1 6DT Contact Number: 01772795428 Age Range: 11-18 yrs Local Education Authority: Lancashire Religious Character: None</p>	1.19 miles
	<p>Name: Preston Muslim Girls High School Address: Quwwatul Education Centre, Preston, PR1 6QQ Contact Number: 01772651906 Age Range: 11-19 yrs Local Education Authority: Lancashire Religious Character: Muslim</p>	1.55 miles
	<p>Name: Cardinal Newman College Address: Lark Hill Road, Preston, PR1 4HD Contact Number: 01772460181 Age Range: 16+ yrs Local Education Authority: Lancashire Religious Character: Roman Catholic Admission Policy: Not applicable</p>	2.16 miles

Disclaimer: The information represented in this section has been sourced from the Department of Education's 2019 results data s and is based on the property's postcode.



Percentage of A level students achieving at least three levels at grades AAB or better, at least two of which are in facilitating subjects

	Name	%
5	Preston College	0.0 %
	Fulwood Academy	N/A
	Moor Park High School and Sixth Form	0.0 %
	Preston Muslim Girls High School	N/A
	Cardinal Newman College	13.1 %
	Lancashire	15.1 %
	National	16.5 %

Disclaimer: The information represented in this section has been sourced from the Department of Education's 2019 results data set and is based on the property's postcode.

As well as actual pupil performance in tests and exams, an important Key Performance Indicator is that of Value Added. When pupils start a school, they all have varying levels of ability and social advantage. A school's Value Added score measures how much progress they have made from the beginning to the end of their compulsory secondary education (i.e. between the end of Key Stage 2 and the end of Key Stage 4). It is a quick measurement of the effect of a school on its pupils.

	Name	Value Added
5	Preston College	-0.5
	Fulwood Academy	N/A
	Moor Park High School and Sixth Form	0.1
	Preston Muslim Girls High School	N/A
	Cardinal Newman College	0.2



Farrell Heyworth 309 Garstang Road , Preston, PR2 9XJ **01772 787666**



Everything you want
to know about
local health services





How local are the health services?

We all want good access to local health facilities, wherever we live. To see how well **Merton Avenue** is served, we have set out below the exact locations of hospitals, Accident & Emergency centres, GPs, pharmacies, dentists, out-of-hours medical care and walk-in clinics. Where it's available, you will find more detailed information, including the names of practitioners and their contact details.

	Hospitals	Approx Distance
	Royal Preston Hospital, Sharoe Green Lane North, Preston, Lancashire, PR2 9HT	0.37 miles
	Chorley And South Ribble Hospital, Chorley and South Ribble Hospital, Chorley, Lancashire, PR7 1PP	8.79 miles
	Royal Blackburn Hospital, Haslingden Road, Blackburn, Lancashire, BB2 3HH	10.18 miles
	Blackpool Victoria Hospital, Whinney Heys Road, Blackpool, Lancashire, FY3 8NR	13.06 miles
	Accrington Victoria Hospital, BB5 6AS	13.76 miles
	A&E	Approx Distance
	Royal Preston Hospital, Sharoe Green Lane North, Preston, Lancashire, PR2 9HT	0.37 miles
	Chorley And South Ribble Hospital, Chorley and South Ribble Hospital, Chorley, Lancashire, PR7 1PP	8.79 miles
	Royal Blackburn Hospital, Haslingden Road, Blackburn, Lancashire, BB2 3HH	10.18 miles
	Blackpool Victoria Hospital, Whinney Heys Road, Blackpool, Lancashire, FY3 8NR	13.06 miles
	Southport And Formby District General Hospital, Southport, Merseyside, PR8 6PN	15.55 miles

	Walk-in Clinics	Approx Distance
	Dr T L Phillips At Barbara Castle Health Centre, Level Two, Lancashire, BB2 1AX	9.11 miles
	Royal Blackburn Hospital, Haslingden Road, Blackburn, Lancashire, BB2 3HH	10.18 miles
	Darwen Health Care, Darwen Health Centre, Lancashire, BB3 1PY	11.31 miles
	Blackpool Victoria Hospital, Whinney Heys Road, Blackpool, Lancashire, FY3 8NR	13.06 miles
	Blackpool Nhs Walk-in Centre, Whitegate Health Centre, Blackpool, Lancashire, FY3 9ES	13.72 miles
	GPs	Approx Distance
	DR D C PATEL & PARTNERS, BROADWAY SURGERY, LANCASHIRE, PR2 9TH	0.64 miles
	LYTHAM ROAD SURGERY, LYTHAM ROAD SURGERY, PR2 8JB	0.78 miles
	BEECH DRIVE SURGERY, THE SURGERY, PRESTON, PR2 3NB	0.86 miles
	THE HEALTHCARE CENTRE, THE HEALTHCARE CENTRE, LANCASHIRE, PR1 5AF	0.94 miles
	MEDICOM LTD, THE HEALTHCARE CENTRE, LANCASHIRE, PR1 5AF	0.94 miles
	Dental Surgeons	Approx Distance
	Community Dental Services, Ashton Road, LANCASTER, Lancashire, LA1 4RR	17.95 miles
	Mayo Dental Clinic, Dallas Road, LANCASTER, Lancashire, LA1 1TW	18.36 miles
	Brock Street Dental Practice, 8 Brock Street, LANCASTER, Lancashire, LA1 1UU	18.37 miles
	Marketgate Dental Practice, Marketgate Shopping Centre, LANCASTER, Lancashire, LA1 1JF	18.46 miles
	3a Dental Care, 3 Great John Street, LANCASTER, Lancashire, LA1 1NQ	18.46 miles

Disclaimer: The information represented in this section has been sourced from Experian and is based on the property's postcode.



Farrell Heyworth 309 Garstang Road , Preston, PR2 9XJ **01772 787666**



Everything you want
to know about
local policing





Understanding who polices your neighbourhood

When you move to a new area, you want to know the arrangements for local community policing. See below for essential information about police services near to **Merton Avenue**. We have included location and contact details for the police station and wherever possible, details of police officers assigned to the area.

Your policing neighbourhood

The name of your policing neighbourhood is **College & Moorpark** and it has a population of **4759**.

Your Local Policing Team

Name	Rank	Tel No.	E-mail
Bernie Clark	Constable		

Disclaimer: The information represented in this section has been sourced from data.police.uk.

Disclaimer: The information represented in this section has been sourced from data.police.uk.



