



Everything you need to know about:

Smithy Lane,
Heysham, Morecambe,
LA3 2QH



Introduction



The Property



Local Authority



Transport Links

Education



Health



Local Policing





An invaluable insight into your new home

This i-PACK brochure offers an informed overview of **Smithy Lane** as a potential new home, along with essential material about its surrounding area and its local community. It provides a valuable insight for any prospective owner or tenant.

We wanted to provide you with information that you can absorb quickly, so we have presented it as visually as possible, making use of maps, icons, tables, graphs and charts. Overall, the brochure contains information about:

- **The Property** - including property details, floor plans, room details, photographs and Energy Performance Certificate.
- **Transport** - including locations of bus and coach stops, railway stations and ferry ports.
- **Health** - including locations, contact details and organisational information on the nearest GPs, pharmacies, hospitals and dentists.
- **Local Policing** - including locations, contact details and information about local community policing and the nearest police station, as well as police officers assigned to the area.
- **Education** - including locations of infant, primary and secondary schools and Key Performance Indicators (KPIs) for each key stage.



Farrell Heyworth 3-7 Victoria Street, Morecambe, LA4 4AE **01524 832929**



SMITHY LANE, MORECAMBE £195,000



x3
Bedrooms



x1
Living Rooms



x1
Bathrooms

Where you are

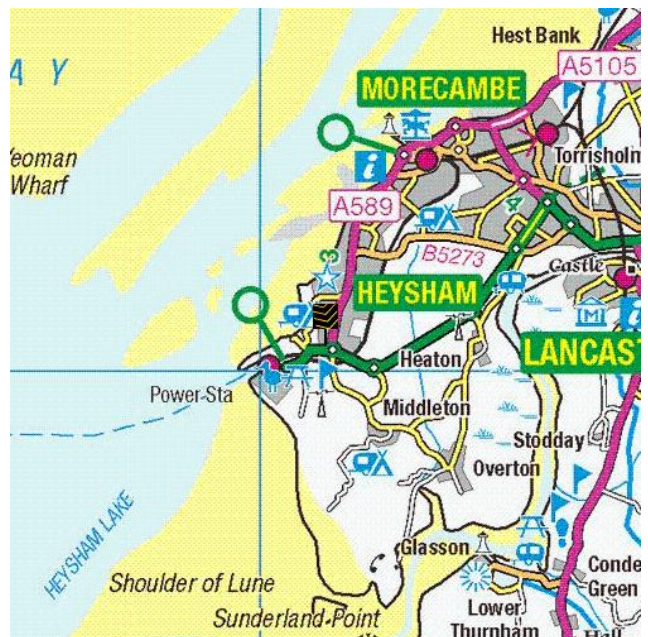
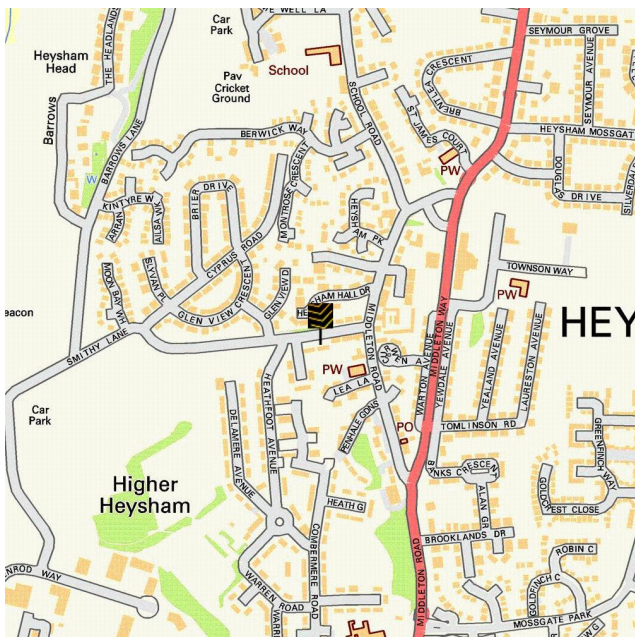



Reception



Kitchen diner





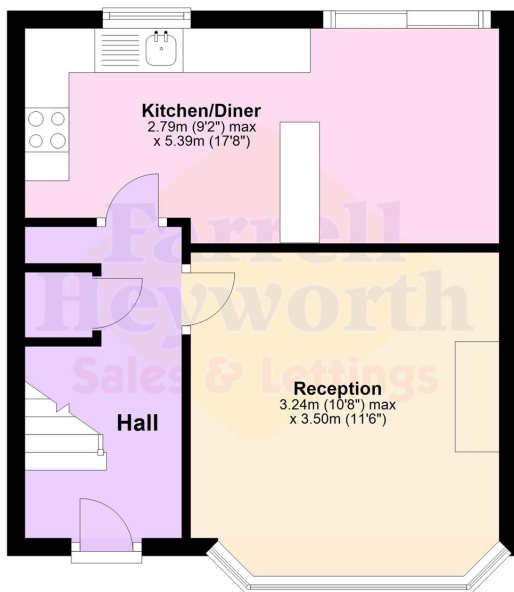

Ground Floor

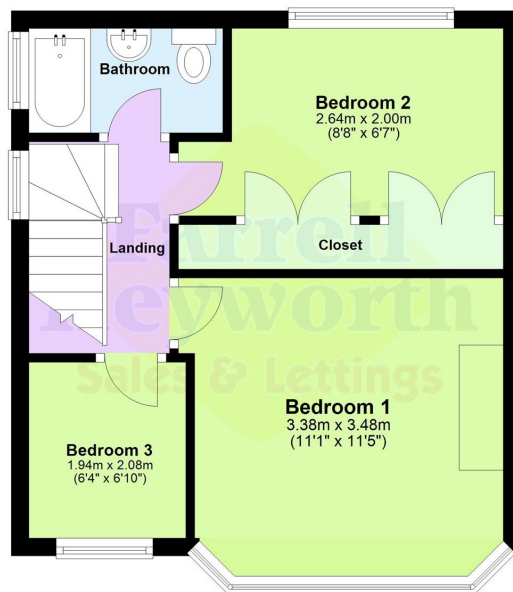

First Floor





Everything you want
to know about
local authorities





Get to know your local authorities

Local government directly affects quality of life, particularly when it comes to council tax, planning, waste disposal and the impact of local policies. You may want to investigate how this is likely to affect you if you decide to move. There are nearly 400 local authorities in England, with five different types of local government structure. These can be broadly divided into **single-tier** and **two-tier authorities**.

Single-tier authorities are **Metropolitan Authorities**, **London Boroughs** and **Unitary** or **Shire Authorities**.

Two-tier authorities have both a **County Council**, and a **District Council** or **City Council**.

There are also around 10,000 parish and town councils, effectively creating an additional tier in some areas - mostly, but not exclusively, in rural areas. The National Association of Local Councils (NALC) represents and works on behalf of these community councils and is a useful contact point.

The local authority locations and contact details for **Smithy Lane** are:

Shire / County / District	Website	Address	Contact details
---------------------------	---------	---------	-----------------

Disclaimer: The information displayed above has been obtained using the property's postcode in proximity to its local authority. It is recommended that this information is independently verified.



Everything you want
to know about
transport links







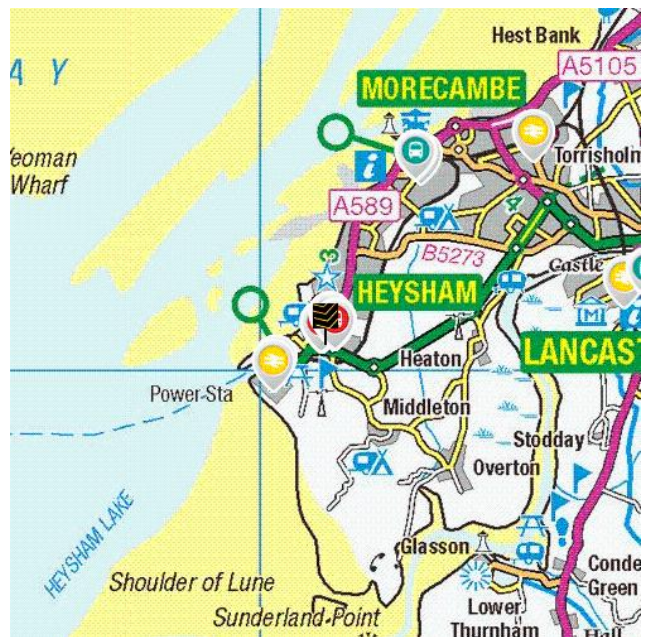

Become familiar with public transport links

Being able to choose to travel by public transport is important for many reasons. It helps to reduce congestion, provides access to work and education, and facilitates use of health and leisure facilities. If you or your family members travel abroad, access to the nearest ferry terminals is also likely to be a significant factor in choosing a new property. Using the maps below, you can pinpoint the precise locations of transport links for **Smithy Lane**. Tables for each type of transport indicate the property's distance from the nearest bus stops, railway stations, coach stops and ferry terminals (providing that these facilities are within the scale proximity of the maps.)

Transport Links



	Airports	Approx Distance
	Blackpool International Airport	19.07 miles
	Liverpool John Lennon Airport	48.58 miles
	Ferry ports	Approx Distance
	Heysham Ferry Terminal	0.77 miles
	Knott End-On-Sea Ferry Landing	8.74 miles
	Fleetwood for Knott End Ferry Landing	8.96 miles
	Piel Island Ferry Landing	11.26 miles
	Roa Island Ferry Landing	11.44 miles
	Train Stations	Approx Distance
	Heysham Port Rail Station	0.82 miles
	Morecambe Rail Station	2.34 miles
	Bare Lane Rail Station	3.43 miles
	Lancaster Rail Station	3.69 miles
	Carnforth Rail Station	7.99 miles

Disclaimer: The information represented in this section has been sourced from the Department of Transport's Open Data and is based on the property's postcode. It is recommended that this information is independently verified.



Farrell Heyworth 3-7 Victoria Street, Morecambe, LA4 4AE **01524 832929**

	Bus Stops	Approx Distance
	Heathfoot Avenue	0.06 miles
	Middleton Road	0.06 miles
	Heathfoot Avenue	0.06 miles
	Middleton Road	0.09 miles
	Warton Drive	0.11 miles
	Coach Stops	Approx Distance
	Morecambe: Central Drive Bus Station	2.33 miles
	Lancaster Bus Station	3.98 miles
	Lancaster: University Underpass Coach Stop	5.01 miles
	Galgate: Crossroads Coach Stop	5.53 miles
	Bolton le Sands (Lancs): Coach Stop	6.1 miles

Disclaimer: The information represented in this section has been sourced from the Department of Transport's Open Data and is based on the property's postcode. It is recommended that this information is independently verified.



Farrell Heyworth 3-7 Victoria Street, Morecambe, LA4 4AE **01524 832929**



Everything you want
to know about
local schools





How are local schools performing?

If schools are important to you, then this section sets out the published Key Performance Indicators for schools near to your prospective new home. Key Performance Indicators look primarily at how well pupils perform in their tests and examinations, as well as some other measures like attendance.

If you want to know more about a particular school or college, you can also visit the Ofsted website <http://www.ofsted.gov.uk/inspection-reports/find-inspection-report>

Local Schools

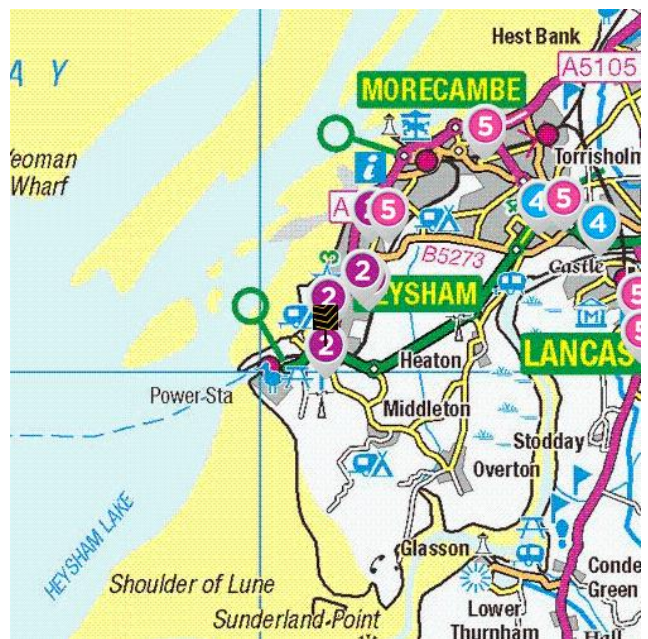

The next page shows tables and charts divided into Key Stages and a list of respective schools local to **Smithy Lane**. There are four main age-related Key Stages defined as:



Special schools are marked with this icon

Key Stage	Definition
Key Stage 1	Fits broadly with the first stage of education, i.e. ages 5-7.
Key Stage 2	Fits the later stage of primary education, often known as junior schools, i.e. ages 8-11. This takes pupils up to the standardised break at age 11 after which pupils generally change schools and transfer to secondary education.
Key Stage 3	Secondary education split between key stages 3 and 4, with key stage 3 covering ages 11-13.
Key Stage 4	Key Stage 4 (ages 14-16) covers the two year period of study for GCSE level examinations.
Key Stage 5	Beyond key stage 4 is 16+ or Sixth Form provision, sometimes unofficially referred to as Key Stage 5.



Farrell Heyworth 3-7 Victoria Street, Morecambe, LA4 4AE **01524 832929**

	Key Stage 2 - Information	Approx Distance
	<p>Name: Heysham St Peter's Church of England Primary School Address: School Road, Morecambe, LA3 2RF Contact Number: 01524852155 Age Range: 4-11 yrs Local Education Authority: Lancashire Religious Character: Church of England</p>	0.27 miles
	<p>Name: Trumacar Nursery and Community Primary School Address: Combermere Road, Morecambe, LA3 2ST Contact Number: 07913758162 Age Range: 3-11 yrs Local Education Authority: Lancashire Religious Character: Does not apply</p>	0.32 miles
	<p>Name: St Patrick's Catholic Primary School Address: Littledale Avenue, Morecambe, LA3 2ER Contact Number: 01524851766 Age Range: 5-11 yrs Local Education Authority: Lancashire Religious Character: Roman Catholic</p>	0.75 miles
	<p>Name: Mossgate Primary School Address: Kingsway, Morecambe, LA3 2EE Contact Number: 01524850736 Age Range: 4-11 yrs Local Education Authority: Lancashire Religious Character: Does not apply</p>	0.75 miles
	<p>Name: Morecambe and Heysham Sandylands Community Primary School Address: Hampton Road, Morecambe, LA3 1EJ Contact Number: 01524410286 Age Range: 2-11 yrs Local Education Authority: Lancashire Religious Character: Does not apply</p>	1.47 miles

Disclaimer: The information represented in this section has been sourced from the Department of Education's 2019 results data s and is based on the property's postcode.



Reading, Writing and Maths

	Name	Expected	Higher
2	Heysham St Peter's Church of England Primary School	60.0 %	9.0 %
	Trumacar Nursery and Community Primary School	64.0 %	9.0 %
	St Patrick's Catholic Primary School	48.0 %	0.0 %
	Mossgate Primary School	50.0 %	11.0 %
	Morecambe and Heysham Sandylands Community Primary School	46.0 %	2.0 %
	Lancashire	64.0 %	10.0 %
	National	65.0 %	11.0 %

Primary Progress Measures

As well as actual pupil performance in tests and exams an important Key Performance Indicator is that of progress measures that compare the actual achievements of other pupils nationally with similar prior attainment. Any increase in attainment achieved by each pupil will be reflected in the schools progress scores. They are fairer to schools in challenging circumstances, as they recognise a school that is doing a good job with an intake with poor prior attainment



Progress Measures for 2019

	Name	Math	Reading	Writing
2	Heysham St Peter's Church of England Primary School	-3.5 %	-3.7 %	-0.7 %
	Trumacar Nursery and Community Primary School	1.9 %	2.4 %	1.4 %
	St Patrick's Catholic Primary School	0.1 %	0.6 %	0.9 %
	Mossgate Primary School	1.1 %	-0.9 %	0.0 %
	Morecambe and Heysham Sandylands Community Primary School	-1.6 %	-3.1 %	-3.2 %

Disclaimer: The information represented in this section has been sourced from the Department of Education's 2019 results data set and is based on the property's postcode.



Farrell Heyworth 3-7 Victoria Street, Morecambe, LA4 4AE 01524 832929

	Key Stage 4 - Information	Approx Distance
	 <p>Name: Morecambe Road School Address: Morecambe Road, Morecambe, LA3 3AB Contact Number: 01524414384 Age Range: 3-16 yrs Local Education Authority: Lancashire Religious Character: Does not apply</p>	2.98 miles
	<p>Name: Morecambe Bay Academy Address: Dallam Avenue, Morecambe, LA4 5BG Contact Number: 01524410207 Age Range: 11-18 yrs Local Education Authority: Lancashire Religious Character: Does not apply</p>	3.07 miles
	<p>Name: Morecambe Community High School Address: Dallam Avenue, Morecambe, LA4 5BG Contact Number: 01524410207 Age Range: 11-18 yrs Local Education Authority: Lancashire Religious Character: Does not apply</p>	3.07 miles
	 <p>Name: The Loyne Specialist School Address: Sefton Drive, Lancaster, LA1 2PZ Contact Number: 0152464543 Age Range: 2-19 yrs Local Education Authority: Lancashire Religious Character: Does not apply</p>	3.55 miles
	<p>Name: Lancaster Girls' Grammar School Address: Regent Street, Lancaster, LA1 1SF Contact Number: 01524581661 Age Range: 11-18 yrs Local Education Authority: Lancashire Religious Character: None Admission Policy: Selective</p>	3.83 miles

Disclaimer: The information represented in this section has been sourced from the Department of Education's 2019 results data and is based on the property's postcode.



Percentage of pupils achieving 5+ A*-C/9-4 or equivalents including 9-4 in both English and mathematics GCSEs

	Name	2019	2018	2017	2016
4	Morecambe Road School	0.0 %	0.0 %	0.0 %	0.0 %
	Morecambe Bay Academy	N/A	N/A	N/A	N/A
	Morecambe Community High School	58.0 %	54.0 %	50.0 %	50.0 %
	The Loyne Specialist School	N/A	N/A	N/A	N/A
	Lancaster Girls' Grammar School	97.0 %	98.0 %	100.0 %	99.0 %
	Lancashire	66.0 %	66.1 %	61.7 %	58.5 %
	National	60.0 %	59.4 %	56.6 %	53.5 %

Disclaimer: The information represented in this section has been sourced from the Department of Education's 2017 results data set and is based on the property's postcode.

Average number of GCSE entries per pupil

	Name	Number
4	Morecambe Road School	1.2
	Morecambe Bay Academy	N/A
	Morecambe Community High School	6.9
	The Loyne Specialist School	N/A
	Lancaster Girls' Grammar School	9.8
	Lancashire	7.5
	National	7.1

Disclaimer: The information represented in this section has been sourced from the Department of Education's 2019 results data set and is based on the property's postcode.



	Key Stage 5 - Information	Approx Distance
	<p>Name: Bay Leadership Academy Address: Limes Avenue, Morecambe, LA3 1HS Contact Number: 01524416830 Age Range: 11-18 yrs Local Education Authority: Lancashire Religious Character: Does not apply</p>	1.54 miles
	<p>Name: Morecambe Community High School Address: Dallam Avenue, Morecambe, LA4 5BG Contact Number: 01524410207 Age Range: 11-18 yrs Local Education Authority: Lancashire Religious Character: Does not apply</p>	3.07 miles
	<p>Name: Lancaster and Morecambe College Address: Morecambe Road, Lancaster, LA1 2TY Contact Number: 0152466215 Age Range: 16+ yrs Local Education Authority: Lancashire Religious Character: Does not apply Admission Policy: Not applicable</p>	3.26 miles
	<p>Name: Lancaster Girls' Grammar School Address: Regent Street, Lancaster, LA1 1SF Contact Number: 01524581661 Age Range: 11-18 yrs Local Education Authority: Lancashire Religious Character: None Admission Policy: Selective</p>	3.83 miles
	<p>Name: Ripley St Thomas Church of England Academy Address: Ashton Road, Lancaster, LA1 4RS Contact Number: 0152464496 Age Range: 11-18 yrs Local Education Authority: Lancashire Religious Character: Church of England</p>	3.86 miles

Disclaimer: The information represented in this section has been sourced from the Department of Education's 2019 results data and is based on the property's postcode.



Percentage of A level students achieving at least three levels at grades AAB or better, at least two of which are in facilitating subjects

	Name	%
5	Bay Leadership Academy	N/A
	Morecambe Community High School	6.1 %
	Lancaster and Morecambe College	N/A
	Lancaster Girls' Grammar School	46.9 %
	Ripley St Thomas Church of England Academy	6.1 %
	Lancashire	15.1 %
	National	16.5 %

Disclaimer: The information represented in this section has been sourced from the Department of Education's 2019 results data set and is based on the property's postcode.

As well as actual pupil performance in tests and exams, an important Key Performance Indicator is that of Value Added. When pupils start a school, they all have varying levels of ability and social advantage. A school's Value Added score measures how much progress they have made from the beginning to the end of their compulsory secondary education (i.e. between the end of Key Stage 2 and the end of Key Stage 4). It is a quick measurement of the effect of a school on its pupils.

	Name	Value Added
5	Bay Leadership Academy	-0.5
	Morecambe Community High School	-0.5
	Lancaster and Morecambe College	N/A
	Lancaster Girls' Grammar School	0.0
	Ripley St Thomas Church of England Academy	-0.1



Farrell Heyworth 3-7 Victoria Street, Morecambe, LA4 4AE 01524 832929



Everything you want
to know about
local health services







How local are the health services?

We all want good access to local health facilities, wherever we live. To see how well **Smithy Lane** is served, we have set out below the exact locations of hospitals, Accident & Emergency centres, GPs, pharmacies, dentists, out-of-hours medical care and walk-in clinics. Where it's available, you will find more detailed information, including the names of practitioners and their contact details.

	Hospitals	Approx Distance
	Royal Lancaster Infirmary, Ashton Road, Lancaster, Lancashire, LA1 4RP	4.0 miles
	Furness General Hospital, Dalton Lane, Barrow-In-Furness, Cumbria, LA14 4LF	14.2 miles
	Blackpool Victoria Hospital, Whinney Heys Road, Blackpool, Lancashire, FY3 8NR	15.95 miles
	Royal Preston Hospital, Sharoe Green Lane North, Preston, Lancashire, PR2 9HT	18.88 miles
	Westmorland General Hospital, Kendal, LA9 7RG	19.53 miles
	A&E	Approx Distance
	Royal Lancaster Infirmary, Ashton Road, Lancaster, Lancashire, LA1 4RP	4.0 miles
	Furness General Hospital, Dalton Lane, Barrow-In-Furness, Cumbria, LA14 4LF	14.2 miles
	Blackpool Victoria Hospital, Whinney Heys Road, Blackpool, Lancashire, FY3 8NR	15.95 miles
	Royal Preston Hospital, Sharoe Green Lane North, Preston, Lancashire, PR2 9HT	18.88 miles
	Royal Blackburn Hospital, Haslingden Road, Blackburn, Lancashire, BB2 3HH	27.35 miles

Walk-in Clinics		Approx Distance
	Same Day Health Centre – Morecambe, Same Day Health Centre, Morecambe, Lancashire, LA4 5LY	2.7 miles
	Same Day Health Centre – Fleetwood, Same Day Health Centre, Fleetwood, Lancashire, FY7 6HP	9.45 miles
	Blackpool Victoria Hospital, Whinney Heys Road, Blackpool, Lancashire, FY3 8NR	15.95 miles
	Blackpool Nhs Walk-in Centre, Whitegate Health Centre, Blackpool, Lancashire, FY3 9ES	16.69 miles
	Westmorland General Hospital, Kendal, LA9 7RG	19.53 miles
GPs		Approx Distance
	STRAWBERRY GARDENS MEDICAL PRACTICE, HEYSHAM PRIMARY CARE CTR, LANCASHIRE, LA3 2LE	1.34 miles
	THE WESTGATE MED PRACTICE, THE WESTGATE MED PRACTICE, MORECAMBE, LANCASHIRE, LA4 4UZ	2.19 miles
	YORK BRIDGE SURGERY, YORK BRIDGE SURGERY, LANCASHIRE, LA4 5TE	2.62 miles
	COASTAL MEDICAL GROUP, COASTAL MEDICAL GROUP, LA4 5LY	2.7 miles
	KING STREET SURGERY, KING STREET SURGERY, LA1 1RE	3.91 miles
Dental Surgeons		Approx Distance
	Mayo Dental Clinic, 3 Meeting House Lane, LANCASTER, Lancashire, LA1 1TJ	3.76 miles
	Mayo Dental Clinic, Dallas Road, LANCASTER, Lancashire, LA1 1TW	3.77 miles
	Central Dental Practice, Telephone House, LANCASTER, Lancashire, LA1 1AB	3.81 miles
	Bay Dental Partnership, 6 New Street, LANCASTER, Lancashire, LA1 1EG	3.91 miles
	Marketgate Dental Practice, Marketgate Shopping Centre, LANCASTER, Lancashire, LA1 1JF	3.93 miles

Disclaimer: The information represented in this section has been sourced from Experian and is based on the property's postcode.



Farrell Heyworth 3-7 Victoria Street, Morecambe, LA4 4AE 01524 832929



Everything you want
to know about
local policing





Understanding who polices your neighbourhood

When you move to a new area, you want to know the arrangements for local community policing. See below for essential information about police services near to **Smithy Lane**. We have included location and contact details for the police station and wherever possible, details of police officers assigned to the area.

Your policing neighbourhood

The name of your policing neighbourhood is **Heysham South** and it has a population of **7264**.

Your Local Policing Team			
Name	Rank	Tel No.	E-mail
Dennis Nelson	PCSO		
Hannah Mason	PCSO		
Andy Blayden-Byrne	PCSO		
Zac Holmes	Constable		

Disclaimer: The information represented in this section has been sourced from data.police.uk.

Disclaimer: The information represented in this section has been sourced from data.police.uk.

Farrell Heyworth 3-7 Victoria Street, Morecambe, LA4 4AE **01524 832929**

