



Everything you need to know about:

**Grosvenor Apartments,
Sandylands Promenade, Morecambe,
LA3 1GW**



Introduction



The Property



Local Authority



Transport Links

Education



Health



Local Policing





An invaluable insight into your new home

This i-PACK brochure offers an informed overview of **Grosvenor Apartments** as a potential new home, along with essential material about its surrounding area and its local community. It provides a valuable insight for any prospective owner or tenant.

We wanted to provide you with information that you can absorb quickly, so we have presented it as visually as possible, making use of maps, icons, tables, graphs and charts. Overall, the brochure contains information about:

- **The Property** - including property details, floor plans, room details, photographs and Energy Performance Certificate.
- **Transport** - including locations of bus and coach stops, railway stations and ferry ports.
- **Health** - including locations, contact details and organisational information on the nearest GPs, pharmacies, hospitals and dentists.
- **Local Policing** - including locations, contact details and information about local community policing and the nearest police station, as well as police officers assigned to the area.
- **Education** - including locations of infant, primary and secondary schools and Key Performance Indicators (KPIs) for each key stage.



Farrell Heyworth 3-7 Victoria Street, Morecambe, LA4 4AE **01524 832929**



GROSVENOR APARTMENTS, MORECAMBE £150,000



x1
Bedrooms



x1
Living Rooms



x1
Bathrooms

Where you are

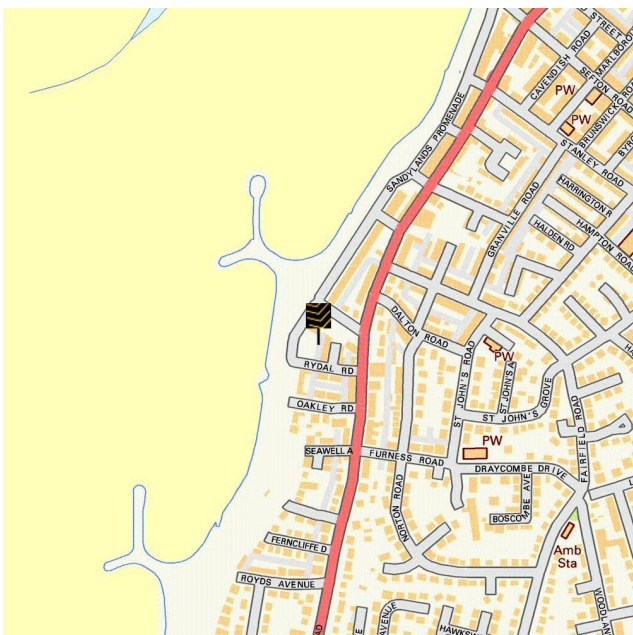



Balcony



Lounge





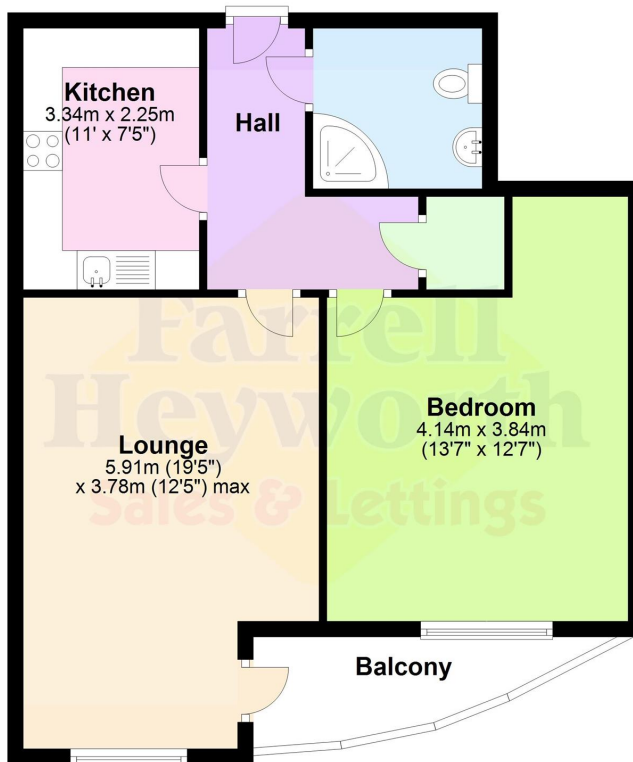



Everything you want
to know about
local authorities





Get to know your local authorities

Local government directly affects quality of life, particularly when it comes to council tax, planning, waste disposal and the impact of local policies. You may want to investigate how this is likely to affect you if you decide to move. There are nearly 400 local authorities in England, with five different types of local government structure. These can be broadly divided into **single-tier** and **two-tier authorities**. Single-tier authorities are **Metropolitan Authorities, London Boroughs** and **Unitary or Shire Authorities**. Two-tier authorities have both a **County Council**, and a **District Council or City Council**. There are also around 10,000 parish and town councils, effectively creating an additional tier in some areas - mostly, but not exclusively, in rural areas. The National Association of Local Councils (NALC) represents and works on behalf of these community councils and is a useful contact point.

The local authority locations and contact details for **Grosvenor Apartments** are:

| Shire / County / District | Website | Address | Contact details |
|---------------------------|---------|---------|-----------------|
|---------------------------|---------|---------|-----------------|

Disclaimer: The information displayed above has been obtained using the property's postcode in proximity to its local authority. It is recommended that this information is independently verified.



Everything you want
to know about
transport links







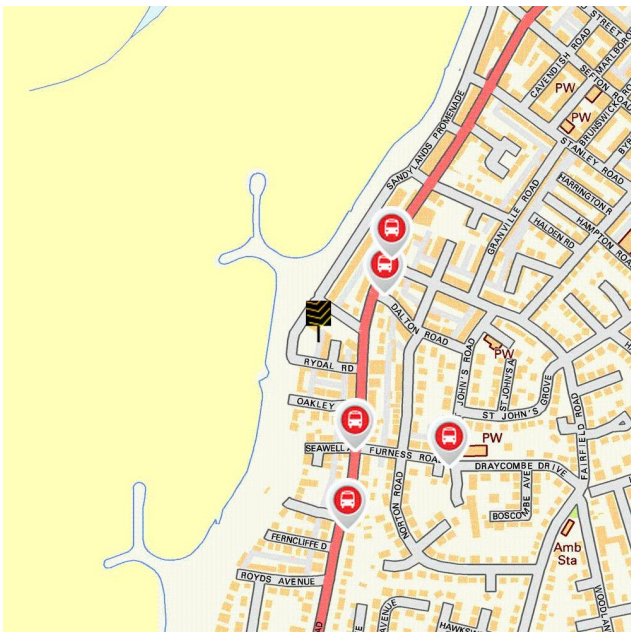

Become familiar with public transport links

Being able to choose to travel by public transport is important for many reasons. It helps to reduce congestion, provides access to work and education, and facilitates use of health and leisure facilities. If you or your family members travel abroad, access to the nearest ferry terminals is also likely to be a significant factor in choosing a new property. Using the maps below, you can pinpoint the precise locations of transport links for **Grosvenor Apartments**. Tables for each type of transport indicate the property's distance from the nearest bus stops, railway stations, coach stops and ferry terminals (providing that these facilities are within the scale proximity of the maps.)

Transport Links



| | Airports | Approx Distance |
|-----------------------------------------------------------------------------------|---------------------------------------|-----------------|
|  | Blackpool International Airport | 20.4 miles |
| | Liverpool John Lennon Airport | 49.88 miles |
| | Ferry ports | Approx Distance |
|  | Heysham Ferry Terminal | 1.99 miles |
| | Knott End-On-Sea Ferry Landing | 10.03 miles |
| | Fleetwood for Knott End Ferry Landing | 10.24 miles |
| | Piel Island Ferry Landing | 11.39 miles |
| | Roa Island Ferry Landing | 11.5 miles |
| | Train Stations | Approx Distance |
|  | Morecambe Rail Station | 1.15 miles |
| | Heysham Port Rail Station | 2.04 miles |
| | Bare Lane Rail Station | 2.49 miles |
| | Lancaster Rail Station | 3.48 miles |
| | Carnforth Rail Station | 6.85 miles |

Disclaimer: The information represented in this section has been sourced from the Department of Transport's Open Data and is based on the property's postcode. It is recommended that this information is independently verified.



Farrell Heyworth 3-7 Victoria Street, Morecambe, LA4 4AE 01524 832929

| | Bus Stops | Approx Distance |
|-----------------------------------------------------------------------------------|--------------------------------------------|-----------------|
|  | Fairfield Road | 0.08 miles |
| | Cross Copp | 0.11 miles |
| | Fairfield Road | 0.11 miles |
| | Draycombe Court | 0.17 miles |
| | Cross Cop | 0.18 miles |
| | Coach Stops | Approx Distance |
|  | Morecambe: Central Drive Bus Station | 1.12 miles |
| | Lancaster Bus Station | 3.73 miles |
| | Bolton le Sands (Lancs): Coach Stop | 5.03 miles |
| | Lancaster: University Underpass Coach Stop | 5.49 miles |
| | Galgate: Crossroads Coach Stop | 6.25 miles |

Disclaimer: The information represented in this section has been sourced from the Department of Transport's Open Data and is based on the property's postcode. It is recommended that this information is independently verified.



Farrell Heyworth 3-7 Victoria Street, Morecambe, LA4 4AE **01524 832929**



Everything you want
to know about
local schools





How are local schools performing?

If schools are important to you, then this section sets out the published Key Performance Indicators for schools near to your prospective new home. Key Performance Indicators look primarily at how well pupils perform in their tests and examinations, as well as some other measures like attendance.

If you want to know more about a particular school or college, you can also visit the Ofsted website <http://www.ofsted.gov.uk/inspection-reports/find-inspection-report>

Local Schools

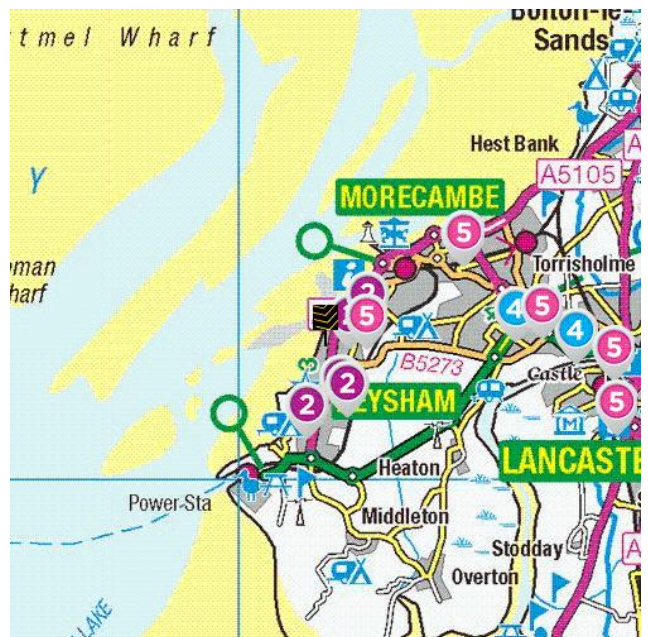
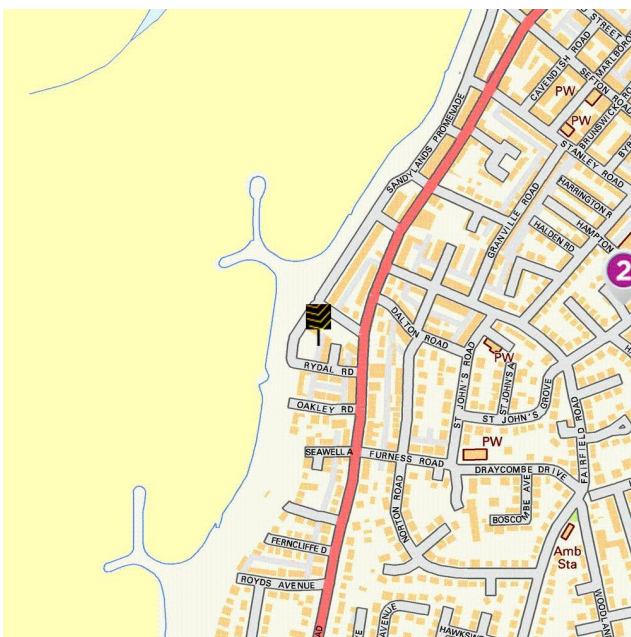

The next page shows tables and charts divided into Key Stages and a list of respective schools local to **Grosvenor Apartments**. There are four main age-related Key Stages defined as:



Special schools are marked with this icon

| Key Stage | Definition |
|-------------|-------------------------------------------------------------------------------------------------------------------------------------------------------------------------------------------------------------------------------------|
| Key Stage 1 | Fits broadly with the first stage of education, i.e. ages 5-7. |
| Key Stage 2 | Fits the later stage of primary education, often known as junior schools, i.e. ages 8-11. This takes pupils up to the standardised break at age 11 after which pupils generally change schools and transfer to secondary education. |
| Key Stage 3 | Secondary education split between key stages 3 and 4, with key stage 3 covering ages 11-13. |
| Key Stage 4 | Key Stage 4 (ages 14-16) covers the two year period of study for GCSE level examinations. |
| Key Stage 5 | Beyond key stage 4 is 16+ or Sixth Form provision, sometimes unofficially referred to as Key Stage 5. |



Farrell Heyworth 3-7 Victoria Street, Morecambe, LA4 4AE **01524 832929**

| | Key Stage 2 - Information | Approx Distance |
|-----------------------------------------------------------------------------------|---------------------------------------------------------------------------------------------------------------------------------------------------------------------------------------------------------------------------------------------------------------------------------------------------------------|-----------------|
|  | <p>Name: Morecambe and Heysham Sandylands Community Primary School Address: Hampton Road, Morecambe, LA3 1EJ Contact Number: 01524410286 Age Range: 2-11 yrs Local Education Authority: Lancashire Religious Character: Does not apply</p> | 0.3 miles |
| | <p>Name: West End Primary School Address: Chatsworth Road, Morecambe, LA3 1BW Contact Number: 01524411227 Age Range: 4-11 yrs Local Education Authority: Lancashire Religious Character: Does not apply</p> | 0.61 miles |
| | <p>Name: Mossgate Primary School Address: Kingsway, Morecambe, LA3 2EE Contact Number: 01524850736 Age Range: 4-11 yrs Local Education Authority: Lancashire Religious Character: Does not apply</p> | 0.73 miles |
| | <p>Name: St Patrick's Catholic Primary School Address: Littledale Avenue, Morecambe, LA3 2ER Contact Number: 01524851766 Age Range: 5-11 yrs Local Education Authority: Lancashire Religious Character: Roman Catholic</p> | 0.83 miles |
| | <p>Name: Heysham St Peter's Church of England Primary School Address: School Road, Morecambe, LA3 2RF Contact Number: 01524852155 Age Range: 4-11 yrs Local Education Authority: Lancashire Religious Character: Church of England</p> | 1.07 miles |

Disclaimer: The information represented in this section has been sourced from the Department of Education's 2019 results data s and is based on the property's postcode.



Reading, Writing and Maths

| | Name | Expected | Higher |
|-----------------|-----------------------------------------------------------|----------|--------|
| 2 | Morecambe and Heysham Sandylands Community Primary School | 46.0 % | 2.0 % |
| | West End Primary School | 46.0 % | 4.0 % |
| | Mossgate Primary School | 50.0 % | 11.0 % |
| | St Patrick's Catholic Primary School | 48.0 % | 0.0 % |
| | Heysham St Peter's Church of England Primary School | 60.0 % | 9.0 % |
| | Lancashire | 64.0 % | 10.0 % |
| National | 65.0 % | 11.0 % | |

Primary Progress Measures

As well as actual pupil performance in tests and exams an important Key Performance Indicator is that of progress measures that compare the actual achievements of other pupils nationally with similar prior attainment. Any increase in attainment achieved by each pupil will be reflected in the schools progress scores. They are fairer to schools in challenging circumstances, as they recognise a school that is doing a good job with an intake with poor prior attainment

Progress Measures for 2019

| | Name | Math | Reading | Writing |
|---|-----------------------------------------------------------|--------|---------|---------|
| 2 | Morecambe and Heysham Sandylands Community Primary School | -1.6 % | -3.1 % | -3.2 % |
| | West End Primary School | -1.8 % | -3.4 % | -0.4 % |
| | Mossgate Primary School | 1.1 % | -0.9 % | 0.0 % |
| | St Patrick's Catholic Primary School | 0.1 % | 0.6 % | 0.9 % |
| | Heysham St Peter's Church of England Primary School | -3.5 % | -3.7 % | -0.7 % |

Disclaimer: The information represented in this section has been sourced from the Department of Education's 2019 results data set and is based on the property's postcode.



Farrell Heyworth 3-7 Victoria Street, Morecambe, LA4 4AE 01524 832929

| | Key Stage 4 - Information | Approx Distance |
|---|--------------------------------------------------------------------------------------------------------------------------------------------------------------------------------------------------------------------------------------------------------------------------------------------------------------------------------------------------------------------|-----------------|
| 4 | <p>Name: Morecambe Bay Academy Address: Dallam Avenue, Morecambe, LA4 5BG Contact Number: 01524410207 Age Range: 11-18 yrs Local Education Authority: Lancashire Religious Character: Does not apply</p> | 1.98 miles |
| | <p>Name: Morecambe Community High School Address: Dallam Avenue, Morecambe, LA4 5BG Contact Number: 01524410207 Age Range: 11-18 yrs Local Education Authority: Lancashire Religious Character: Does not apply</p> | 1.98 miles |
| | <p>Name: Morecambe Road School  Address: Morecambe Road, Morecambe, LA3 3AB Contact Number: 01524414384 Age Range: 3-16 yrs Local Education Authority: Lancashire Religious Character: Does not apply</p> | 2.34 miles |
| | <p>Name: The Loyne Specialist School  Address: Sefton Drive, Lancaster, LA1 2PZ Contact Number: 0152464543 Age Range: 2-19 yrs Local Education Authority: Lancashire Religious Character: Does not apply</p> | 3.08 miles |
| | <p>Name: Our Lady's Catholic College Address: Morecambe Road, Lancaster, LA1 2RX Contact Number: 0152466689 Age Range: 11-18 yrs Local Education Authority: Lancashire Religious Character: Roman Catholic</p> | 3.53 miles |

Disclaimer: The information represented in this section has been sourced from the Department of Education's 2019 results data s and is based on the property's postcode.



Percentage of pupils achieving 5+ A*-C/9-4 or equivalents including 9-4 in both English and mathematics GCSEs

| | Name | 2019 | 2018 | 2017 | 2016 |
|---|---------------------------------|---------------|---------------|---------------|---------------|
| 4 | Morecambe Bay Academy | N/A | N/A | N/A | N/A |
| | Morecambe Community High School | 58.0 % | 54.0 % | 50.0 % | 50.0 % |
| | Morecambe Road School | 0.0 % | 0.0 % | 0.0 % | 0.0 % |
| | The Loyne Specialist School | N/A | N/A | N/A | N/A |
| | Our Lady's Catholic College | 51.0 % | 56.0 % | 50.0 % | 52.0 % |
| | Lancashire | 66.0 % | 66.1 % | 61.7 % | 58.5 % |
| | National | 60.0 % | 59.4 % | 56.6 % | 53.5 % |

Disclaimer: The information represented in this section has been sourced from the Department of Education's 2017 results data set and is based on the property's postcode.

Average number of GCSE entries per pupil

| | Name | Number |
|---|---------------------------------|------------|
| 4 | Morecambe Bay Academy | N/A |
| | Morecambe Community High School | 6.9 |
| | Morecambe Road School | 1.2 |
| | The Loyne Specialist School | N/A |
| | Our Lady's Catholic College | 6.6 |
| | Lancashire | 7.5 |
| | National | 7.1 |

Disclaimer: The information represented in this section has been sourced from the Department of Education's 2019 results data set and is based on the property's postcode.



| | Key Stage 5 - Information | Approx Distance |
|-----------------------------------------------------------------------------------|----------------------------------------------------------------------------------------------------------------------------------------------------------------------------------------------------------------------------------------------------------------------------------------------------------------------------------|-----------------|
|  | <p>Name: Bay Leadership Academy Address: Limes Avenue, Morecambe, LA3 1HS Contact Number: 01524416830 Age Range: 11-18 yrs Local Education Authority: Lancashire Religious Character: Does not apply</p> | 0.49 miles |
| | <p>Name: Morecambe Community High School Address: Dallam Avenue, Morecambe, LA4 5BG Contact Number: 01524410207 Age Range: 11-18 yrs Local Education Authority: Lancashire Religious Character: Does not apply</p> | 1.98 miles |
| | <p>Name: Lancaster and Morecambe College Address: Morecambe Road, Lancaster, LA1 2TY Contact Number: 0152466215 Age Range: 16+ yrs Local Education Authority: Lancashire Religious Character: Does not apply Admission Policy: Not applicable</p> | 2.64 miles |
| | <p>Name: Our Lady's Catholic College Address: Morecambe Road, Lancaster, LA1 2RX Contact Number: 0152466689 Age Range: 11-18 yrs Local Education Authority: Lancashire Religious Character: Roman Catholic</p> | 3.53 miles |
| | <p>Name: Lancaster Girls' Grammar School Address: Regent Street, Lancaster, LA1 1SF Contact Number: 01524581661 Age Range: 11-18 yrs Local Education Authority: Lancashire Religious Character: None Admission Policy: Selective</p> | 3.7 miles |

Disclaimer: The information represented in this section has been sourced from the Department of Education's 2019 results data s and is based on the property's postcode.



Percentage of A level students achieving at least three levels at grades AAB or better, at least two of which are in facilitating subjects

| | Name | % |
|---|---------------------------------|---------------|
| 5 | Bay Leadership Academy | N/A |
| | Morecambe Community High School | 6.1 % |
| | Lancaster and Morecambe College | N/A |
| | Our Lady's Catholic College | 10.0 % |
| | Lancaster Girls' Grammar School | 46.9 % |
| | Lancashire | 15.1 % |
| | National | 16.5 % |

Disclaimer: The information represented in this section has been sourced from the Department of Education's 2019 results data set and is based on the property's postcode.

As well as actual pupil performance in tests and exams, an important Key Performance Indicator is that of Value Added. When pupils start a school, they all have varying levels of ability and social advantage. A school's Value Added score measures how much progress they have made from the beginning to the end of their compulsory secondary education (i.e. between the end of Key Stage 2 and the end of Key Stage 4). It is a quick measurement of the effect of a school on its pupils.

| | Name | Value Added |
|---|---------------------------------|-------------|
| 5 | Bay Leadership Academy | -0.5 |
| | Morecambe Community High School | -0.5 |
| | Lancaster and Morecambe College | N/A |
| | Our Lady's Catholic College | 0.5 |
| | Lancaster Girls' Grammar School | 0.0 |
| | | |



Farrell Heyworth 3-7 Victoria Street, Morecambe, LA4 4AE 01524 832929



Everything you want
to know about
local health services







How local are the health services?

We all want good access to local health facilities, wherever we live. To see how well **Grosvenor Apartments** is served, we have set out below the exact locations of hospitals, Accident & Emergency centres, GPs, pharmacies, dentists, out-of-hours medical care and walk-in clinics. Where it's available, you will find more detailed information, including the names of practitioners and their contact details.

| Hospitals | | Approx Distance |
|-----------|--------------------------------------------------------------------------------|-----------------|
| | Royal Lancaster Infirmary, Ashton Road, Lancaster, Lancashire, LA1 4RP | 3.92 miles |
| | Furness General Hospital, Dalton Lane, Barrow-In-Furness, Cumbria, LA14 4LF | 13.87 miles |
| | Blackpool Victoria Hospital, Whinney Heys Road, Blackpool, Lancashire, FY3 8NR | 17.27 miles |
| | Westmorland General Hospital, Kendal, LA9 7RG | 18.21 miles |
| | Royal Preston Hospital, Sharoe Green Lane North, Preston, Lancashire, PR2 9HT | 19.99 miles |
| A&E | | Approx Distance |
| | Royal Lancaster Infirmary, Ashton Road, Lancaster, Lancashire, LA1 4RP | 3.92 miles |
| | Furness General Hospital, Dalton Lane, Barrow-In-Furness, Cumbria, LA14 4LF | 13.87 miles |
| | Blackpool Victoria Hospital, Whinney Heys Road, Blackpool, Lancashire, FY3 8NR | 17.27 miles |
| | Royal Preston Hospital, Sharoe Green Lane North, Preston, Lancashire, PR2 9HT | 19.99 miles |
| | Royal Blackburn Hospital, Haslingden Road, Blackburn, Lancashire, BB2 3HH | 28.22 miles |

| | Walk-in Clinics | Approx Distance |
|-------------------------------------------------------------------------------------|--------------------------------------------------------------------------------------------|-----------------|
|  | Same Day Health Centre – Morecambe, Same Day Health Centre, Morecambe, Lancashire, LA4 5LY | 1.57 miles |
| | Same Day Health Centre – Fleetwood, Same Day Health Centre, Fleetwood, Lancashire, FY7 6HP | 10.73 miles |
| | Blackpool Victoria Hospital, Whinney Heys Road, Blackpool, Lancashire, FY3 8NR | 17.27 miles |
| | Blackpool Nhs Walk-in Centre, Whitegate Health Centre, Blackpool, Lancashire, FY3 9ES | 18.01 miles |
| | Westmorland General Hospital, Kendal, LA9 7RG | 18.21 miles |
| | GPs | Approx Distance |
|  | THE WESTGATE MED PRACTICE, THE WESTGATE MED PRACTICE, MORECAMBE, LANCASHIRE, LA4 4UZ | 1.44 miles |
| | COASTAL MEDICAL GROUP, COASTAL MEDICAL GROUP, LA4 5LY | 1.57 miles |
| | YORK BRIDGE SURGERY, YORK BRIDGE SURGERY, LANCASHIRE, LA4 5TE | 1.58 miles |
| | STRAWBERRY GARDENS MEDICAL PRACTICE, HEYSHAM PRIMARY CARE CTR, LANCASHIRE, LA3 2LE | 1.76 miles |
| | OWEN ROAD SURGERY, 67 OWEN ROAD, LANCASHIRE, LA1 2LG | 3.64 miles |
| | Dental Surgeons | Approx Distance |
|  | Mayo Dental Clinic, 3 Meeting House Lane, LANCASTER, Lancashire, LA1 1TJ | 3.57 miles |
| | Central Dental Practice, Telephone House, LANCASTER, Lancashire, LA1 1AB | 3.62 miles |
| | Mayo Dental Clinic, Dallas Road, LANCASTER, Lancashire, LA1 1TW | 3.62 miles |
| | Bay Dental Partnership, 6 New Street, LANCASTER, Lancashire, LA1 1EG | 3.69 miles |
| | Lancaster Dental Clinic, 8 Aldrens Lane, LANCASTER, Lancashire, LA1 2DU | 3.71 miles |

Disclaimer: The information represented in this section has been sourced from Experian and is based on the property's postcode.



Farrell Heyworth 3-7 Victoria Street, Morecambe, LA4 4AE 01524 832929



Everything you want
to know about
local policing





Understanding who polices your neighbourhood

When you move to a new area, you want to know the arrangements for local community policing. See below for essential information about police services near to **Grosvenor Apartments**. We have included location and contact details for the police station and wherever possible, details of police officers assigned to the area.

Your policing neighbourhood

The name of your policing neighbourhood is **Heysham Central** and it has a population of **4478**.

| Your Local Policing Team | | | |
|--------------------------|-----------|---------|--------|
| Name | Rank | Tel No. | E-mail |
| Samantha Wilkinson | PCSO | | |
| Tony Marsh | Constable | | |

Disclaimer: The information represented in this section has been sourced from data.police.uk.

Locations of Interest

Morecambe Police Station
 station
 Poulton Square Morecambe

Morecambe Police Station is open 09:00 to 17:00 Monday to Friday, Closed Saturday and Sunday

Disclaimer: The information represented in this section has been sourced from data.police.uk.



Farrell Heyworth 3-7 Victoria Street, Morecambe, LA4 4AE **01524 832929**

