



Everything you need to know about:

**Burlington Gardens,
Leyland,
PR25 3EX**



Introduction



The Property



Local Authority



Transport Links

Education



Health



Local Policing





An invaluable insight into your new home

This i-PACK brochure offers an informed overview of **Burlington Gardens** as a potential new home, along with essential material about its surrounding area and its local community. It provides a valuable insight for any prospective owner or tenant.

We wanted to provide you with information that you can absorb quickly, so we have presented it as visually as possible, making use of maps, icons, tables, graphs and charts. Overall, the brochure contains information about:

- **The Property** - including property details, floor plans, room details, photographs and Energy Performance Certificate.
- **Transport** - including locations of bus and coach stops, railway stations and ferry ports.
- **Health** - including locations, contact details and organisational information on the nearest GPs, pharmacies, hospitals and dentists.
- **Local Policing** - including locations, contact details and information about local community policing and the nearest police station, as well as police officers assigned to the area.
- **Education** - including locations of infant, primary and secondary schools and Key Performance Indicators (KPIs) for each key stage.





BURLINGTON GARDENS, LEYLAND £280,000



x2

Bedrooms



x0

Living Rooms



x1

Bathrooms

Where you are

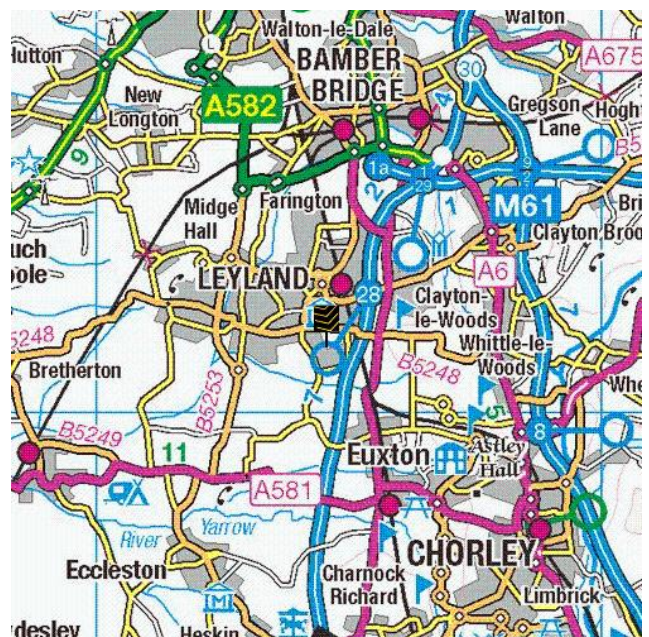
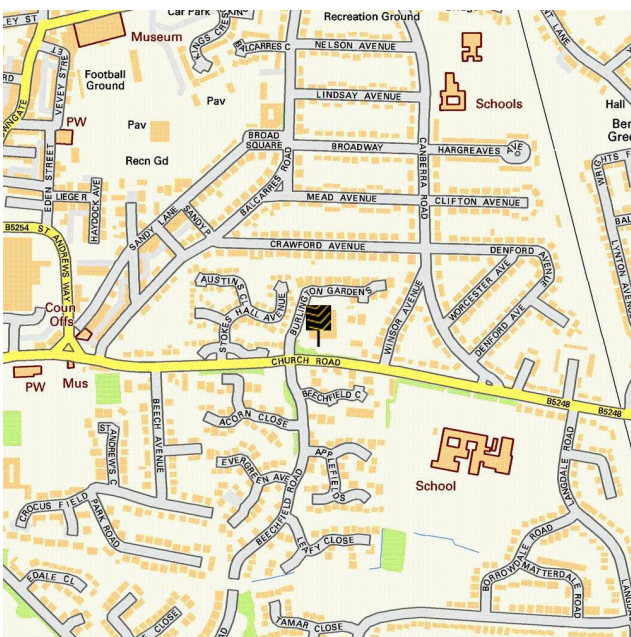

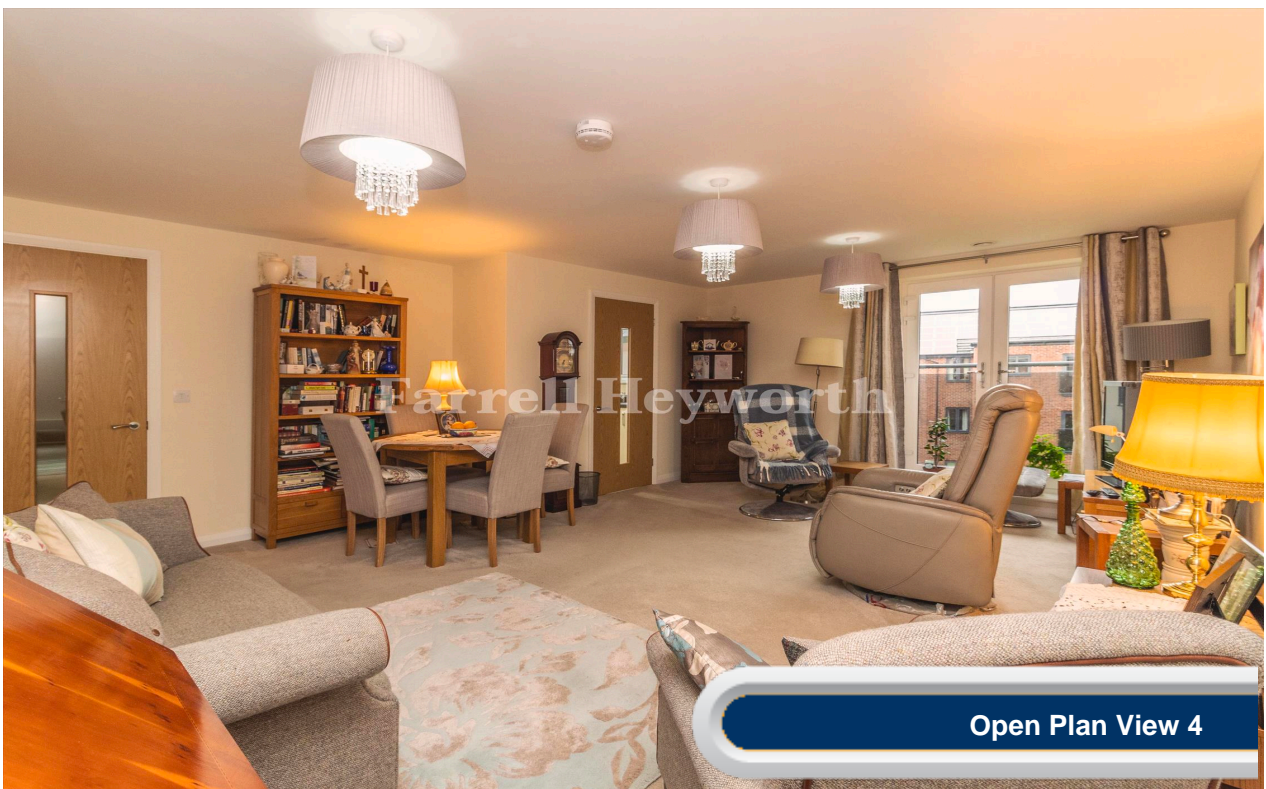



Kitchen



Bedroom One View 3



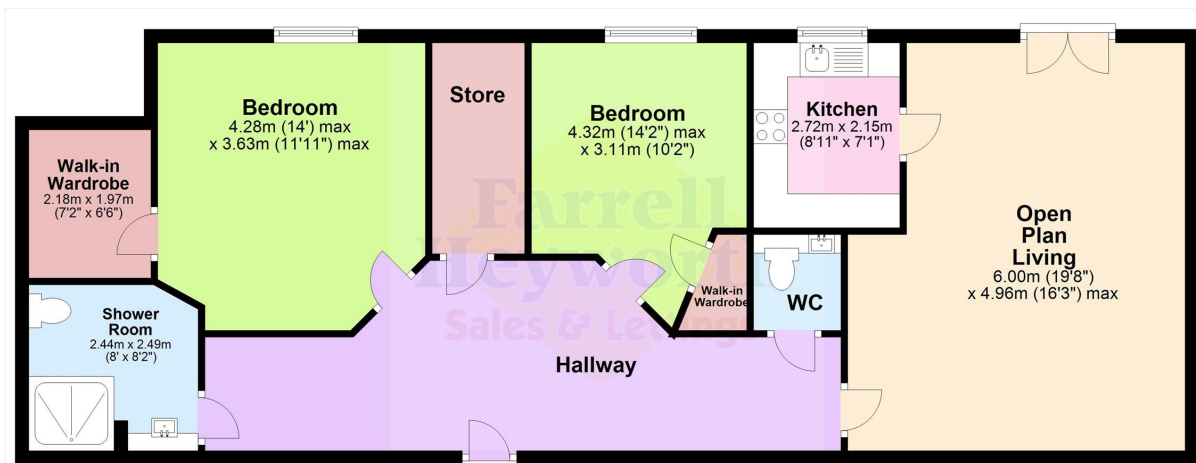



Everything you want
to know about
local authorities





Get to know your local authorities

Local government directly affects quality of life, particularly when it comes to council tax, planning, waste disposal and the impact of local policies. You may want to investigate how this is likely to affect you if you decide to move. There are nearly 400 local authorities in England, with five different types of local government structure. These can be broadly divided into **single-tier** and **two-tier authorities**.

Single-tier authorities are **Metropolitan Authorities, London Boroughs** and **Unitary or Shire Authorities**.

Two-tier authorities have both a **County Council**, and a **District Council or City Council**.

There are also around 10,000 parish and town councils, effectively creating an additional tier in some areas - mostly, but not exclusively, in rural areas. The National Association of Local Councils (NALC) represents and works on behalf of these community councils and is a useful contact point.

The local authority locations and contact details for **Burlington Gardens** are:

| Shire / County / District | Website | Address | Contact details |
|---------------------------|---------|---------|-----------------|
|---------------------------|---------|---------|-----------------|

Disclaimer: The information displayed above has been obtained using the property's postcode in proximity to its local authority. It is recommended that this information is independently verified.



Everything you want
to know about
transport links







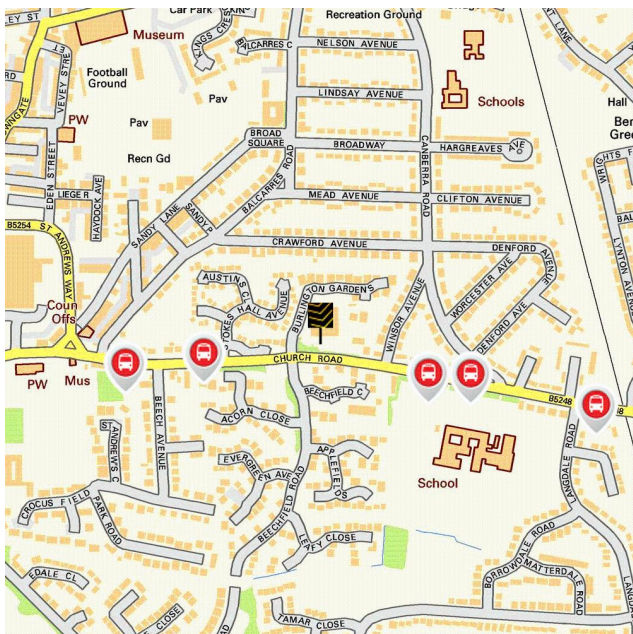

Become familiar with public transport links

Being able to choose to travel by public transport is important for many reasons. It helps to reduce congestion, provides access to work and education, and facilitates use of health and leisure facilities. If you or your family members travel abroad, access to the nearest ferry terminals is also likely to be a significant factor in choosing a new property. Using the maps below, you can pinpoint the precise locations of transport links for **Burlington Gardens**. Tables for each type of transport indicate the property's distance from the nearest bus stops, railway stations, coach stops and ferry terminals (providing that these facilities are within the scale proximity of the maps.)

Transport Links



| | Airports | Approx Distance |
|--|---|-----------------|
|  | Blackpool International Airport | 15.64 miles |
| | Liverpool John Lennon Airport | 25.22 miles |
| | Manchester Airport | 28.4 miles |
| | Leeds Bradford International Airport | 43.78 miles |
| | Ferry ports | Approx Distance |
|  | Knott End-On-Sea Ferry Landing | 20.73 miles |
| | Fleetwood for Knott End Ferry Landing | 20.9 miles |
| | Liverpool Belfast Ferry Terminal Bootle | 21.38 miles |
| | Liverpool Isle of Man & Dublin Terminal | 23.32 miles |
| | Liverpool Pier Head Ferry Terminal | 23.32 miles |
| | Train Stations | Approx Distance |
|  | Leyland Rail Station | 0.66 miles |
| | Buckshaw Parkway Rail Station | 1.61 miles |
| | Euxton Balshaw Lane Rail Station | 2.12 miles |
| | Lostock Hall Rail Station | 2.4 miles |
| | Bamber Bridge Rail Station | 2.84 miles |

Disclaimer: The information represented in this section has been sourced from the Department of Transport's Open Data and is based on the property's postcode. It is recommended that this information is independently verified.



Farrell Heyworth 13/15 Cleveland Street, Chorley, PR7 1BH 01772 624150

| | Bus Stops | Approx Distance |
|---|------------------------------|-----------------|
|  | Balshaws High School | 0.12 miles |
| | Eagle & Child | 0.12 miles |
| | Balshaws CEHS | 0.16 miles |
| | Eagle & Child | 0.2 miles |
| | Heald House Rd | 0.28 miles |
| | Coach Stops | Approx Distance |
|  | Chorley Interchange | 3.54 miles |
| | Preston Bus Station | 4.95 miles |
| | Fulwood (Preston) Coach Stop | 6.32 miles |
| | Freckleton Coach Stop | 8.57 miles |
| | Darwen Bus Station | 9.12 miles |

Disclaimer: The information represented in this section has been sourced from the Department of Transport's Open Data and is based on the property's postcode. It is recommended that this information is independently verified.



Farrell Heyworth 13/15 Cleveland Street, Chorley, PR7 1BH 01772 624150



Everything you want
to know about
local schools





How are local schools performing?

If schools are important to you, then this section sets out the published Key Performance Indicators for schools near to your prospective new home. Key Performance Indicators look primarily at how well pupils perform in their tests and examinations, as well as some other measures like attendance.

If you want to know more about a particular school or college, you can also visit the Ofsted website <http://www.ofsted.gov.uk/inspection-reports/find-inspection-report>

Local Schools

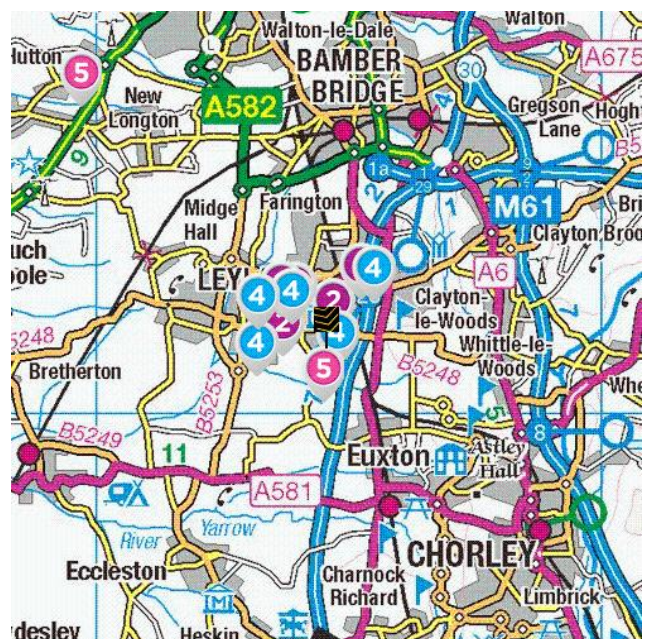
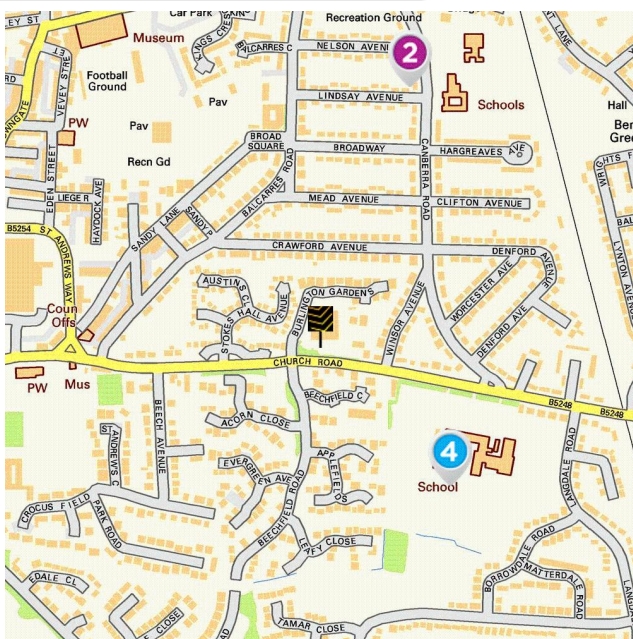

The next page shows tables and charts divided into Key Stages and a list of respective schools local to **Burlington Gardens**. There are four main age-related Key Stages defined as:



Special schools are marked with this icon

| Key Stage | Definition |
|-------------|---|
| Key Stage 1 | Fits broadly with the first stage of education, i.e. ages 5-7. |
| Key Stage 2 | Fits the later stage of primary education, often known as junior schools, i.e. ages 8-11. This takes pupils up to the standardised break at age 11 after which pupils generally change schools and transfer to secondary education. |
| Key Stage 3 | Secondary education split between key stages 3 and 4, with key stage 3 covering ages 11-13. |
| Key Stage 4 | Key Stage 4 (ages 14-16) covers the two year period of study for GCSE level examinations. |
| Key Stage 5 | Beyond key stage 4 is 16+ or Sixth Form provision, sometimes unofficially referred to as Key Stage 5. |



Farrell Heyworth 13/15 Cleveland Street, Chorley, PR7 1BH 01772 624150

| | Key Stage 2 - Information | Approx Distance |
|---|---|-----------------|
|  | <p>Name: Leyland Methodist Junior School Address: Canberra Road, Leyland, PR25 3ET Contact Number: 01772423694 Age Range: 7-11 yrs Local Education Authority: Lancashire Religious Character: Methodist</p> | 0.28 miles |
| | <p>Name: Woodlea Junior School Address: Woodlea Road, Leyland, PR25 1JL Contact Number: 01772421992 Age Range: 7-11 yrs Local Education Authority: Lancashire Religious Character: Does not apply</p> | 0.54 miles |
| | <p>Name: Leyland St Mary's Roman Catholic Primary School Address: Haig Avenue, Leyland, PR25 2QA Contact Number: 01772422431 Age Range: 3-11 yrs Local Education Authority: Lancashire Religious Character: Roman Catholic</p> | 0.6 miles |
| | <p>Name: Northbrook Primary School Address: Bannister Drive, Leyland, PR25 2GB Contact Number: 01772421599 Age Range: 4-11 yrs Local Education Authority: Lancashire Religious Character: Does not apply</p> | 0.72 miles |
| | <p>Name: St Catherine's RC Primary School Address: Moss Lane, Leyland, PR25 4SJ Contact Number: 01772423767 Age Range: 5-11 yrs Local Education Authority: Lancashire Religious Character: Roman Catholic</p> | 0.81 miles |

Disclaimer: The information represented in this section has been sourced from the Department of Education's 2019 results data s and is based on the property's postcode.



Reading, Writing and Maths

| | Name | Expected | Higher |
|---|---|----------|--------|
|  | Leyland Methodist Junior School | 62.0 % | 16.0 % |
| | Woodlea Junior School | 68.0 % | 12.0 % |
| | Leyland St Mary's Roman Catholic Primary School | 57.0 % | 2.0 % |
| | Northbrook Primary School | 27.0 % | 0.0 % |
| | St Catherine's RC Primary School | 74.0 % | 6.0 % |
| | Lancashire | 64.0 % | 10.0 % |
| National | 65.0 % | 11.0 % | |

Primary Progress Measures

As well as actual pupil performance in tests and exams an important Key Performance Indicator is that of progress measures that compare the actual achievements of other pupils nationally with similar prior attainment. Any increase in attainment achieved by each pupil will be reflected in the schools progress scores. They are fairer to schools in challenging circumstances, as they recognise a school that is doing a good job with an intake with poor prior attainment

Progress Measures for 2019

| | Name | Math | Reading | Writing |
|---|---|--------|---------|---------|
|  | Leyland Methodist Junior School | -1.5 % | -2.7 % | 0.4 % |
| | Woodlea Junior School | 0.4 % | 0.5 % | 0.0 % |
| | Leyland St Mary's Roman Catholic Primary School | -1.0 % | -0.8 % | -0.1 % |
| | Northbrook Primary School | -1.4 % | -2.5 % | -2.4 % |
| | St Catherine's RC Primary School | -0.5 % | 0.8 % | -0.5 % |

Disclaimer: The information represented in this section has been sourced from the Department of Education's 2019 results data set and is based on the property's postcode.



Farrell Heyworth 13/15 Cleveland Street, Chorley, PR7 1BH 01772 624150

| | Key Stage 4 - Information | Approx Distance |
|---|---|-----------------|
| 4 | <p>Name: Balshaw's Church of England High School Address: Church Road, Leyland, PR25 3AH Contact Number: 01772421009 Age Range: 11-16 yrs Local Education Authority: Lancashire Religious Character: Church of England</p> | 0.18 miles |
| | <p>Name: Wellfield High School Address: Yewlands Drive, Leyland, PR25 2TP Contact Number: 01772421303 Age Range: 11-16 yrs Local Education Authority: Lancashire Religious Character: Does not apply</p> | 0.57 miles |
| | <p>Name: Roselyn House School  Address: Moss Lane, Off Wigan Road, Leyland, PR25 4SE Contact Number: 01772435948 Age Range: 10-19 yrs Local Education Authority: Lancashire Religious Character: None</p> | 0.88 miles |
| | <p>Name: St Mary's Catholic High School Address: Royal Avenue, Leyland, PR25 1BS Contact Number: 01772421909 Age Range: 11-16 yrs Local Education Authority: Lancashire Religious Character: Roman Catholic</p> | 0.9 miles |
| | <p>Name: Academy@Worden Address: Westfield Drive, Leyland, PR25 1QX Contact Number: 01772421021 Age Range: 11-16 yrs Local Education Authority: Lancashire Religious Character: Does not apply</p> | 0.91 miles |

Disclaimer: The information represented in this section has been sourced from the Department of Education's 2019 results data s and is based on the property's postcode.



Percentage of pupils achieving 5+ A*-C/9-4 or equivalents including 9-4 in both English and mathematics GCSEs

| | Name | 2019 | 2018 | 2017 | 2016 |
|---|---|--------|--------|--------|--------|
| 4 | Balshaw's Church of England High School | 78.0 % | 74.0 % | 63.0 % | 67.0 % |
| | Wellfield High School | 56.0 % | 45.0 % | 44.0 % | 41.0 % |
| | Roselyn House School | 0.0 % | 0.0 % | N/A | 0.0 % |
| | St Mary's Catholic High School | 56.0 % | 67.0 % | 66.0 % | 60.0 % |
| | Academy@Worden | 68.0 % | 67.0 % | 58.0 % | 44.0 % |
| | Lancashire | 66.0 % | 66.1 % | 61.7 % | 58.5 % |
| | National | 60.0 % | 59.4 % | 56.6 % | 53.5 % |

Disclaimer: The information represented in this section has been sourced from the Department of Education's 2017 results data set and is based on the property's postcode.

Average number of GCSE entries per pupil

| | Name | Number |
|---|---|--------|
| 4 | Balshaw's Church of England High School | 8.0 |
| | Wellfield High School | 6.8 |
| | Roselyn House School | 1.1 |
| | St Mary's Catholic High School | 8.2 |
| | Academy@Worden | 7.5 |
| | Lancashire | 7.5 |
| | National | 7.1 |

Disclaimer: The information represented in this section has been sourced from the Department of Education's 2019 results data set and is based on the property's postcode.



| | Key Stage 5 - Information | Approx Distance |
|---|---|-----------------|
|  | <p>Name: Runshaw College Address: Langdale Road, Leyland, PR25 3DQ Contact Number: 01772622677 Age Range: 16+ yrs Local Education Authority: Lancashire Religious Character: Does not apply Admission Policy: Not applicable</p> | 0.59 miles |
| | <p>Name: Hutton Church of England Grammar School Address: Liverpool Road, Preston, PR4 5SN Contact Number: 01772613112 Age Range: 11-18 yrs Local Education Authority: Lancashire Religious Character: Church of England</p> | 4.29 miles |
| | <p>Name: Cardinal Newman College Address: Lark Hill Road, Preston, PR1 4HD Contact Number: 01772460181 Age Range: 16+ yrs Local Education Authority: Lancashire Religious Character: Roman Catholic Admission Policy: Not applicable</p> | 4.67 miles |
| | <p>Name: Preston Muslim Girls High School Address: Quwwatul Education Centre, Preston, PR1 6QQ Contact Number: 01772651906 Age Range: 11-19 yrs Local Education Authority: Lancashire Religious Character: Muslim</p> | 5.32 miles |
| | <p>Name: Moor Park High School and Sixth Form Address: Moor Park Avenue, Preston, PR1 6DT Contact Number: 01772795428 Age Range: 11-18 yrs Local Education Authority: Lancashire Religious Character: None</p> | 5.63 miles |

Disclaimer: The information represented in this section has been sourced from the Department of Education's 2019 results data set and is based on the property's postcode.



Percentage of A level students achieving at least three levels at grades AAB or better, at least two of which are in facilitating subjects

| | Name | % |
|---|---|---------------|
| 5 | Runshaw College | 16.3 % |
| | Hutton Church of England Grammar School | 11.8 % |
| | Cardinal Newman College | 13.1 % |
| | Preston Muslim Girls High School | N/A |
| | Moor Park High School and Sixth Form | 0.0 % |
| | Lancashire | 15.1 % |
| | National | 16.5 % |

Disclaimer: The information represented in this section has been sourced from the Department of Education's 2019 results data set and is based on the property's postcode.

As well as actual pupil performance in tests and exams, an important Key Performance Indicator is that of Value Added. When pupils start a school, they all have varying levels of ability and social advantage. A school's Value Added score measures how much progress they have made from the beginning to the end of their compulsory secondary education (i.e. between the end of Key Stage 2 and the end of Key Stage 4). It is a quick measurement of the effect of a school on its pupils.

| | Name | Value Added |
|---|---|-------------|
| 5 | Runshaw College | 0.0 |
| | Hutton Church of England Grammar School | 0.2 |
| | Cardinal Newman College | 0.2 |
| | Preston Muslim Girls High School | N/A |
| | Moor Park High School and Sixth Form | 0.1 |
| | | |



Farrell Heyworth 13/15 Cleveland Street, Chorley, PR7 1BH 01772 624150



Everything you want
to know about
local health services





How local are the health services?

We all want good access to local health facilities, wherever we live. To see how well **Burlington Gardens** is served, we have set out below the exact locations of hospitals, Accident & Emergency centres, GPs, pharmacies, dentists, out-of-hours medical care and walk-in clinics. Where it's available, you will find more detailed information, including the names of practitioners and their contact details.

| | Hospitals | Approx Distance |
|--|--|-----------------|
| | Chorley And South Ribble Hospital, Chorley and South Ribble Hospital, Chorley, Lancashire, PR7 1PP | 2.7 miles |
| | Royal Preston Hospital, Sharoe Green Lane North, Preston, Lancashire, PR2 9HT | 7.07 miles |
| | Royal Albert Edward Infirmary, Wigan, Lancashire, WN1 2NN | 9.43 miles |
| | Royal Blackburn Hospital, Haslingden Road, Blackburn, Lancashire, BB2 3HH | 9.66 miles |
| | Ormskirk And District General Hospital, Ormskirk, Lancashire, L39 2AZ | 11.4 miles |
| | A&E | Approx Distance |
| | Chorley And South Ribble Hospital, Chorley and South Ribble Hospital, Chorley, Lancashire, PR7 1PP | 2.7 miles |
| | Royal Preston Hospital, Sharoe Green Lane North, Preston, Lancashire, PR2 9HT | 7.07 miles |
| | Royal Albert Edward Infirmary, Wigan, Lancashire, WN1 2NN | 9.43 miles |
| | Royal Blackburn Hospital, Haslingden Road, Blackburn, Lancashire, BB2 3HH | 9.66 miles |
| | Southport And Formby District General Hospital, Southport, Merseyside, PR8 6PN | 12.44 miles |

| | Walk-in Clinics | Approx Distance |
|---|---|-----------------|
|  | Darwen Health Care, Darwen Health Centre, Lancashire, BB3 1PY | 8.92 miles |
| | Dr T L Phillips At Barbara Castle Health Centre, Level Two, Lancashire, BB2 1AX | 9.28 miles |
| | Royal Blackburn Hospital, Haslingden Road, Blackburn, Lancashire, BB2 3HH | 9.66 miles |
| | The Skelmersdale Walk In Centre, 116-118 The Concourse, Skelmersdale, Lancashire, WN8 6LJ | 10.24 miles |
| | Ormskirk And District General Hospital, Ormskirk, Lancashire, L39 2AZ | 11.4 miles |
| | GPs | Approx Distance |
|  | SANDY LANE SURGERY, SANDY LANE SURGERY, LANCASHIRE, PR25 2EB | 0.22 miles |
| | CENTRAL PARK SURGERY, CENTRAL PARK SURGERY, PRESTON, PR25 2TD | 0.49 miles |
| | STATION SURGERY, STATION SURGERY, LANCASHIRE, PR25 3NP | 0.59 miles |
| | WORDEN MEDICAL CENTRE, WORDEN MEDICAL CENTRE, LANCASHIRE, PR25 1HR | 0.82 miles |
| | BUCKSHAW VILLAGE HEALTH CENTRE, BUCKSHAW VILLAGE HLTH CTR, PR7 7HZ | 1.47 miles |
| | Dental Surgeons | Approx Distance |
|  | High Street Smiles, 107-109 High Street, WARRINGTON, Cheshire, WA3 3BZ | 15.13 miles |
| | Mr Jm Kelly & Associates, 7A Stonecross Lane, WARRINGTON, Cheshire, WA3 2SA | 15.48 miles |
| | L Askins, Woodgate, WARRINGTON, Cheshire, WA3 2QZ | 15.8 miles |
| | Hob Hey Dental Practice, 3 Hob Hey Lane, WARRINGTON, Cheshire, WA3 4NQ | 17.64 miles |
| | The Village Dental Practice, Warrington Road, WARRINGTON, Cheshire, WA3 5HH | 17.82 miles |

Disclaimer: The information represented in this section has been sourced from Experian and is based on the property's postcode.



Farrell Heyworth 13/15 Cleveland Street, Chorley, PR7 1BH **01772 624150**



Everything you want
to know about
local policing





Understanding who polices your neighbourhood

When you move to a new area, you want to know the arrangements for local community policing. See below for essential information about police services near to **Burlington Gardens**. We have included location and contact detail for the police station and wherever possible, details of police officers assigned to the area.

Your policing neighbourhood

The name of your policing neighbourhood is **Leyland St Marys** and it has a population of **3479**.

| Your Local Policing Team | | | |
|--------------------------|-----------|---------|--------|
| Name | Rank | Tel No. | E-mail |
| Tony Wojnarowski | PCSO | | |
| Katie Heaton | Constable | | |

Disclaimer: The information represented in this section has been sourced from data.police.uk.

Locations of Interest

Preston Police Station
 station
 Lancaster Road North Preston

Preston Police Station is open 08:00 to 20:00 Monday to Friday, 09:00 to 18:00 Saturday and Sunday

Disclaimer: The information represented in this section has been sourced from data.police.uk.



Farrell Heyworth 13/15 Cleveland Street, Chorley, PR7 1BH **01772 624150**

