



Everything you need to know about:

**Glebe Close,  
Burton, Carnforth,  
LA6 1PL**



**Introduction**



**The Property**



**Local Authority**



**Transport Links**

**Education**



**Health**



**Local Policing**





### An invaluable insight into your new home

This i-PACK brochure offers an informed overview of **Glebe Close** as a potential new home, along with essential material about its surrounding area and its local community. It provides a valuable insight for any prospective owner or tenant.

We wanted to provide you with information that you can absorb quickly, so we have presented it as visually as possible, making use of maps, icons, tables, graphs and charts. Overall, the brochure contains information about:

- **The Property** - including property details, floor plans, room details, photographs and Energy Performance Certificate.
- **Transport** - including locations of bus and coach stops, railway stations and ferry ports.
- **Health** - including locations, contact details and organisational information on the nearest GPs, pharmacies, hospitals and dentists.
- **Local Policing** - including locations, contact details and information about local community policing and the nearest police station, as well as police officers assigned to the area.
- **Education** - including locations of infant, primary and secondary schools and Key Performance Indicators (KPIs) for each key stage.





GLEBE CLOSE, CARNFORTH £259,950



x3  
Bedrooms



x0  
Living Rooms



x1  
Bathrooms

Where you are

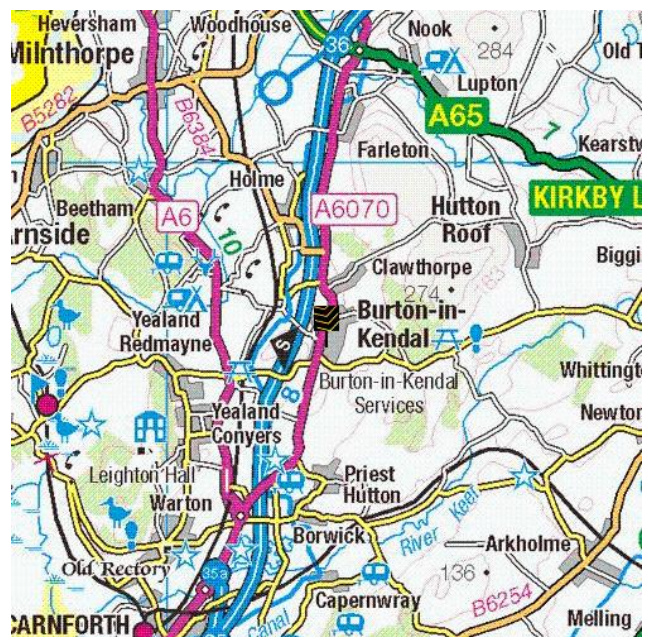
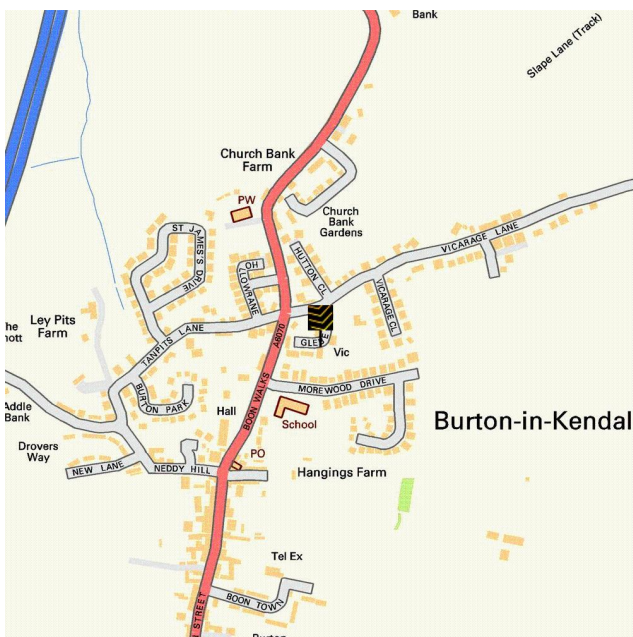





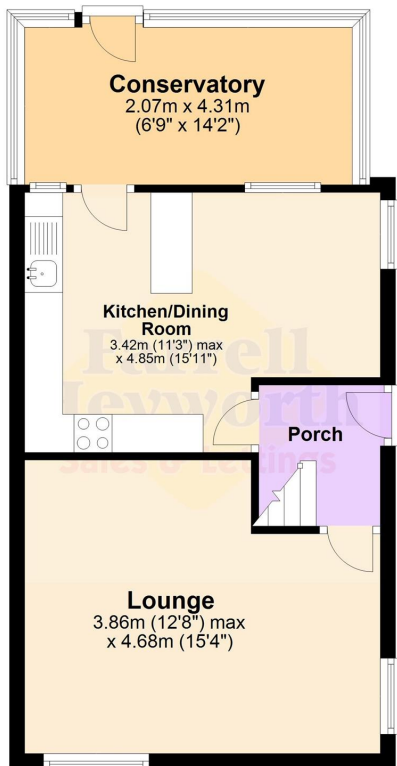

Ground Floor

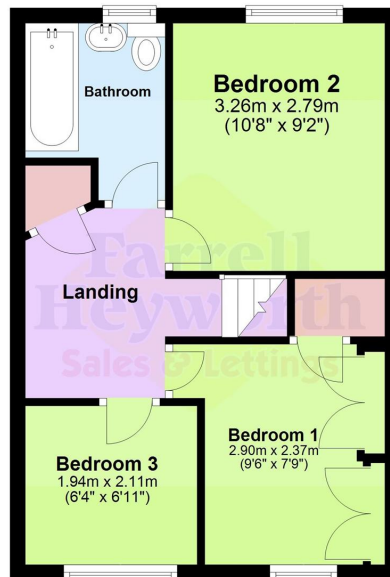

First Floor





Everything you want  
to know about  
local authorities







**Get to know your local authorities**

Local government directly affects quality of life, particularly when it comes to council tax, planning, waste disposal and the impact of local policies. You may want to investigate how this is likely to affect you if you decide to move. There are nearly 400 local authorities in England, with five different types of local government structure. These can be broadly divided into **single-tier** and **two-tier authorities**.

Single-tier authorities are **Metropolitan Authorities, London Boroughs** and **Unitary** or **Shire Authorities**.

Two-tier authorities have both a **County Council**, and a **District Council** or **City Council**.

There are also around 10,000 parish and town councils, effectively creating an additional tier in some areas - mostly, but not exclusively, in rural areas. The National Association of Local Councils (NALC) represents and works on behalf of these community councils and is a useful contact point.

The local authority locations and contact details for **Glebe Close** are:

Shire / County / District	Website	Address	Contact details
---------------------------	---------	---------	-----------------

**Disclaimer:** The information displayed above has been obtained using the property's postcode in proximity to its local authority. It is recommended that this information is independently verified.



Everything you want  
to know about  
transport links







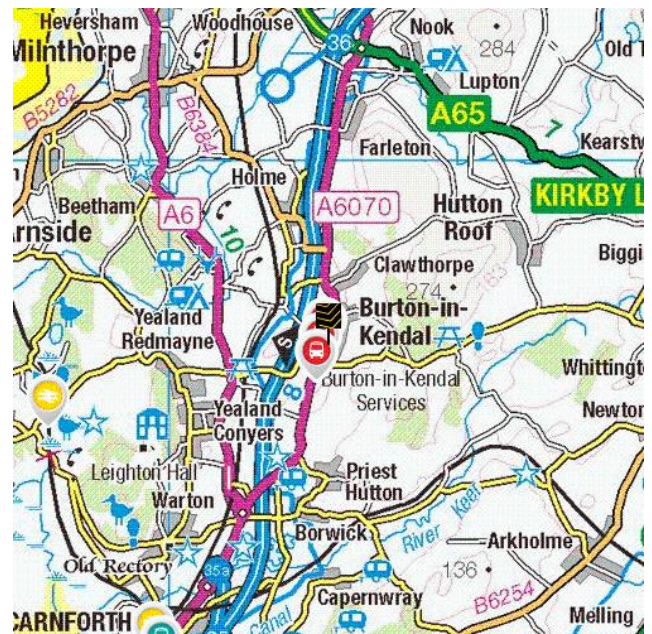
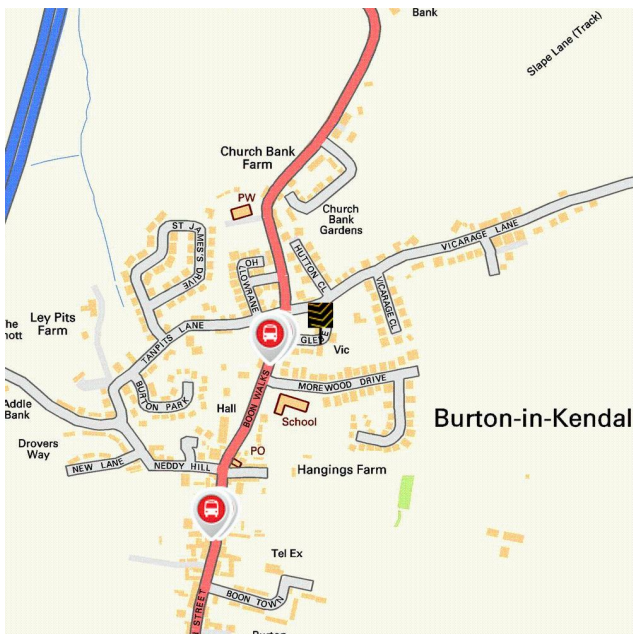

**Become familiar with public transport links**

Being able to choose to travel by public transport is important for many reasons. It helps to reduce congestion, provides access to work and education, and facilitates use of health and leisure facilities. If you or your family members travel abroad, access to the nearest ferry terminals is also likely to be a significant factor in choosing a new property. Using the maps below, you can pinpoint the precise locations of transport links for **Glebe Close**. Tables for each type of transport indicate the property's distance from the nearest bus stops, railway stations, coach stops and ferry terminals (providing that these facilities are within the scale proximity of the maps.)

**Transport Links**





	Airports	Approx Distance
	Blackpool International Airport	30.96 miles
	Leeds Bradford International Airport	48.16 miles
	Ferry ports	Approx Distance
	Fell Foot Country Park Ferry Landing	11.37 miles
	Lakeside Windermere Ferry Landing	11.52 miles
	Heysham Ferry Terminal	13.02 miles
	Bowness Ferry Nab Ferry Landing	14.52 miles
	Far Sawrey Windermere Ferry Terminal	14.64 miles
	Train Stations	Approx Distance
	Silverdale Rail Station	3.57 miles
	Carnforth Rail Station	4.32 miles
	Arnside Rail Station	4.59 miles
	Wennington Rail Station	6.77 miles
	Grange-over-Sands Rail Station	7.46 miles

**Disclaimer:** The information represented in this section has been sourced from the Department of Transport's Open Data and is based on the property's postcode. It is recommended that this information is independently verified.



**Farrell Heyworth** 18 New Street, Lancaster, LA1 1EG 01524 736777

	Bus Stops	Approx Distance
	Glebe Close	0.04 miles
	Main Street at Tanpits Lane	0.05 miles
	The Square (S bound)	0.21 miles
	The Square (N bound)	0.22 miles
	Green Dragon Farm (S bound)	0.42 miles
	Coach Stops	Approx Distance
	Carnforth: Lancaster Rd Coach Stop	4.42 miles
	Bolton le Sands (Lancs): Coach Stop	6.28 miles
	Grange-over-Sands: Rail Station Coach Stop	7.47 miles
	Lancaster Bus Station	9.82 miles
	Morecambe: Central Drive Bus Station	9.96 miles

**Disclaimer:** The information represented in this section has been sourced from the Department of Transport's Open Data and is based on the property's postcode. It is recommended that this information is independently verified.



**Farrell Heyworth** 18 New Street, Lancaster, LA1 1EG 01524 736777



Everything you want  
to know about  
local schools





### How are local schools performing?

If schools are important to you, then this section sets out the published Key Performance Indicators for schools near to your prospective new home. Key Performance Indicators look primarily at how well pupils perform in their tests and examinations, as well as some other measures like attendance.

If you want to know more about a particular school or college, you can also visit the Ofsted website <http://www.ofsted.gov.uk/inspection-reports/find-inspection-report>

## Local Schools

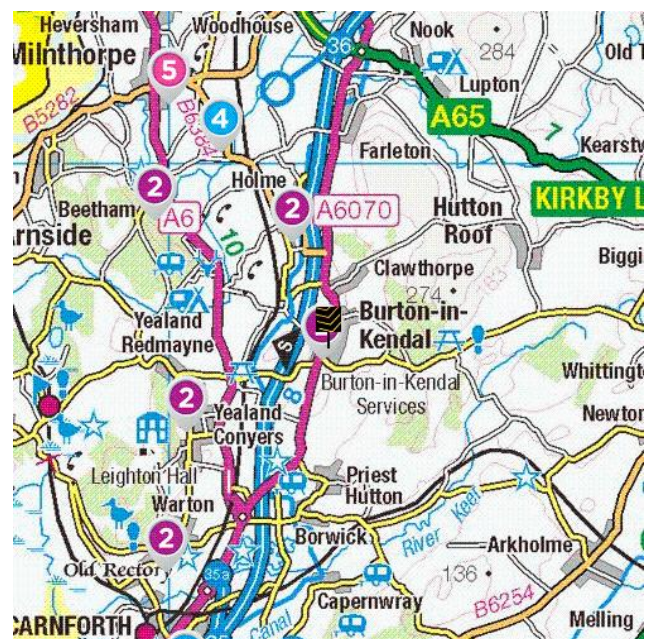
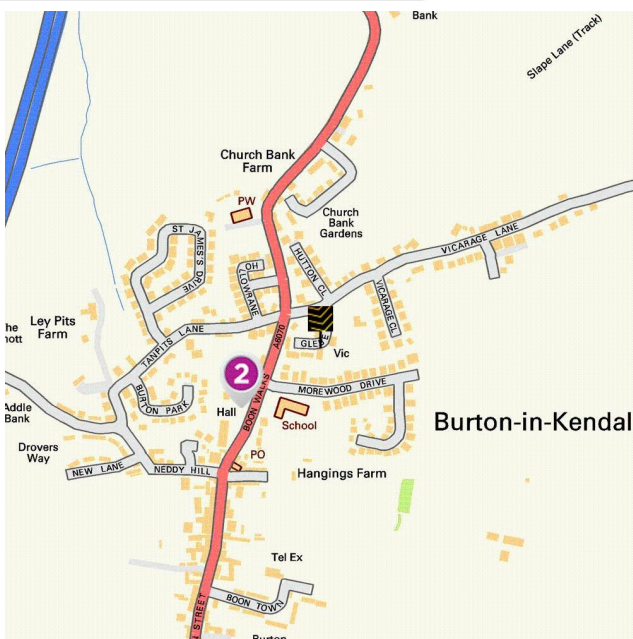

The next page shows tables and charts divided into Key Stages and a list of respective schools local to **Glebe Close**. There are four main age-related Key Stages defined as:



Special schools are marked with this icon

Key Stage	Definition
Key Stage 1	Fits broadly with the first stage of education, i.e. ages 5-7.
Key Stage 2	Fits the later stage of primary education, often known as junior schools, i.e. ages 8-11. This takes pupils up to the standardised break at age 11 after which pupils generally change schools and transfer to secondary education.
Key Stage 3	Secondary education split between key stages 3 and 4, with key stage 3 covering ages 11-13.
Key Stage 4	Key Stage 4 (ages 14-16) covers the two year period of study for GCSE level examinations.
Key Stage 5	Beyond key stage 4 is 16+ or Sixth Form provision, sometimes unofficially referred to as Key Stage 5.



**Farrell Heyworth** 18 New Street, Lancaster, LA1 1EG **01524 736777**



	Key Stage 2 - Information	Approx Distance
	<p><b>Name:</b> Burton Morewood CofE Primary School  <b>Address:</b> Main Street, Carnforth, LA6 1ND  <b>Contact Number:</b> 01524781627  <b>Age Range:</b> 2-11 yrs  <b>Local Education Authority:</b> Cumbria  <b>Religious Character:</b> Church of England</p>	0.09 miles
	<p><b>Name:</b> Holme Primary School  <b>Address:</b> North Road, Carnforth, LA6 1QA  <b>Contact Number:</b> 01524781205  <b>Age Range:</b> 3-11 yrs  <b>Local Education Authority:</b> Cumbria  <b>Religious Character:</b> Does not apply</p>	1.45 miles
	<p><b>Name:</b> Yealand Church of England Primary School  <b>Address:</b> Footeran Lane, Carnforth, LA5 9SU  <b>Contact Number:</b> 01524781360  <b>Age Range:</b> 3-11 yrs  <b>Local Education Authority:</b> Lancashire  <b>Religious Character:</b> Church of England</p>	1.98 miles
	<p><b>Name:</b> Beetham CofE Primary School  <b>Address:</b> Stanley Street, Milnthorpe, LA7 7AS  <b>Contact Number:</b> 01539562515  <b>Age Range:</b> 3-11 yrs  <b>Local Education Authority:</b> Cumbria  <b>Religious Character:</b> Church of England</p>	2.7 miles
	<p><b>Name:</b> Warton Archbishop Hutton's VC Primary School  <b>Address:</b> Back Lane, Carnforth, LA5 9QU  <b>Contact Number:</b> 01524734305  <b>Age Range:</b> 4-11 yrs  <b>Local Education Authority:</b> Lancashire  <b>Religious Character:</b> Christian</p>	3.31 miles

**Disclaimer:** The information represented in this section has been sourced from the Department of Education's 2019 results data s and is based on the property's postcode.



## Reading, Writing and Maths

	Name	Expected	Higher
	Burton Morewood CofE Primary School	65.0 %	6.0 %
	Holme Primary School	73.0 %	7.0 %
	Yealand Church of England Primary School	N/A	N/A
	Beetham CofE Primary School	N/A	N/A
	Warton Archbishop Hutton's VC Primary School	62.0 %	10.0 %
	<b>Cumbria</b>	66.0 %	9.0 %
<b>National</b>	65.0 %	11.0 %	

## Primary Progress Measures

As well as actual pupil performance in tests and exams an important Key Performance Indicator is that of progress measures that compare the actual achievements of other pupils nationally with similar prior attainment. Any increase in attainment achieved by each pupil will be reflected in the schools progress scores. They are fairer to schools in challenging circumstances, as they recognise a school that is doing a good job with an intake with poor prior attainment



## Progress Measures for 2019

	Name	Math	Reading	Writing
	Burton Morewood CofE Primary School	0.0 %	1.1 %	0.6 %
	Holme Primary School	-1.4 %	1.2 %	1.7 %
	Yealand Church of England Primary School	N/A	N/A	N/A
	Beetham CofE Primary School	N/A	N/A	N/A
	Warton Archbishop Hutton's VC Primary School	-3.4 %	-3.0 %	-2.8 %

**Disclaimer:** The information represented in this section has been sourced from the Department of Education's 2019 results data set and is based on the property's postcode.



Farrell Heyworth 18 New Street, Lancaster, LA1 1EG 01524 736777

	Key Stage 4 - Information	Approx Distance
	 <p><b>Name:</b> Wings School  <b>Address:</b> Whassett, Milnthorpe, LA7 7DN  <b>Contact Number:</b> 01539562006  <b>Age Range:</b> 10-17 yrs  <b>Local Education Authority:</b> Cumbria  <b>Religious Character:</b> None</p>	2.81 miles
	<p><b>Name:</b> Dallam School  <b>Address:</b> Milnthorpe, LA7 7DD  <b>Contact Number:</b> 01539565165  <b>Age Range:</b> 11-18 yrs  <b>Local Education Authority:</b> Cumbria  <b>Religious Character:</b> None</p>	3.66 miles
	<p><b>Name:</b> Carnforth High School  <b>Address:</b> Kellet Road, Carnforth, LA5 9LS  <b>Contact Number:</b> 01524732424  <b>Age Range:</b> 11-18 yrs  <b>Local Education Authority:</b> Lancashire  <b>Religious Character:</b> Does not apply</p>	4.43 miles
	 <p><b>Name:</b> Bleasdale School  <b>Address:</b> 27 Emesgate Lane, Carnforth, LA5 0RG  <b>Contact Number:</b> 01524701217  <b>Age Range:</b> 2-19 yrs  <b>Local Education Authority:</b> Lancashire  <b>Religious Character:</b> Does not apply</p>	4.46 miles
	<p><b>Name:</b> Queen Elizabeth Studio School  <b>Address:</b> Kirkby Lonsdale, LA6 2HJ  <b>Contact Number:</b> 01524271275  <b>Age Range:</b> 14-19 yrs  <b>Local Education Authority:</b> Cumbria  <b>Religious Character:</b> Does not apply</p>	4.8 miles

**Disclaimer:** The information represented in this section has been sourced from the Department of Education's 2019 results data s and is based on the property's postcode.



**Percentage of pupils achieving 5+ A\*-C/9-4 or equivalents including 9-4 in both English and mathematics GCSEs**

	Name	2019	2018	2017	2016
4	Wings School	N/A	0.0 %	N/A	0.0 %
	Dallam School	72.0 %	68.0 %	74.0 %	67.0 %
	Carnforth High School	54.0 %	N/A	N/A	N/A
	Bleasdale School	N/A	N/A	N/A	N/A
	Queen Elizabeth Studio School	47.0 %	N/A	N/A	N/A
	<b>Cumbria</b>	<b>64.0 %</b>	<b>65.3 %</b>	<b>62.8 %</b>	<b>56.7 %</b>
	<b>National</b>	<b>60.0 %</b>	<b>59.4 %</b>	<b>56.6 %</b>	<b>53.5 %</b>

**Disclaimer:** The information represented in this section has been sourced from the Department of Education's 2017 results data set and is based on the property's postcode.

**Average number of GCSE entries per pupil**

	Name	Number
4	Wings School	N/A
	Dallam School	7.6
	Carnforth High School	8.1
	Bleasdale School	N/A
	Queen Elizabeth Studio School	6.2
	<b>Cumbria</b>	<b>7.4</b>
	<b>National</b>	<b>7.1</b>

**Disclaimer:** The information represented in this section has been sourced from the Department of Education's 2019 results data set and is based on the property's postcode.



	Key Stage 5 - Information	Approx Distance
	<b>Name:</b> Dallam School <b>Address:</b> Milnthorpe, LA7 7DD <b>Contact Number:</b> 01539565165 <b>Age Range:</b> 11-18 yrs <b>Local Education Authority:</b> Cumbria <b>Religious Character:</b> None	3.66 miles
	<b>Name:</b> Queen Elizabeth School <b>Address:</b> Kirkby Lonsdale, LA6 2HJ <b>Contact Number:</b> 01524271275 <b>Age Range:</b> 11-18 yrs <b>Local Education Authority:</b> Cumbria <b>Religious Character:</b> None	4.8 miles
	<b>Name:</b> Oneschool Global Uk Lancaster Campus <b>Address:</b> Melling Road, Lancaster, LA2 8LH <b>Contact Number:</b> 01524222159 <b>Age Range:</b> 7-18 yrs <b>Local Education Authority:</b> Lancashire <b>Religious Character:</b> Plymouth Brethren Christian Church	5.79 miles
	<b>Name:</b> Morecambe Community High School <b>Address:</b> Dallam Avenue, Morecambe, LA4 5BG <b>Contact Number:</b> 01524410207 <b>Age Range:</b> 11-18 yrs <b>Local Education Authority:</b> Lancashire <b>Religious Character:</b> Does not apply	9.2 miles
	<b>Name:</b> Kirkbie Kendal School <b>Address:</b> Lound Road, Kendal, LA9 7EQ <b>Contact Number:</b> 01539727422 <b>Age Range:</b> 11-18 yrs <b>Local Education Authority:</b> Cumbria <b>Religious Character:</b> None	9.23 miles

**Disclaimer:** The information represented in this section has been sourced from the Department of Education's 2019 results data s and is based on the property's postcode.



**Farrell Heyworth** 18 New Street, Lancaster, LA1 1EG 01524 736777

**Percentage of A level students achieving at least three levels at grades AAB or better, at least two of which are in facilitating subjects**

	Name	%
	Dallam School	21.9 %
	Queen Elizabeth School	17.1 %
	Oneschool Global Uk Lancaster Campus	N/A
	Morecambe Community High School	6.1 %
	Kirkbie Kendal School	25.0 %
	<b>Cumbria</b>	<b>16.5 %</b>
	<b>National</b>	<b>16.5 %</b>

**Disclaimer:** The information represented in this section has been sourced from the Department of Education's 2019 results data set and is based on the property's postcode.

As well as actual pupil performance in tests and exams, an important Key Performance Indicator is that of Value Added. When pupils start a school, they all have varying levels of ability and social advantage. A school's Value Added score measures how much progress they have made from the beginning to the end of their compulsory secondary education (i.e. between the end of Key Stage 2 and the end of Key Stage 4). It is a quick measurement of the effect of a school on its pupils.

	Name	Value Added
	Dallam School	0.1
	Queen Elizabeth School	0.1
	Oneschool Global Uk Lancaster Campus	0.1
	Morecambe Community High School	-0.5
	Kirkbie Kendal School	0.1



**Farrell Heyworth** 18 New Street, Lancaster, LA1 1EG 01524 736777



Everything you want  
to know about  
local health services





**How local are the health services?**

We all want good access to local health facilities, wherever we live. To see how well **Glebe Close** is served, we have set out below the exact locations of hospitals, Accident & Emergency centres, GPs, pharmacies, dentists, out-of-hours medical care and walk-in clinics. Where it's available, you will find more detailed information, including the names of practitioners and their contact details.

	Hospitals	Approx Distance
	Westmorland General Hospital, Kendal, LA9 7RG	8.47 miles
	Royal Lancaster Infirmary, Ashton Road, Lancaster, Lancashire, LA1 4RP	10.29 miles
	Furness General Hospital, Dalton Lane, Barrow-In-Furness, Cumbria, LA14 4LF	20.04 miles
	Royal Preston Hospital, Sharoe Green Lane North, Preston, Lancashire, PR2 9HT	27.14 miles
	Blackpool Victoria Hospital, Whinney Heys Road, Blackpool, Lancashire, FY3 8NR	27.86 miles
	A&E	Approx Distance
	Royal Lancaster Infirmary, Ashton Road, Lancaster, Lancashire, LA1 4RP	10.29 miles
	Furness General Hospital, Dalton Lane, Barrow-In-Furness, Cumbria, LA14 4LF	20.04 miles
	Royal Preston Hospital, Sharoe Green Lane North, Preston, Lancashire, PR2 9HT	27.14 miles
	Blackpool Victoria Hospital, Whinney Heys Road, Blackpool, Lancashire, FY3 8NR	27.86 miles
	Royal Blackburn Hospital, Haslingden Road, Blackburn, Lancashire, BB2 3HH	32.56 miles



Walk-in Clinics		Approx Distance
	Westmorland General Hospital, Kendal, LA9 7RG	8.47 miles
	Same Day Health Centre – Morecambe, Same Day Health Centre, Morecambe, Lancashire, LA4 5LY	9.57 miles
	Same Day Health Centre – Fleetwood, Same Day Health Centre, Fleetwood, Lancashire, FY7 6HP	21.68 miles
	Blackpool Victoria Hospital, Whinney Heys Road, Blackpool, Lancashire, FY3 8NR	27.86 miles
	Blackpool Nhs Walk-in Centre, Whitegate Health Centre, Blackpool, Lancashire, FY3 9ES	28.67 miles
GPs		Approx Distance
	STONELEIGH SURGERY, STONELEIGH SURGERY, CUMBRIA, LA7 7PW	3.63 miles
	PARK VIEW SURGERY, PARK VIEW SURGERY, CUMBRIA, LA7 7PS	3.66 miles
	ASH TREES SURGERY, ASH TREES SURGERY, LANCASHIRE, LA5 9JU	4.3 miles
	ARNSIDE SURGERY, THE SURGERY, LANCASHIRE, LA5 0DP	4.73 miles
	LUNESDALE SURGERY, THE LUNESDALE SURGERY, LANCASHIRE, LA6 2HQ	4.85 miles
Dental Surgeons		Approx Distance
	Lancaster Dental Clinic, 8 Aldrens Lane, LANCASTER, Lancashire, LA1 2DU	9.21 miles
	Ashfield House Dental Practice, 66 Main Street, LANCASTER, Lancashire, LA2 7HZ	9.45 miles
	3a Dental Care, 3 Great John Street, LANCASTER, Lancashire, LA1 1NQ	9.88 miles
	Bay Dental Partnership, 6 New Street, LANCASTER, Lancashire, LA1 1EG	9.91 miles
	Marketgate Dental Practice, Marketgate Shopping Centre, LANCASTER, Lancashire, LA1 1JF	9.96 miles

**Disclaimer:** The information represented in this section has been sourced from Experian and is based on the property's postcode.



**Farrell Heyworth** 18 New Street, Lancaster, LA1 1EG **01524 736777**



Everything you want  
to know about  
local policing





### Understanding who polices your neighbourhood

When you move to a new area, you want to know the arrangements for local community policing. See below for essential information about police services near to **Glebe Close**. We have included location and contact details for the police station and wherever possible, details of police officers assigned to the area.

#### Your policing neighbourhood

The name of your policing neighbourhood is **Kirkby Lonsdale, Sedburgh and Milnthorpe** and it has a population of 0

Your Local Policing Team			
Name	Rank	Tel No.	E-mail
Grant Kelso	Inspector		
Suzanne Scott O-Neil	Sergeant		
Jamie Callon	PC		
Mandy Coleman	PCSO		
Jenna Egglestone	PCSO		
Hayley Newman	PCSO		

**Disclaimer:** The information represented in this section has been sourced from data.police.uk.

**Disclaimer:** The information represented in this section has been sourced from data.police.uk.



**Farrell Heyworth** 18 New Street, Lancaster, LA1 1EG **01524 736777**

