



Everything you need to know about:

**Borwick Close,
Warton, Carnforth,
LA5 9QY**



Introduction



The Property



Local Authority



Transport Links

Education



Health



Local Policing





An invaluable insight into your new home

This i-PACK brochure offers an informed overview of **Borwick Close** as a potential new home, along with essential material about its surrounding area and its local community. It provides a valuable insight for any prospective owner or tenant.

We wanted to provide you with information that you can absorb quickly, so we have presented it as visually as possible, making use of maps, icons, tables, graphs and charts. Overall, the brochure contains information about:

- **The Property** - including property details, floor plans, room details, photographs and Energy Performance Certificate.
- **Transport** - including locations of bus and coach stops, railway stations and ferry ports.
- **Health** - including locations, contact details and organisational information on the nearest GPs, pharmacies, hospitals and dentists.
- **Local Policing** - including locations, contact details and information about local community policing and the nearest police station, as well as police officers assigned to the area.
- **Education** - including locations of infant, primary and secondary schools and Key Performance Indicators (KPIs) for each key stage.



Farrell Heyworth 18 New Street, Lancaster, LA1 1EG 01524 736777



BORWICK CLOSE, CARNFORTH £325,000



x4
Bedrooms



x1
Living Rooms



x1
Bathrooms

Where you are

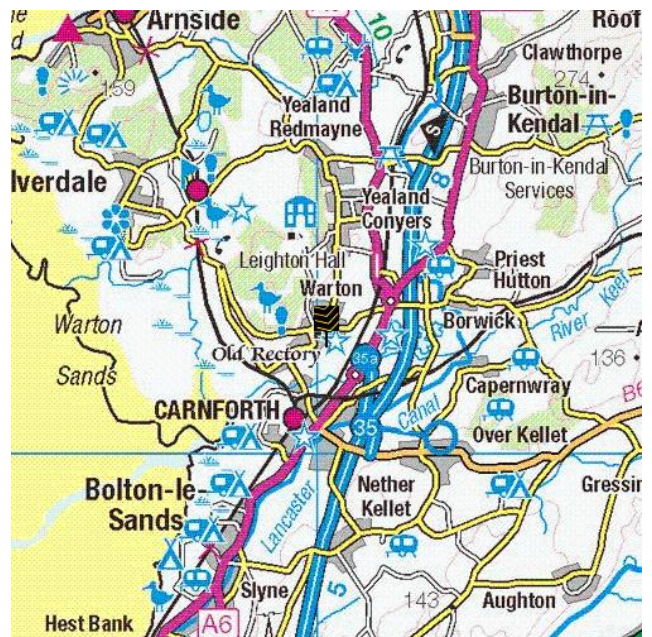
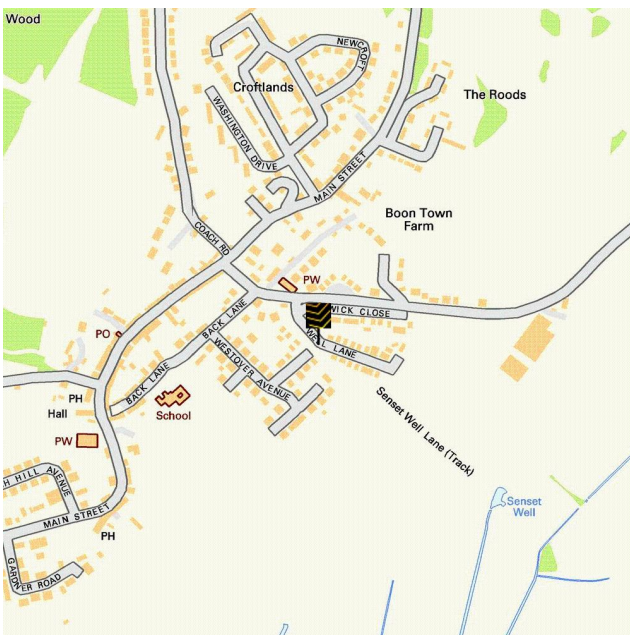



Rear Garden view 2



Lounge





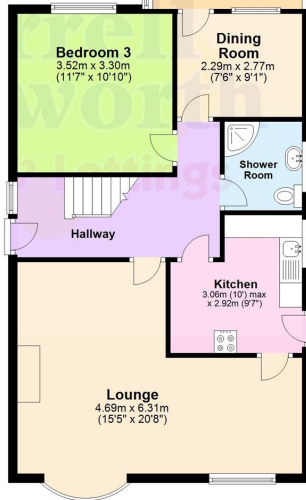
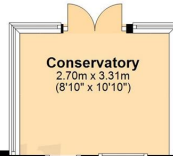
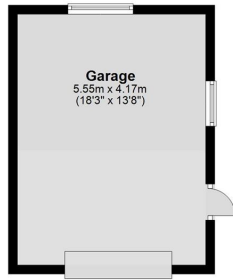

Ground Floor

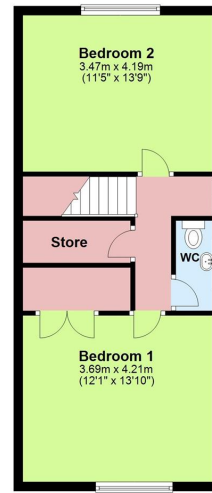

First Floor





Everything you want
to know about
local authorities





Get to know your local authorities

Local government directly affects quality of life, particularly when it comes to council tax, planning, waste disposal and the impact of local policies. You may want to investigate how this is likely to affect you if you decide to move. There are nearly 400 local authorities in England, with five different types of local government structure. These can be broadly divided into **single-tier** and **two-tier authorities**. Single-tier authorities are **Metropolitan Authorities, London Boroughs** and **Unitary or Shire Authorities**. Two-tier authorities have both a **County Council**, and a **District Council or City Council**. There are also around 10,000 parish and town councils, effectively creating an additional tier in some areas - mostly, but not exclusively, in rural areas. The National Association of Local Councils (NALC) represents and works on behalf of these community councils and is a useful contact point.

The local authority locations and contact details for **Borwick Close** are:

Shire / County / District	Website	Address	Contact details
---------------------------	---------	---------	-----------------

Disclaimer: The information displayed above has been obtained using the property's postcode in proximity to its local authority. It is recommended that this information is independently verified.



Everything you want
to know about
transport links







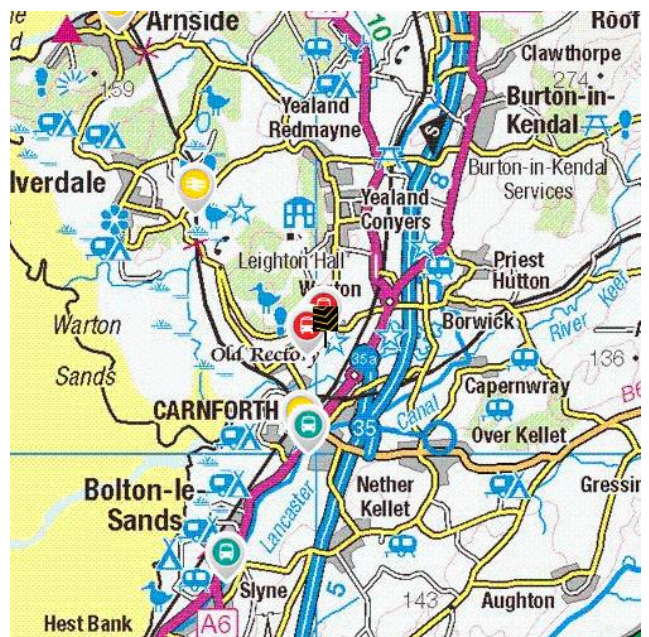
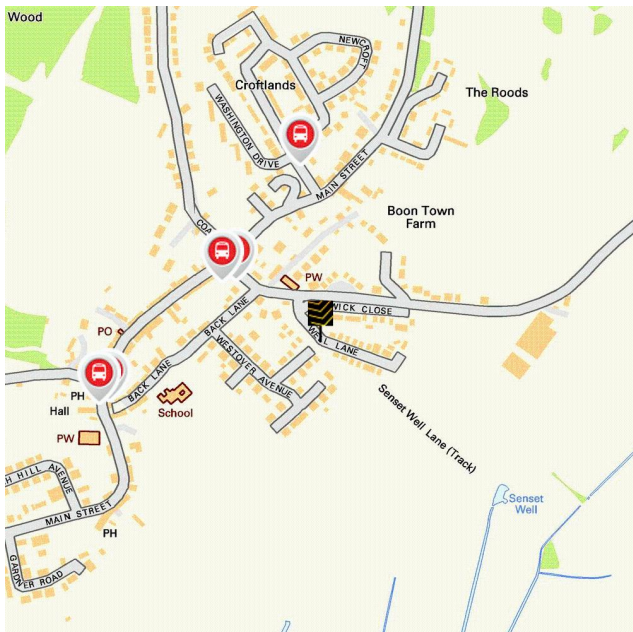

Become familiar with public transport links

Being able to choose to travel by public transport is important for many reasons. It helps to reduce congestion, provides access to work and education, and facilitates use of health and leisure facilities. If you or your family members travel abroad, access to the nearest ferry terminals is also likely to be a significant factor in choosing a new property. Using the maps below, you can pinpoint the precise locations of transport links for **Borwick Close**. Tables for each type of transport indicate the property's distance from the nearest bus stops, railway stations, coach stops and ferry terminals (providing that these facilities are within the scale proximity of the maps.)

Transport Links





	Airports	Approx Distance
	Blackpool International Airport	27.8 miles
	Leeds Bradford International Airport	48.7 miles
	Ferry ports	Approx Distance
	Heysham Ferry Terminal	9.81 miles
	Fell Foot Country Park Ferry Landing	11.81 miles
	Lakeside Windermere Ferry Landing	11.95 miles
	Bowness Ferry Nab Ferry Landing	15.89 miles
	Far Sawrey Windermere Ferry Terminal	15.95 miles
	Train Stations	Approx Distance
	Carnforth Rail Station	1.16 miles
	Silverdale Rail Station	2.31 miles
	Arnside Rail Station	4.71 miles
	Bare Lane Rail Station	5.71 miles
	Grange-over-Sands Rail Station	6.58 miles

Disclaimer: The information represented in this section has been sourced from the Department of Transport's Open Data and is based on the property's postcode. It is recommended that this information is independently verified.



Farrell Heyworth 18 New Street, Lancaster, LA1 1EG 01524 736777

	Bus Stops	Approx Distance
	Borwick Lane End	0.11 miles
	Borwick Lane	0.12 miles
	Croftlands	0.18 miles
	George Washington	0.21 miles
	George Washington	0.22 miles
	Coach Stops	Approx Distance
	Carnforth: Lancaster Rd Coach Stop	1.3 miles
	Bolton le Sands (Lancs): Coach Stop	3.1 miles
	Grange-over-Sands: Rail Station Coach Stop	6.59 miles
	Morecambe: Central Drive Bus Station	6.76 miles
	Lancaster Bus Station	6.76 miles

Disclaimer: The information represented in this section has been sourced from the Department of Transport's Open Data and is based on the property's postcode. It is recommended that this information is independently verified.



Farrell Heyworth 18 New Street, Lancaster, LA1 1EG 01524 736777



Everything you want
to know about
local schools





How are local schools performing?

If schools are important to you, then this section sets out the published Key Performance Indicators for schools near to your prospective new home. Key Performance Indicators look primarily at how well pupils perform in their tests and examinations, as well as some other measures like attendance.

If you want to know more about a particular school or college, you can also visit the Ofsted website <http://www.ofsted.gov.uk/inspection-reports/find-inspection-report>

Local Schools

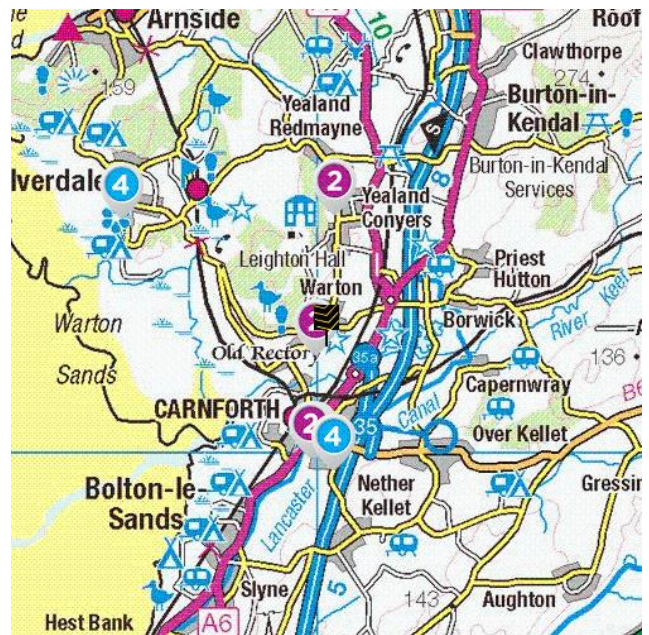
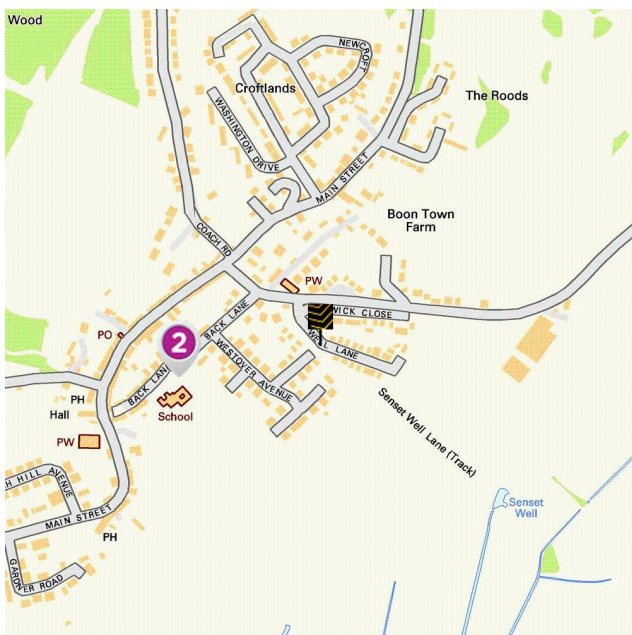

The next page shows tables and charts divided into Key Stages and a list of respective schools local to **Borwick Close**. There are four main age-related Key Stages defined as:



Special schools are marked with this icon

Key Stage	Definition
Key Stage 1	Fits broadly with the first stage of education, i.e. ages 5-7.
Key Stage 2	Fits the later stage of primary education, often known as junior schools, i.e. ages 8-11. This takes pupils up to the standardised break at age 11 after which pupils generally change schools and transfer to secondary education.
Key Stage 3	Secondary education split between key stages 3 and 4, with key stage 3 covering ages 11-13.
Key Stage 4	Key Stage 4 (ages 14-16) covers the two year period of study for GCSE level examinations.
Key Stage 5	Beyond key stage 4 is 16+ or Sixth Form provision, sometimes unofficially referred to as Key Stage 5.



Farrell Heyworth 18 New Street, Lancaster, LA1 1EG 01524 736777

	Key Stage 2 - Information	Approx Distance
	<p>Name: Warton Archbishop Hutton's VC Primary School Address: Back Lane, Carnforth, LA5 9QU Contact Number: 01524734305 Age Range: 4-11 yrs Local Education Authority: Lancashire Religious Character: Christian</p>	0.14 miles
	<p>Name: Carnforth Christ Church, Church of England, Voluntary Aided Primary School Address: North Road, Carnforth, LA5 9LJ Contact Number: 01524732536 Age Range: 4-11 yrs Local Education Authority: Lancashire Religious Character: Church of England</p>	1.29 miles
	<p>Name: North Road Primary School Address: North Road, Carnforth, LA5 9LQ Contact Number: 01524732435 Age Range: 5-11 yrs Local Education Authority: Lancashire Religious Character: Does not apply</p>	1.3 miles
	<p>Name: Our Lady of Lourdes Catholic Primary School, Carnforth Address: Kellet Road, Carnforth, LA5 9LS Contact Number: 01524732289 Age Range: 3-11 yrs Local Education Authority: Lancashire Religious Character: Roman Catholic</p>	1.43 miles
	<p>Name: Yealand Church of England Primary School Address: Footeran Lane, Carnforth, LA5 9SU Contact Number: 01524781360 Age Range: 3-11 yrs Local Education Authority: Lancashire Religious Character: Church of England</p>	1.7 miles

Disclaimer: The information represented in this section has been sourced from the Department of Education's 2019 results data s and is based on the property's postcode.



Reading, Writing and Maths

	Name	Expected	Higher
2	Warton Archbishop Hutton's VC Primary School	62.0 %	10.0 %
	Carnforth Christ Church, Church of England, Voluntary Aided Primary School	86.0 %	14.0 %
	North Road Primary School	68.0 %	18.0 %
	Our Lady of Lourdes Catholic Primary School, Carnforth	71.0 %	14.0 %
	Yealand Church of England Primary School	N/A	N/A
	Lancashire	64.0 %	10.0 %
National	65.0 %	11.0 %	

Primary Progress Measures

As well as actual pupil performance in tests and exams an important Key Performance Indicator is that of progress measures that compare the actual achievements of other pupils nationally with similar prior attainment. Any increase in attainment achieved by each pupil will be reflected in the schools progress scores. They are fairer to schools in challenging circumstances, as they recognise a school that is doing a good job with an intake with poor prior attainment



Progress Measures for 2019

	Name	Math	Reading	Writing
2	Warton Archbishop Hutton's VC Primary School	-3.4 %	-3.0 %	-2.8 %
	Carnforth Christ Church, Church of England, Voluntary Aided Primary School	2.7 %	2.1 %	2.3 %
	North Road Primary School	2.4 %	0.5 %	-0.4 %
	Our Lady of Lourdes Catholic Primary School, Carnforth	-0.2 %	-0.5 %	-0.7 %
	Yealand Church of England Primary School	N/A	N/A	N/A

Disclaimer: The information represented in this section has been sourced from the Department of Education's 2019 results data set and is based on the property's postcode.



Farrell Heyworth 18 New Street, Lancaster, LA1 1EG 01524 736777

	Key Stage 4 - Information	Approx Distance
	<p>Name: Carnforth High School Address: Kellet Road, Carnforth, LA5 9LS Contact Number: 01524732424 Age Range: 11-18 yrs Local Education Authority: Lancashire Religious Character: Does not apply</p>	1.43 miles
	<p> Name: Bleasdale School Address: 27 Emesgate Lane, Carnforth, LA5 0RG Contact Number: 01524701217 Age Range: 2-19 yrs Local Education Authority: Lancashire Religious Character: Does not apply</p>	3.01 miles
	<p> Name: Wings School Address: Whassett, Milnthorpe, LA7 7DN Contact Number: 01539562006 Age Range: 10-17 yrs Local Education Authority: Cumbria Religious Character: None</p>	5.14 miles
	<p>Name: Oneschool Global UK Lancaster Campus Address: Melling Road, Lancaster, LA2 8LH Contact Number: 01524222159 Age Range: 7-18 yrs Local Education Authority: Lancashire Religious Character: Plymouth Brethren Christian Church</p>	5.49 miles
	<p>Name: Dallam School Address: Milnthorpe, LA7 7DD Contact Number: 01539565165 Age Range: 11-18 yrs Local Education Authority: Cumbria Religious Character: None</p>	5.72 miles

Disclaimer: The information represented in this section has been sourced from the Department of Education's 2019 results data and is based on the property's postcode.



Percentage of pupils achieving 5+ A*-C/9-4 or equivalents including 9-4 in both English and mathematics GCSEs

	Name	2019	2018	2017	2016
4	Carnforth High School	54.0 %	N/A	N/A	N/A
	Bleasdale School	N/A	N/A	N/A	N/A
	Wings School	N/A	0.0 %	N/A	0.0 %
	Oneschool Global Uk Lancaster Campus	92.0 %	89.0 %	100.0 %	75.0 %
	Dallam School	72.0 %	68.0 %	74.0 %	67.0 %
	Lancashire	66.0 %	66.1 %	61.7 %	58.5 %
	National	60.0 %	59.4 %	56.6 %	53.5 %

Disclaimer: The information represented in this section has been sourced from the Department of Education's 2017 results data set and is based on the property's postcode.

Average number of GCSE entries per pupil

	Name	Number
4	Carnforth High School	8.1
	Bleasdale School	N/A
	Wings School	N/A
	Oneschool Global Uk Lancaster Campus	7.2
	Dallam School	7.6
	Lancashire	7.5
	National	7.1

Disclaimer: The information represented in this section has been sourced from the Department of Education's 2019 results data set and is based on the property's postcode.



	Key Stage 5 - Information	Approx Distance
	<p>Name: Oneschool Global Uk Lancaster Campus Address: Melling Road, Lancaster, LA2 8LH Contact Number: 01524222159 Age Range: 7-18 yrs Local Education Authority: Lancashire Religious Character: Plymouth Brethren Christian Church</p>	5.49 miles
	<p>Name: Dallam School Address: Milnthorpe, LA7 7DD Contact Number: 01539565165 Age Range: 11-18 yrs Local Education Authority: Cumbria Religious Character: None</p>	5.72 miles
	<p>Name: Morecambe Community High School Address: Dallam Avenue, Morecambe, LA4 5BG Contact Number: 01524410207 Age Range: 11-18 yrs Local Education Authority: Lancashire Religious Character: Does not apply</p>	5.99 miles
	<p>Name: Lancaster and Morecambe College Address: Morecambe Road, Lancaster, LA1 2TY Contact Number: 0152466215 Age Range: 16+ yrs Local Education Authority: Lancashire Religious Character: Does not apply Admission Policy: Not applicable</p>	6.28 miles
	<p>Name: Central Lancaster High School Address: Crag Road, Lancaster, LA1 3LS Contact Number: 0152432636 Age Range: 11-16 yrs Local Education Authority: Lancashire Religious Character: Does not apply</p>	6.33 miles

Disclaimer: The information represented in this section has been sourced from the Department of Education's 2019 results data s and is based on the property's postcode.



Percentage of A level students achieving at least three levels at grades AAB or better, at least two of which are in facilitating subjects

	Name	%
5	Oneschool Global Uk Lancaster Campus	N/A
	Dallam School	21.9 %
	Morecambe Community High School	6.1 %
	Lancaster and Morecambe College	N/A
	Central Lancaster High School	N/A
	Lancashire	15.1 %
	National	16.5 %

Disclaimer: The information represented in this section has been sourced from the Department of Education's 2019 results data set and is based on the property's postcode.

As well as actual pupil performance in tests and exams, an important Key Performance Indicator is that of Value Added. When pupils start a school, they all have varying levels of ability and social advantage. A school's Value Added score measures how much progress they have made from the beginning to the end of their compulsory secondary education (i.e. between the end of Key Stage 2 and the end of Key Stage 4). It is a quick measurement of the effect of a school on its pupils.

	Name	Value Added
5	Oneschool Global Uk Lancaster Campus	0.1
	Dallam School	0.1
	Morecambe Community High School	-0.5
	Lancaster and Morecambe College	N/A
	Central Lancaster High School	N/A



Farrell Heyworth 18 New Street, Lancaster, LA1 1EG 01524 736777



Everything you want
to know about
local health services





How local are the health services?

We all want good access to local health facilities, wherever we live. To see how well **Borwick Close** is served, we have set out below the exact locations of hospitals, Accident & Emergency centres, GPs, pharmacies, dentists, out-of-hours medical care and walk-in clinics. Where it's available, you will find more detailed information, including the names of practitioners and their contact details.

	Hospitals	Approx Distance
	Royal Lancaster Infirmary, Ashton Road, Lancaster, Lancashire, LA1 4RP	7.25 miles
	Westmorland General Hospital, Kendal, LA9 7RG	11.17 miles
	Furness General Hospital, Dalton Lane, Barrow-In-Furness, Cumbria, LA14 4LF	17.97 miles
	Royal Preston Hospital, Sharoe Green Lane North, Preston, Lancashire, PR2 9HT	24.59 miles
	Blackpool Victoria Hospital, Whinney Heys Road, Blackpool, Lancashire, FY3 8NR	24.68 miles
	A&E	Approx Distance
	Royal Lancaster Infirmary, Ashton Road, Lancaster, Lancashire, LA1 4RP	7.25 miles
	Furness General Hospital, Dalton Lane, Barrow-In-Furness, Cumbria, LA14 4LF	17.97 miles
	Royal Preston Hospital, Sharoe Green Lane North, Preston, Lancashire, PR2 9HT	24.59 miles
	Blackpool Victoria Hospital, Whinney Heys Road, Blackpool, Lancashire, FY3 8NR	24.68 miles
	Royal Blackburn Hospital, Haslingden Road, Blackburn, Lancashire, BB2 3HH	30.73 miles

	Walk-in Clinics	Approx Distance
	Same Day Health Centre – Morecambe, Same Day Health Centre, Morecambe, Lancashire, LA4 5LY	6.36 miles
	Westmorland General Hospital, Kendal, LA9 7RG	11.17 miles
	Same Day Health Centre – Fleetwood, Same Day Health Centre, Fleetwood, Lancashire, FY7 6HP	18.47 miles
	Blackpool Victoria Hospital, Whinney Heys Road, Blackpool, Lancashire, FY3 8NR	24.68 miles
	Blackpool Nhs Walk-in Centre, Whitegate Health Centre, Blackpool, Lancashire, FY3 9ES	25.48 miles
	GPs	Approx Distance
	ASH TREES SURGERY, ASH TREES SURGERY, LANCASHIRE, LA5 9JU	1.16 miles
	ARNSIDE SURGERY, THE SURGERY, LANCASHIRE, LA5 0DP	4.68 miles
	STONELEIGH SURGERY, STONELEIGH SURGERY, CUMBRIA, LA7 7PW	5.63 miles
	PARK VIEW SURGERY, PARK VIEW SURGERY, CUMBRIA, LA7 7PS	5.65 miles
	OWEN ROAD SURGERY, 67 OWEN ROAD, LANCASHIRE, LA1 2LG	6.16 miles
	Dental Surgeons	Approx Distance
	Lancaster Dental Clinic, 8 Aldrens Lane, LANCASTER, Lancashire, LA1 2DU	6.13 miles
	3a Dental Care, 3 Great John Street, LANCASTER, Lancashire, LA1 1NQ	6.84 miles
	Bay Dental Partnership, 6 New Street, LANCASTER, Lancashire, LA1 1EG	6.85 miles
	Marketgate Dental Practice, Marketgate Shopping Centre, LANCASTER, Lancashire, LA1 1JF	6.91 miles
	Brock Street Dental Practice, 8 Brock Street, LANCASTER, Lancashire, LA1 1UU	6.95 miles

Disclaimer: The information represented in this section has been sourced from Experian and is based on the property's postcode.



Farrell Heyworth 18 New Street, Lancaster, LA1 1EG **01524 736777**



Everything you want
to know about
local policing





Understanding who polices your neighbourhood

When you move to a new area, you want to know the arrangements for local community policing. See below for essential information about police services near to **Borwick Close**. We have included location and contact details for the police station and wherever possible, details of police officers assigned to the area.

Your policing neighbourhood

The name of your policing neighbourhood is **Warton (Carnforth)** and it has a population of **2360**.

Your Local Policing Team

Name	Rank	Tel No.	E-mail
Paul Shepherd	PCSO		
Sarah Leverton	PCSO		
Robert Barnsley	Constable		
Richard Barr	Constable		

Disclaimer: The information represented in this section has been sourced from data.police.uk.

Locations of Interest

Morecambe Police Station
station
Poulton Square Morecambe

Morecambe Police Station is open 09:00 to 17:00 Monday to Friday, Closed Saturday and Sunday

Disclaimer: The information represented in this section has been sourced from data.police.uk.



Farrell Heyworth 18 New Street, Lancaster, LA1 1EG **01524 736777**

