



Everything you need to know about:

Park Road,
Barrow In Furness,
LA14 4QS



Introduction



The Property



Local Authority



Transport Links

Education



Health



Local Policing





An invaluable insight into your new home

This i-PACK brochure offers an informed overview of **Park Road** as a potential new home, along with essential material about its surrounding area and its local community. It provides a valuable insight for any prospective owner or tenant.

We wanted to provide you with information that you can absorb quickly, so we have presented it as visually as possible, making use of maps, icons, tables, graphs and charts. Overall, the brochure contains information about:

- **The Property** - including property details, floor plans, room details, photographs and Energy Performance Certificate.
- **Transport** - including locations of bus and coach stops, railway stations and ferry ports.
- **Health** - including locations, contact details and organisational information on the nearest GPs, pharmacies, hospitals and dentists.
- **Local Policing** - including locations, contact details and information about local community policing and the nearest police station, as well as police officers assigned to the area.
- **Education** - including locations of infant, primary and secondary schools and Key Performance Indicators (KPIs) for each key stage.



Farrell Heyworth 76 Cavendish Street, Barrow In Furness, LA14 1PZ **01229 839090**



PARK ROAD, BARROW IN FURNESS £325,000



x2
Bedrooms



x2
Living Rooms



x2
Bathrooms

Where you are

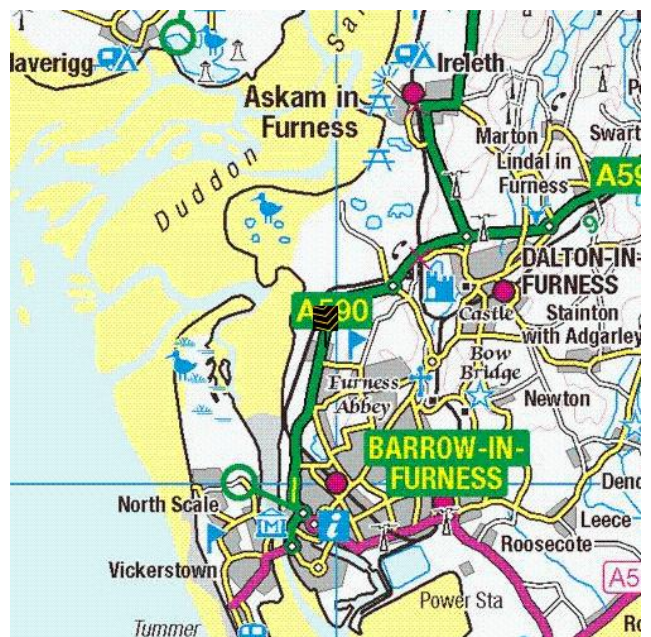
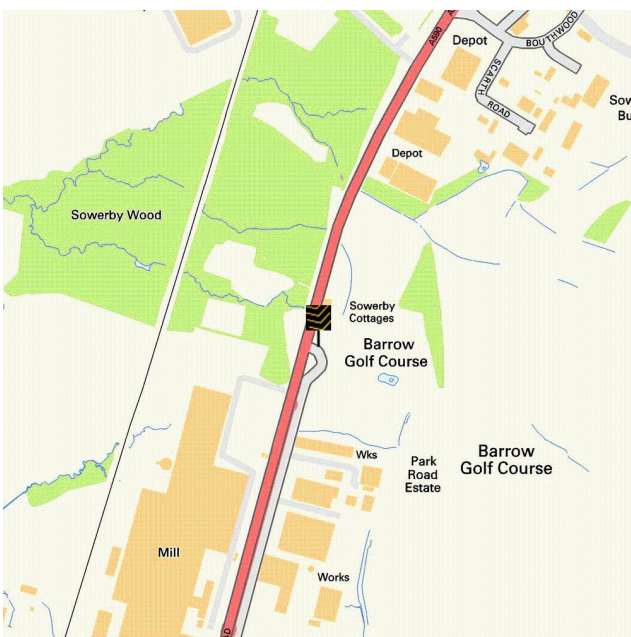



Rear view 3

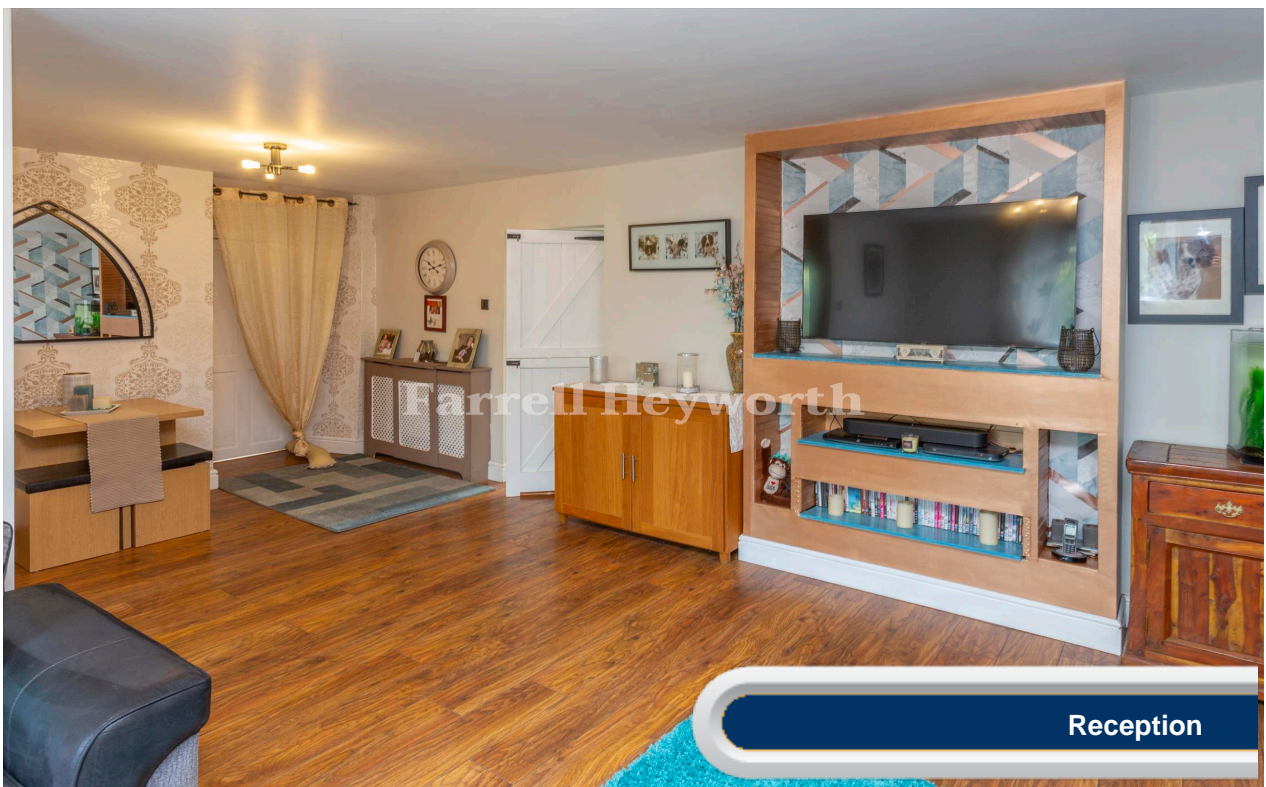

Reception





Reception view 2



Kitchen view 3







Everything you want
to know about
local authorities





Get to know your local authorities

Local government directly affects quality of life, particularly when it comes to council tax, planning, waste disposal and the impact of local policies. You may want to investigate how this is likely to affect you if you decide to move. There are nearly 400 local authorities in England, with five different types of local government structure. These can be broadly divided into **single-tier** and **two-tier authorities**. Single-tier authorities are **Metropolitan Authorities, London Boroughs** and **Unitary or Shire Authorities**. Two-tier authorities have both a **County Council**, and a **District Council or City Council**. There are also around 10,000 parish and town councils, effectively creating an additional tier in some areas - mostly, but not exclusively, in rural areas. The National Association of Local Councils (NALC) represents and works on behalf of these community councils and is a useful contact point.

The local authority locations and contact details for **Park Road** are:

Shire / County / District	Website	Address	Contact details
---------------------------	---------	---------	-----------------

Disclaimer: The information displayed above has been obtained using the property's postcode in proximity to its local authority. It is recommended that this information is independently verified.



Everything you want
to know about
transport links







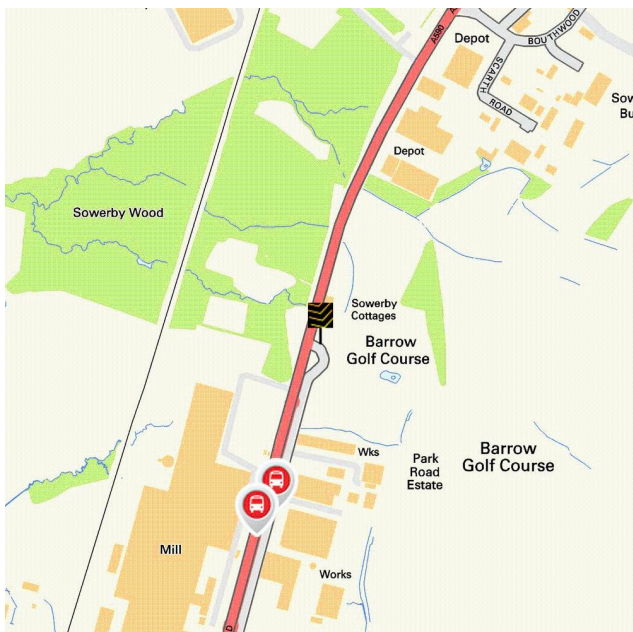

Become familiar with public transport links

Being able to choose to travel by public transport is important for many reasons. It helps to reduce congestion, provides access to work and education, and facilitates use of health and leisure facilities. If you or your family members travel abroad, access to the nearest ferry terminals is also likely to be a significant factor in choosing a new property. Using the maps below, you can pinpoint the precise locations of transport links for **Park Road**. Tables for each type of transport indicate the property's distance from the nearest bus stops, railway stations, coach stops and ferry terminals (providing that these facilities are within the scale proximity of the maps.)

Transport Links





	Airports	Approx Distance
	Blackpool International Airport	26.62 miles
	Ferry ports	Approx Distance
	Roa Island Ferry Landing	5.58 miles
	Piel Island Ferry Landing	6.18 miles
	Lake Bank (Coniston) Ferry Landing	11.92 miles
	Water Park (Coniston) Ferry Landing	12.28 miles
	Sunny Bank (Coniston) Ferry Landing	13.23 miles
	Train Stations	Approx Distance
	Barrow-in-Furness Rail Station	1.97 miles
	Dalton Rail Station	2.09 miles
	Roose Rail Station	2.64 miles
	Askam Rail Station	3.04 miles
	Millom Rail Station	4.69 miles

Disclaimer: The information represented in this section has been sourced from the Department of Transport's Open Data and is based on the property's postcode. It is recommended that this information is independently verified.



Farrell Heyworth 76 Cavendish Street, Barrow In Furness, LA14 1PZ **01229 839090**

	Bus Stops	Approx Distance
	Kimberly Clark	0.16 miles
	Kimberly Clark	0.19 miles
	Top of Sowerby Avenue (E bound)	0.46 miles
	Top of Sowerby Avenue (W bound)	0.47 miles
	Sikemeadow (N bound)	0.5 miles
	Coach Stops	Approx Distance
	Dalton in Furness: Tudor Square Coach Stop	2.21 miles
	Barrow-in-Furness: Cornwallis St Coach Stop	2.45 miles
	Ulverston: Victoria Rd Bus Terminus	6.33 miles
	Newby Bridge: Hotel Coach Stop	13.3 miles
	Grange-over-Sands: Rail Station Coach Stop	13.61 miles

Disclaimer: The information represented in this section has been sourced from the Department of Transport's Open Data and is based on the property's postcode. It is recommended that this information is independently verified.



Farrell Heyworth 76 Cavendish Street, Barrow In Furness, LA14 1PZ **01229 839090**



Everything you want
to know about
local schools





How are local schools performing?

If schools are important to you, then this section sets out the published Key Performance Indicators for schools near to your prospective new home. Key Performance Indicators look primarily at how well pupils perform in their tests and examinations, as well as some other measures like attendance.

If you want to know more about a particular school or college, you can also visit the Ofsted website <http://www.ofsted.gov.uk/inspection-reports/find-inspection-report>

Local Schools

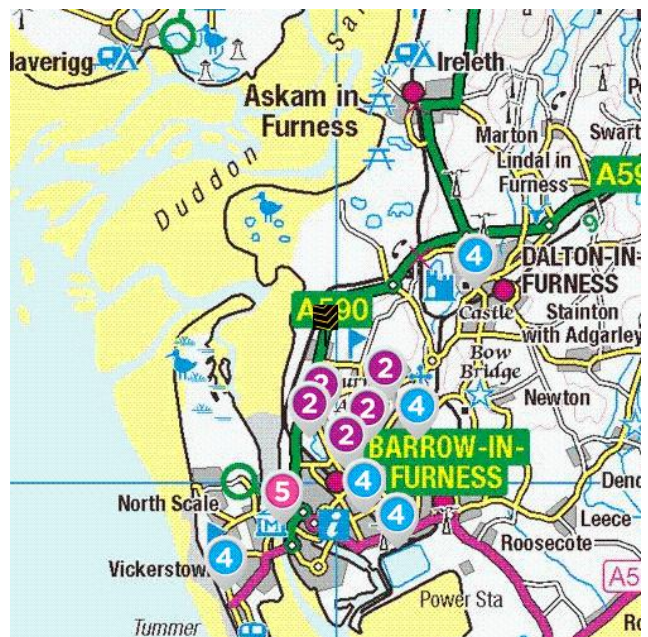
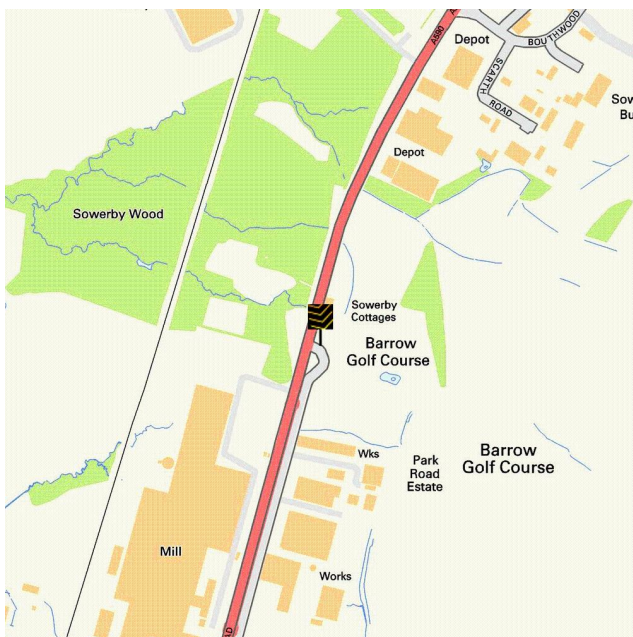

The next page shows tables and charts divided into Key Stages and a list of respective schools local to **Park Road**. There are four main age-related Key Stages defined as:



Special schools are marked with this icon

Key Stage	Definition
Key Stage 1	Fits broadly with the first stage of education, i.e. ages 5-7.
Key Stage 2	Fits the later stage of primary education, often known as junior schools, i.e. ages 8-11. This takes pupils up to the standardised break at age 11 after which pupils generally change schools and transfer to secondary education.
Key Stage 3	Secondary education split between key stages 3 and 4, with key stage 3 covering ages 11-13.
Key Stage 4	Key Stage 4 (ages 14-16) covers the two year period of study for GCSE level examinations.
Key Stage 5	Beyond key stage 4 is 16+ or Sixth Form provision, sometimes unofficially referred to as Key Stage 5.



Farrell Heyworth 76 Cavendish Street, Barrow In Furness, LA14 1PZ **01229 839090**

	Key Stage 2 - Information	Approx Distance
	<p>Name: Ormsgill Nursery and Primary School Address: Mill Bank, Barrow-in-Furness, LA14 4AR Contact Number: 01229830431 Age Range: 3-11 yrs Local Education Authority: Cumbria Religious Character: Does not apply</p>	0.8 miles
	<p>Name: Dane Ghyll School Address: Skelwith Drive, Barrow-in-Furness, LA14 4PG Contact Number: 01229830201 Age Range: 4-11 yrs Local Education Authority: Cumbria Religious Character: Does not apply</p>	0.94 miles
	<p>Name: St Pius X Catholic Primary School Address: Schneider Road, Barrow-in-Furness, LA14 4AA Contact Number: 01229828406 Age Range: 4-11 yrs Local Education Authority: Cumbria Religious Character: Roman Catholic</p>	1.06 miles
	<p>Name: St Paul's CofE Junior School Address: Hawcoat Lane, Barrow-in-Furness, LA14 4HF Contact Number: 01229822211 Age Range: 7-11 yrs Local Education Authority: Cumbria Religious Character: Church of England</p>	1.21 miles
	<p>Name: Victoria Academy Address: Devonshire Road, Barrow-in-Furness, LA14 5NE Contact Number: 01229894656 Age Range: 7-11 yrs Local Education Authority: Cumbria Religious Character: Does not apply</p>	1.45 miles

Disclaimer: The information represented in this section has been sourced from the Department of Education's 2019 results data s and is based on the property's postcode.



Reading, Writing and Maths

	Name	Expected	Higher
2	Ormsgill Nursery and Primary School	52.0 %	0.0 %
	Dane Ghyll School	73.0 %	9.0 %
	St Pius X Catholic Primary School	42.0 %	4.0 %
	St Paul's CofE Junior School	46.0 %	0.0 %
	Victoria Academy	87.0 %	13.0 %
	Cumbria	66.0 %	9.0 %
National	65.0 %	11.0 %	

Primary Progress Measures

As well as actual pupil performance in tests and exams an important Key Performance Indicator is that of progress measures that compare the actual achievements of other pupils nationally with similar prior attainment. Any increase in attainment achieved by each pupil will be reflected in the schools progress scores. They are fairer to schools in challenging circumstances, as they recognise a school that is doing a good job with an intake with poor prior attainment

Progress Measures for 2019

	Name	Math	Reading	Writing
2	Ormsgill Nursery and Primary School	-0.5 %	-1.0 %	1.4 %
	Dane Ghyll School	-0.5 %	4.6 %	0.8 %
	St Pius X Catholic Primary School	-2.1 %	-1.1 %	-2.9 %
	St Paul's CofE Junior School	-2.3 %	-1.3 %	-0.3 %
	Victoria Academy	2.8 %	2.4 %	3.1 %

Disclaimer: The information represented in this section has been sourced from the Department of Education's 2019 results data set and is based on the property's postcode.



Farrell Heyworth 76 Cavendish Street, Barrow In Furness, LA14 1PZ 01229 839090

	Key Stage 4 - Information	Approx Distance
4	<p>Name: St Bernard's Catholic High School Address: Rating Lane, Barrow-in-Furness, LA13 9LE Contact Number: 01229814560 Age Range: 11-16 yrs Local Education Authority: Cumbria Religious Character: Roman Catholic</p>	1.55 miles
	<p>Name: Dowdales School Address: Dalton-in-Furness, LA15 8AH Contact Number: 01229469800 Age Range: 11-16 yrs Local Education Authority: Cumbria Religious Character: Does not apply</p>	1.99 miles
	<p>Name: Furness Academy Address: Park Drive, Barrow-in-Furness, LA13 9BB Contact Number: 01229484270 Age Range: 11-16 yrs Local Education Authority: Cumbria Religious Character: Does not apply</p>	2.03 miles
	<p>Name: Moorfield Learning Centre Address: Moorfield Street, Barrow-in-Furness, LA13 9RS Contact Number: 01229837258 Age Range: 11-17 yrs Local Education Authority: Cumbria Religious Character: None</p>	2.54 miles
	<p>Name: Walney School Address: Sandy Gap Lane, Barrow-in-Furness, LA14 3JT Contact Number: 01229471528 Age Range: 11-16 yrs Local Education Authority: Cumbria Religious Character: None</p>	3.17 miles

Disclaimer: The information represented in this section has been sourced from the Department of Education's 2019 results data s and is based on the property's postcode.



Farrell Heyworth 76 Cavendish Street, Barrow In Furness, LA14 1PZ 01229 839090

Percentage of pupils achieving 5+ A*-C/9-4 or equivalents including 9-4 in both English and mathematics GCSEs

	Name	2019	2018	2017	2016
4	St Bernard's Catholic High School	62.0 %	67.0 %	72.0 %	58.0 %
	Dowdales School	63.0 %	68.0 %	64.0 %	64.0 %
	Furness Academy	46.0 %	50.0 %	47.0 %	38.0 %
	Moorfield Learning Centre	N/A	N/A	N/A	N/A
	Walney School	54.0 %	50.0 %	44.0 %	34.0 %
	Cumbria	64.0 %	65.3 %	62.8 %	56.7 %
	National	60.0 %	59.4 %	56.6 %	53.5 %

Disclaimer: The information represented in this section has been sourced from the Department of Education's 2017 results data set and is based on the property's postcode.

Average number of GCSE entries per pupil

	Name	Number
4	St Bernard's Catholic High School	7.0
	Dowdales School	7.2
	Furness Academy	6.1
	Moorfield Learning Centre	N/A
	Walney School	6.3
	Cumbria	7.4
	National	7.1

Disclaimer: The information represented in this section has been sourced from the Department of Education's 2019 results data set and is based on the property's postcode.



	Key Stage 5 - Information	Approx Distance
	<p>Name: Furness College Address: Channelside, Barrow-in-Furness, LA14 2PJ Contact Number: 01229825017 Age Range: 16+ yrs Local Education Authority: Cumbria Religious Character: Does not apply Admission Policy: Not applicable</p>	2.2 miles
	<p>Name: Millom School Address: Salthouse Road, Millom, LA18 5AB Contact Number: 01229772300 Age Range: 11-18 yrs Local Education Authority: Cumbria Religious Character: Does not apply</p>	4.85 miles
	<p>Name: Ulverston Victoria High School Address: Springfield Road, Ulverston, LA12 0EB Contact Number: 01229483900 Age Range: 11-18 yrs Local Education Authority: Cumbria Religious Character: Does not apply</p>	6.14 miles
	<p>Name: Bay Leadership Academy Address: Limes Avenue, Morecambe, LA3 1HS Contact Number: 01524416830 Age Range: 11-18 yrs Local Education Authority: Lancashire Religious Character: Does not apply</p>	15.39 miles
	<p>Name: Morecambe Community High School Address: Dallam Avenue, Morecambe, LA4 5BG Contact Number: 01524410207 Age Range: 11-18 yrs Local Education Authority: Lancashire Religious Character: Does not apply</p>	16.13 miles

Disclaimer: The information represented in this section has been sourced from the Department of Education's 2019 results data s and is based on the property's postcode.



Percentage of A level students achieving at least three levels at grades AAB or better, at least two of which are in facilitating subjects

	Name	%
5	Furness College	8.3 %
	Millom School	20.0 %
	Ulverston Victoria High School	16.3 %
	Bay Leadership Academy	N/A
	Morecambe Community High School	6.1 %
	Cumbria	16.5 %
National	16.5 %	

Disclaimer: The information represented in this section has been sourced from the Department of Education's 2019 results data set and is based on the property's postcode.

As well as actual pupil performance in tests and exams, an important Key Performance Indicator is that of Value Added. When pupils start a school, they all have varying levels of ability and social advantage. A school's Value Added score measures how much progress they have made from the beginning to the end of their compulsory secondary education (i.e. between the end of Key Stage 2 and the end of Key Stage 4). It is a quick measurement of the effect of a school on its pupils.

	Name	Value Added
5	Furness College	-0.2
	Millom School	-0.3
	Ulverston Victoria High School	-0.2
	Bay Leadership Academy	-0.5
	Morecambe Community High School	-0.5



Farrell Heyworth 76 Cavendish Street, Barrow In Furness, LA14 1PZ **01229 839090**





Everything you want
to know about
local health services





How local are the health services?

We all want good access to local health facilities, wherever we live. To see how well **Park Road** is served, we have set out below the exact locations of hospitals, Accident & Emergency centres, GPs, pharmacies, dentists, out-of-hours medical care and walk-in clinics. Where it's available, you will find more detailed information, including the names of practitioners and their contact details.

Hospitals	Approx Distance
	Furness General Hospital, Dalton Lane, Barrow-In-Furness, Cumbria, LA14 4LF
	Royal Lancaster Infirmary, Ashton Road, Lancaster, Lancashire, LA1 4RP
	Westmorland General Hospital, Kendal, LA9 7RG
	Blackpool Victoria Hospital, Whinney Heys Road, Blackpool, Lancashire, FY3 8NR
	West Cumberland Hospital, Homewood, Whitehaven, CA28 8JG
A&E	Approx Distance
	Furness General Hospital, Dalton Lane, Barrow-In-Furness, Cumbria, LA14 4LF
	Royal Lancaster Infirmary, Ashton Road, Lancaster, Lancashire, LA1 4RP
	Blackpool Victoria Hospital, Whinney Heys Road, Blackpool, Lancashire, FY3 8NR
	West Cumberland Hospital, Homewood, Whitehaven, CA28 8JG
	Royal Preston Hospital, Sharoe Green Lane North, Preston, Lancashire, PR2 9HT

	Walk-in Clinics	Approx Distance
	Same Day Health Centre – Morecambe, Same Day Health Centre, Morecambe, Lancashire, LA4 5LY	15.83 miles
	Same Day Health Centre – Fleetwood, Same Day Health Centre, Fleetwood, Lancashire, FY7 6HP	17.98 miles
	Westmorland General Hospital, Kendal, LA9 7RG	22.87 miles
	Blackpool Victoria Hospital, Whinney Heys Road, Blackpool, Lancashire, FY3 8NR	24.16 miles
	Blackpool Nhs Walk-in Centre, Whitegate Health Centre, Blackpool, Lancashire, FY3 9ES	24.42 miles
	GPs	Approx Distance
	ABBEY ROAD SURGERY, 243 ABBEY ROAD, LA14 5JY	1.7 miles
	NORWOOD MEDICAL CENTRE, NORWOOD MEDICAL CENTRE, CUMBRIA, LA14 5ES	1.97 miles
	NELSON STREET SURGERY, NELSON STREET SURGERY, CUMBRIA, LA15 8AF	2.04 miles
	DALTON SURGERY, THE SURGERY, CUMBRIA, LA15 8AB	2.09 miles
	THE FAMILY PRACTICE, THE SURGERY, CUMBRIA, LA14 5SL	2.12 miles
	Dental Surgeons	Approx Distance
	Lancaster Dental Clinic, 8 Aldrens Lane, LANCASTER, Lancashire, LA1 2DU	18.42 miles
	Mayo Dental Clinic, 3 Meeting House Lane, LANCASTER, Lancashire, LA1 1TJ	18.48 miles
	Central Dental Practice, Telephone House, LANCASTER, Lancashire, LA1 1AB	18.52 miles
	Mayo Dental Clinic, Dallas Road, LANCASTER, Lancashire, LA1 1TW	18.55 miles
	Bay Dental Partnership, 6 New Street, LANCASTER, Lancashire, LA1 1EG	18.58 miles

Disclaimer: The information represented in this section has been sourced from Experian and is based on the property's postcode.



Farrell Heyworth 76 Cavendish Street, Barrow In Furness, LA14 1PZ **01229 839090**



Everything you want
to know about
local policing





Understanding who polices your neighbourhood

When you move to a new area, you want to know the arrangements for local community policing. See below for essential information about police services near to **Park Road**. We have included location and contact details for the police station and wherever possible, details of police officers assigned to the area.

Your policing neighbourhood

The name of your policing neighbourhood is **Dalton** and it has a population of **0**.

Your Local Policing Team

Name	Rank	Tel No.	E-mail
Joanne Smith	Sergeant		
John Dilks	Sergeant		
Lydia Howard	PC		
Jo Smith	A/Inspector		
Gareth Sargent	PC		

Disclaimer: The information represented in this section has been sourced from data.police.uk.

Disclaimer: The information represented in this section has been sourced from data.police.uk.



Farrell Heyworth 76 Cavendish Street, Barrow, In Furness, LA14 1PZ **01229 839090**

