



Everything you need to know about:

**Beanthwaite,
Kirkby In Furness,
LA17 7XT**



Introduction



The Property



Local Authority



Transport Links

Education



Health



Local Policing





An invaluable insight into your new home

This i-PACK brochure offers an informed overview of **Beanthwaite** as a potential new home, along with essential material about its surrounding area and its local community. It provides a valuable insight for any prospective owner or tenant.

We wanted to provide you with information that you can absorb quickly, so we have presented it as visually as possible, making use of maps, icons, tables, graphs and charts. Overall, the brochure contains information about:

- **The Property** - including property details, floor plans, room details, photographs and Energy Performance Certificate.
- **Transport** - including locations of bus and coach stops, railway stations and ferry ports.
- **Health** - including locations, contact details and organisational information on the nearest GPs, pharmacies, hospitals and dentists.
- **Local Policing** - including locations, contact details and information about local community policing and the nearest police station, as well as police officers assigned to the area.
- **Education** - including locations of infant, primary and secondary schools and Key Performance Indicators (KPIs) for each key stage.



Farrell Heyworth 76 Cavendish Street, Barrow In Furness, LA14 1PZ **01229 839090**



BEANTHWAITE, KIRKBY IN FURNESS £298,500



x2
Bedrooms



x2
Living Rooms



x1
Bathrooms

Where you are

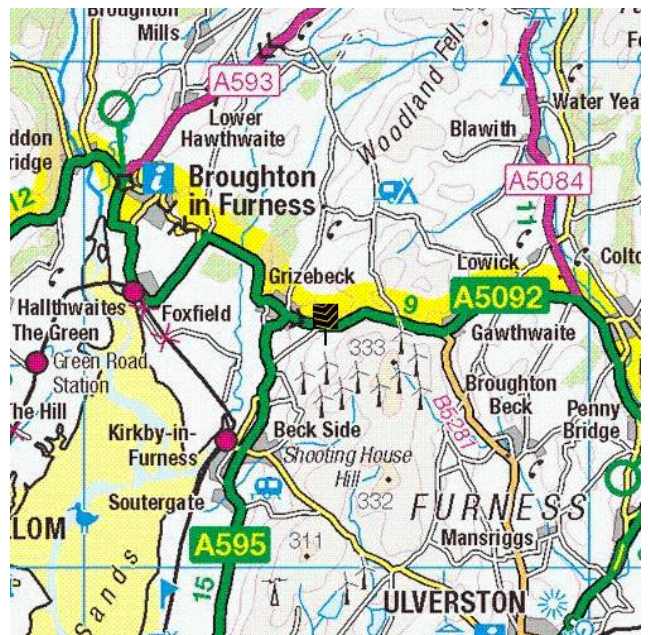
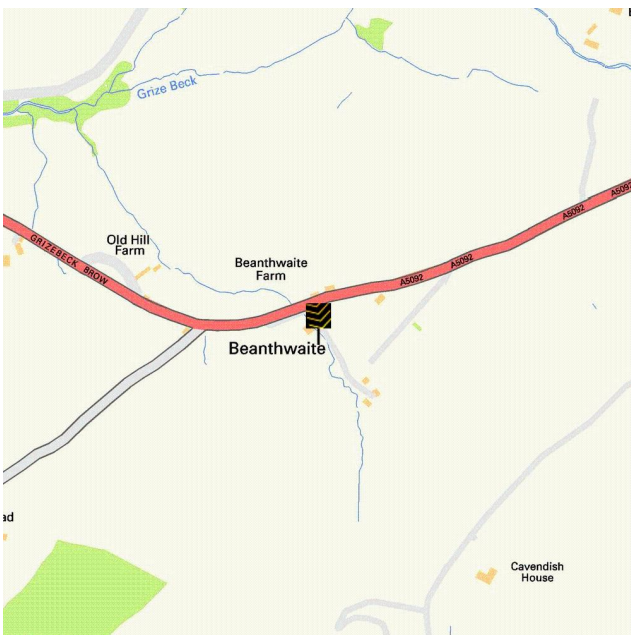





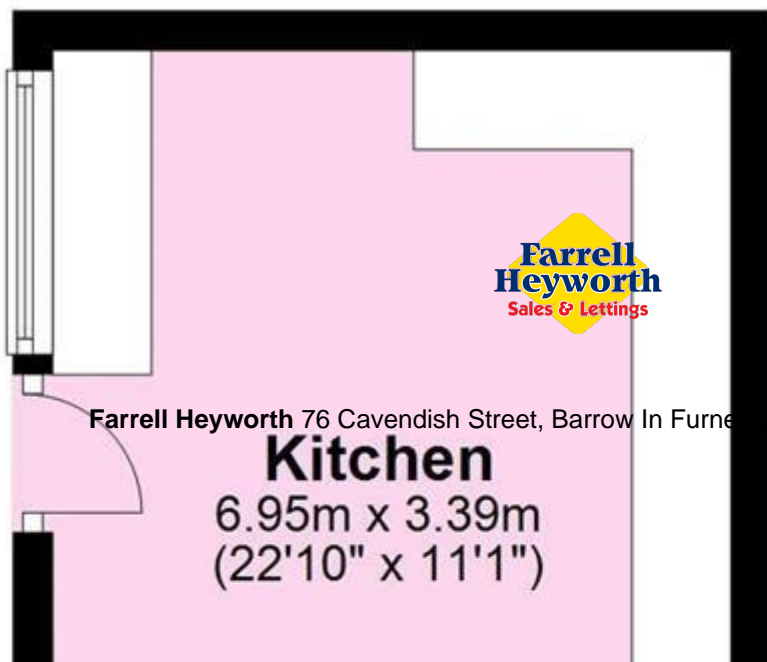

Farrell Heyworth 76 Cavendish Street, Barrow In Furness LA14 1PZ 01753 839090

Kitchen
6.95m x 3.39m
(22'10" x 11'1")



Lo
6.84m
(22'5")

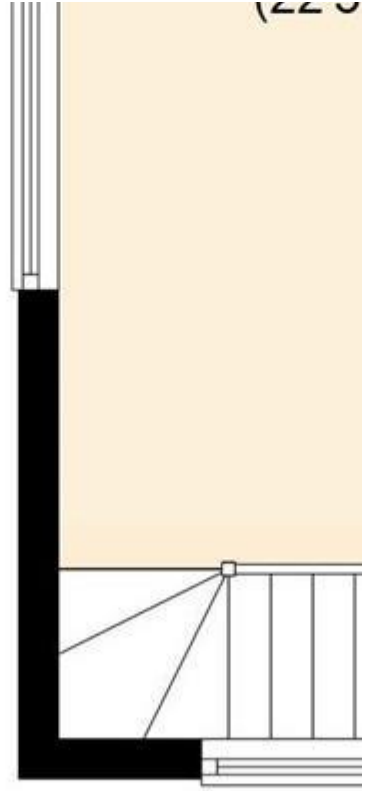
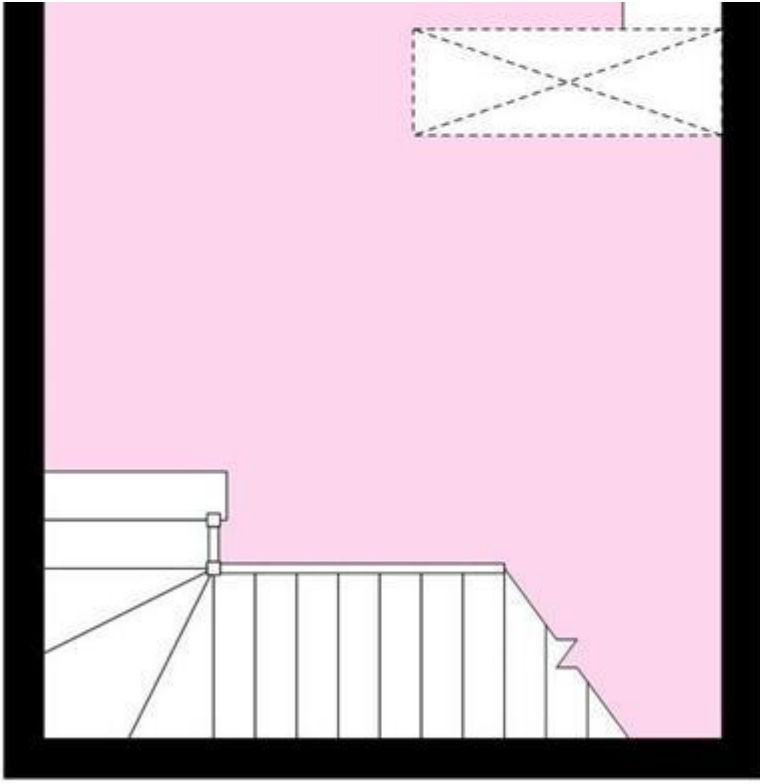

Basement



Get to know your local authorities

Local government directly affects quality of life, particularly when it comes to council tax, planning, waste disposal and the impact of local policies. You may want to investigate how this is likely to affect you if you decide to move. There are nearly 400 local authorities in England, with five different types of local government structure. These can be broadly divided into **single-tier** and **two-tier authorities**.

Single-tier authorities are **Metropolitan Authorities**, **London Boroughs** and **Unitary** or **Shire Authorities**.

Two-tier authorities have both a **County Council**, and a **District Council** or **City Council**.

There are also around 10,000 parish and town councils, effectively creating an additional tier in some areas - mostly, but not exclusively, in rural areas. The National Association of Local Councils (NALC) represents and works on behalf of these community councils and is a useful contact point.

The local authority locations and contact details for **Beanthwaite** are:

Shire / County / District	Website	Address	Contact details
---------------------------	---------	---------	-----------------

Disclaimer: The information displayed above has been obtained using the property's postcode in proximity to its local authority. It is recommended that this information is independently verified.

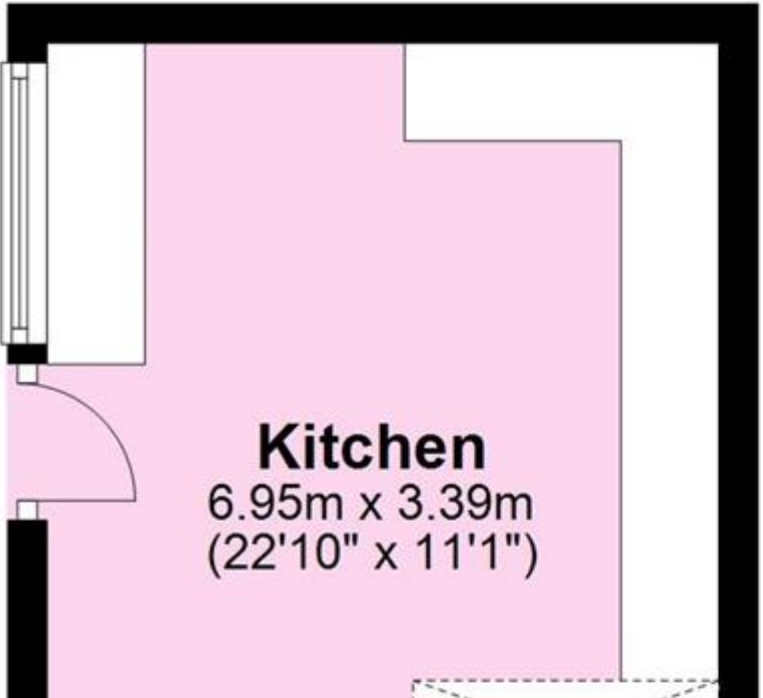



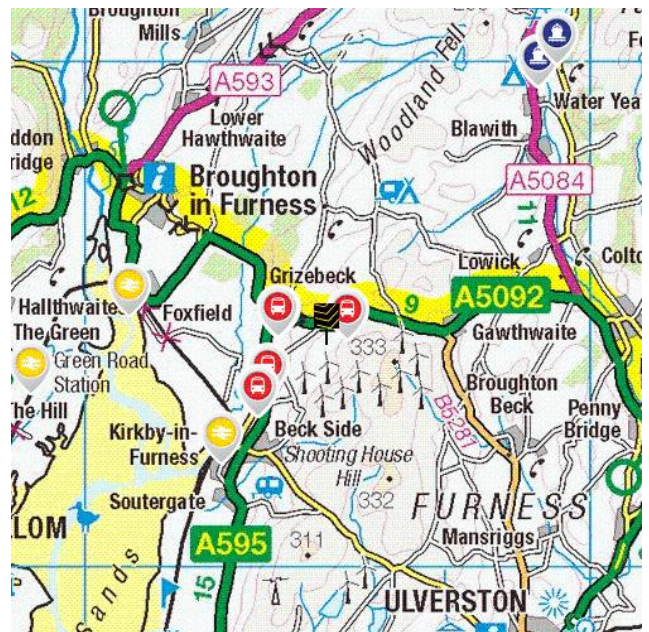
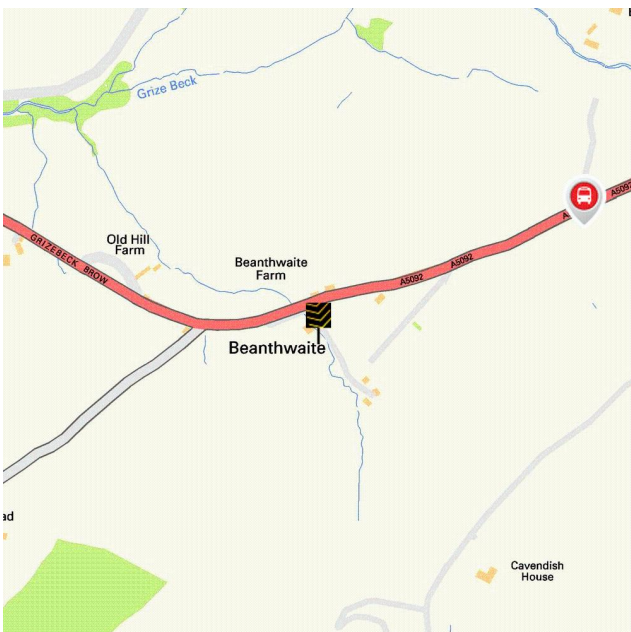

Become familiar with public transport links

Being able to choose to travel by public transport is important for many reasons. It helps to reduce congestion, provides access to work and education, and facilitates use of health and leisure facilities. If you or your family members travel abroad, access to the nearest ferry terminals is also likely to be a significant factor in choosing a new property. Using the maps below, you can pinpoint the precise locations of transport links for **Beanthwaite**. Tables for each type of transport indicate the property's distance from the nearest bus stops, railway stations, coach stops and ferry terminals (providing that these facilities are within the scale proximity of the maps.)





	Airports	Approx Distance
	Blackpool International Airport	33.14 miles
	Ferry ports	Approx Distance
	Lake Bank (Coniston) Ferry Landing	4.13 miles
	Water Park (Coniston) Ferry Landing	4.49 miles
	Sunny Bank (Coniston) Ferry Landing	5.37 miles
	Torver (Coniston) Ferry Landing	7.22 miles
	Brantwood (Coniston) Ferry Landing	7.86 miles
	Train Stations	Approx Distance
	Kirkby-in-Furness Rail Station	1.91 miles
	Foxfield Rail Station	2.46 miles
	Green Road Rail Station	3.67 miles
	Ulverston Rail Station	4.86 miles
	Askam Rail Station	4.86 miles

Disclaimer: The information represented in this section has been sourced from the Department of Transport's Open Data and is based on the property's postcode. It is recommended that this information is independently verified.



Farrell Heyworth 76 Cavendish Street, Barrow In Furness, LA14 1PZ **01229 839090**

	Bus Stops	Approx Distance
	Beckstones Farm road end	0.29 miles
	Mill Bridge	0.6 miles
	Service Station	0.61 miles
	Buckhorn Lane A595 junction	0.91 miles
	Marshside (S bound)	1.18 miles
	Coach Stops	Approx Distance
	Ulverston: Victoria Rd Bus Terminus	4.8 miles
	Dalton in Furness: Tudor Square Coach Stop	6.68 miles
	Newby Bridge: Hotel Coach Stop	7.4 miles
	Barrow-in-Furness: Cornwallis St Coach Stop	10.2 miles
	Grange-over-Sands: Rail Station Coach Stop	10.95 miles

Disclaimer: The information represented in this section has been sourced from the Department of Transport's Open Data and is based on the property's postcode. It is recommended that this information is independently verified.



Farrell Heyworth 76 Cavendish Street, Barrow In Furness, LA14 1PZ **01229 839090**



Everything you want
to know about
local schools





How are local schools performing?

If schools are important to you, then this section sets out the published Key Performance Indicators for schools near to your prospective new home. Key Performance Indicators look primarily at how well pupils perform in their tests and examinations, as well as some other measures like attendance.

If you want to know more about a particular school or college, you can also visit the Ofsted website <http://www.ofsted.gov.uk/inspection-reports/find-inspection-report>

Local Schools

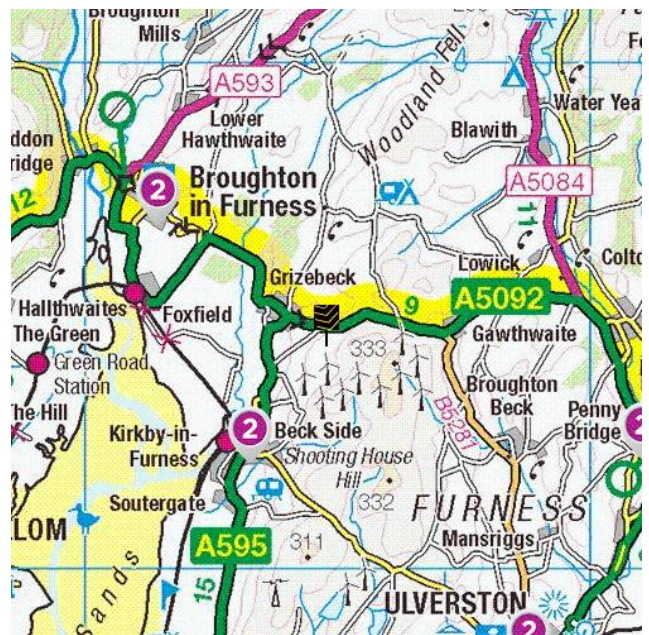
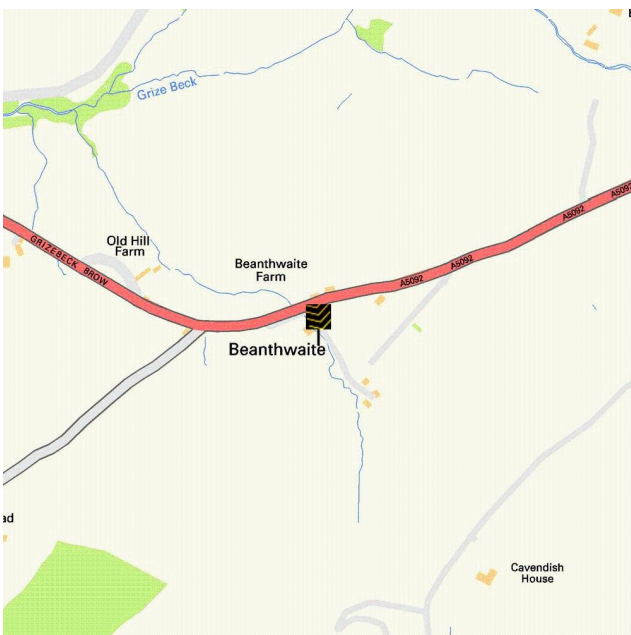

The next page shows tables and charts divided into Key Stages and a list of respective schools local to **Beanthwaite**. There are four main age-related Key Stages defined as:



Special schools are marked with this icon

Key Stage	Definition
Key Stage 1	Fits broadly with the first stage of education, i.e. ages 5-7.
Key Stage 2	Fits the later stage of primary education, often known as junior schools, i.e. ages 8-11. This takes pupils up to the standardised break at age 11 after which pupils generally change schools and transfer to secondary education.
Key Stage 3	Secondary education split between key stages 3 and 4, with key stage 3 covering ages 11-13.
Key Stage 4	Key Stage 4 (ages 14-16) covers the two year period of study for GCSE level examinations.
Key Stage 5	Beyond key stage 4 is 16+ or Sixth Form provision, sometimes unofficially referred to as Key Stage 5.



Farrell Heyworth 76 Cavendish Street, Barrow In Furness, LA14 1PZ **01229 839090**

	Key Stage 2 - Information	Approx Distance
	<p>Name: Burlington CofE School Address: School Road, Kirkby-in-Furness, LA17 7UH Contact Number: 01229889210 Age Range: 3-11 yrs Local Education Authority: Cumbria Religious Character: Church of England</p>	1.63 miles
	<p>Name: Broughton CofE Primary and Nursery School Address: Kepplewray, Broughton-in-Furness, LA20 6BJ Contact Number: 01229716206 Age Range: 2-11 yrs Local Education Authority: Cumbria Religious Character: Church of England</p>	2.61 miles
	<p>Name: Penny Bridge CofE School Address: Greenodd, Ulverston, LA12 7RQ Contact Number: 01229861307 Age Range: 4-11 yrs Local Education Authority: Cumbria Religious Character: Church of England</p>	4.08 miles
	<p>Name: Thwaites School Address: Hallthwaites, Millom, LA18 5HP Contact Number: 01229772554 Age Range: 3-11 yrs Local Education Authority: Cumbria Religious Character: Does not apply</p>	4.16 miles
	<p>Name: Church Walk CofE Primary School Address: Church Walk, Ulverston, LA12 7EN Contact Number: 01229587258 Age Range: 4-11 yrs Local Education Authority: Cumbria Religious Character: Church of England</p>	4.57 miles

Disclaimer: The information represented in this section has been sourced from the Department of Education's 2019 results data s and is based on the property's postcode.



Reading, Writing and Maths

	Name	Expected	Higher
2	Burlington CofE School	86.0 %	0.0 %
	Broughton CofE Primary and Nursery School	67.0 %	0.0 %
	Penny Bridge CofE School	94.0 %	17.0 %
	Thwaites School	N/A	N/A
	Church Walk CofE Primary School	71.0 %	14.0 %
	Cumbria	66.0 %	9.0 %
National	65.0 %	11.0 %	

Primary Progress Measures

As well as actual pupil performance in tests and exams an important Key Performance Indicator is that of progress measures that compare the actual achievements of other pupils nationally with similar prior attainment. Any increase in attainment achieved by each pupil will be reflected in the schools progress scores. They are fairer to schools in challenging circumstances, as they recognise a school that is doing a good job with an intake with poor prior attainment



Progress Measures for 2019

	Name	Math	Reading	Writing
2	Burlington CofE School	-1.5 %	-1.1 %	-0.7 %
	Broughton CofE Primary and Nursery School	-5.6 %	1.7 %	2.2 %
	Penny Bridge CofE School	0.7 %	2.7 %	1.3 %
	Thwaites School	N/A	N/A	N/A
	Church Walk CofE Primary School	-1.8 %	0.4 %	1.7 %

Disclaimer: The information represented in this section has been sourced from the Department of Education's 2019 results data set and is based on the property's postcode.



Farrell Heyworth 76 Cavendish Street, Barrow In Furness, LA14 1PZ 01229 839090

	Key Stage 4 - Information	Approx Distance
	<p>Name: Ulverston Victoria High School Address: Springfield Road, Ulverston, LA12 0EB Contact Number: 01229483900 Age Range: 11-18 yrs Local Education Authority: Cumbria Religious Character: Does not apply</p>	5.12 miles
	<p>Name: Millom School Address: Salthouse Road, Millom, LA18 5AB Contact Number: 01229772300 Age Range: 11-18 yrs Local Education Authority: Cumbria Religious Character: Does not apply</p>	5.34 miles
	<p> Name: Sandside Lodge School Address: Sandside Road, Ulverston, LA12 9EF Contact Number: 01229588825 Age Range: 2-19 yrs Local Education Authority: Cumbria Religious Character: Does not apply</p>	5.6 miles
	<p>Name: Dowdales School Address: Dalton-in-Furness, LA15 8AH Contact Number: 01229469800 Age Range: 11-16 yrs Local Education Authority: Cumbria Religious Character: Does not apply</p>	6.6 miles
	<p>Name: John Ruskin School Address: Lake Road, Coniston, LA21 8EW Contact Number: 01539441306 Age Range: 11-16 yrs Local Education Authority: Cumbria Religious Character: Does not apply</p>	8.52 miles

Disclaimer: The information represented in this section has been sourced from the Department of Education's 2019 results data s and is based on the property's postcode.



Percentage of pupils achieving 5+ A*-C/9-4 or equivalents including 9-4 in both English and mathematics GCSEs

	Name	2019	2018	2017	2016
4	Ulverston Victoria High School	74.0 %	73.0 %	75.0 %	73.0 %
	Millom School	55.0 %	52.0 %	67.0 %	60.0 %
	Sandside Lodge School	N/A	N/A	N/A	N/A
	Dowdales School	63.0 %	68.0 %	64.0 %	64.0 %
	John Ruskin School	68.0 %	65.0 %	75.0 %	37.0 %
	Cumbria	64.0 %	65.3 %	62.8 %	56.7 %
	National	60.0 %	59.4 %	56.6 %	53.5 %

Disclaimer: The information represented in this section has been sourced from the Department of Education's 2017 results data set and is based on the property's postcode.

Average number of GCSE entries per pupil

	Name	Number
4	Ulverston Victoria High School	7.1
	Millom School	6.7
	Sandside Lodge School	N/A
	Dowdales School	7.2
	John Ruskin School	9.3
	Cumbria	7.4
	National	7.1

Disclaimer: The information represented in this section has been sourced from the Department of Education's 2019 results data set and is based on the property's postcode.



	Key Stage 5 - Information	Approx Distance
	<p>Name: Ulverston Victoria High School Address: Springfield Road, Ulverston, LA12 0EB Contact Number: 01229483900 Age Range: 11-18 yrs Local Education Authority: Cumbria Religious Character: Does not apply</p>	5.12 miles
	<p>Name: Millom School Address: Salthouse Road, Millom, LA18 5AB Contact Number: 01229772300 Age Range: 11-18 yrs Local Education Authority: Cumbria Religious Character: Does not apply</p>	5.34 miles
	<p>Name: Furness College Address: Channelside, Barrow-in-Furness, LA14 2PJ Contact Number: 01229825017 Age Range: 16+ yrs Local Education Authority: Cumbria Religious Character: Does not apply Admission Policy: Not applicable</p>	10.07 miles
	<p>Name: The Lakes School Address: Troutbeck Bridge, Windermere, LA23 1HW Contact Number: 01539440810 Age Range: 11-18 yrs Local Education Authority: Cumbria Religious Character: Does not apply</p>	13.44 miles
	<p>Name: Windermere School Address: Browhead, Windermere, LA23 1NW Contact Number: 01539446164 Age Range: 3-18 yrs Local Education Authority: Cumbria Religious Character: None</p>	13.77 miles

Disclaimer: The information represented in this section has been sourced from the Department of Education's 2019 results data s and is based on the property's postcode.



Percentage of A level students achieving at least three levels at grades AAB or better, at least two of which are in facilitating subjects

	Name	%
	Ulverston Victoria High School	16.3 %
	Millom School	20.0 %
	Furness College	8.3 %
	The Lakes School	29.4 %
	Windermere School	N/A
	Cumbria	16.5 %
National	16.5 %	

Disclaimer: The information represented in this section has been sourced from the Department of Education's 2019 results data set and is based on the property's postcode.

As well as actual pupil performance in tests and exams, an important Key Performance Indicator is that of Value Added. When pupils start a school, they all have varying levels of ability and social advantage. A school's Value Added score measures how much progress they have made from the beginning to the end of their compulsory secondary education (i.e. between the end of Key Stage 2 and the end of Key Stage 4). It is a quick measurement of the effect of a school on its pupils.

	Name	Value Added
	Ulverston Victoria High School	-0.2
	Millom School	-0.3
	Furness College	-0.2
	The Lakes School	0.1
	Windermere School	N/A



Farrell Heyworth 76 Cavendish Street, Barrow In Furness, LA14 1PZ 01229 839090





Everything you want
to know about
local health services







How local are the health services?

We all want good access to local health facilities, wherever we live. To see how well **Beanthwaite** is served, we have set out below the exact locations of hospitals, Accident & Emergency centres, GPs, pharmacies, dentists, out-of-hours medical care and walk-in clinics. Where it's available, you will find more detailed information, including the names of practitioners and their contact details.

	Hospitals	Approx Distance
	Furness General Hospital, Dalton Lane, Barrow-In-Furness, Cumbria, LA14 4LF	8.34 miles
	Westmorland General Hospital, Kendal, LA9 7RG	17.45 miles
	Royal Lancaster Infirmary, Ashton Road, Lancaster, Lancashire, LA1 4RP	20.47 miles
	Keswick Mary Hewetson Hospital, Mary Hewetson Cottage Hospital, Keswick, Cumbria, CA12 5PH	24.4 miles
	West Cumberland Hospital, Homewood, Whitehaven, CA28 8JG	25.17 miles
	A&E	Approx Distance
	Furness General Hospital, Dalton Lane, Barrow-In-Furness, Cumbria, LA14 4LF	8.34 miles
	Royal Lancaster Infirmary, Ashton Road, Lancaster, Lancashire, LA1 4RP	20.47 miles
	West Cumberland Hospital, Homewood, Whitehaven, CA28 8JG	25.17 miles
	Blackpool Victoria Hospital, Whinney Heys Road, Blackpool, Lancashire, FY3 8NR	30.4 miles
	Royal Preston Hospital, Sharoe Green Lane North, Preston, Lancashire, PR2 9HT	36.72 miles

	Walk-in Clinics	Approx Distance
	Same Day Health Centre – Morecambe, Same Day Health Centre, Morecambe, Lancashire, LA4 5LY	17.28 miles
	Westmorland General Hospital, Kendal, LA9 7RG	17.45 miles
	Same Day Health Centre – Fleetwood, Same Day Health Centre, Fleetwood, Lancashire, FY7 6HP	23.69 miles
	Keswick Mary Hewetson Hospital, Mary Hewetson Cottage Hospital, Keswick, Cumbria, CA12 5PH	24.4 miles
	Blackpool Victoria Hospital, Whinney Heys Road, Blackpool, Lancashire, FY3 8NR	30.4 miles
	GPs	Approx Distance
	DUDDON VALLEY MEDICAL PRACTICE, KIRKBY SURGERY, CUMBRIA, LA17 7TE	1.85 miles
	ULVERSTON HEALTH CENTRE (MURRAY), ULVERSTON COMM.HEALTH CTR, CUMBRIA, LA12 7BT	4.42 miles
	ULVERSTON HEALTH CENTRE (GRAHAM), ULVERSTON COMM.HEALTH CTR, CUMBRIA, LA12 7BT	4.42 miles
	ASKAM SURGERY, THE SURGERY, CUMBRIA, LA16 7JP	5.3 miles
	WATERLOO HOUSE SURGERY, WATERLOO HOUSE SURGERY, CUMBRIA, LA18 4DE	5.4 miles
	Dental Surgeons	Approx Distance
	Lancaster Dental Clinic, 8 Aldrens Lane, LANCASTER, Lancashire, LA1 2DU	19.65 miles
	Mayo Dental Clinic, 3 Meeting House Lane, LANCASTER, Lancashire, LA1 1TJ	20.03 miles
	Central Dental Practice, Telephone House, LANCASTER, Lancashire, LA1 1AB	20.07 miles
	Bay Dental Partnership, 6 New Street, LANCASTER, Lancashire, LA1 1EG	20.07 miles
	Mayo Dental Clinic, Dallas Road, LANCASTER, Lancashire, LA1 1TW	20.14 miles

Disclaimer: The information represented in this section has been sourced from Experian and is based on the property's postcode.



Farrell Heyworth 76 Cavendish Street, Barrow In Furness, LA14 1PZ **01229 839090**



Everything you want
to know about
local policing





Understanding who polices your neighbourhood

When you move to a new area, you want to know the arrangements for local community policing. See below for essential information about police services near to **Beanthwaite**. We have included location and contact details for the police station and wherever possible, details of police officers assigned to the area.

Your policing neighbourhood

The name of your policing neighbourhood is **Dalton and Askam** and it has a population of **0**.

Welcome to your area page for Dalton and Askam part of the Barrow Borough North district. From here you can find information on your area policing team, crime information and how Cumbria Police is tackling your area priorities.

Your Local Policing Team			
Name	Rank	Tel No.	E-mail
Gareth Jesson	Inspector:		
Samantha Creegan	Community Beat Officer		
John Dilks	NPT Sergeant:		
Michelle Jones	PCSO:		
Steph Hadwin	NPT Sergeant		
Joe Ward	PCSO:		
Joanne Smith	NPT Sergeant:		

Disclaimer: The information represented in this section has been sourced from data.police.uk.

Locations of Interest

\$location.type

Andrews Way, Barrow In Furness Cumbria, LA14 2UE

Disclaimer: The information represented in this section has been sourced from data.police.uk.



Farrell Heyworth 76 Cavendish Street, Barrow In Furness, LA14 1PZ 01229 839090

