



Everything you need to know about:

Oaklands Drive,  
Penwortham, Preston,  
PR1 0XY



**Introduction**



**The Property**



**Local Authority**



**Transport Links**

**Education**



**Health**



**Local Policing**





### An invaluable insight into your new home

This i-PACK brochure offers an informed overview of **Oaklands Drive** as a potential new home, along with essential material about its surrounding area and its local community. It provides a valuable insight for any prospective owner or tenant.

We wanted to provide you with information that you can absorb quickly, so we have presented it as visually as possible, making use of maps, icons, tables, graphs and charts. Overall, the brochure contains information about:

- **The Property** - including property details, floor plans, room details, photographs and Energy Performance Certificate.
- **Transport** - including locations of bus and coach stops, railway stations and ferry ports.
- **Health** - including locations, contact details and organisational information on the nearest GPs, pharmacies, hospitals and dentists.
- **Local Policing** - including locations, contact details and information about local community policing and the nearest police station, as well as police officers assigned to the area.
- **Education** - including locations of infant, primary and secondary schools and Key Performance Indicators (KPIs) for each key stage.



**Farrell Heyworth** 309 Garstang Road, Preston, PR2 9XJ **01772 752666**



OAKLANDS DRIVE, PRESTON £230,000



x3

Bedrooms



x2

Living Rooms



x1

Bathrooms

Where you are

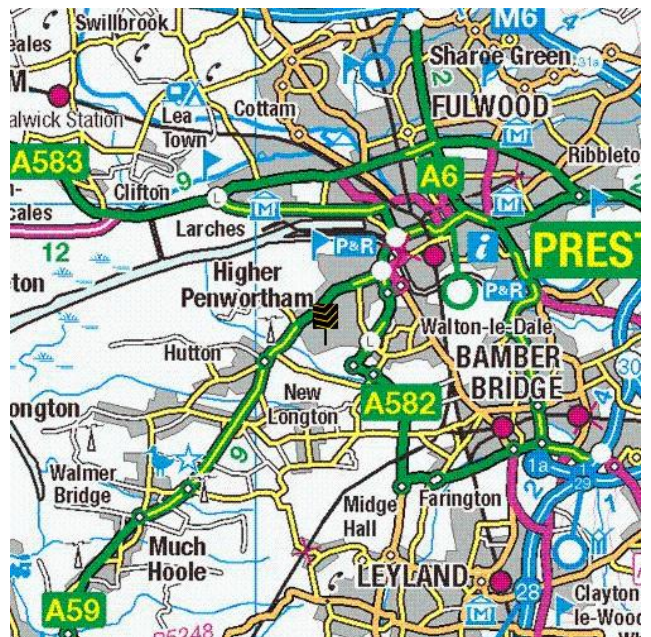
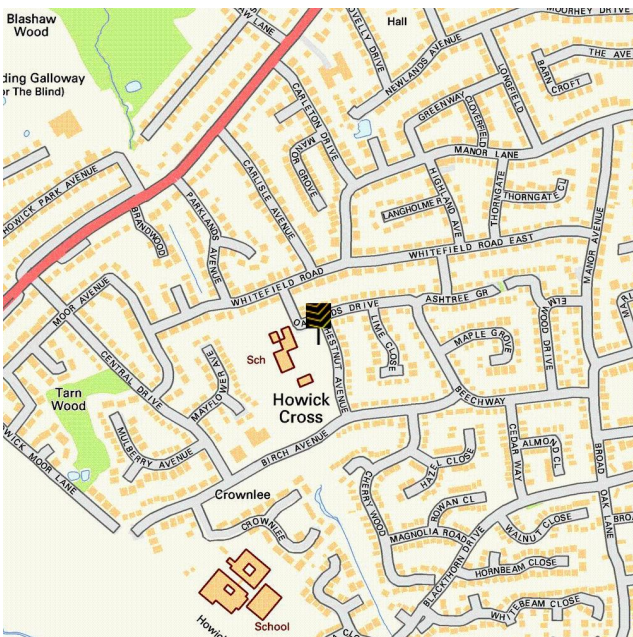





Lounge



Kitchen Diner image



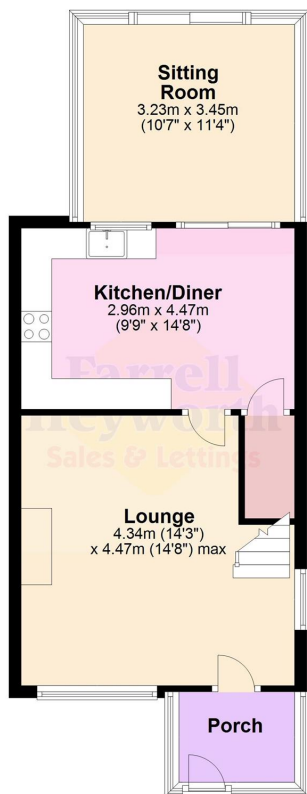

Ground Floor

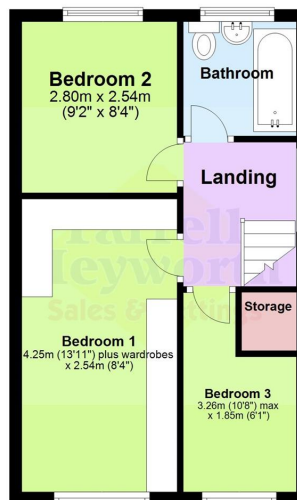

First Floor





Everything you want  
to know about  
local authorities







**Get to know your local authorities**

Local government directly affects quality of life, particularly when it comes to council tax, planning, waste disposal and the impact of local policies. You may want to investigate how this is likely to affect you if you decide to move. There are nearly 400 local authorities in England, with five different types of local government structure. These can be broadly divided into **single-tier** and **two-tier authorities**.

Single-tier authorities are **Metropolitan Authorities**, **London Boroughs** and **Unitary** or **Shire Authorities**.

Two-tier authorities have both a **County Council**, and a **District Council** or **City Council**.

There are also around 10,000 parish and town councils, effectively creating an additional tier in some areas - mostly, but not exclusively, in rural areas. The National Association of Local Councils (NALC) represents and works on behalf of these community councils and is a useful contact point.

The local authority locations and contact details for **Oaklands Drive** are:

Shire / County / District	Website	Address	Contact details
---------------------------	---------	---------	-----------------

**Disclaimer:** The information displayed above has been obtained using the property's postcode in proximity to its local authority. It is recommended that this information is independently verified.



Everything you want  
to know about  
transport links







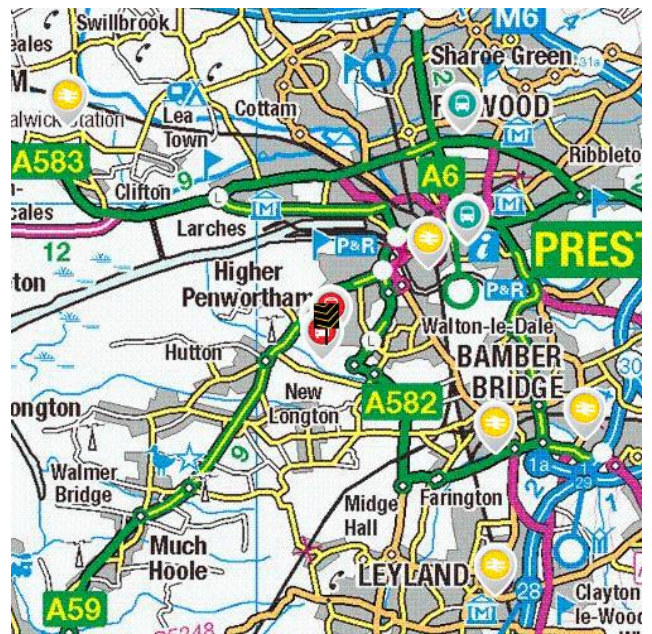
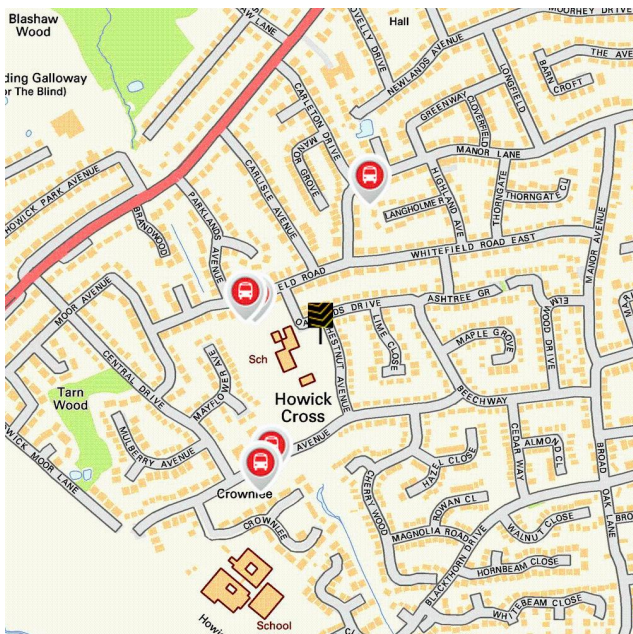

### Become familiar with public transport links

Being able to choose to travel by public transport is important for many reasons. It helps to reduce congestion, provides access to work and education, and facilitates use of health and leisure facilities. If you or your family members travel abroad, access to the nearest ferry terminals is also likely to be a significant factor in choosing a new property. Using the maps below, you can pinpoint the precise locations of transport links for **Oaklands Drive**. Tables for each type of transport indicate the property's distance from the nearest bus stops, railway stations, coach stops and ferry terminals (providing that these facilities are within the scale proximity of the maps.)

## Transport Links



	Airports	Approx Distance
	Blackpool International Airport	12.62 miles
	Liverpool John Lennon Airport	28.36 miles
	Manchester Airport	32.53 miles
	Leeds Bradford International Airport	44.82 miles
	Ferry ports	Approx Distance
	Knott End-On-Sea Ferry Landing	16.61 miles
	Fleetwood for Knott End Ferry Landing	16.8 miles
	Heysham Ferry Terminal	21.32 miles
	Liverpool Belfast Ferry Terminal Bootle	23.38 miles
	Liverpool Isle of Man & Dublin Terminal	25.56 miles
	Train Stations	Approx Distance
	Preston Rail Station	1.58 miles
	Lostock Hall Rail Station	2.43 miles
	Bamber Bridge Rail Station	3.35 miles
	Leyland Rail Station	3.67 miles
	Salwick Rail Station	4.19 miles

**Disclaimer:** The information represented in this section has been sourced from the Department of Transport's Open Data and is based on the property's postcode. It is recommended that this information is independently verified.



**Farrell Heyworth** 309 Garstang Road, Preston, PR2 9XJ 01772 752666

	Bus Stops	Approx Distance
	Whitefield Avenue	0.07 miles
	Whitefield Avenue	0.08 miles
	Sainsburys	0.13 miles
	Manor Lane	0.15 miles
	Sainsburys	0.15 miles
	Coach Stops	Approx Distance
	Preston Bus Station	2.14 miles
	Fulwood (Preston) Coach Stop	3.11 miles
	Freckleton Coach Stop	5.35 miles
	Warton (Lancs): Pickwick Coach Stop	6.35 miles
	Chorley Interchange	7.64 miles

**Disclaimer:** The information represented in this section has been sourced from the Department of Transport's Open Data and is based on the property's postcode. It is recommended that this information is independently verified.



**Farrell Heyworth** 309 Garstang Road, Preston, PR2 9XJ **01772 752666**



Everything you want  
to know about  
local schools





### How are local schools performing?

If schools are important to you, then this section sets out the published Key Performance Indicators for schools near to your prospective new home. Key Performance Indicators look primarily at how well pupils perform in their tests and examinations, as well as some other measures like attendance.

If you want to know more about a particular school or college, you can also visit the Ofsted website <http://www.ofsted.gov.uk/inspection-reports/find-inspection-report>

### Local Schools

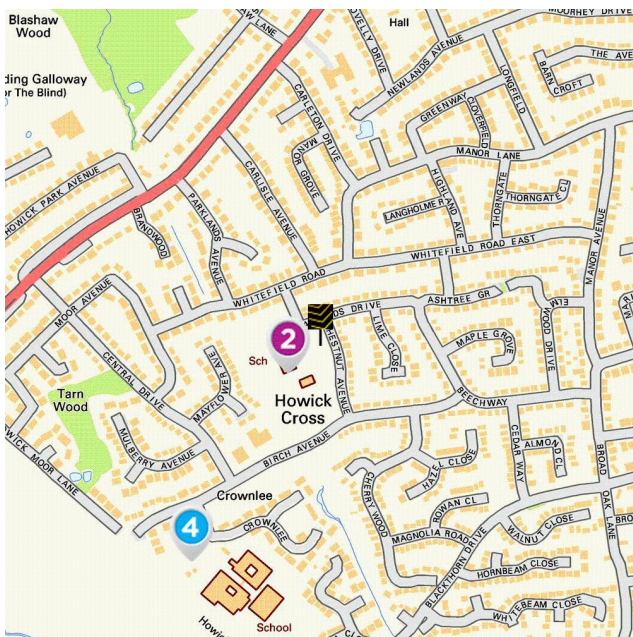

The next page shows tables and charts divided into Key Stages and a list of respective schools local to **Oaklands Drive**. There are four main age-related Key Stages defined as:



Special schools are marked with this icon

Key Stage	Definition
<b>Key Stage 1</b>	Fits broadly with the first stage of education, i.e. ages 5-7.
<b>Key Stage 2</b>	Fits the later stage of primary education, often known as junior schools, i.e. ages 8-11. This takes pupils up to the standardised break at age 11 after which pupils generally change schools and transfer to secondary education.
<b>Key Stage 3</b>	Secondary education split between key stages 3 and 4, with key stage 3 covering ages 11-13.
<b>Key Stage 4</b>	Key Stage 4 (ages 14-16) covers the two year period of study for GCSE level examinations.
<b>Key Stage 5</b>	Beyond key stage 4 is 16+ or Sixth Form provision, sometimes unofficially referred to as Key Stage 5.



**Farrell Heyworth** 309 Garstang Road, Preston, PR2 9XJ **01772 752666**



	Key Stage 2 - Information	Approx Distance
	<p><b>Name:</b> Whitefield Primary School  <b>Address:</b> Oaklands Drive, Preston, PR1 0RH  <b>Contact Number:</b> 01772744449  <b>Age Range:</b> 5-11 yrs  <b>Local Education Authority:</b> Lancashire  <b>Religious Character:</b> Does not apply</p>	0.04 miles
	<p><b>Name:</b> Penwortham, St Teresa's Catholic Primary School  <b>Address:</b> Stanley Grove, Preston, PR1 0JH  <b>Contact Number:</b> 01772742331  <b>Age Range:</b> 4-11 yrs  <b>Local Education Authority:</b> Lancashire  <b>Religious Character:</b> Roman Catholic</p>	0.38 miles
	<p><b>Name:</b> Howick Church Endowed Primary School  <b>Address:</b> Liverpool Road, Preston, PR1 0NB  <b>Contact Number:</b> 01772612487  <b>Age Range:</b> 4-11 yrs  <b>Local Education Authority:</b> Lancashire  <b>Religious Character:</b> Church of England</p>	0.4 miles
	<p><b>Name:</b> Cop Lane Church of England Primary School, Penwortham  <b>Address:</b> Cop Lane, Preston, PR1 9AE  <b>Contact Number:</b> 01772743131  <b>Age Range:</b> 4-11 yrs  <b>Local Education Authority:</b> Lancashire  <b>Religious Character:</b> Church of England</p>	0.42 miles
	<p><b>Name:</b> Penwortham Primary School  <b>Address:</b> Crookings Lane, Preston, PR1 0HU  <b>Contact Number:</b> 01772743321  <b>Age Range:</b> 5-11 yrs  <b>Local Education Authority:</b> Lancashire  <b>Religious Character:</b> Does not apply</p>	0.49 miles

**Disclaimer:** The information represented in this section has been sourced from the Department of Education's 2019 results data s and is based on the property's postcode.



## Reading, Writing and Maths

	Name	Expected	Higher
2	Whitefield Primary School	63.0 %	5.0 %
	Penwortham, St Teresa's Catholic Primary School	70.0 %	9.0 %
	Howick Church Endowed Primary School	75.0 %	13.0 %
	Cop Lane Church of England Primary School, Penwortham	70.0 %	13.0 %
	Penwortham Primary School	84.0 %	16.0 %
	<b>Lancashire</b>	64.0 %	10.0 %
	<b>National</b>	65.0 %	11.0 %

## Primary Progress Measures

As well as actual pupil performance in tests and exams an important Key Performance Indicator is that of progress measures that compare the actual achievements of other pupils nationally with similar prior attainment. Any increase in attainment achieved by each pupil will be reflected in the schools progress scores. They are fairer to schools in challenging circumstances, as they recognise a school that is doing a good job with an intake with poor prior attainment

## Progress Measures for 2019

	Name	Math	Reading	Writing
2	Whitefield Primary School	-2.1 %	0.2 %	-0.2 %
	Penwortham, St Teresa's Catholic Primary School	1.5 %	1.5 %	1.8 %
	Howick Church Endowed Primary School	0.0 %	-1.2 %	2.5 %
	Cop Lane Church of England Primary School, Penwortham	1.3 %	-0.4 %	2.2 %
	Penwortham Primary School	1.2 %	1.2 %	1.2 %

**Disclaimer:** The information represented in this section has been sourced from the Department of Education's 2019 results data set and is based on the property's postcode.



Farrell Heyworth 309 Garstang Road, Preston, PR2 9XJ 01772 752666

	Key Stage 4 - Information	Approx Distance
4	<b>Name:</b> All Hallows Catholic High School <b>Address:</b> Crabtree Avenue, Preston, PR1 0LN <b>Contact Number:</b> 01772746121 <b>Age Range:</b> 11-16 yrs <b>Local Education Authority:</b> Lancashire <b>Religious Character:</b> Roman Catholic	0.24 miles
	<b>Name:</b> Penwortham Girls' High School <b>Address:</b> Cop Lane, Preston, PR1 0SR <b>Contact Number:</b> 01772743399 <b>Age Range:</b> 11-16 yrs <b>Local Education Authority:</b> Lancashire <b>Religious Character:</b> Does not apply	0.5 miles
	<b>Name:</b> Penwortham Priory Academy <b>Address:</b> Crow Hills Road, Preston, PR1 0JE <b>Contact Number:</b> 01772320250 <b>Age Range:</b> 11-16 yrs <b>Local Education Authority:</b> Lancashire <b>Religious Character:</b> Does not apply	0.58 miles
	<b>Name:</b> Hutton Church of England Grammar School <b>Address:</b> Liverpool Road, Preston, PR4 5SN <b>Contact Number:</b> 01772613112 <b>Age Range:</b> 11-18 yrs <b>Local Education Authority:</b> Lancashire <b>Religious Character:</b> Church of England	1.24 miles
	 <b>Name:</b> Stonegate School <b>Address:</b> Co Hexagon Care Services, Preston, PR2 2YQ <b>Contact Number:</b> 01524263237 <b>Age Range:</b> 11-16 yrs <b>Local Education Authority:</b> Lancashire <b>Religious Character:</b> None	1.31 miles

**Disclaimer:** The information represented in this section has been sourced from the Department of Education's 2019 results data s and is based on the property's postcode.



### Percentage of pupils achieving 5+ A\*-C/9-4 or equivalents including 9-4 in both English and mathematics GCSEs

	Name	2019	2018	2017	2016
4	All Hallows Catholic High School	81.0 %	85.0 %	78.0 %	83.0 %
	Penwortham Girls' High School	86.0 %	80.0 %	87.0 %	72.0 %
	Penwortham Priory Academy	64.0 %	55.0 %	58.0 %	63.0 %
	Hutton Church of England Grammar School	78.0 %	87.0 %	82.0 %	75.0 %
	Stonegate School	N/A	N/A	N/A	N/A
	<b>Lancashire</b>	66.0 %	66.1 %	61.7 %	58.5 %
	<b>National</b>	60.0 %	59.4 %	56.6 %	53.5 %

**Disclaimer:** The information represented in this section has been sourced from the Department of Education's 2017 results data set and is based on the property's postcode.

### Average number of GCSE entries per pupil

	Name	Number
4	All Hallows Catholic High School	7.9
	Penwortham Girls' High School	7.8
	Penwortham Priory Academy	6.1
	Hutton Church of England Grammar School	9.2
	Stonegate School	N/A
	<b>Lancashire</b>	7.5
	<b>National</b>	7.1

**Disclaimer:** The information represented in this section has been sourced from the Department of Education's 2019 results data set and is based on the property's postcode.



	Key Stage 5 - Information	Approx Distance
	<p><b>Name:</b> Hutton Church of England Grammar School  <b>Address:</b> Liverpool Road, Preston, PR4 5SN  <b>Contact Number:</b> 01772613112  <b>Age Range:</b> 11-18 yrs  <b>Local Education Authority:</b> Lancashire  <b>Religious Character:</b> Church of England</p>	1.24 miles
	<p><b>Name:</b> Ashton Community Science College  <b>Address:</b> Aldwych Drive, Preston, PR2 1SL  <b>Contact Number:</b> 01772513002  <b>Age Range:</b> 11-16 yrs  <b>Local Education Authority:</b> Lancashire  <b>Religious Character:</b> Does not apply  <b>Admission Policy:</b> Comprehensive</p>	1.91 miles
	<p><b>Name:</b> Cardinal Newman College  <b>Address:</b> Lark Hill Road, Preston, PR1 4HD  <b>Contact Number:</b> 01772460181  <b>Age Range:</b> 16+ yrs  <b>Local Education Authority:</b> Lancashire  <b>Religious Character:</b> Roman Catholic  <b>Admission Policy:</b> Not applicable</p>	2.26 miles
	<p><b>Name:</b> Preston Muslim Girls High School  <b>Address:</b> Quwwatul Education Centre, Preston, PR1 6QQ  <b>Contact Number:</b> 01772651906  <b>Age Range:</b> 11-19 yrs  <b>Local Education Authority:</b> Lancashire  <b>Religious Character:</b> Muslim</p>	2.64 miles
	<p><b>Name:</b> Moor Park High School and Sixth Form  <b>Address:</b> Moor Park Avenue, Preston, PR1 6DT  <b>Contact Number:</b> 01772795428  <b>Age Range:</b> 11-18 yrs  <b>Local Education Authority:</b> Lancashire  <b>Religious Character:</b> None</p>	2.71 miles

**Disclaimer:** The information represented in this section has been sourced from the Department of Education's 2019 results data set and is based on the property's postcode.



**Percentage of A level students achieving at least three levels at grades AAB or better, at least two of which are in facilitating subjects**

	Name	%
5	Hutton Church of England Grammar School	11.8 %
	Ashton Community Science College	N/A
	Cardinal Newman College	13.1 %
	Preston Muslim Girls High School	N/A
	Moor Park High School and Sixth Form	0.0 %
	<b>Lancashire</b>	<b>15.1 %</b>
	<b>National</b>	<b>16.5 %</b>

**Disclaimer:** The information represented in this section has been sourced from the Department of Education's 2019 results data set and is based on the property's postcode.

As well as actual pupil performance in tests and exams, an important Key Performance Indicator is that of Value Added. When pupils start a school, they all have varying levels of ability and social advantage. A school's Value Added score measures how much progress they have made from the beginning to the end of their compulsory secondary education (i.e. between the end of Key Stage 2 and the end of Key Stage 4). It is a quick measurement of the effect of a school on its pupils.

	Name	Value Added
5	Hutton Church of England Grammar School	0.2
	Ashton Community Science College	N/A
	Cardinal Newman College	0.2
	Preston Muslim Girls High School	N/A
	Moor Park High School and Sixth Form	0.1



**Farrell Heyworth** 309 Garstang Road, Preston, PR2 9XJ 01772 752666





Everything you want  
to know about  
local health services





### How local are the health services?

We all want good access to local health facilities, wherever we live. To see how well **Oaklands Drive** is served, we have set out below the exact locations of hospitals, Accident & Emergency centres, GPs, pharmacies, dentists, out-of-hours medical care and walk-in clinics. Where it's available, you will find more detailed information, including the names of practitioners and their contact details.

	Hospitals	Approx Distance
	Royal Preston Hospital, Sharoe Green Lane North, Preston, Lancashire, PR2 9HT	3.6 miles
	Chorley And South Ribble Hospital, Chorley and South Ribble Hospital, Chorley, Lancashire, PR7 1PP	6.72 miles
	Royal Blackburn Hospital, Haslingden Road, Blackburn, Lancashire, BB2 3HH	11.1 miles
	Southport And Formby District General Hospital, Southport, Merseyside, PR8 6PN	12.36 miles
	Blackpool Victoria Hospital, Whinney Heys Road, Blackpool, Lancashire, FY3 8NR	12.56 miles
	A&E	Approx Distance
	Royal Preston Hospital, Sharoe Green Lane North, Preston, Lancashire, PR2 9HT	3.6 miles
	Chorley And South Ribble Hospital, Chorley and South Ribble Hospital, Chorley, Lancashire, PR7 1PP	6.72 miles
	Royal Blackburn Hospital, Haslingden Road, Blackburn, Lancashire, BB2 3HH	11.1 miles
	Southport And Formby District General Hospital, Southport, Merseyside, PR8 6PN	12.36 miles
	Blackpool Victoria Hospital, Whinney Heys Road, Blackpool, Lancashire, FY3 8NR	12.56 miles



	Walk-in Clinics	Approx Distance
	Dr T L Phillips At Barbara Castle Health Centre, Level Two, Lancashire, BB2 1AX	10.29 miles
	Royal Blackburn Hospital, Haslingden Road, Blackburn, Lancashire, BB2 3HH	11.1 miles
	Darwen Health Care, Darwen Health Centre, Lancashire, BB3 1PY	11.37 miles
	Blackpool Victoria Hospital, Whinney Heys Road, Blackpool, Lancashire, FY3 8NR	12.56 miles
	Blackpool Nhs Walk-in Centre, Whitegate Health Centre, Blackpool, Lancashire, FY3 9ES	13.03 miles
	GPs	Approx Distance
	ST.MARY'S HEALTH CENTRE, ST.MARY'S HEALTH CENTRE, LANCASHIRE, PR1 0SR	0.5 miles
	ST FILLAN'S MEDICAL CTRE, ST FILLAN'S MEDICAL CTRE, LANCASHIRE, PR1 0AD	0.67 miles
	KINGSFOLD MEDICAL CENTRE, KINGSFOLD MEDICAL CENTRE, PRESTON, PR1 9BX	0.75 miles
	FISHERGATE HILL SURGERY, FISHERGATE HILL SURGERY, LANCASHIRE, PR1 8DN	1.28 miles
	NEW LONGTON SURGERY, THE VILLAGE SURGERY, PRESTON, PR4 4LU	1.28 miles
	Dental Surgeons	Approx Distance
	High Street Smiles, 107-109 High Street, WARRINGTON, Cheshire, WA3 3BZ	19.21 miles
	Mr Jm Kelly & Associates, 7A Stonecross Lane, WARRINGTON, Cheshire, WA3 2SA	19.58 miles
	L Askins, Woodgate, WARRINGTON, Cheshire, WA3 2QZ	19.91 miles
	Community Dental Services, Ashton Road, LANCASTER, Lancashire, LA1 4RR	20.76 miles
	Mayo Dental Clinic, Dallas Road, LANCASTER, Lancashire, LA1 1TW	21.15 miles

**Disclaimer:** The information represented in this section has been sourced from Experian and is based on the property's postcode.



**Farrell Heyworth** 309 Garstang Road, Preston, PR2 9XJ **01772 752666**



Everything you want  
to know about  
local policing





### Understanding who polices your neighbourhood

When you move to a new area, you want to know the arrangements for local community policing. See below for essential information about police services near to **Oaklands Drive**. We have included location and contact details for the police station and wherever possible, details of police officers assigned to the area.

#### Your policing neighbourhood

The name of your policing neighbourhood is **Broadoak, Whitefield, Howick & Priory** and it has a population of **11530**.

Your Local Policing Team			
Name	Rank	Tel No.	E-mail
Hannah Blundell	PCSO		
James Kilner	PCSO		

**Disclaimer:** The information represented in this section has been sourced from data.police.uk.

**Disclaimer:** The information represented in this section has been sourced from data.police.uk.





