



Everything you need to know about:

Woodville Road,  
Penwortham, Preston,  
PR1 9DR



**Introduction**



**The Property**



**Local Authority**



**Transport Links**

**Education**



**Health**



**Local Policing**





### An invaluable insight into your new home

This i-PACK brochure offers an informed overview of **Woodville Road** as a potential new home, along with essential material about its surrounding area and its local community. It provides a valuable insight for any prospective owner or tenant.

We wanted to provide you with information that you can absorb quickly, so we have presented it as visually as possible, making use of maps, icons, tables, graphs and charts. Overall, the brochure contains information about:

- **The Property** - including property details, floor plans, room details, photographs and Energy Performance Certificate.
- **Transport** - including locations of bus and coach stops, railway stations and ferry ports.
- **Health** - including locations, contact details and organisational information on the nearest GPs, pharmacies, hospitals and dentists.
- **Local Policing** - including locations, contact details and information about local community policing and the nearest police station, as well as police officers assigned to the area.
- **Education** - including locations of infant, primary and secondary schools and Key Performance Indicators (KPIs) for each key stage.



**Farrell Heyworth** 309 Garstang Road, Preston, PR2 9XJ **01772 752666**



WOODVILLE ROAD, PRESTON £199,950



**x3**  
Bedrooms



**x2**  
Living Rooms



**x1**  
Bathrooms

## Where you are

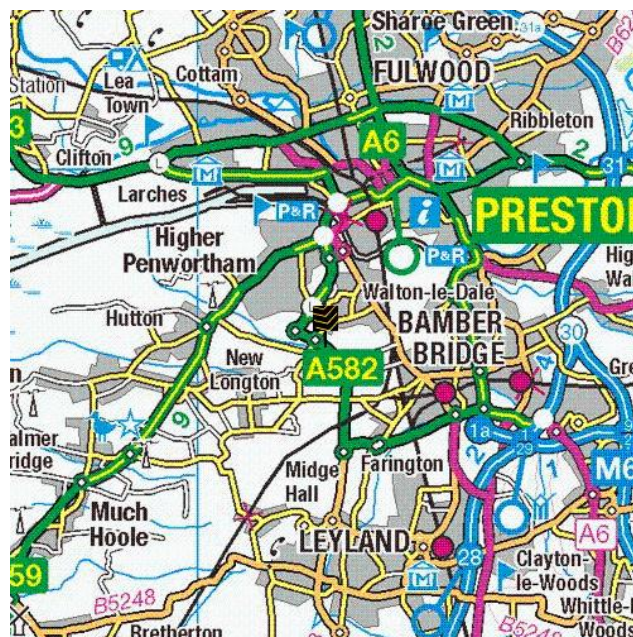
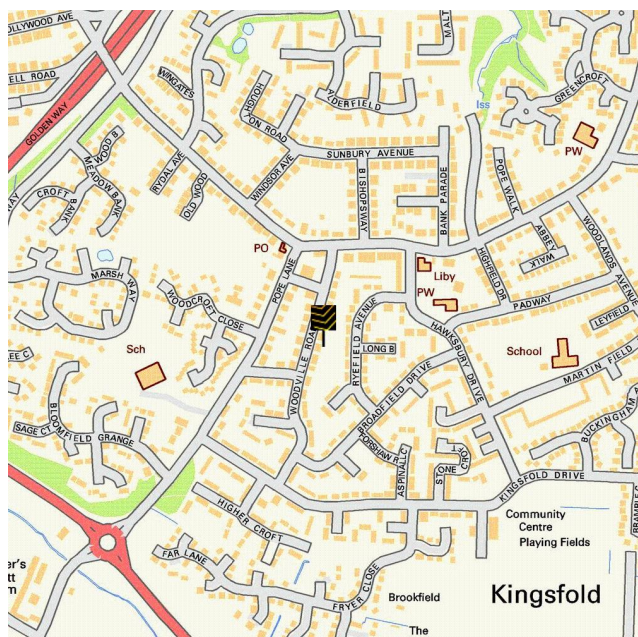





Kitchen



Bedroom One View 2



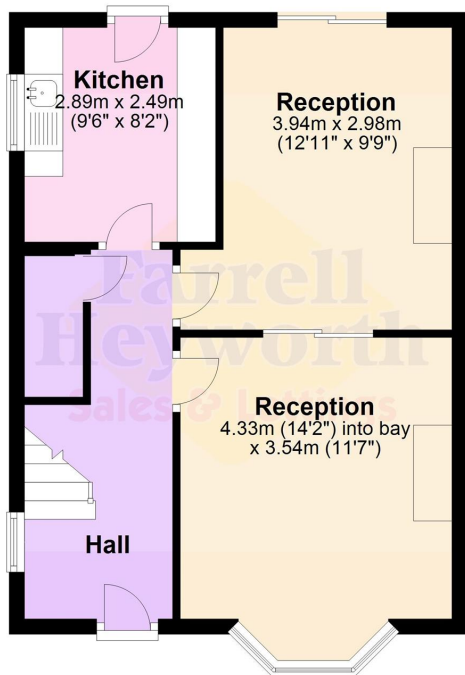

Ground Floor

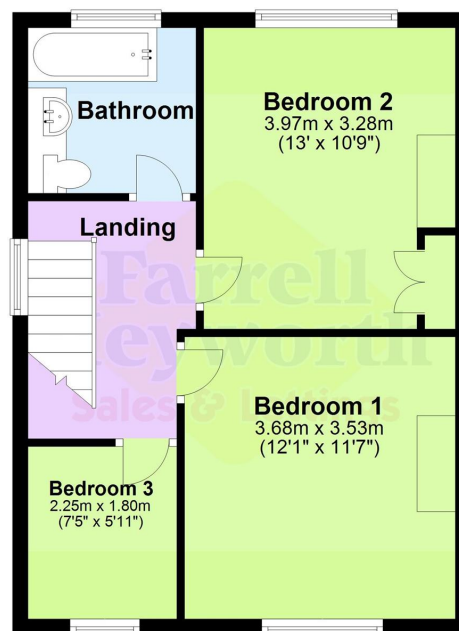

First Floor





Everything you want  
to know about  
local authorities







**Get to know your local authorities**

Local government directly affects quality of life, particularly when it comes to council tax, planning, waste disposal and the impact of local policies. You may want to investigate how this is likely to affect you if you decide to move. There are nearly 400 local authorities in England, with five different types of local government structure. These can be broadly divided into **single-tier** and **two-tier authorities**.

Single-tier authorities are **Metropolitan Authorities**, **London Boroughs** and **Unitary** or **Shire Authorities**.

Two-tier authorities have both a **County Council**, and a **District Council** or **City Council**.

There are also around 10,000 parish and town councils, effectively creating an additional tier in some areas - mostly, but not exclusively, in rural areas. The National Association of Local Councils (NALC) represents and works on behalf of these community councils and is a useful contact point.

The local authority locations and contact details for **Woodville Road** are:

| Shire / County / District | Website | Address | Contact details |
|---------------------------|---------|---------|-----------------|
|---------------------------|---------|---------|-----------------|

**Disclaimer:** The information displayed above has been obtained using the property's postcode in proximity to its local authority. It is recommended that this information is independently verified.



Everything you want  
to know about  
transport links







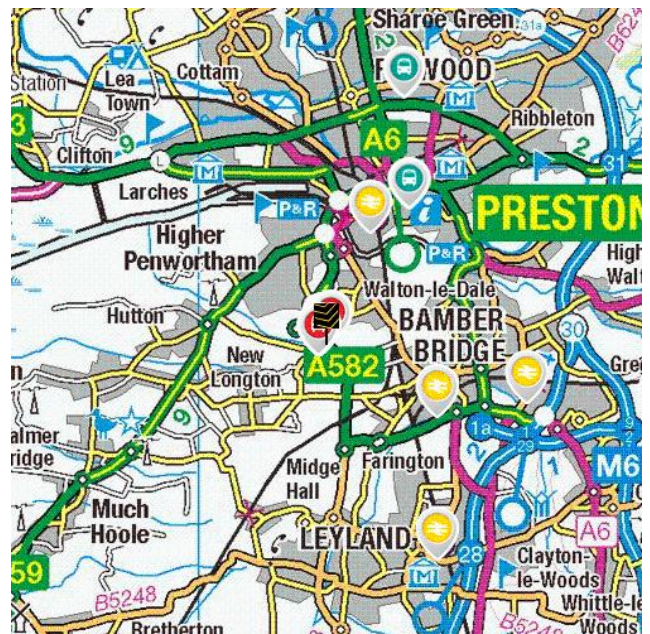
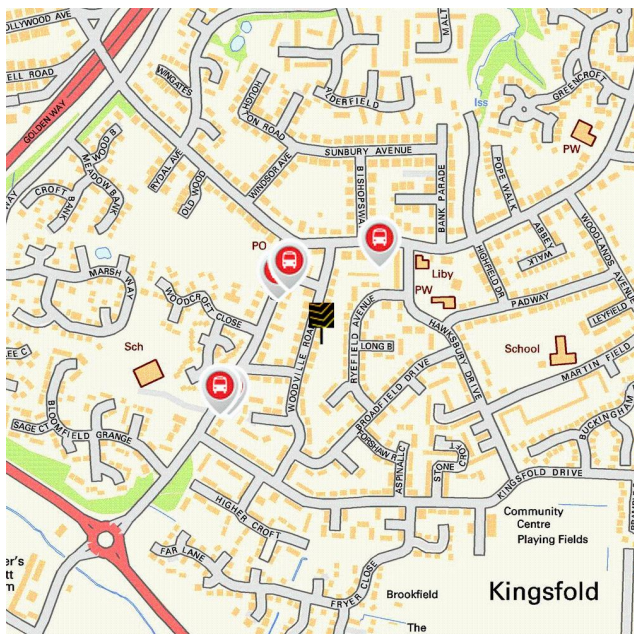

**Become familiar with public transport links**

Being able to choose to travel by public transport is important for many reasons. It helps to reduce congestion, provides access to work and education, and facilitates use of health and leisure facilities. If you or your family members travel abroad, access to the nearest ferry terminals is also likely to be a significant factor in choosing a new property. Using the maps below, you can pinpoint the precise locations of transport links for **Woodville Road**. Tables for each type of transport indicate the property's distance from the nearest bus stops, railway stations, coach stops and ferry terminals (providing that these facilities are within the scale proximity of the maps.)

**Transport Links**



|  | Airports                                | Approx Distance |
|--|---|-----------------|
|   | Blackpool International Airport         | 13.42 miles     |
|  | Liverpool John Lennon Airport           | 28.05 miles     |
|  | Manchester Airport                      | 31.75 miles     |
|  | Leeds Bradford International Airport    | 44.21 miles     |
|  | Ferry ports                             | Approx Distance |
|   | Knott End-On-Sea Ferry Landing          | 17.41 miles     |
|  | Fleetwood for Knott End Ferry Landing   | 17.61 miles     |
|  | Heysham Ferry Terminal                  | 21.98 miles     |
|  | Liverpool Belfast Ferry Terminal Bootle | 23.34 miles     |
|  | Liverpool Isle of Man & Dublin Terminal | 25.46 miles     |
|  | Train Stations                          | Approx Distance |
|  | Preston Rail Station                    | 1.53 miles      |
|  | Lostock Hall Rail Station               | 1.58 miles      |
|  | Bamber Bridge Rail Station              | 2.53 miles      |
|  | Leyland Rail Station                    | 2.91 miles      |
|  | Buckshaw Parkway Rail Station           | 4.97 miles      |

**Disclaimer:** The information represented in this section has been sourced from the Department of Transport's Open Data and is based on the property's postcode. It is recommended that this information is independently verified.



**Farrell Heyworth** 309 Garstang Road, Preston, PR2 9XJ 01772 752666

|   | Bus Stops                           | Approx Distance |
|---|-------------------------------------|-----------------|
|  | The Plough Inn                      | 0.06 miles      |
|   | Plough Inn                          | 0.06 miles      |
|   | Kingsfold Shops                     | 0.1 miles       |
|   | Kingsfold Drive                     | 0.11 miles      |
|   | Kingsfold Drive                     | 0.12 miles      |
|   | Coach Stops                         | Approx Distance |
|  | Preston Bus Station                 | 2.0 miles       |
|   | Fulwood (Preston) Coach Stop        | 3.23 miles      |
|   | Freckleton Coach Stop               | 6.14 miles      |
|   | Chorley Interchange                 | 6.86 miles      |
|   | Warton (Lancs): Pickwick Coach Stop | 7.11 miles      |

**Disclaimer:** The information represented in this section has been sourced from the Department of Transport's Open Data and is based on the property's postcode. It is recommended that this information is independently verified.



**Farrell Heyworth** 309 Garstang Road, Preston, PR2 9XJ **01772 752666**



Everything you want  
to know about  
local schools





### How are local schools performing?

If schools are important to you, then this section sets out the published Key Performance Indicators for schools near to your prospective new home. Key Performance Indicators look primarily at how well pupils perform in their tests and examinations, as well as some other measures like attendance.

If you want to know more about a particular school or college, you can also visit the Ofsted website <http://www.ofsted.gov.uk/inspection-reports/find-inspection-report>

### Local Schools

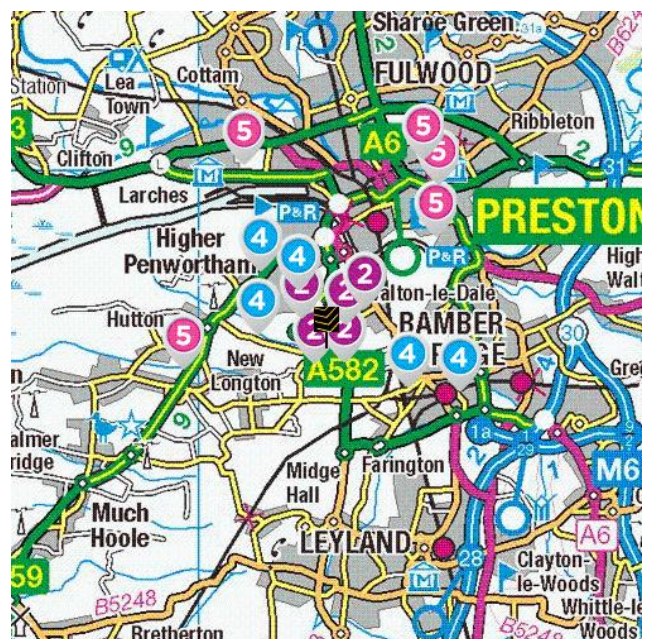
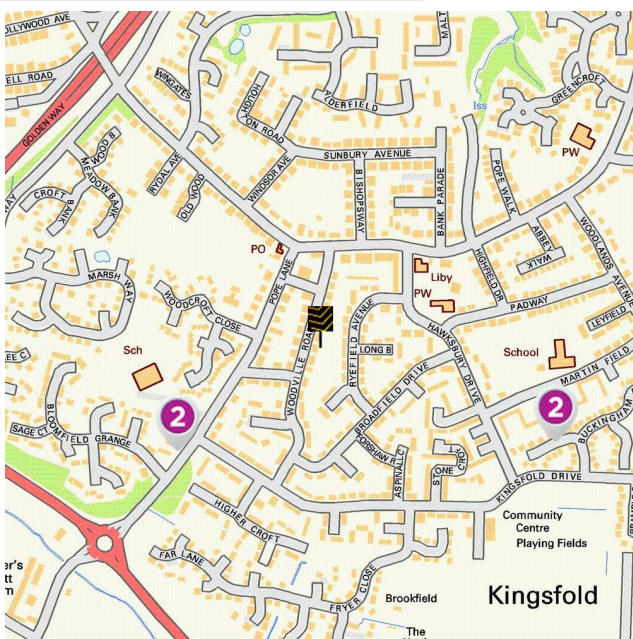

The next page shows tables and charts divided into Key Stages and a list of respective schools local to **Woodville Road**. There are four main age-related Key Stages defined as:



Special schools are marked with this icon

| Key Stage   | Definition  |
|-------------|---|
| Key Stage 1 | Fits broadly with the first stage of education, i.e. ages 5-7.  |
| Key Stage 2 | Fits the later stage of primary education, often known as junior schools, i.e. ages 8-11. This takes pupils up to the standardised break at age 11 after which pupils generally change schools and transfer to secondary education. |
| Key Stage 3 | Secondary education split between key stages 3 and 4, with key stage 3 covering ages 11-13.   |
| Key Stage 4 | Key Stage 4 (ages 14-16) covers the two year period of study for GCSE level examinations.   |
| Key Stage 5 | Beyond key stage 4 is 16+ or Sixth Form provision, sometimes unofficially referred to as Key Stage 5.   |



**Farrell Heyworth** 309 Garstang Road, Preston, PR2 9XJ **01772 752666**



|   | Key Stage 2 - Information   | Approx Distance |
|---|---|-----------------|
|  | <p><b>Name:</b> Penwortham Broad Oak Primary School<br/> <b>Address:</b> Pope Lane, Preston, PR1 9DE<br/> <b>Contact Number:</b> 01772749511<br/> <b>Age Range:</b> 4-11 yrs<br/> <b>Local Education Authority:</b> Lancashire<br/> <b>Religious Character:</b> Does not apply</p>                              | 0.17 miles      |
|   | <p><b>Name:</b> Kingsfold Primary School<br/> <b>Address:</b> Martinfield Road, Preston, PR1 9HJ<br/> <b>Contact Number:</b> 01772743531<br/> <b>Age Range:</b> 3-11 yrs<br/> <b>Local Education Authority:</b> Lancashire<br/> <b>Religious Character:</b> Does not apply</p>                                  | 0.25 miles      |
|   | <p><b>Name:</b> Penwortham Middleforth Church of England Primary School<br/> <b>Address:</b> Hill Road South, Preston, PR1 9YE<br/> <b>Contact Number:</b> 01772746024<br/> <b>Age Range:</b> 4-11 yrs<br/> <b>Local Education Authority:</b> Lancashire<br/> <b>Religious Character:</b> Church of England</p> | 0.46 miles      |
|   | <p><b>Name:</b> Cop Lane Church of England Primary School, Penwortham<br/> <b>Address:</b> Cop Lane, Preston, PR1 9AE<br/> <b>Contact Number:</b> 01772743131<br/> <b>Age Range:</b> 4-11 yrs<br/> <b>Local Education Authority:</b> Lancashire<br/> <b>Religious Character:</b> Church of England</p>          | 0.54 miles      |
|   | <p><b>Name:</b> St Mary Magdalen's Catholic Primary School<br/> <b>Address:</b> Buller Avenue, Preston, PR1 9QQ<br/> <b>Contact Number:</b> 01772742351<br/> <b>Age Range:</b> 5-11 yrs<br/> <b>Local Education Authority:</b> Lancashire<br/> <b>Religious Character:</b> Roman Catholic</p>                   | 0.75 miles      |

**Disclaimer:** The information represented in this section has been sourced from the Department of Education's 2019 results data s and is based on the property's postcode.



## Reading, Writing and Maths

|   | Name  | Expected | Higher |
|---|---|----------|--------|
|  | Penwortham Broad Oak Primary School                     | 83.0 %   | 10.0 % |
|   | Kingsfold Primary School                                | 57.0 %   | 0.0 %  |
|   | Penwortham Middleforth Church of England Primary School | 67.0 %   | 3.0 %  |
|   | Cop Lane Church of England Primary School, Penwortham   | 70.0 %   | 13.0 % |
|   | St Mary Magdalen's Catholic Primary School              | 83.0 %   | 20.0 % |
|   | <b>Lancashire</b>                                       | 64.0 %   | 10.0 % |
| <b>National</b>   | 65.0 %  | 11.0 %   |        |

## Primary Progress Measures

As well as actual pupil performance in tests and exams an important Key Performance Indicator is that of progress measures that compare the actual achievements of other pupils nationally with similar prior attainment. Any increase in attainment achieved by each pupil will be reflected in the schools progress scores. They are fairer to schools in challenging circumstances, as they recognise a school that is doing a good job with an intake with poor prior attainment

## Progress Measures for 2019

|   | Name  | Math   | Reading | Writing |
|---|---|--------|---------|---------|
|  | Penwortham Broad Oak Primary School                     | 3.5 %  | 2.1 %   | 2.3 %   |
|   | Kingsfold Primary School                                | -0.9 % | -2.6 %  | 0.3 %   |
|   | Penwortham Middleforth Church of England Primary School | 1.8 %  | 2.9 %   | 0.6 %   |
|   | Cop Lane Church of England Primary School, Penwortham   | 1.3 %  | -0.4 %  | 2.2 %   |
|   | St Mary Magdalen's Catholic Primary School              | 2.7 %  | 2.0 %   | 0.5 %   |

**Disclaimer:** The information represented in this section has been sourced from the Department of Education's 2019 results data set and is based on the property's postcode.



Farrell Heyworth 309 Garstang Road, Preston, PR2 9XJ 01772 752666

|   | Key Stage 4 - Information   | Approx Distance |
|---|---|-----------------|
|  | <p><b>Name:</b> Penwortham Girls' High School<br/> <b>Address:</b> Cop Lane, Preston, PR1 0SR<br/> <b>Contact Number:</b> 01772743399<br/> <b>Age Range:</b> 11-16 yrs<br/> <b>Local Education Authority:</b> Lancashire<br/> <b>Religious Character:</b> Does not apply</p>  | 0.88 miles      |
|   | <p><b>Name:</b> All Hallows Catholic High School<br/> <b>Address:</b> Crabtree Avenue, Preston, PR1 0LN<br/> <b>Contact Number:</b> 01772746121<br/> <b>Age Range:</b> 11-16 yrs<br/> <b>Local Education Authority:</b> Lancashire<br/> <b>Religious Character:</b> Roman Catholic</p>  | 0.88 miles      |
|   | <p><b>Name:</b> Lostock Hall Moor Hey School <br/> <b>Address:</b> Far Croft, Preston, PR5 5SS<br/> <b>Contact Number:</b> 01772336976<br/> <b>Age Range:</b> 4-16 yrs<br/> <b>Local Education Authority:</b> Lancashire<br/> <b>Religious Character:</b> Does not apply</p> | 1.07 miles      |
|   | <p><b>Name:</b> Penwortham Priory Academy<br/> <b>Address:</b> Crow Hills Road, Preston, PR1 0JE<br/> <b>Contact Number:</b> 01772320250<br/> <b>Age Range:</b> 11-16 yrs<br/> <b>Local Education Authority:</b> Lancashire<br/> <b>Religious Character:</b> Does not apply</p>   | 1.31 miles      |
|   | <p><b>Name:</b> Lostock Hall Academy<br/> <b>Address:</b> Todd Lane North, Preston, PR5 5UR<br/> <b>Contact Number:</b> 01772336293<br/> <b>Age Range:</b> 11-16 yrs<br/> <b>Local Education Authority:</b> Lancashire<br/> <b>Religious Character:</b> Does not apply</p>  | 1.69 miles      |

**Disclaimer:** The information represented in this section has been sourced from the Department of Education's 2019 results data s and is based on the property's postcode.



### Percentage of pupils achieving 5+ A\*-C/9-4 or equivalents including 9-4 in both English and mathematics GCSEs

|   | Name                             | 2019          | 2018          | 2017          | 2016          |
|---|----------------------------------|---------------|---------------|---------------|---------------|
| 4 | Penwortham Girls' High School    | 86.0 %        | 80.0 %        | 87.0 %        | 72.0 %        |
|   | All Hallows Catholic High School | 81.0 %        | 85.0 %        | 78.0 %        | 83.0 %        |
|   | Lostock Hall Moor Hey School     | 0.0 %         | 0.0 %         | 0.0 %         | 0.0 %         |
|   | Penwortham Priory Academy        | 64.0 %        | 55.0 %        | 58.0 %        | 63.0 %        |
|   | Lostock Hall Academy             | 76.0 %        | 64.0 %        | 75.0 %        | 55.0 %        |
|   | <b>Lancashire</b>                | <b>66.0 %</b> | <b>66.1 %</b> | <b>61.7 %</b> | <b>58.5 %</b> |
|   | <b>National</b>                  | <b>60.0 %</b> | <b>59.4 %</b> | <b>56.6 %</b> | <b>53.5 %</b> |

**Disclaimer:** The information represented in this section has been sourced from the Department of Education's 2017 results data set and is based on the property's postcode.

### Average number of GCSE entries per pupil

|   | Name                             | Number     |
|---|----------------------------------|------------|
| 4 | Penwortham Girls' High School    | 7.8        |
|   | All Hallows Catholic High School | 7.9        |
|   | Lostock Hall Moor Hey School     | 0.3        |
|   | Penwortham Priory Academy        | 6.1        |
|   | Lostock Hall Academy             | 6.7        |
|   | <b>Lancashire</b>                | <b>7.5</b> |
|   | <b>National</b>                  | <b>7.1</b> |

**Disclaimer:** The information represented in this section has been sourced from the Department of Education's 2019 results data set and is based on the property's postcode.



|   | Key Stage 5 - Information  | Approx Distance |
|---|--|-----------------|
|  | <p><b>Name:</b> Hutton Church of England Grammar School<br/> <b>Address:</b> Liverpool Road, Preston, PR4 5SN<br/> <b>Contact Number:</b> 01772613112<br/> <b>Age Range:</b> 11-18 yrs<br/> <b>Local Education Authority:</b> Lancashire<br/> <b>Religious Character:</b> Church of England</p>                                  | 1.78 miles      |
|   | <p><b>Name:</b> Cardinal Newman College<br/> <b>Address:</b> Lark Hill Road, Preston, PR1 4HD<br/> <b>Contact Number:</b> 01772460181<br/> <b>Age Range:</b> 16+ yrs<br/> <b>Local Education Authority:</b> Lancashire<br/> <b>Religious Character:</b> Roman Catholic<br/> <b>Admission Policy:</b> Not applicable</p>          | 1.96 miles      |
|   | <p><b>Name:</b> Preston Muslim Girls High School<br/> <b>Address:</b> Quwwatul Education Centre, Preston, PR1 6QQ<br/> <b>Contact Number:</b> 01772651906<br/> <b>Age Range:</b> 11-19 yrs<br/> <b>Local Education Authority:</b> Lancashire<br/> <b>Religious Character:</b> Muslim</p>   | 2.5 miles       |
|   | <p><b>Name:</b> Ashton Community Science College<br/> <b>Address:</b> Aldwych Drive, Preston, PR2 1SL<br/> <b>Contact Number:</b> 01772513002<br/> <b>Age Range:</b> 11-16 yrs<br/> <b>Local Education Authority:</b> Lancashire<br/> <b>Religious Character:</b> Does not apply<br/> <b>Admission Policy:</b> Comprehensive</p> | 2.56 miles      |
|   | <p><b>Name:</b> Moor Park High School and Sixth Form<br/> <b>Address:</b> Moor Park Avenue, Preston, PR1 6DT<br/> <b>Contact Number:</b> 01772795428<br/> <b>Age Range:</b> 11-18 yrs<br/> <b>Local Education Authority:</b> Lancashire<br/> <b>Religious Character:</b> None</p>  | 2.68 miles      |

**Disclaimer:** The information represented in this section has been sourced from the Department of Education's 2019 results data s and is based on the property's postcode.



**Percentage of A level students achieving at least three levels at grades AAB or better, at least two of which are in facilitating subjects**

|   | Name                                    | %             |
|---|---|---------------|
|  | Hutton Church of England Grammar School | 11.8 %        |
|   | Cardinal Newman College                 | 13.1 %        |
|   | Preston Muslim Girls High School        | N/A           |
|   | Ashton Community Science College        | N/A           |
|   | Moor Park High School and Sixth Form    | 0.0 %         |
|   | <b>Lancashire</b>                       | <b>15.1 %</b> |
|   | <b>National</b>                         | <b>16.5 %</b> |

**Disclaimer:** The information represented in this section has been sourced from the Department of Education's 2019 results data set and is based on the property's postcode.

As well as actual pupil performance in tests and exams, an important Key Performance Indicator is that of Value Added. When pupils start a school, they all have varying levels of ability and social advantage. A school's Value Added score measures how much progress they have made from the beginning to the end of their compulsory secondary education (i.e. between the end of Key Stage 2 and the end of Key Stage 4). It is a quick measurement of the effect of a school on its pupils.

|   | Name                                    | Value Added |
|---|---|-------------|
|  | Hutton Church of England Grammar School | 0.2         |
|   | Cardinal Newman College                 | 0.2         |
|   | Preston Muslim Girls High School        | N/A         |
|   | Ashton Community Science College        | N/A         |
|   | Moor Park High School and Sixth Form    | 0.1         |



**Farrell Heyworth** 309 Garstang Road, Preston, PR2 9XJ 01772 752666





Everything you want  
to know about  
local health services







**How local are the health services?**

We all want good access to local health facilities, wherever we live. To see how well **Woodville Road** is served, we have set out below the exact locations of hospitals, Accident & Emergency centres, GPs, pharmacies, dentists, out-of-hours medical care and walk-in clinics. Where it's available, you will find more detailed information, including the names of practitioners and their contact details.

| Hospitals   | Approx Distance  |             |
|---|--|-------------|
|  | Royal Preston Hospital, Sharoe Green Lane North, Preston, Lancashire, PR2 9HT                      | 3.86 miles  |
|   | Chorley And South Ribble Hospital, Chorley and South Ribble Hospital, Chorley, Lancashire, PR7 1PP | 5.93 miles  |
|   | Royal Blackburn Hospital, Haslingden Road, Blackburn, Lancashire, BB2 3HH                          | 10.37 miles |
|   | Southport And Formby District General Hospital, Southport, Merseyside, PR8 6PN                     | 12.68 miles |
|   | Royal Albert Edward Infirmary, Wigan, Lancashire, WN1 2NN  | 12.87 miles |
| A&E   | Approx Distance  |             |
|  | Royal Preston Hospital, Sharoe Green Lane North, Preston, Lancashire, PR2 9HT                      | 3.86 miles  |
|   | Chorley And South Ribble Hospital, Chorley and South Ribble Hospital, Chorley, Lancashire, PR7 1PP | 5.93 miles  |
|   | Royal Blackburn Hospital, Haslingden Road, Blackburn, Lancashire, BB2 3HH                          | 10.37 miles |
|   | Southport And Formby District General Hospital, Southport, Merseyside, PR8 6PN                     | 12.68 miles |
|   | Royal Albert Edward Infirmary, Wigan, Lancashire, WN1 2NN  | 12.87 miles |



|   | Walk-in Clinics   | Approx Distance |
|---|---|-----------------|
|    | Dr T L Phillips At Barbara Castle Health Centre, Level Two, Lancashire, BB2 1AX           | 9.61 miles      |
|   | Royal Blackburn Hospital, Haslingden Road, Blackburn, Lancashire, BB2 3HH                 | 10.37 miles     |
|   | Darwen Health Care, Darwen Health Centre, Lancashire, BB3 1PY                             | 10.56 miles     |
|   | The Skelmersdale Walk In Centre, 116-118 The Concourse, Skelmersdale, Lancashire, WN8 6LJ | 13.04 miles     |
|   | Ormskirk And District General Hospital, Ormskirk, Lancashire, L39 2AZ                     | 13.35 miles     |
|   | GPs   | Approx Distance |
|    | KINGSFOLD MEDICAL CENTRE, KINGSFOLD MEDICAL CENTRE, PRESTON, PR1 9BX                      | 0.13 miles      |
|   | ST.MARY'S HEALTH CENTRE, ST.MARY'S HEALTH CENTRE, LANCASHIRE, PR1 0SR                     | 0.88 miles      |
|   | ST FILLAN'S MEDICAL CTRE, ST FILLAN'S MEDICAL CTRE, LANCASHIRE, PR1 0AD                   | 1.04 miles      |
|   | LOSTOCK HALL MEDICAL CTR., LOSTOCK HALL MEDICAL CTR., WALTON-LE-DALE,PRESTON, PR5 5SA     | 1.18 miles      |
|   | NEW LONGTON SURGERY, THE VILLAGE SURGERY, PRESTON, PR4 4LU                                | 1.24 miles      |
|   | Dental Surgeons   | Approx Distance |
|  | High Street Smiles, 107-109 High Street, WARRINGTON, Cheshire, WA3 3BZ                    | 18.57 miles     |
|   | Mr Jm Kelly & Associates, 7A Stonecross Lane, WARRINGTON, Cheshire, WA3 2SA               | 18.93 miles     |
|   | L Askins, Woodgate, WARRINGTON, Cheshire, WA3 2QZ   | 19.25 miles     |
|   | Hob Hey Dental Practice, 3 Hob Hey Lane, WARRINGTON, Cheshire, WA3 4NQ                    | 21.1 miles      |
|   | The Village Dental Practice, Warrington Road, WARRINGTON, Cheshire, WA3 5HH               | 21.28 miles     |

**Disclaimer:** The information represented in this section has been sourced from Experian and is based on the property's postcode.



**Farrell Heyworth** 309 Garstang Road, Preston, PR2 9XJ **01772 752666**



Everything you want  
to know about  
local policing





### Understanding who polices your neighbourhood

When you move to a new area, you want to know the arrangements for local community policing. See below for essential information about police services near to **Woodville Road**. We have included location and contact details for the police station and wherever possible, details of police officers assigned to the area.

#### Your policing neighbourhood

The name of your policing neighbourhood is **Kingsfold & Middleforth** and it has a population of **7985**.

| Your Local Policing Team |      |         |        |
|--------------------------|------|---------|--------|
| Name                     | Rank | Tel No. | E-mail |
| Hannah Blundell          | PCSO |         |        |

**Disclaimer:** The information represented in this section has been sourced from data.police.uk.

#### Locations of Interest

Preston Police Station  
 station  
 Lancaster Road North Preston

Preston Police Station is open 08:00 to 20:00 Monday to Friday, 09:00 to 18:00 Saturday and Sunday

**Disclaimer:** The information represented in this section has been sourced from data.police.uk.



**Farrell Heyworth** 309 Garstang Road, Preston, PR2 9XJ **01772 752666**

