



Market Chambers, New Town, SG1 1DD

ATTN LANDLORD'S SPACIOUS AND CENRALLY LOCATED One Bedroom Flat SITUATED A SHORT WALK to Stevenage Mainline Station, New Town and Old Town, Features include Fitted Kitchen/Lounge Area, Master Bedroom, Bathroom, Current has been renting for the last 8 years paying £690PCM.

£130,000

Market Chambers, New Town, SG1 1DD



- Spacious and Centrally located One Bedroom Flat
- Master Bedroom
- 167 Years Remaining on the Lease
- Situated close to Stevenage Mainline Station, New Town, and Old Town
- Bathroom
- Fitted Kitchen/Lounge Area
- Current has been renting for the last 8 years paying £690PCM

Entrance Hallway

3'1 x 8'2 (0.94m x 2.49m)

Kitchen and Living Room

20'5 x 9'5 (6.22m x 2.87m)

Bedroom One

12'5 x 9'5 (3.78m x 2.87m)

Bathroom

5'11 x 5'6 (1.80m x 1.68m)

Lease Information and Local Information

SERVICE CHARGE - £848.00 incl

Building Insurance

GROUND RENT - £100

Term of 189 years from and including

1st June 2003, therefore 167 year remaining.

The managing company is Pont & Lyall Ltd

The owner is not aware of any review period for the Ground Rent.

Market Chambers is centrally located within the New Town and is a short walk to Stevenage Mainline Station.



Directions



Floor Plan

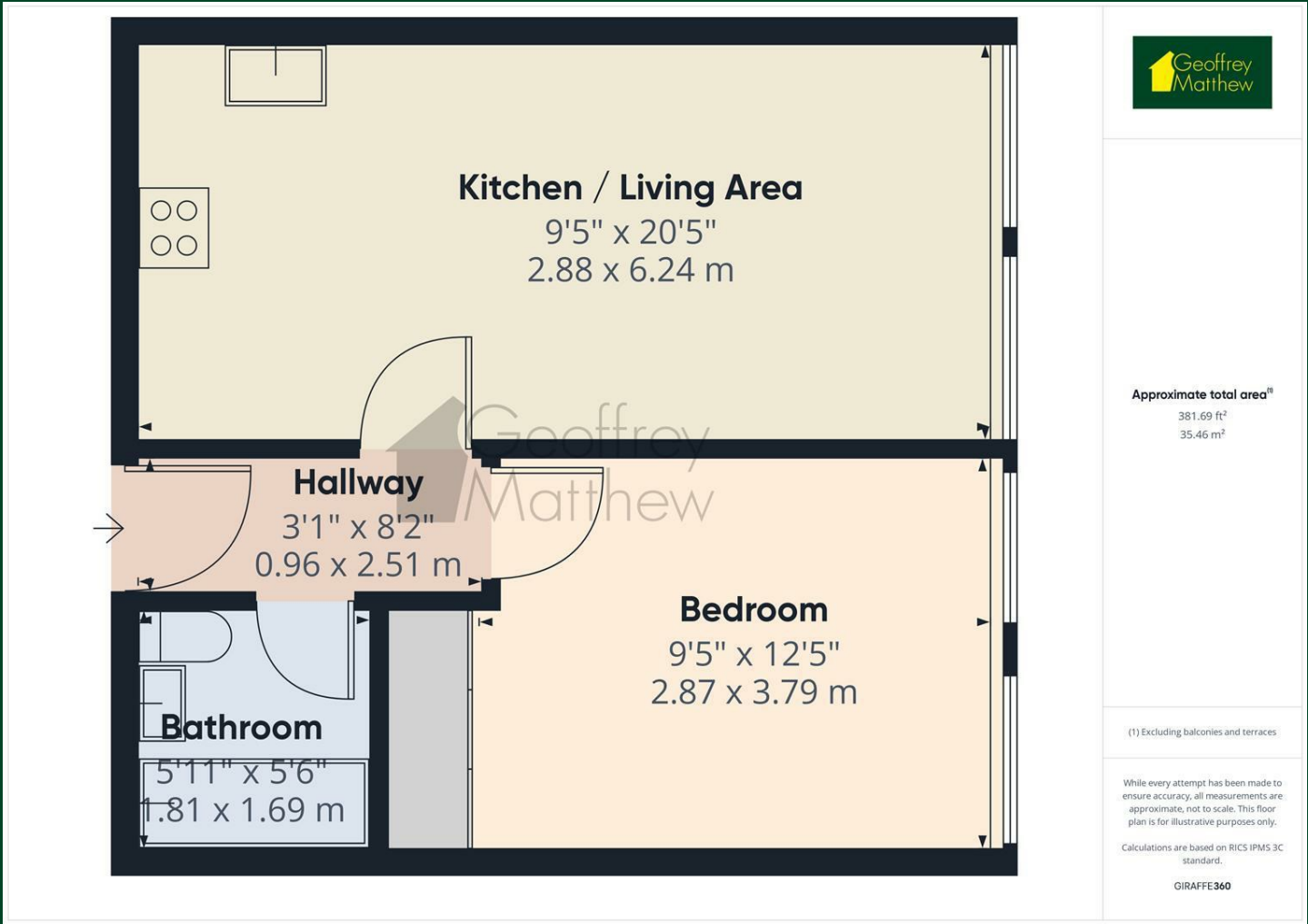

Council Tax Details

Band A

These particulars, whilst believed to be accurate are set out as a general outline only for guidance and do not constitute any part of an offer or contract. Intending purchasers should not rely on them as statements of representation of fact, but must satisfy themselves by inspection or otherwise as to their accuracy. No person in this firms employment has the authority to make or give any representation or warranty in respect of the property.

